

FOREST CO SURVEYOR
FILE # 401408-20241118
DATE 12/18/2024 BY JA

S 1/2 - Government Lot 13
Doc. No. 240148

2" dia. iron pipe
w/ brass cap found

2" dia. iron pipe
w/ G.L.O. cap found
(Monument and
witnesses verified)

Government Lot 16

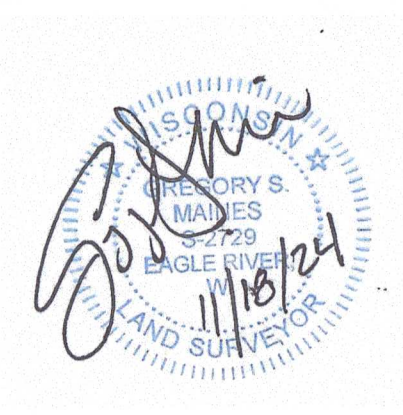

Forest County Grid Bearings:
Referenced to the East-West 1/4 Line
of Section 8 as bearing N89°18'15"W

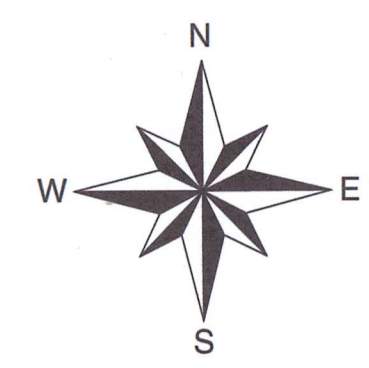

- 1" dia. iron pipe set
- ⊗ 1" dia. iron pipe found
- ⊕ Steel nail found
- () Bearing or distance of record

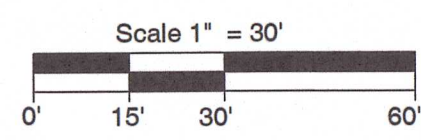

Surveyors Certificate

I hereby certify that I have surveyed the property shown hereon; that this map represents an accurate survey of said property to the best of my knowledge and belief; and that I have complied with the applicable requirements of the Wisconsin Administrative Code Section A-E 7.

Notes:

- This survey was done without the benefit of a title commitment, there may or may not be easements of record that benefit or burden the subject property.
- Fieldwork was completed on September 17, 2024.

Lot 1 Legal Description:

A parcel of land being part of the South Half of Government Lot 13, Section 8, Township 40 North, Range 14 East, Town of Alvin, Forest County, Wisconsin, shown as Lot 1 on Maines and Associates Map No. 2024355, dated November 18, 2024, and being more particularly described as follows:

Commencing at the east quarter corner of said Section 8 marked by a G.L.O. brass capped iron pipe; thence along the east-west quarter line of said Section 8, N89°18'15"W for a distance of 1223.48 feet to the center-east sixteenth corner marked by an iron pipe, the PLACE OF BEGINNING. Thence along the south line of said Government Lot 13, N89°18'15"W for a distance of 235.00 feet to an iron pipe; thence leaving said south line, N04°51'57"E for a distance of 120.00 feet to an iron pipe; thence S89°18'16"E for a distance of 235.00 feet to an iron pipe on the east line of said Government Lot 13; thence along said east line, S04°51'57"W for a distance of 120.00 feet to the PLACE OF BEGINNING.

Subject to the rights of the public over the Town Road known as Zierler Road.
Together with and subject to any easements, restrictions, and reservations of record or of use.

Part of the
South 1/2 of Government Lot 13
Section 8, T 40 N, R 14 E
Town of Alvin
Forest County, Wisconsin

PREPARED FOR:

David Lesselyoung
Charles Hofensperger
Gregory & Janet Lenz Trust



Arbor Vitae, WI 54568
Phone 715.356.9485

Eagle River, WI 54521
Phone 715.479.2570

www.mainesandassociates.com

SHEET 1 OF 1
DATE: 11/18/2024
DRAWN BY: LMV
MAP #: 2024355