

PLAT OF SURVEY FOR CERTIFIED LAND CORNER

RESTORATION AND ESTABLISHMENT

BEING THE CORNERS FOR THE NE 1/4 OF THE NE 1/4,  
THE SE 1/4 OF THE SE 1/4, THE EAST 1/2 OF THE SW 1/4  
AND THE CORNERS ON THE PERIMETER OF THE SECTION.

SECTION 14, TOWNSHIP 40 NORTH, RANGE 13 EAST.

COUNTY OF FOREST, STATE OF WISCONSIN.

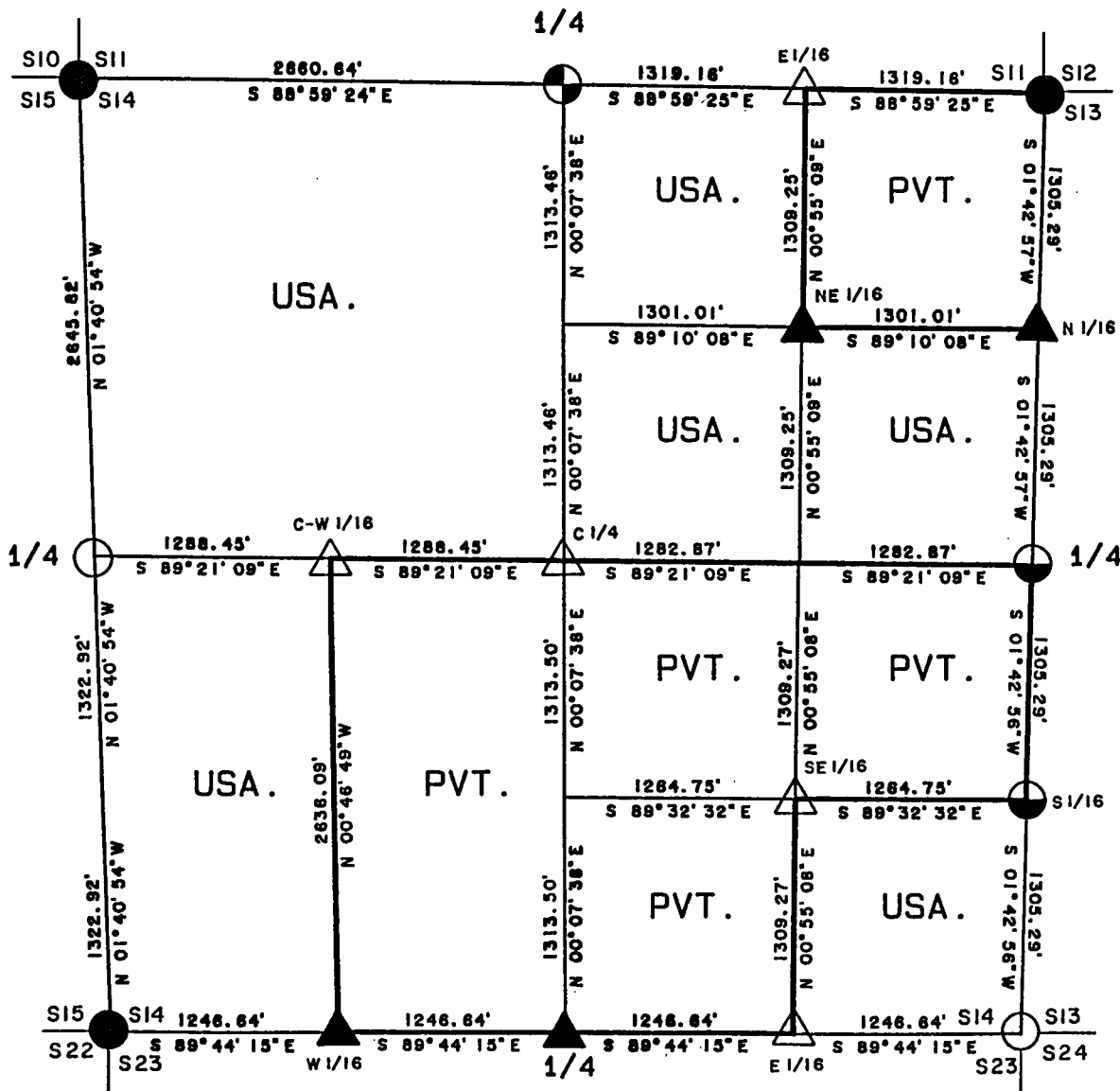

Stock No. 26273

## T40N R13E - SECTION 14

Page 2 of 5

SURVEY NOTES

This survey was made by the U.S. Department of Agriculture, Forest Service for the purpose of recovering, restoring, establishing, marking, and perpetuating the corners and boundary line of U.S. Government land on the perimeter and within Section 14, Township 40 North, Range 13 East, Fourth Principal Meridian, Forest County, State of Wisconsin as shown on the plat map herewith.

The Original Government Sub-division of this township was done in 1865 by William E. Daugherty.

The U.S. Government land within Section 14 was acquired in 1935.

The bearings between corner positions are referenced to the East line of Section 25 as previously surveyed. No curvature corrections have been applied to the bearings in Section 14. The accuracy of this survey exceeds the State of Wisconsin requirement for closure of 1 part in 3000. Corners recovered or established by this survey are marked as described in the map legend. Each monumented corner is referenced to blazed, scribed, painted and tagged bearing trees. Tie bearings to the bearing trees are magnetic and are not corrected for declination.

The field notes and a copy of the plat of survey are on file in the Forest Service Supervisor's Office at Rhinelander, Wisconsin and the District Ranger's Office at Eagle River, Wisconsin.

CORNERS RECOVERED AND RESTORED1. Northeast Section Corner

Corner position restored in 1973 by Jean Resvick, RLS with the U.S. Forest Service from original corner evidence. Corner documentation is recorded on a Certified Land Corner Restoration Certificate filed in the Forest County Registrar of Deeds Office as Document No. 102386.

## 1973 Corner References Recovered:

Sugar	6"	N 22° E	5.87 feet
Sugar	Stump	N 56° W	12.22 feet
Northeast Corner of a Cabin		S 51° W	65.10 feet

## New Corner References:

Maple	10"	N 37° W	35.55 feet
Steel Sign Post		Northwest	1.00 feet

2. East Quarter Corner

Corner position restored at midpoint and on line between the Northeast and Southeast section corners.

## Corner References:

Tamarack	10"	N 41° E	10.99 feet
Tamarack	7"	S 44° W	13.77 feet
Steel Sign Post		West	0.75 feet

3. Southeast Section Corner

Corner restroed at double proportionate measurement between the Southwest section corner of section 14, the Northeast section corner of section 14, the Southeast section corner of section 13 and the West quarter corner of section 24.

## Corner References:

Maple	5"	N 67° E	18.68 feet
Maple	4"	S 78° E	36.40 feet
Maple	7"	S 9° W	13.05 feet
Maple	12"	N 61° W	25.56 feet
Steel sign post		Southeast	1.00 feet

Stock No. 26273

T40N R13E - SECTION 14

Page 3 of 5

4. South Quarter Corner

Corner position restored at midpoint and on line between the Southwest and Southeast section corners.

## Corner References:

Cedar	14"	S 54° E	46.41 feet
Cedar	12"	S 60° W	21.50 feet
Steel sign post		North	0.50 feet

5. Southwest Section Corner

Corner position recovered and restored in 1975 by Jean Resvick, RLS with the U.S. Forest Service. Corner documentation is recorded on a Certified Land Corner Restoration Certificate filed in the Forest County Registrar of Deeds Office as Document No. 106881.

## 1975 Corner References Recovered:

Maple	10"	N 74° E	12.32 feet
Maple	10"	S 12° E	23.57 feet
Maple	11"	S 72° W	8.63 feet

## New Corner References:

Steel sign post		Northeast	1.00 feet
-----------------	--	-----------	-----------

6. West Quarter Corner

Corner position restored at midpoint and on line between the Southwest and Northwest section corners.

## Corner References:

Maple	10"	S 50° E	13.83 feet
Maple	5"	N 3° W	19.15 feet
Steel Sign Post		West	0.75 feet

7. Northwest Section Corner

Corner position recovered and restored in 1959 by Robert Bandow, RLS. Corner documentation is recorded on a Certified Land Corner Restoration Certificate filed in the Forest County Registrar of Deeds Office as Document No. 83248.

## 1959 Corner References Recovered:

Hemlock	16"	S 30° E	9.95 feet
Hemlock	16"	S 40° W	23.93 feet
Maple	16"	N 20° W	8.65 feet

## New Corner References:

Hemlock	26"	West	25.22 feet
Steel sign post		West	1.50 feet

8. North Quarter Corner

Corner position restored on line between the Northwest and Northeast section corners at the intersection of the centerline of Highway 55.

## Corner References:

Spruce	9"	S 68° W	71.10 feet
Spruce	8"	N 59° W	69.40 feet
Reference Corner		West	33.00 feet
Steel sign post		West	33.50 feet

CORNERS ESTABLISHED1. Northeast Sixteenth Corner

Corner position established at the intersection of straight lines between opposing sixteenth corner positions on the perimeter of the Northeast quarter of the section.

## Corner References:

Spruce	7"	N 60° E	7.35 feet
Tamarack	12"	S 83° E	25.92 feet
Steel sign post		East	1.00 feet

Stock No. 26273

T40N R13E - SECTION 14

Page 4 of 5

2. North Sixteenth Between Sections 13 and 14

Corner position established at midpoint and on line between the East quarter corner and the Northeast section corner.

## Corner References:

Black Spruce	4"	N 62° E	5.36 feet
Black Spruce	2"	N 77° W	10.48 feet
Steel sign Post		South along side the monument	

3. Center West Sixteenth

Corner position established at midpoint and on line between the West quarter corner and the Center quarter corner.

## Corner References: 15.13

Maple	9"	S 56° E	24.05 feet
Maple	7"	N 21° W	16.58 feet
Steel sign post		Southwest	1.00 feet

4. Center Quarter Corner

Corner position established at the intersection of straight lines between opposing quarter corners on the perimeter of the section.

## Corner References:

Maple	14"	North	18.82 feet
Maple	8"	N 82° W	12.93 feet
Steel sign post		West	0.50 feet

5. South Sixteenth Corner Between Sections 14 and 15

Corner position established at the midpoint and on line between the Southwest section corner and the West quarter corner.

## Corner References:

Aspen	7"	N 28° E	9.34 feet
Maple	6"	S 72° E	18.17 feet
Steel sign post		Northeast	0.50 feet

6. Southeast Sixteenth Corner

Corner position established at the intersection of straight lines between opposing sixteenth corners in the Southeast quarter.

## Corner References:

Balsam	8"	S 40° E	39.64 feet
Balsam	8"	S 40° W	11.19 feet
Steel sign post		North	0.25 feet

7. South Sixteenth Corner Between Sections 13 and 14

Corner position established at midpoint and on line between the Southeast section corner and the East quarter corner.

## Corner References:

No living bearing trees within 400 feet.			
Steel sign post		East	1.00 feet

8. West Sixteenth Between Sections 14 and 23

Corner position established at midpoint and on line between the Southwest section corner and the South quarter corner.

## Corner References:

Cedar	11"	N 10° E	27.09 feet
Cedar	12"	N 88° W	13.85 feet
Steel sign post		Southwest	1.00 feet

9. East Sixteenth Between Section 14 and 23

Corner position established at midpoint and on line between the South quarter corner and the Southeast section corner.

## Corner References:

Maple	8"	S 71° E	33.16 feet
Maple	8"	S 53° W	51.92 feet
Steel sign post		Northwest	0.50 feet

