

Butternut

Lake

Lot 1, Vol.4CS, Pg.102
recorded as Document No. 139692
located in part of
Government Lot 2
Hiles Township
Forest County, Wisconsin

Record Bearings:
referenced to the east line of Lot 1,
CSM Volume 4CS, Page 104
which bears S 7°33'58"E

-Krueger-
Lot 1, CSM Vol.3cs, Pg.224
Parcel No. 016 01305 0000
Document No. 245095

-Dula-
Parcel No. 016-01300-0000
Document No. 215149

Lot 1, Vol.4CS, Pg.102
Parcel No. 016-01298-0000
Document No. 228874
22,820 sq.ft. +/-
0.52 acre +/-

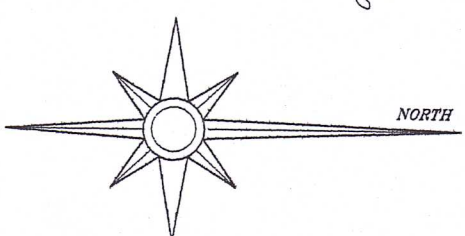

Legend:
⊕ 1.0" diameter iron pipe found in place
○ 1.25" diameter iron pipe found in place
() data per the record thereof

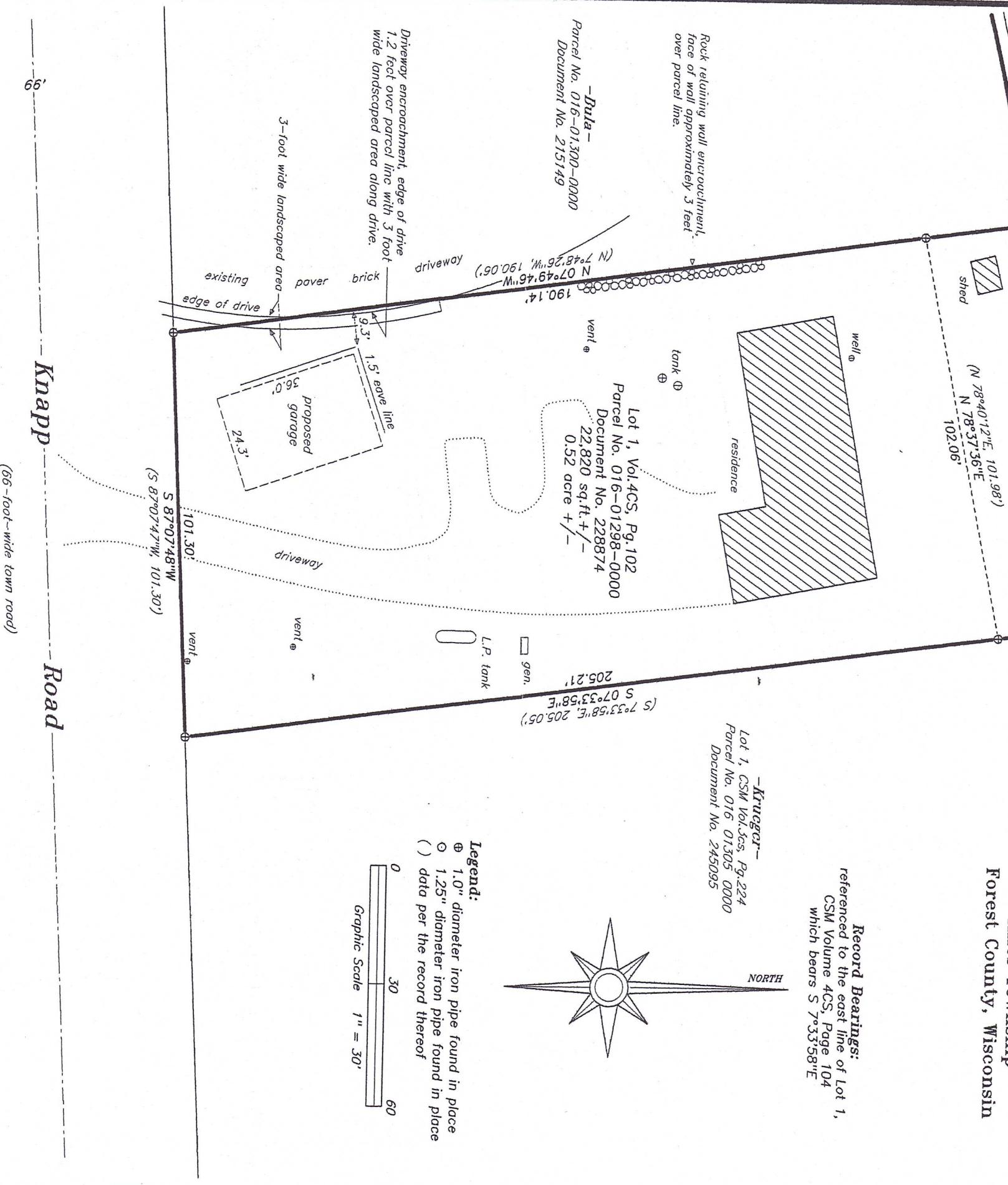
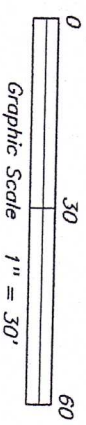

Surveyor's Certificate:

I, David A. Konopacky, hereby certify that I have surveyed the parcel(s) of land shown hereon; that this map represents an accurate survey of said lands to the best of my knowledge and belief; and that I have complied with the applicable requirements of the Wisconsin Administrative Code Section A-E 7.

David A. Konopacky
Professional Land Surveyor No. 2566

Date 6.20.25



FOREST CO SURVEYOR
FILE # 40233-20250620
DATE 10/02/2025 BY DA

Susan M Vander Leest Trust
215 8th Street
Downers Grove, IL 60515

Map Scale: 1" = 30' Date: 06/20/25 Drafted by: DAK
Project No. 5869 NORTHWOODS SURVEYING
P.O. BOX 1002, LAND O'LAKES, WISCONSIN 54540