

North is referenced to the South line of the Northwest 1/4, section 32 as shown on the United States Forest Service Plat of Survey as being a bearing of N 87° 28' 08" E.

PLAT OF SURVEY

LOCATED IN PART OF THE
SE 1/4 OF THE NW 1/4, SEC. 32,
T. 38 N., R. 14 E., TOWN OF ROSS,
FOREST COUNTY, WI.

PARCEL -A-
8.976 ACRES
391,022 SQ. FT.

PARCEL -B-
11.240 ACRES
489,637 SQ. FT.

EXCEPTION

DOUBLE BEND ROAD & FR 2166

LEGEND

- Subdivisional monument of record
- ⊙ Subdivisional monument set
- Set 1" iron pipe, outside dimension
- △ Computed position
- (0.00') bearing & distance of record

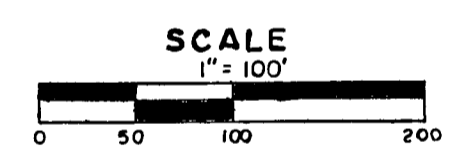

FOREST CO SURVEYOR
FILE # 381432-20201130
DATE _____ BY _____

I, Todd Loftus, Professional Land Surveyor, hereby certify that I have surveyed the property shown hereon. That this map represents an accurate survey of said property to the best of my knowledge & belief. That I have performed this survey by order of Steven Smitz and that I have complied with the applicable requirements of the Wisconsin Administrative Code A.E.7.

DATE Nov 30 2020
SIGNED *Todd Loftus*

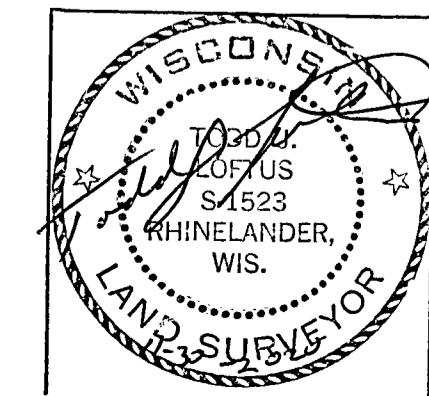

survey for Steven R. Smitz
1627 Shore Drive
Racine, WI. 53402

LOFTUS SURVEYING
860 BALSAM STREET
RHINELANDER, WI 54501
TEL/FAX 715-369-1142
hodag28@hotmail.com

2080B7

W 1/4 COR.
Brass capped 2.5" iron pipe by U.S.F.S.
S 87° 28' 08" W 1279.50'
(S 87° 28' 08" W 1279.50')
C-W 1/16
1" aluminum pipe with aluminum cap

N 1/4 COR.
brass capped 2.5" iron pipe by U.S.F.S.
1306.89'
found bent 1" iron pipe
bears S 60° 53' 56" E, 2.75'
C-N 1/16
1" iron pipe od.
2619.78'
2619.88'
N 1° 03' 50" W 140.10'
(N 1° 03' 50" W 140.10')

NE-NW 1/4
SE-NW 1/4

N 87° 28' 08" E 1279.50'

found CPI, 2.5" capped pipe
bears S 35° 54' 16" E, 2.40'
C 1/4

FOREST CO SURVEYOR
FILE # 381432-20201130
DATE 02/05/2021 BY *SL*

Legal Descriptions conforming to the above parcels are on separate sheets.