

HARRY (JESS) SMITH, RLS
CASEY J. SWANSON, RLS
Job No. 11-5497
Dwg. No. 5497northernrealty



Northeast
Surveying, Inc.
Registered Wisconsin Land Surveyors

13418 LOGAN ROAD
SURING WI. 54174
920-842-2426

FOREST CO SURVEYOR
FILE # 381426-20110317
DATE _____ BY _____

3-17-11

PIACENZA CLUB INC
VOL. 123 PG. 218



GRAPHIC SCALE
1 inch = 200 ft.

PLAT OF SURVEY

PART OF THE NORTHEAST QUARTER OF THE NORTHEAST QUARTER OF SECTION 26, TOWNSHIP 38 NORTH RANGE 14 EAST, TOWN OF ROSS, FOREST COUNTY, WISCONSIN.

Bearings referenced to the north line of the NE 1/4 of Section 26, T38N R14E, RECORDED TO BEAR N89°37'06"W (SURVEYS OF RECORD)

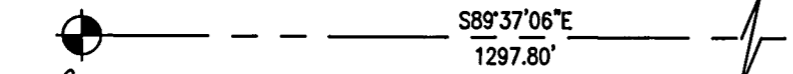

PRIOR TO ANY CONSTRUCTION OR OTHER LAND USE ACTIVITY, ALL BUILDING SETBACKS AND OTHER LAND USE REQUIREMENTS SHOULD BE VERIFIED BY THE FOREST COUNTY ZONING OFFICE.

PORTIONS OF THIS BOUNDARY ARE BASED ON THE SUBDIVISION OF SECTION 26, ON FILE IN THE FOREST COUNTY SURVEYOR'S OFFICE. (USFS PLAT AND SURVEYS OF RECORD)

- EXISTING FOREST COUNTY MONUMENT OF RECORD
- EXISTING 1" IRON PIPE
- SET 2"x 30" IRON PIPE weighing 3.65 lbs./lin. ft.
- SET 1"x 24" IRON PIPE weighing 1.68 lbs./lin. ft.

MYRON CAELWAERTS
VOL. 173 PG. 381

PARCEL A
244,461 SQ. FT.
5.612 AC.

PARCEL 1

JADE RUECHEL
VOL. 355 PG. 762

TOWN OF ROSS
VOL. 119 PG. 19

STH 139

SURVEYOR'S CERTIFICATE:

I, Harry J. Smith, Registered Land Surveyor, do hereby certify: That by the order and under the direction of Myron Caelwaerts, owner; I have surveyed, and mapped part of the Northeast quarter of the Northeast quarter of Section 26, Township 38 North - Range 14 East, Town of Ross, Forest County, Wisconsin.

I, further certify that the within map is a true and correct representation of the exterior boundaries of the lands surveyed and that I have fully complied with the provisions of the State of Wisconsin in the surveying and mapping of same to the best of my knowledge and belief.

Dated this 17th day of March, 2011.

Harry J. Smith
Harry J. Smith, P.fes.

MYRON CAELWAERTS
VOL. 173 PG. 381

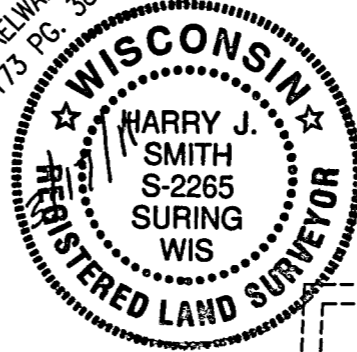

NW1/4-NE1/4
NE1/4-NE1/4

Art 26-492

PARCEL A

Part of the Northeast quarter of the Northeast quarter of Section 26, Township 38 North, Range 14 East, Town of Ross, Forest County, Wisconsin, described as follows:

Commencing at the Northeast corner of said Section 26, Thence North 89 degrees 37 minutes 06 seconds West, along the North line of said Section 26, a distance of 915.76 ft. to a 1" iron pipe at the **POINT OF BEGINNING**:

Thence South 01 degrees 33 minutes 16 seconds West, along the West line of lands described in Volume 355 Page 762 of the Forest County Records, a distance of 632.00 ft. to a 1" iron pipe;
Thence North 89 degrees 37 minutes 06 seconds West, a distance of 391.74 ft. to a 1" iron pipe on the West line of the Northeast quarter of the Northeast quarter of said Section 26;
Thence North 02 degrees 25 minutes 58 seconds East, along said West line, a distance of 632.27 ft. to a 2" iron pipe at the East 1/16th corner;
Thence South 89 degrees 37 minutes 06 seconds East, along the North line of said Section 26, a distance of 382.04 ft. to the **POINT OF BEGINNING...**

Together with and subject to any easements, covenants, and restrictions of record.

Said parcel contains 244,461 sq. ft or 5.612 acres of land, more or less.