

Received
8-26-10

PLAT OF SURVEY

PART OF THE NE 1/4 - SE 1/4 OF SECTION 9, T37N, R12E,
TOWN OF HILES, FOREST COUNTY, WISCONSIN

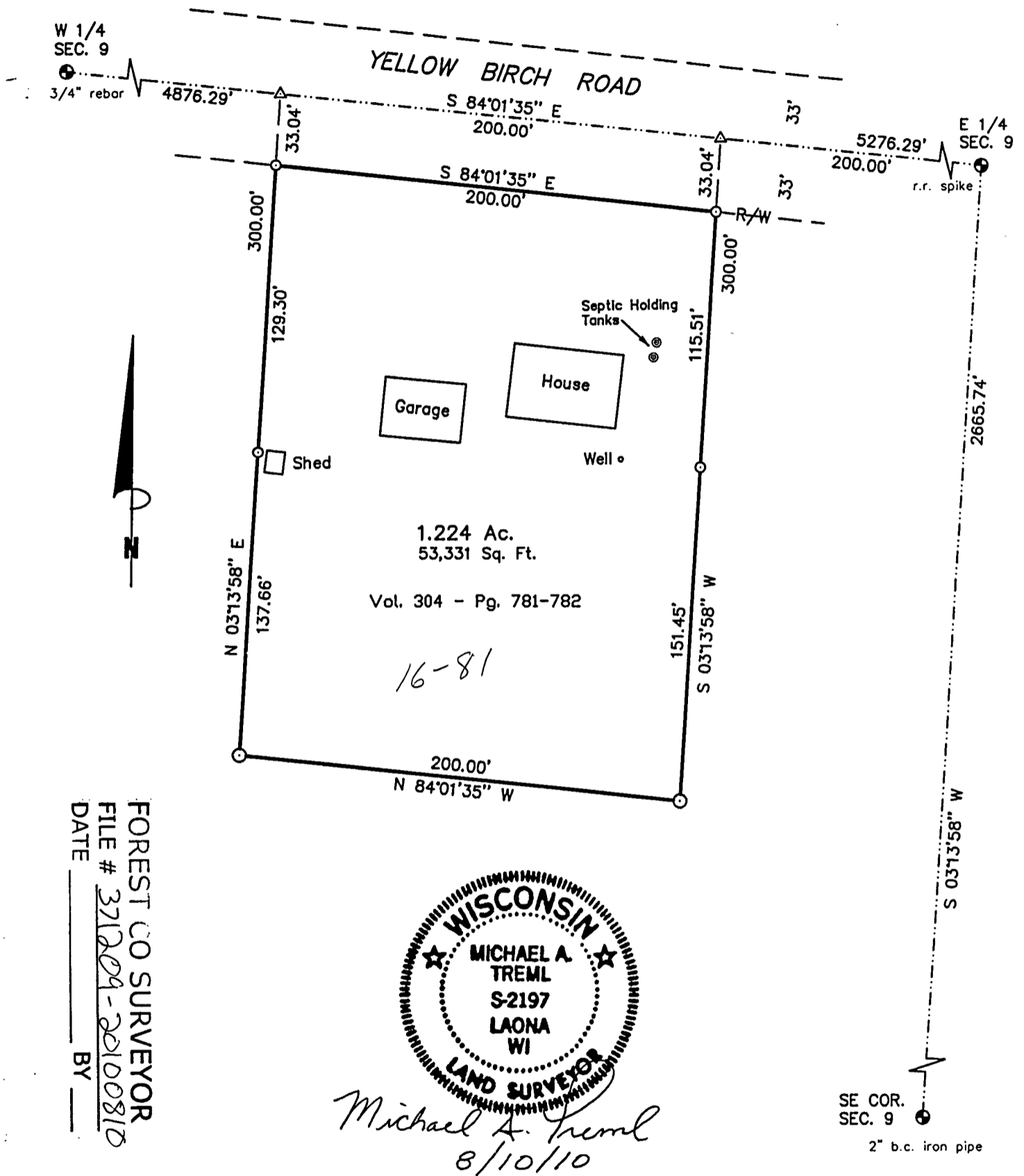

FOREST CO SURVEYOR
 FILE # 371209-20100810
 DATE _____ BY _____



Michael A. Tremel
8/10/10

Bearings are assumed and referenced to the east line of said SE 1/4 which bears S 03°13'58" W.

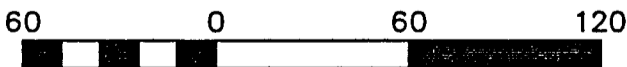

Scale 1" = 60'

SURVEYOR'S CERTIFICATE:

I, Michael A. Tremel, Registered Land Surveyor, HEREBY certify that by the order of Joseph Bukovic: I have surveyed and mapped the hereon described and depicted lands and that this map is a true and correct representation of the lands surveyed to the best of my knowledge and belief.

DWG. NO.: 893-10	LEGEND:
	<ul style="list-style-type: none"> ⊕ EXISTING MONUMENT OF RECORD (AS NOTED) ⊙ SET 1" O.D. X 36" IRON PIPE ○ SET 1" O.D. X 20" IRON PIPE △ COMPUTED POSITION