

# PLAT OF SURVEY

PART OF THE NW 1/4 - NW 1/4 OF SECTION 31,  
T36N, R15E, TOWN OF LAONA, FOREST COUNTY, WISCONSIN

NW COR.  
SEC. 31

P.K. NAIL

33'

MILL STREET

S 88°57'40" E

660.00'

2717.32'

2057.32'

N 1/4  
SEC. 31

R.R. SPIKE

Vol. 92 - Pg. 444

(Due East parallel to N. Line Sec. 31)

S 88°57'40" E

125.00'

Utility Pole

115'

43,734 Sq. Ft.  
1.004 Ac.

Asphalt Parking Lot

Garage

350.00'

N 00°26'37" W  
(S 01°28'00" E)

N 00°26'37" W  
(N 01°28'00" W)

(S 01°28'00" E)  
S 00°26'37" E  
350.00'

Beech Apartments

Existing 23"x11" telephone box at cor. position

125.00'

25'

N 88°57'40" W

(Due West parallel to N. Line Sec. 31)

Vol. 114 - Pg. 744

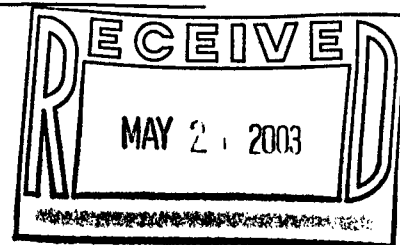

Bearings are assumed and referenced to the North line of said NW 1/4 which bears S 88°57'40" E.

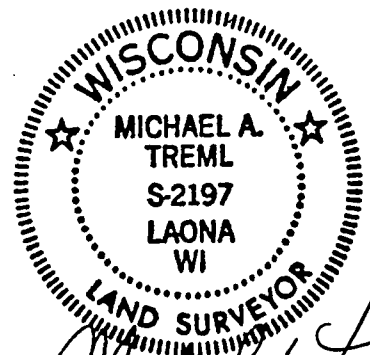

*Michael A. Tremel*  
5/19/03

## SURVEYOR'S CERTIFICATE:

I, Michael A. Tremel, Registered Land Surveyor, HEREBY certify that by the order of Don Erickson: I have surveyed and mapped the hereon described and depicted lands and the within map is a true and correct representation of the lands surveyed to the best of my knowledge and belief.

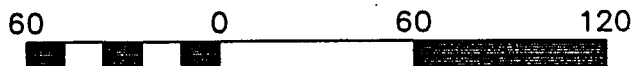

Scale 1" = 60'

<p>DATE: MAY 09, 2003</p> <p>DWG. NO.: 332-03</p>	<p>LEGEND:</p> <ul style="list-style-type: none"> <li>⊙ MONUMENT OF RECORD (AS NOTED) FOUND</li> <li>● 1" DIA. SOLID IRON ROD FOUND</li> <li>○ 3/4" X 24" REBAR W/CAP SET</li> <li>( ) RECORDED AS</li> </ul>	<p>SHT. NO.</p> <p>1 Of 1</p>
---	---	-------------------------------