

PLAT OF SURVEY

PART OF GOV'T LOT 6 OF SECTION 29, T36N, R15E,
TOWN OF LAONA, FOREST COUNTY, WISCONSIN

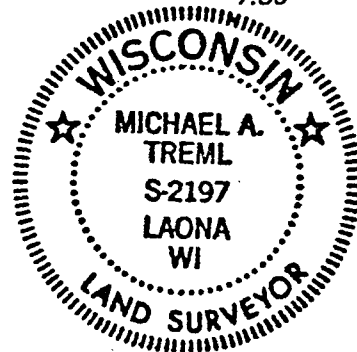

SURVEYOR'S CERTIFICATE:

I, Michael A. Tremel, Registered Land Surveyor, HEREBY certify that by the order of Paul Evans: I have surveyed and mapped the hereon described and depicted lands and the within map is a true and correct representation of the lands surveyed to the best of my knowledge and belief.

Michael A. Tremel 8/10/05
Michael A. Tremel, R.L.S. No. 2197 Date

Bearings are referenced to the Northerly boundary line of parcel described in Vol. 209 - Pg. 835, recorded as N 51°00'11" E.

100 0 100 200
Scale: 1" = 100'

SHT. NO.	LEGEND:		
1 of 1	● EXISTING 2" IRON PIPE	△ COMPUTED POSITION	
	● EXISTING 1" IRON PIPE	() RECORDED AS	
	⊙ EXISTING 1 1/2" IRON PIPE		
	○ SET 1" X 20" IRON PIPE		

DRAWN BY: KRM

DWG. NO.: 2114-05

CHECKED BY: MAT

