

# LINE SURVEY

THE NORTHWEST LINE OF THOSE LANDS DESCRIBED IN DOCUMENT NUMBER 241270 BEING THE NORTHWEST LINE OF LOT 3 OF CERTIFIED SURVEY MAP AS RECORDED IN VOLUME 3 OF CERTIFIED SURVEY MAPS ON PAGE 125, AS DOCUMENT NUMBER 125158, LOCATED IN THE SOUTHEAST 1/4 OF THE NORTHEAST 1/4, SECTION 30, TOWNSHIP 36 NORTH, RANGE 13 EAST, FOURTH PRINCIPAL MERIDIAN, CITY OF CRANDON, FOREST COUNTY, WISCONSIN

Bearings are referenced to:  
The Wisconsin Coordinate Reference System,  
Forest County Zone,  
and the East line of the NE 1/4 of Section 30  
Measured to bear  
N00°19'49"W



## SURVEYOR'S CERTIFICATE

I, Jeffrey L. DeMuth, Professional Land Surveyor S-2656 of the State of Wisconsin, do hereby certify to my client, David Tupper, the Owner of adjoining lands, and under whose direction this survey was performed, that I have: surveyed, mapped, and described the Northwest Line of those lands described in document number 241270, being the Northwest Line of Lot 3 of Certified Survey Map as recorded in volume 3 of Certified Survey Maps on page 125, as document number 125158, located in the Southeast 1/4 of the Northeast 1/4, Section 30, Township 36 North, Range 13 East, Fourth Principal Meridian, City of Crandon, Forest County, Wisconsin.

Being more particularly described for mapping purposes as follows:

Commencing at the East 1/4 corner of Section 30, Thence N 00°19'49" W, along the east line of the NE 1/4 of said section, a distance of 593.97 feet to the easterly extension of the northwest right-of-way line of Railway Lane; Thence, leaving said east line, S 51°45'16" W, along said right-of-way line, a distance of 543.44 feet to the South corner of Lot 3 of Certified Survey Map as recorded in volume 3 of Certified Survey Maps on page 125, as document number 125158; Thence, leaving said right-of-way line, N 38°05'50" W, along the Southwest line of said Lot 3, a distance of 126.24 feet to the West corner of said Lot 3, and the POINT OF BEGINNING of line to be described; Thence, leaving said Southwest line, N 51°24'38" E, along the Northwest line of said Lot 3, a distance of 94.70 feet to the point of termination of the line being described.

That this Map is a true and correct representation of the line surveyed, and that I have fully complied with Chapter A-E 7 of the Wisconsin Administrative Code, to the best of my knowledge and belief.

Northeast Corner Section 30  
per U.S.P.L.S. Monument Record.  
Railroad spike, found.  
See current Monument Record.

*Jeffrey L. DeMuth*  
Jeffrey L. DeMuth S-2656  
February 10, 2026  
Date

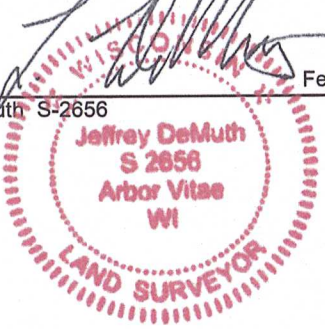

## LEGEND

Monument sizes = outside diameter measurements.

- ⊙ 1.4" diameter iron pipe, found
- ⊙ 1.25" diameter iron pipe, found
- ⊙ U.S.P.L.S. monument, as noted
- △ Computed position, not set
- ( ) Previously recorded data
- ⊕ Centerline
- P.O.B. Point of Beginning
- P.O.T. Point of Termination
- R/W Right-of-Way line
- Doc. Document
- C.S.M. Certified Survey Map
- U.S.P.L.S. United States Public Land Survey

**FOREST CO SURVEYOR**  
FILE # 361330-20260210  
DATE 02/18/2026 BY JA

East 1/4 Corner Section 30  
per U.S.P.L.S. Monument Record.  
Mag nail, found.  
See current Monument Record.

Project : 2025-47-Tupper Line
Drawn by: Jeffrey L. DeMuth
Checked by: James E. Anderson
Fieldwork completed: February 2026
Sheet 1 of 1 Sheets

CLIENT:  
David Tupper  
SITE ADDRESS:  
110 Railway Lane  
Crandon, WI 54520

## LINE SURVEY



4327 COLE ROAD  
CRANDON, WI 54520  
Anderson 715.784.3485  
DeMuth 715.482.5237  
cardinal.north@outlook.com