

PART OF THE  
SW 1/4 OF THE SW 1/4  
SECTION 5, T.36N. R.13E.  
TOWN OF LINCOLN  
FOREST COUNTY, WISCONSIN

Document No. 219278

Part of the SW1/4 of the SW1/4 Section 5, Township 36 North Range 13 East, Town of Lincoln, Forest County, Wisconsin, described as follows:  
Commencing at the West Quarter Corner of said Section 5;  
Thence S 4°29'10" W, 1287.30' to the S1/16 Corner of said Section 5, the Point of Beginning;  
Thence N 89°37'53" E, 1246.41' to the SW1/16 Corner of said Section 5;  
Thence S 00°46'51" W, along the east line of the SW1/4 of the SW1/4 of said Section 5, 328.68';  
Thence S 89°37'53" W, 412.80';  
Thence S 89°34'42" W, 855.00' to the West Line of the SW1/4 of said Section 5;  
Thence N 04°29'10" E, along the West line of the SW1/4 of Section 5, 330.59' to the S1/16 Corner and the Point of Beginning.  
Said parcel contains 413,430 Square Feet, 9.49 Acres more or less.  
Together with and subject to easements and restrictions of record or of use.

Document No. 202420

Part of the SW1/4 of the SW1/4 Section 5, Township 36 North Range 13 East, Town of Lincoln, Forest County, Wisconsin, described as follows:  
Commencing at the West Quarter Corner of said Section 5;  
Thence S 4°29'10" W, 1287.30' to the S1/16 Corner of said Section 5; Thence continuing S 4°29'10" W, 330.59'; Thence N 89°34'42" E, 855.00' to the Point of Beginning;  
Thence N 89°37'53" E, 412.80' to the East Line of the SW1/4 of the SW1/4 of said Section 5;  
Thence S 00°46'51" W along the East Line of the SW1/4 of the SW1/4 of said Section 5, 968.77' to the W1/16 Corner of said Section 5;  
Thence S 89°34'42" W, along the South Line of the SW1/4 of said Section 5 1330.66' to the SW Corner of said Section 5;  
Thence N 04°29'10" E, along the West Line of said Section 5, 331.50';  
Thence N 89°34'42" E, 855.00';  
Thence N 04°29'10" E, 641.00' to the Point of Beginning;  
Said parcel contains 712,748 Square Feet, 16.36 Acres more or less.  
Together with and subject to easements and restrictions of record or of use.

SURVEYOR'S CERTIFICATE

I, Jeffrey T. Brock, Wisconsin Professional Land Surveyor S-2642, by the order of Leslie O. Ison and Joyce E. Ison: I hereby certify to the best of my knowledge and belief; that I have surveyed and mapped the property shown hereon; that this map represents an accurate survey of said property; and that I have complied with the applicable requirements of Wisconsin Administrative Code A-E 7.

Jeffrey T. Brock 7/25/2023

Jeffrey T. Brock, PLS 2642  
JTB Land Surveying, LLC  
Rhinelander, WI



SOUTHWEST CORNER  
SURVEY NAIL, SET

CORNER BY PRIES  
FALLS  
S 27°43'10" W  
44.37'

WEST 1/4 CORNER  
ALUMINUM  
CAPPED MONUMENT

CURVE	RADIUS	ARC LENGTH	CHORD LENGTH	CHORD BEARING	DELTA ANGLE
C1	2814.90'	334.39'	334.20'	N 08°21'09" E	6°48'23"
C2	2814.90'	677.37'	675.74'	N 18°38'59" E	13°47'15"
C3	2814.90'	92.06'	92.05'	N 26°28'49" E	1°52'26"
C4	2764.90'	315.77'	315.60'	N 30°41'20" E	6°32'37"

LOT 4 CSM V. 4 P. 79  
DOC# 138485

SW 1/16 CORNER  
(By Others)

CS 1/16 CORNER  
S 89°27'11" E 1265.78'

DOC # 219278  
413,430 Sq. Ft.  
9.49 Acres including  
Highway R/W  
302,743 Sq. Ft.  
6.95 Acres excluding  
Highway R/W

DOC # 202420  
712,748 Sq. Ft.  
16.36 Acres including  
Highway R/W  
692,366 Sq. Ft.  
15.89 Acres excluding  
Highway R/W

LEGEND

- 3/4 INCH REBAR, FOUND
- 2 INCH IRON PIPE, FOUND
- 1 INCH IRON PIPE, FOUND
- 1-1/2 INCH IRON PIPE, FOUND
- 1-1/4 INCH IRON PIPE, SET
- COMPUTED POSITION  
(NOT MUNUMENTED)
- R/W POST

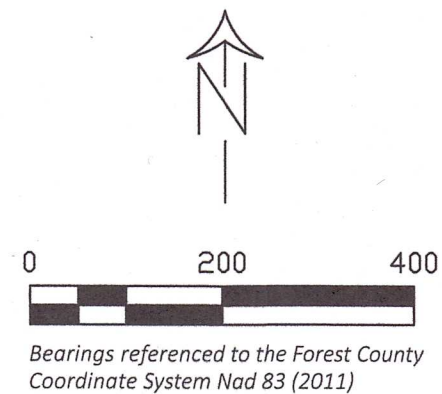

FOREST CO SURVEYOR  
FILE # 361305 - 2023 0725  
DATE 03/20/2025 BY JA

S1/4 CORNER  
ALUMINUM MONUMENT  
FOUND