

# RETRACEMENT SURVEY - REVISED

REVISED TO ADD ONE IRON ROD NEAR THE SHORE PER CLIENTS REQUEST  
THOSE LANDS DESCRIBED IN DOCUMENT NUMBER 215147  
BEING LOT 25, OF BLOCK 4 OF THE SIXTH ADDITION TO SILVER LAKE PARK,  
BEING PART OF GOVERNMENT LOT 1, SECTION 35, TOWNSHIP 36 NORTH,  
RANGE 14 EAST, FOURTH PRINCIPAL MERIDIAN,  
TOWN OF LAONA, FOREST COUNTY, WISCONSIN

FOREST CO SURVEYOR

FILE # 361435-20251002

DATE 10/02/2025 BY JA

Bearings are referenced to:  
The Wisconsin Coordinate  
Reference System,  
Forest County Zone,  
and the west line of the  
NW 1/4 of Section 35  
Measured to bear  
S00°20'59"E

## SURVEYOR'S CERTIFICATE

I, Jeffrey L. DeMuth, Professional Land Surveyor S-2656 of the State of Wisconsin, do hereby certify to my client, The Town of Laona, the Owners and under whose direction this survey was performed, that I have surveyed, mapped, and described those lands described in document number 215147; being Lot 25, of Block 4, of the Sixth Addition of Silver Lake Park, being part of Government Lot 1, Section 35, Township 36 North, Range 14 East, Fourth Principal Meridian, Town of Laona, Forest County, Wisconsin.

That said parcel contains 0.51 acres of land more or less.  
Said parcel is subject to easements, restrictions, reservations and rights-of-way of record, if any.

That this Map is a true and correct representation of the exterior boundaries of lands surveyed, and that I have fully complied with Chapter A-E 7 of the Wisconsin Administrative Code, to the best of my knowledge and belief.

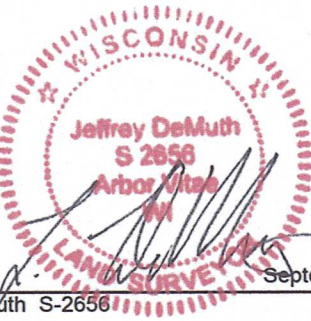

## LEGEND

Monument sizes = outside diameter measurements.

- 0.75" diameter X 18" long iron rod, weighing 1.5 lbs. per lineal foot, set
- ⊙ 1.4" diameter iron pipe, found
- 2" diameter iron pipe, found
- ⊙ 1.75" diameter iron pipe, found
- ⊗ Railroad spike, found
- ▲ Mag nail, found
- △ Computed position, not set
- ⊙ Mag nail, set over found 2" diameter iron pipe
- ⊙ U.S.P.L.S. monument, as noted
- ( ) Previously recorded data
- ℄ Centerline
- R/W Right-of-Way line
- C.S.M. Certified Survey Map
- U.S.P.L.S. United States Public Land Survey
- S.F. Square feet

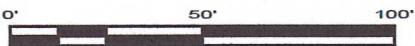

Any land below the ordinary high water mark of a lake or a navigable stream is subject to the public trust in navigable waters that is established under article IX, section 1, of the state constitution.

Northwest Corner Section 35  
per "Preservation of Landmarks"  
Found & verified 0.75" diameter  
iron rod with a red plastic cap.

Section 34  
Section 35

N 89°39'01" E  
214.41'

S 00°20'59" E  
413.79'

West 1/4 Corner Section 35  
per U.S.P.L.S. Monument Record  
Found & verified 2.5" diameter  
aluminum capped monument,

Found MAG nail  
S 20°20'39" W, 9.49'  
from set iron rod.

Found 1.75" x 1.75"  
Plastic "survey mark" stake  
S 72°45'40" E, 1.74'  
from found iron pipe.

Part of Lot 12  
Block 1  
Document #238467

Lot 1  
C.S.M. Volume 4 Page 173  
Doc. #146363

Lot 24 Block 4  
Document #180839

Lot 2 Block 2  
Document #230310

Lot 1 Block 2  
Document #230310

Found iron pipe  
S 48°17'55" W, 3.31'  
from set iron rod.

Found 1.75" x 1.75"  
Plastic "survey mark" stake  
S 35°30'33" E, 0.43'  
from computed spot.

RETRACEMENT  
SURVEY

CLIENT:  
Town of Laona  
SITE ADDRESS:  
5128 West Silver Lake Road  
Laona, WI 54541

Project : 2025-27-Laona Boat Landing  
Drawn by: Jeffrey L. DeMuth  
Checked by: James E. Anderson  
Fieldwork completed: September 2025  
Sheet 1 of 1 Sheets

4327 COLE ROAD  
CRANDON, WI 54520  
Anderson 715.784.3485  
DeMuth 715.482.5237  
cardinal.north@outlook.com

cardinal North, LLC  
ENGINEERING | SURVEYING | DRONE