

PLAT OF SURVEY U.S. GOVERNMENT LAND

Sheet one of four

BEING THE SW 1/4, THE NW 1/4, THE NE 1/4, AND THE
E 1/2 OF THE SE 1/4 OF SECTION 6, TOWNSHIP 34 NORTH,
RANGE 16 EAST, 4TH PRINCIPAL MERIDIAN, FOREST
COUNTY, WISCONSIN

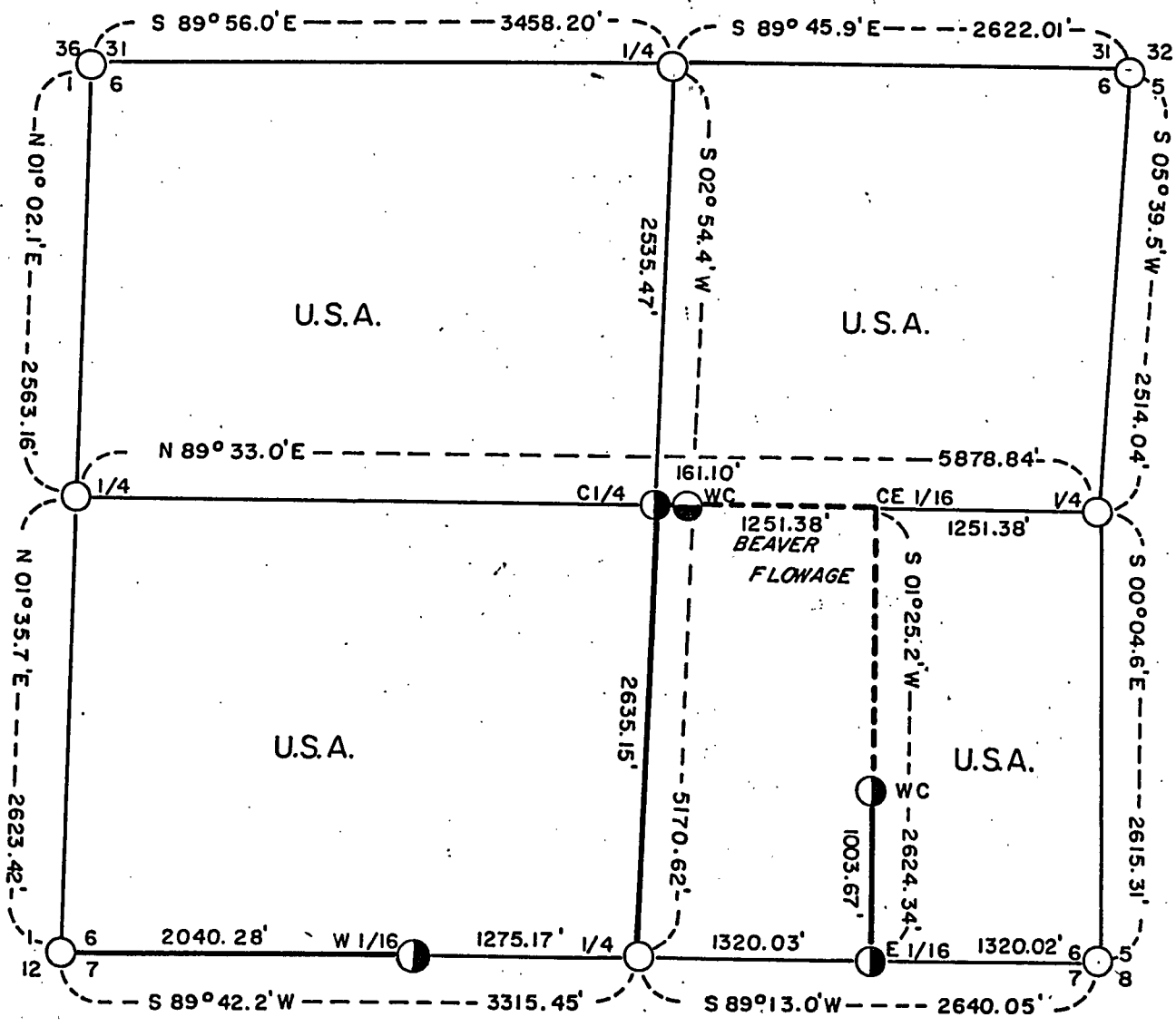

LEGEND

- Existing Forest Service Monuments
- Set 2" Diameter Aluminum Monument, 36" Long
- ◐ Set 2" Diameter Aluminum Monument, 60" Long
- Marked Boundary Lines of U.S. Government Lands

CONVERSION FACTOR:
Feet to Meters = 0.3048
Meters to Feet = 3.280833

Stock No. 26273

Sheet two of four

SURVEY NOTES

This survey was made by AARON ASSOCIATES of Oconto Falls, Wisconsin under contract with the U.S. Department of Agriculture, Forest Service, using Forest Service section subdivisional data for the purpose of establishing subdivisional corners within Section 6, and for locating and marking the boundaries of U.S. Government lands on their perimeter and within Section 6, Township 34 North, Range 16 East, 4th Principal Meridian, Forest County, Wisconsin.

The U.S. Government lands were acquired in 1934-1935-1964.

The Original Government Survey of this township was made in 1859.

The corner positions recovered, restored and established by this survey are marked with monuments described in the map legend.

The corner positions established by this survey were located to an accuracy of one part in 3000.

The bearings between corner positions are True Bearings as determined by Solar observations.

The field notes of this survey and a copy of the plat map are on file in the Forest Supervisor's Office at Rhinelander, Wisconsin.

CORNERS RECOVERED AND RESTORED

1. Section Corner to Sections 36-31-6-1 of T35N, R15E; T35N, R16E; T34N, R15E; and T34N, R16E Respectively.
Corner position found marked with a Forest Service monument.
Certificate on file in the Forest County courthouse.
2. Section Corner to Sections 31-32, T35N, R16E, and 5-6, T34N, R16E.
Corner position found marked with a Forest Service monument.
Certificate on file in the Forest County courthouse.
3. Section Corner to Sections 5 -6 - 7-8, T34N, R16E.
Corner position found marked with a Forest Service monument.
Certificate on file in the Forest County courthouse.
4. Section Corner to Sections 6 -7, T34N, R16E and 11-12, T34N, R15E.
Corner position found marked with a Forest Service monument.
Certificate on file in the Forest County courthouse.
5. Quarter Corner to Sections 6-31, T34N, R16E, T35N, R16E. Respectively.
Corner position found marked with a Forest Service monument.
Certificate on file in the Forest County courthouse.
6. Quarter Corner to Sections 5 -6, T34N, R16E.
Corner position found marked with a Forest Service monument.
Certificate on file in the Forest County courthouse.
7. Quarter Corner to Sections 6 - 7, T34N, R16E.
Corner position found marked with a Forest Service monument.
Certificate on file in the Forest County courthouse.

Stock No. 26273

Sheet three of four

8. Quarter Corner to Sections 1-6, T34N, R15E and T34N, R16E Respectively.

Corner position found marked with a Forest Service monument.
Certificate on file in the Forest County courthouse.

CORNERS ESTABLISHED9. West Sixteenth Corner between Sections 6-7, T34N, R16E.

Set this corner position at single proportionate position along the north line of Section 7 as determined by the Forest Service.
Corner references:

Red Maple	9"	N58E	13.88 ft.
Sugar	11"	S45W	47.51 ft.
Sugar	6"	N74W	37.62 ft.
Sign Post		South	0.80 ft.

10. East Sixteenth Corner between Sections 6-7, T34N, R16E.

Set this corner position at midpoint between the south quarter and southeast corners of Section 6 as determined by the Forest Service.
Corner references:

Popple	6"	S10E	45.56 ft.
Popple	5"	S58W	47.29 ft.
Sign Post		North	1.07 ft.

11. Center Quarter Corner of Section 6, T34N, R16E.

Set this corner position at the straight line intersection of quarter lines in Section 6 as determined by the Forest Service.
Corner references:

Elm	8"	N15E	6.51 ft.
Sugar	6"	S75W	11.96 ft.
Sugar	4"	S08W	17.98 ft.
Sign Post		East	1.12 ft.

12. Center-East Sixteenth Corner of Section 6, T34N, R16E.

This corner position was determined at the midpoint of the east-west quarter line of Section 6 between the center and east quarter corners. This corner fell in a beaver flowage which was inaccessible and Witness Corners were set to the west and south of this position as follows:

Witness Corner West: 1090.28 ft.

Corner references:

Cedar	7"	S42E	37.65 ft.
Cedar	5"	S07E	32.62 ft.
Cedar	4"	S08W	36.74 ft.
Sign Post			

Witness Corner South: 1620.67 ft.

Corner references:

Cherry	10"	N50W	17.95 ft.
Cherry	6"	S32W	68.81 ft.
Black Spruce	5"	N57E	18.83 ft.
Sign Post		North	0.82 ft.

Stock No. 26273

Sheet four of four

SURVEYOR'S AFFIDAVIT

STATE OF WISCONSIN)
COUNTY OF FOREST)SS

I, Kim H Pritzlaff, Registered Land Surveyor, in the State of Wisconsin hereby certify: that I have surveyed and subdivided Section 6, Township 34 North, Range 16 East, 4th Principal Meridian, Forest County, Wisconsin.

That the Plat map and notes herewith are a true and correct representation of the land surveyed and subdivided using Forest Service section data and that I have surveyed and subdivided said Section 6 in accordance with the rules of survey of the public lands and with the Statutes of the State of Wisconsin.

Date of Survey: 1986.

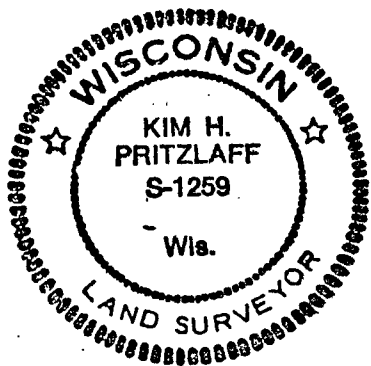

Kim H. Pritzlaff

Kim H Pritzlaff, RLS No. 1259
AARON ASSOCIATES
Oconto Falls, Wisconsin

Plat ready for filing *Dale Staege*
District Ranger

