

34327-20210613

RECEIVED

AUG 12 21

CO. TREASURER

LOCATION \ DESCRIPTION

THE EAST 500 FEET OF THE WEST 1510 FEET OF THE NORTH HALF OF THE NORTHWEST QUARTER, ALSO KNOWN AS GOVERNMENT LOT 1 AND 2, LYING NORTHERLY OF COUNTY HIGHWAY "DD", SECTION 27, T34N-R13E, TOWN OF NASHVILLE, FOREST COUNTY, WISCONSIN.

NORTHWEST CORNER
SEC. 27, T34N-R13E

N86°11'23"E
500.00'

165.89'
194.00'

NORTH QUARTER CORNER
SEC. 27, T34N-R13E

PARCEL 1
4.06 ACRES

PARCEL 2
3.00 ACRES

017.001
22-1614

018

22-1626

N78°15'00"W

248.44'

C.T.H. "DD"

N69°29'54"W

119.09'

183.67'

N65°05'13"W

88.71'

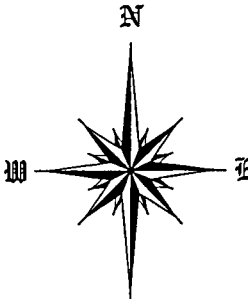

REF. NORTH LINE, NORTHWEST
QUARTER ASSUMED TO BEAR
N86°11'23"E

LEGEND

- SET 3/4" x 18" REBAR
(WT. 1.50 LBS/FT)
- FOUND 1" PIPE
- FOUND 1" PIPE w/ 4" ALUMINUM CAP

SCALE: 1" = 60'
DATE: JUNE 13th, 2021 A.D.
FIELDWORK PERFORMED ON JUNE 14th, 2021 A.D.

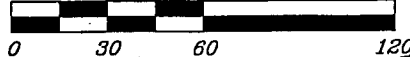

SURVEYORS' CERTIFICATE

I, JEFFREY M. LIEUWEN, PROFESSIONAL LAND SURVEYOR, S-2617, CRIVITZ, WISCONSIN, CERTIFY THAT I HAVE SURVEYED AND MAPPED THE HEREON DESCRIBED AND DEPICTED LANDS TO MY BEST KNOWLEDGE AND BELIEF.

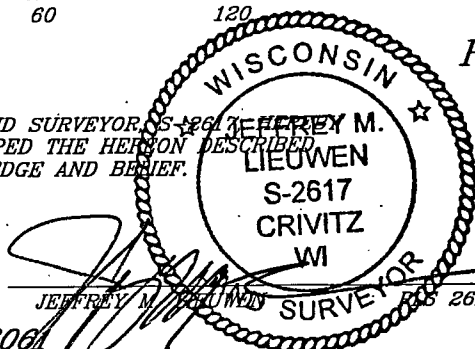

ROB KAMPS LAND SURVEYING

JEFFREY M. LIEUWEN, PLS
P.O. BOX 303
CRIVITZ, WISCONSIN 54114-0303
robkampslandsurveying@gmail.com

SURVEYED BY THE ORDER OF:

TIMOTHY DIERS
5957 E. WATERFORD ROAD
HARTFORD, WISCONSIN 53027

KAMPS OFFICE MAP NUMBER 21-6061

Rob Kamps Land Surveying

Jeffrey Lieuwen, PLS

P.O. Box 303, Crivitz, Wisconsin 54114-0303

(715) 854-2200

robkampslandsurveying@gmail.com

Date: June 13th, 2021 A.D.

Timothy Diers

5957 E. Waterford Road

Hartford, Wisconsin 53020

RE: Parcel 2, Diers Parcel

Description:

That part of the East 500 feet of the West 1510 feet of the North Half of the Northwest Quarter, also known as Government Lots 1 & 2, lying northerly of County Highway "DD", Section 27, T34N-R13E, Town of Nashville, Forest County, Wisconsin described as: Commencing at the Northwest Corner of said Section 27, as marked by a 1 inch pipe with 4 inch aluminum cap; thence N86°11'23"E 1316.00 feet to a 1 inch pipe at the Point of Beginning of this Description; thence N86°11'23"E 194.00 feet to a ¾ inch rebar; thence S00°58'49"W 722.95 feet to a ¾ inch rebar on the northerly right-of-way of County Highway "DD"; thence N65°05'13"W along said northerly line, 88.71 feet to a ¾ inch rebar; thence N69°29'54"W 119.09 feet to a ¾ inch rebar; thence N00°58'49"E 630.96 feet to the ¾ inch rebar at the Point of Beginning. Contains 3.00 Acres.

Dated this 13th day of June, 2021 A.D.

Jeffrey M. Lieuwen

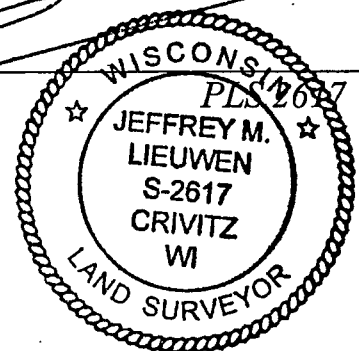

Rob Kamps Land Surveying

Jeffrey Lieuwen, PLS

P.O. Box 303, Crivitz, Wisconsin 54114-0303

(715) 854-2200

robkampslandsurveying@gmail.com

Date: June 13th, 2021 A.D.

Timothy Diers

5957 E. Waterford Road

Hartford, Wisconsin 53020

RE: Parcel 1, Collura Home

Description:

That part of the East 500 feet of the West-1510 feet of the North Half of the Northwest Quarter, also known as Government Lots 1 & 2, lying northerly of County Highway "DD", Section 27, T34N-R13E, Town of Nashville, Forest County, Wisconsin described as: Commencing at the Northwest Corner of said Section 27, as marked by a 1 inch pipe with 4 inch aluminum cap; thence N86°11'23"E 1010.00 feet to a 1 inch pipe at the Point of Beginning of this Description; thence N86°11'23"E 306.00 feet to a ¾ inch rebar; thence S00°58'49"W 630.96 feet to a ¾ inch rebar on the northerly right-of-way of County Highway "DD"; thence N69°29'54"W along said northerly line, 64.58 feet to a ¾ inch rebar; thence N78°15'00"W 248.44 feet to a ¾ inch rebar; thence N00°58'49"E 537.40 feet to the ¾ inch rebar at the Point of Beginning. Contains 4.06 Acres.

Dated this 13th day of June, 2021 A.D.

Jeffrey M. Lieuwen

