

St. Johns Lake

The center of the septic tank vent is 7.8' from the property line.

septic tank

garage

KLAPPER
Vol. 122, Pg. 249

approximate perimeter of mound system

WALVOORT
Vol. 229, Pg. 445

Iron pipe to iron pipe = N64°05'00"E, 590.03'

LEGEND

- ⊙ 1 3/4" iron pipe found
- 1/2" iron rod found
- ⊕ fence post set on line
- line surveyed

Bearings are referenced to the Plat of Survey by Michael E. Trembl, and existing deeds and were not tied to an exterior section line.

I, David E. Tlusty, Registered Land Surveyor, do hereby certify that, by the direction of Dan and Robin Walvoort, I have made a survey of their north property line, as shown on a Plat of Survey for Dennis Klapper, said survey dated May 16, 2001 by Michael A. Trembl, RLS-2197. Said line is depicted on said survey as the South line of a parcel described in a deed recorded in Volume 122, Page 249 and as the North line of parcel described in a deed recorded in Volume 229, Page 445, Forest County records. I have made this survey for the sole purpose of adding monumentation along this common line as shown hereon. I further certify that this map is a true and correct representation of said survey, that I have complied with the provisions of Chapter AE-7 of the Wisconsin Administrative Code and that this survey is correct to the best of my knowledge and belief.

January 12, 2007

David E. Tlusty
Wisconsin Registered Land Surveyor S-1390

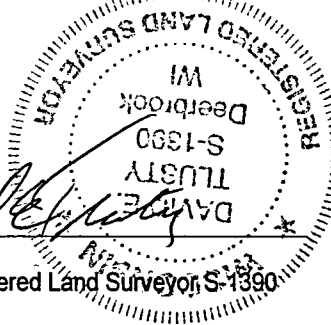

David E. Tlusty, RLS
Deerbrook, Wisconsin 54424

Survey for Dan & Robin Walvoort
Part of Gov't. Lot 3, Section 9,
Township 34 North, Range 13 East,
Town of Nashville, Forest County, WI.

FOREST CO SURVEYOR
FILE # 34309-20076112
DATE _____ BY _____

SCALE: 1" = 50'	DATE: 01/12/07	DRAWN BY: dt	MAP #:
--------------------	-------------------	-----------------	--------

FOR: FOREST CO. SURVEY RECORDS

David E. Thusty, RLS

N5134 USH 45 Deerbrook, WI 54424

Wisconsin Registered Land Surveyor S-1390

Telephone (715) 627-2611

January 14, 2007

Dan & Robin Walvoort
2980 W. Northland Ave.
Appleton, WI 54914

Dear Dan & Robin,

Enclosed you will find a map that I created as the result of survey work along your north property line at St. Johns Lake in the Town of Nashville, Forest County, WI. The map shows the location of steel fence posts set along the line.

While I was on this project and reviewing your deed, I find that an existing map of survey dated May 16, 2001, by surveyor Michael Treml, showing your neighbors (Dennis Klapper) property, also shows a dashed line around your property. I've enclosed a copy of the Treml survey map and the dashed line with "Vol. 229 Pg. 445" appears to be an accurate representation of your property lines. I have not located this line on the ground to check for encroachments or other problems. As you suspected and my computations confirm, your property appears to encompass 3.8 acres. The amount of right-of-way of CTH "Q" that is within your description could only be determined by survey and that would be deducted from the 3.8 acres. I don't know how Forest County came up with your acreage as being 15 acres shown on your tax bill, but I am sure that number is wrong. As you requested, I am sending a copy of these maps and this letter to the Forest County Property lister so that they can advise the Assessor of this problem with acreage and can adjust that number in the tax roll to more accurately reflect the correct area of 3.8 acres.

I am also sending a copy of my map to "Forest County Survey records" at the Courthouse. Please give me a call if you have any question or need further assistance with this matter. Thanks for contacting me to do this work!

Sincerely yours,

David E. Thusty, RLS

enc.

cc: Forest County Prop. Lister w/copies

Forest County Survey records w/copies copy For Your Records.