

U.S. PUBLIC LAND SURVEY MONUMENT RECORD

Index No. J-17

State of Wisconsin }
County of Forest } ss.

I, Gary L. Pisoni, do hereby certify that on the 9th day of September, 1989, I found evidence of the Northeast Section corner of Section 15 Township 40 North, Range 14 East, Fourth Principal Meridian, as described hereon; and that from this evidence I established a new monument and accessories as described hereon to perpetuate the original location of this corner.

Resident witnesses:

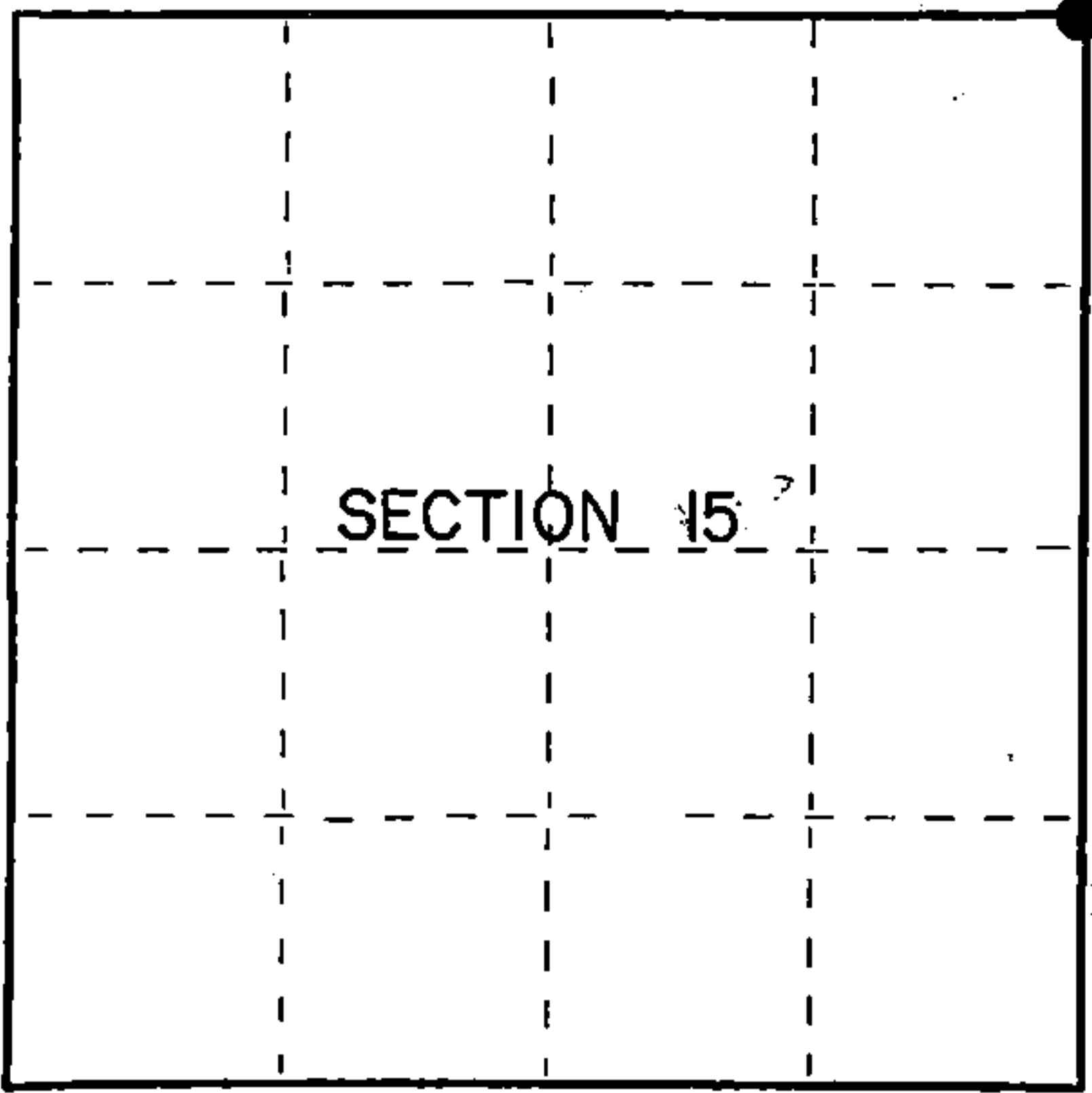

● = Corner monument restored.

History of original corner establishment:

Dependent Resurvey in 1945 by Hugh B. Crawford. North between Sections 14 and 15, 80.36 chains, proportionate distance for position in latitude and on the line projected from the south half of Sections 14 and 15, the point for corner is not monumented.

In 1969, Jean Resvick, a Land Surveyor with the U.S. Forest Service, re-established the corner position using GLO recorded bearing and distance from the Quarter corner between Sections 14 and 15. At the corner position set a 6" diameter concrete monument, 30" long, with a brass cap stamped to identify corner. Blazed and scribed the following;

Description of corner evidence found:		Bearing	Distance	Notes
White Spruce		N.31°E.	118.84 feet	Local B.T.s
Elm	5"	S.42°30'W.	65.09 feet	
W. Spruce	6"	S.64°30'W.	55.49 feet	
W. Spruce	5"	N.39°30'W.	48.35 feet	
4"x4" Cedar Post		East	30.00 feet	
C/L of Road		West	3.00 feet	

Found concrete monument broken off, from which the following bear;

Spruce	10"	N.31 E.	118.84 feet
Spruce	9"	N.39 W.	48,35 feet

Description of monument and accessories I established to perpetuate the original location of this corner.

I replaced the damaged monument with a 2½ inch diameter aluminum pipe monument, 3 feet long, 8 inches below the surface of the road, with an aluminum cap stamped; T40N, R14E, S10, S11, S14, S15, 1989, S-1634. From which the following new blazed and scribed bearing trees bear(all measurements taken to a nail in side of tree): -

White Spruce	13"	S.52°W.	41.35 feet
Sugar Maple	12"	N.78°E.	26,28 feet

Dated at Iron River, MI, Wis., this 2nd day of November, 1989.

Signature: Gary L. Pisoni Title: Land Surveyor Registration No. S-1634
(County Surveyor, Registered Land Surveyor, or other duly authorized official)

Office of Register of Deeds, County of Forest, I hereby certify that the within instrument was filed in this office for record on the 20th day of September, 1990 at 10:45 o'clock A.M.

(Register of Deeds)
By: Hal Chitko Deputy

FORM NO. 985-A
H.C. Miller Company

Stock No. 26273

DOCUMENT NUMBER
140469

44014180000

(e) Describe any material discrepancy between the location of the corner as restored or reestablished and the location of that corner as previously restored or reestablished by distance and direction. Show the discrepancy on the plan view drawing under (d), above. Show the distances between the corner as previously restored or reestablished and (1) the corner as restored or reestablished, and (2) to at least 2 of the witness monuments shown on the drawing in (d), above.

See drawing below.

(f) Was the corner restored through acceptance of (1) an obliterated evidence location, or, (2) a found perpetuated location?

Restored through acceptance of a found perpetuated location.

(g&h) Was the corner reestablished through lost corner proportionate methods? If so, show the method, including the directions and distances to other public land survey corners used as evidence or used for proportioning in determining the corner location?

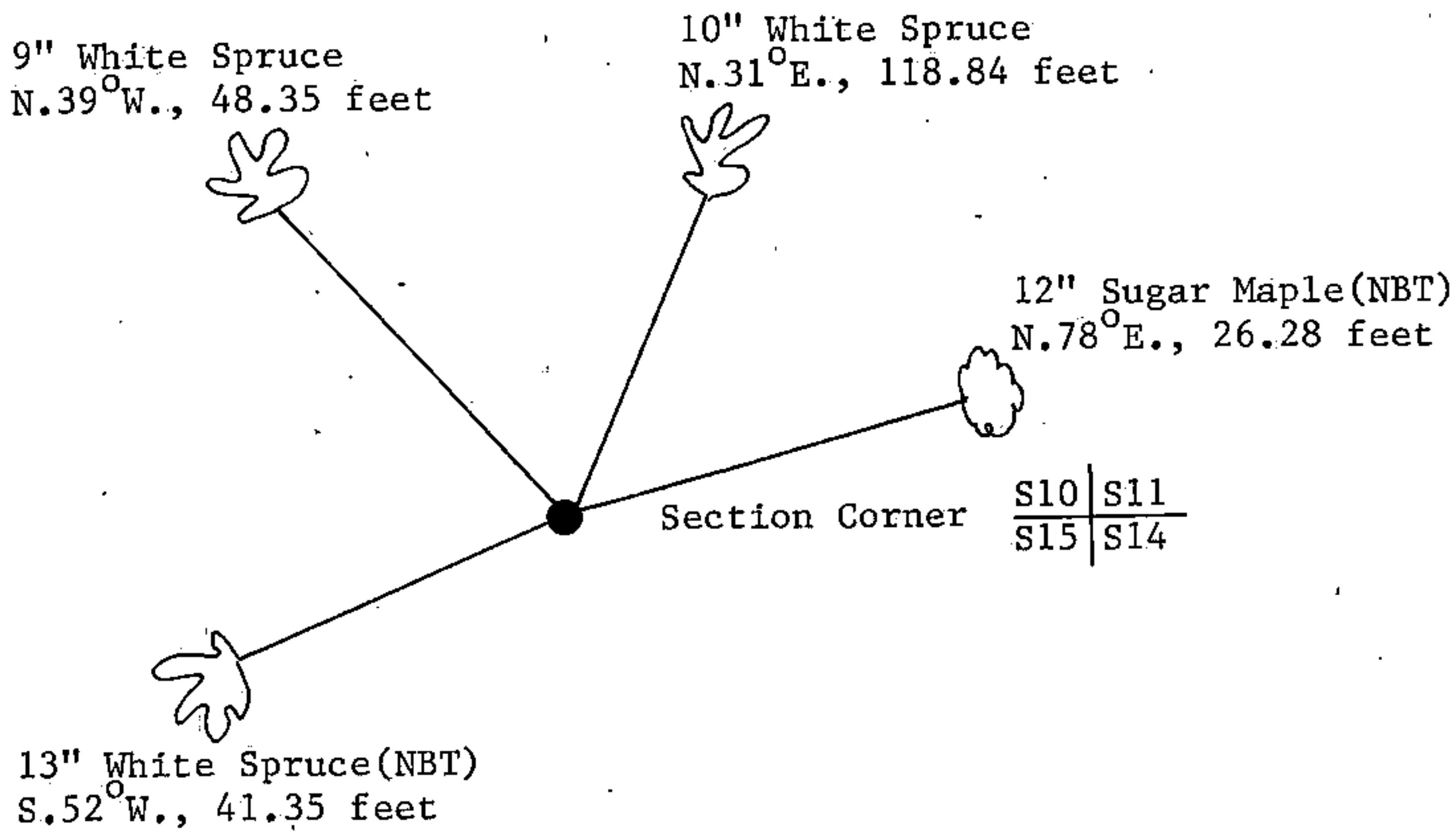

(i) I, Gary L. Pisoni
 (type or print name) certify that the corner location shown on this record was determined by me or under my direction and control and that this U.S. Public Land Survey Monument Record is correct and complete to the best of my knowledge and belief.

Gary L. Pisoni Signature Jan 12 1990 Date

Survey requested by: _____
 District Ranger Date