

U.S. PUBLIC LAND SURVEY MONUMENT RECORD

State of Wisconsin }  
County of Forest } ss.

I, Gary L. Pisoni, do hereby certify that on the 15 day of August, 1989, I found evidence of the West Quarter corner of Section 9 Township 40 North, Range 14 East, Fourth Principal Meridian, as described hereon; and that from this evidence I established a new monument and accessories as described hereon to perpetuate the original location of this corner.

Resident witnesses:

.....  
.....  
.....

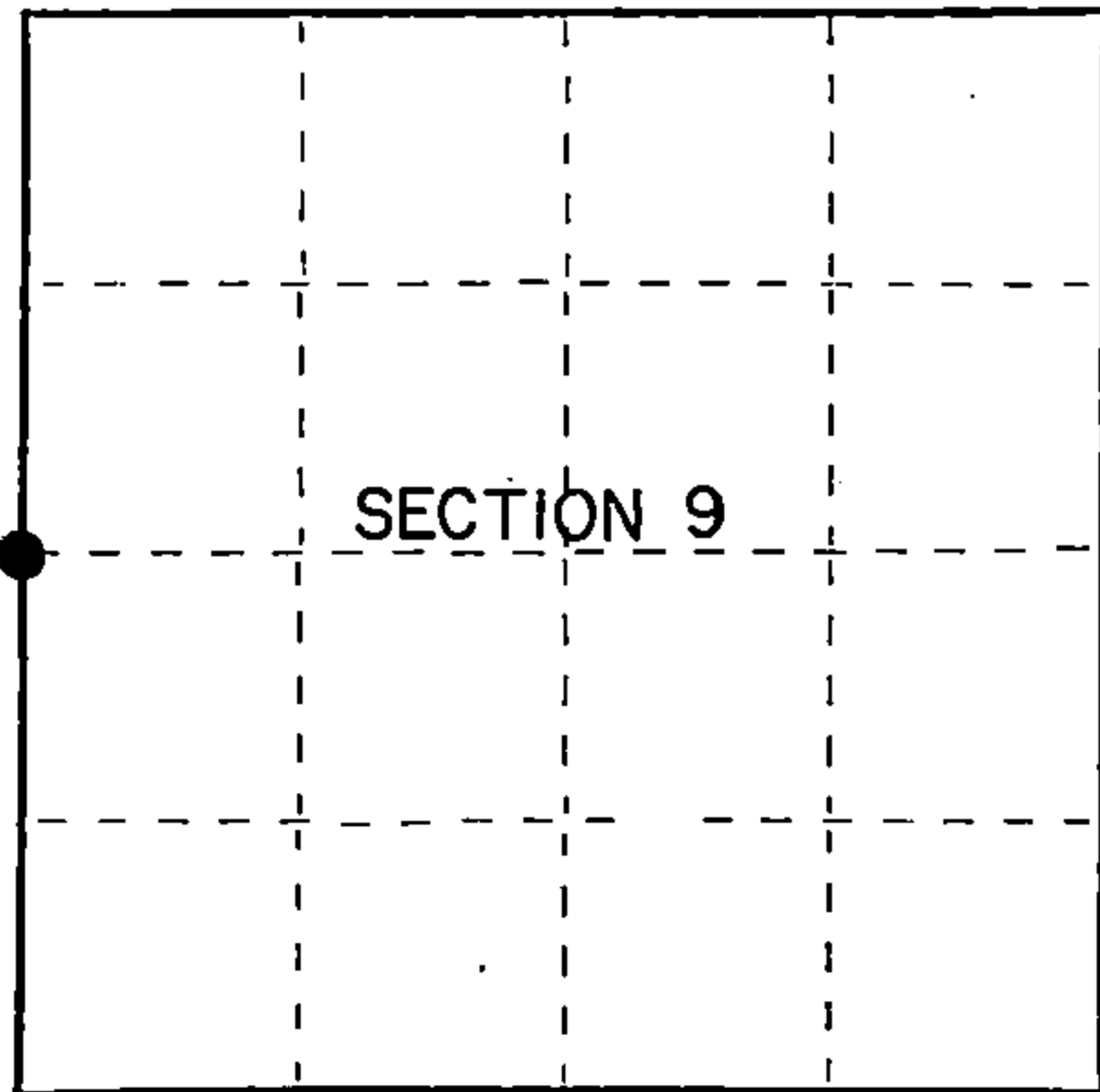

● = Corner monument restored.

History of original corner establishment:

Original Government Survey in 1865 by William E. Daugherty.

Re-establishment of a portion of the subdivisional and meander lines in Sections 7 and 8, done in 1924 by Robert W. Livingston. N.06°19'E., 38.95 chains, between Sections 8 and 9, set the corner at proportionate distance, from which the following bear;

White Pine	6"	S.56°E.	36 links
White Pine	10"	S.83°W.	29 links

Description of corner evidence found: In 1972, Jean Resvick, a Land Surveyor with the U.S. Forest Service, blazed and scribed the following;

Maple	6"	N.86°E.	20.10 feet
Maple	6"	N.35°W.	23.10 feet
Steel Sign Post		East	1.00 feet

Found a 2 inch diameter iron pipe monument 10 inches above ground surface on the West side of a woods road and stamped as follows; U.S. General Land Office, 1/4, S8, S9, 1924.

All bearing trees are dead or missing.

Description of monument and accessories I established to perpetuate the original location of this corner.

Blazed and scribed the following new bearing trees(measurements taken to a nail in side of tree):

Popple	3"	S.76°W.	10.85 feet
Steel Sign Post		S.02°E.	0.92 feet
Steel Sign Post		N.47°W.	2.45 feet

Dated at Iron River, MI, Wis, this 2nd day of November, 1989

Signature Gary L. Pisoni Title Land Surveyor Registration No. S-1634  
(County Surveyor, Registered Land Surveyor, or other duly authorized official)

Office of Register of Deeds, County of Forest, I hereby certify that the within instrument was filed in this office for record on the 20th day of September, 1989 at 10:45 o'clock A.M.

(Register of Deeds)  
By Carol Chitko Deputy

FORM NO. 985-A

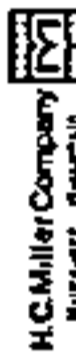

Stock No. 26273

DOCUMENT NUMBER

140465

4404082000

(e) Describe any material discrepancy between the location of the corner as restored or reestablished and the location of that corner as previously restored or reestablished by distance and direction. Show the discrepancy on the plan view drawing under (d), above. Show the distances between the corner as previously restored or reestablished and (1) the corner as restored or reestablished, and (2) to at least 2 of the witness monuments shown on the drawing in (d), above.

See drawing below.

(f) Was the corner restored through acceptance of (1) an obliterated evidence location, or, (2) a found perpetuated location?

Restored through acceptance of a found perpetuated location,

(g&h) Was the corner reestablished through lost corner proportionate methods? If so, show the method, including the directions and distances to other public land survey corners used as evidence or used for proportioning in determining the corner location?

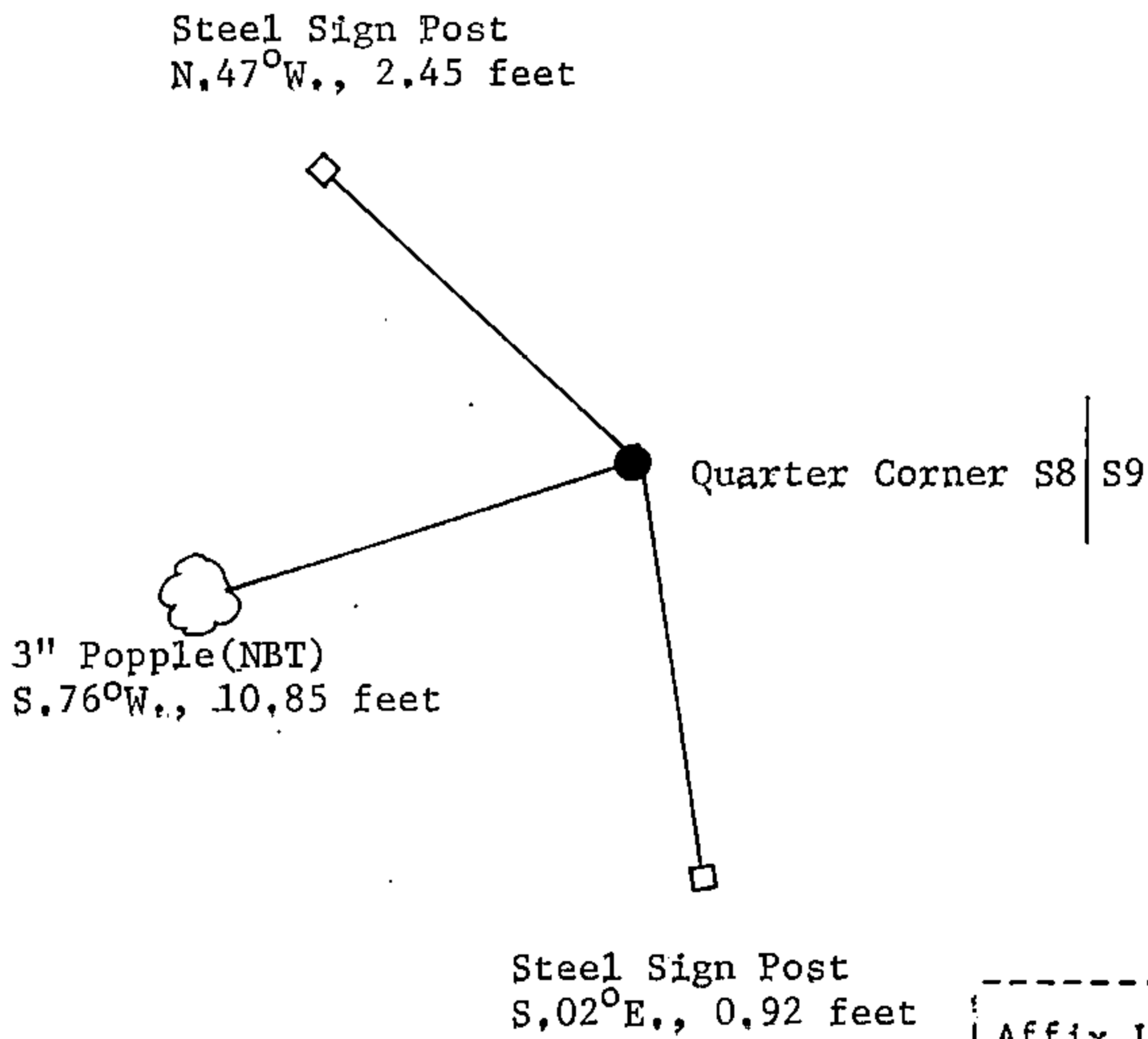

(i) I, Gary L. Pisoni  
 (type or print name) certify that the corner location shown on this record was determined by me or under my direction and control and that this U.S. Public Land Survey Monument Record is correct and complete to the best of my knowledge and belief.

Signature Gary L. Pisoni Date Jan 12 1990

Survey requested by: [Signature] Date 9-18-90  
 District Ranger