

U.S. PUBLIC LAND SURVEY MONUMENT RECORD

Index No. J-5

State of Wisconsin }
County of Forest } ss.

I, Gary L. Pisoni, do hereby certify that on the 9th day of September, 1989, I found evidence of the Northeast section corner of Section 18 Township 40 North, Range 14 East, Fourth Principal Meridian, as described hereon; and that from this evidence I established a new monument and accessories as described hereon to perpetuate the original location of this corner.

Resident witnesses:

History of original corner establishment:

Original Government Survey in 1865 by William E. Daugherty.

In 1970-71, Jean F. Resvick, Land Surveyor for the U.S.F.S. restored this corner position with a 6" diameter by 3' long concrete post with a 3" diameter brass tablet embedded in concrete, corner restored at record distances from recovered meander corner on South shore of Animush Lake in accordance with the GLO 1925 supplemental plat of Sections 7-8, from which the following bear: Elm 5" N 37° E 51.2 feet, Maple 4" S 51° E 73.7 feet, Maple 4" S 55° W 44.3 feet, Maple 8" N 86° W 34.2 feet, Cedar sign post East 15 feet

Description of corner evidence found:

Found the monument as described above, from which the following bear:			
Maple	6"	S 51° E	73.92 feet
Maple	6"	S 56° 30' W	44.30 feet
Maple	10"	N 86° W	34.20 feet
Cedar sign post		East	15 feet

The monument was damaged, so I replaced it with the monument described below.

Description of monument and accessories I established to perpetuate the original location of this corner.

In place of damaged monument, set a 2½ inch diameter aluminum pipe monument, 3 feet long, 8 inches below roadbed surface with an aluminum capped stamped: T40N, R14E, S-7, S-8, S-17, S-18, 1989, S-1634, from which the following new blazed and scribed reference objects bear (all measurements taken to a nail in side of tree)

Maple	6"	N 50° E	35.17 feet
Steel sign post		East	17.95 feet

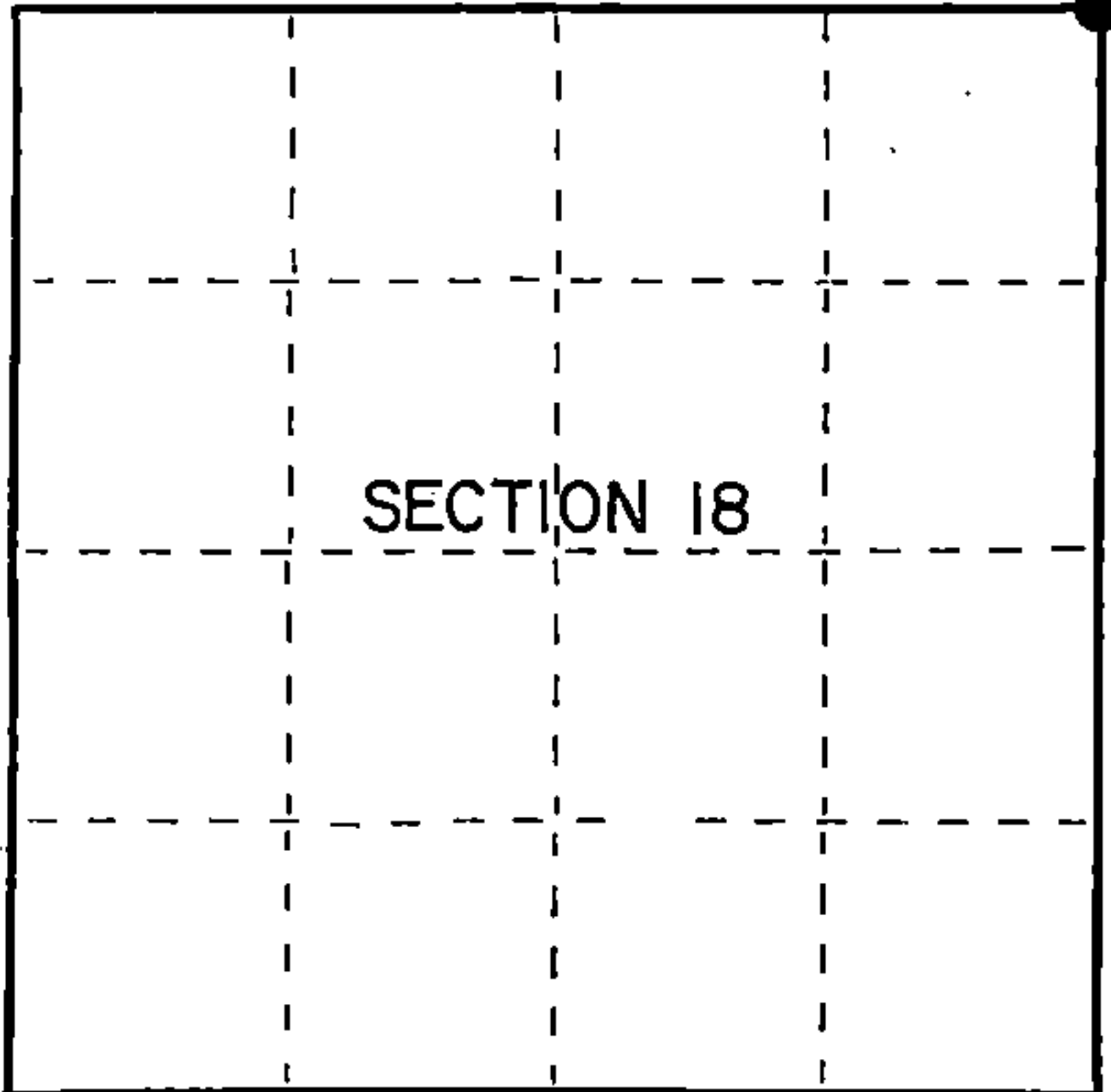

○ = Corner monument restored.

Dated at Iron River, MI, Wis, this 9th day of December, 1989

Signature Gary L. Pisoni Title Land Surveyor Registration No. S-1634
(County Surveyor, Registered Land Surveyor, or other duly authorized official)

Office of Register of Deeds, County of Forest, I hereby certify that the within instrument was filed in this office for record on the 20th day of September, 1990 at 10:45 o'clock A.M.

(Register of Deeds)

By Paul Clitto Deputy

FORM NO. 985-A
H.C. Miller Company
P.O. Box 100
Forest, Wisconsin

Stock No. 26273

DOCUMENT NUMBER

140468

44014070000

a) Describe any material discrepancy between the location of the corner as restored or reestablished and the location of that corner as previously restored or reestablished by distance and direction. Show the discrepancy on the plan view drawing under (d), above. Show the distances between the corner as previously restored or reestablished and (1) the corner as restored or reestablished, and (2) to at least 2 of the witness monuments shown on the drawing in (d), above.

See drawing below.

(f) Was the corner restored through acceptance of (1) an obliterated evidence location, or, (2) a found perpetuated location?

Restored through acceptance of a found perpetuated location

(g&h) Was the corner reestablished through lost corner proportionate methods? If so, show the method, including the directions and distances to other public land survey corners used as evidence or used for proportioning in determining the corner location?

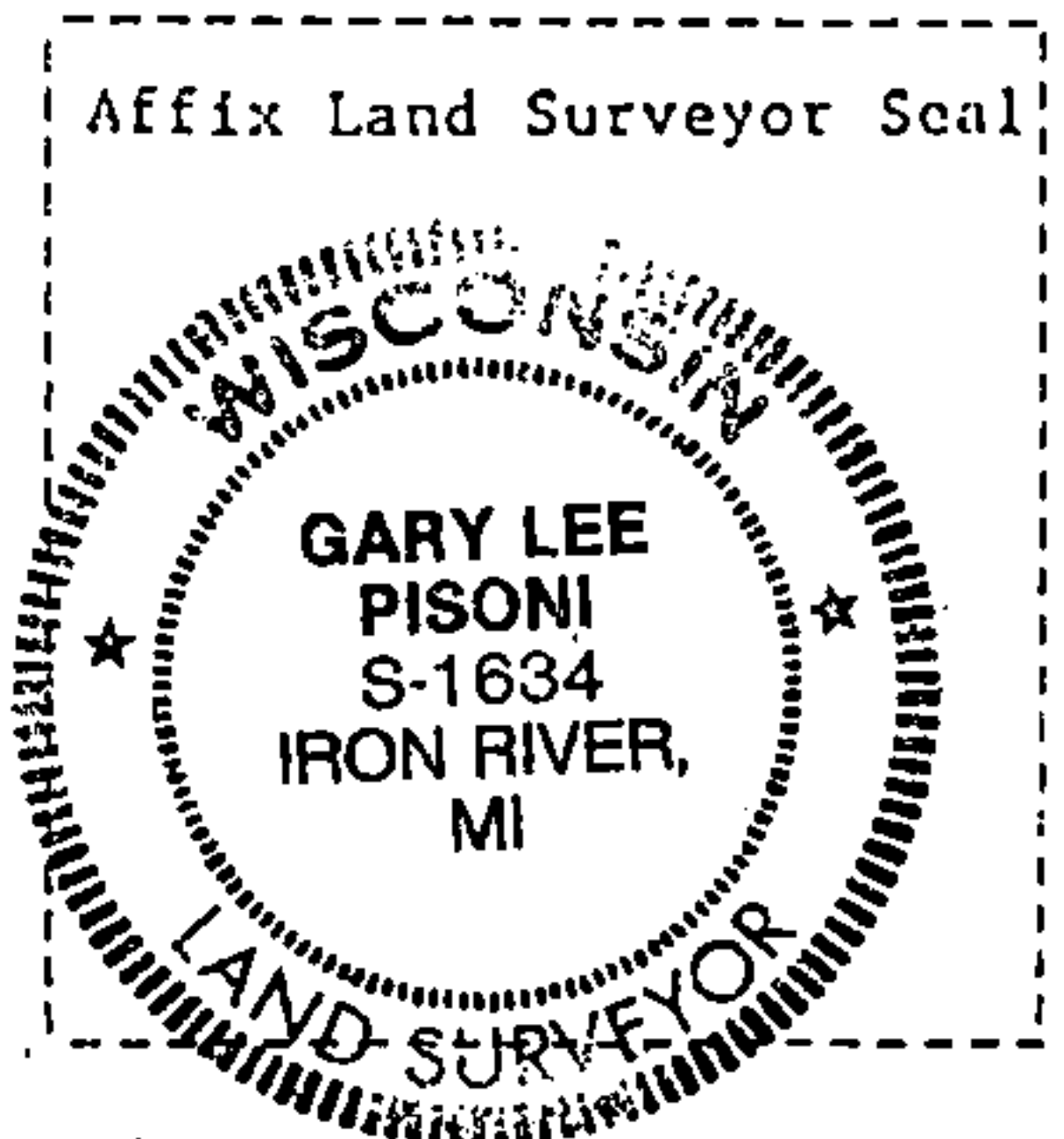
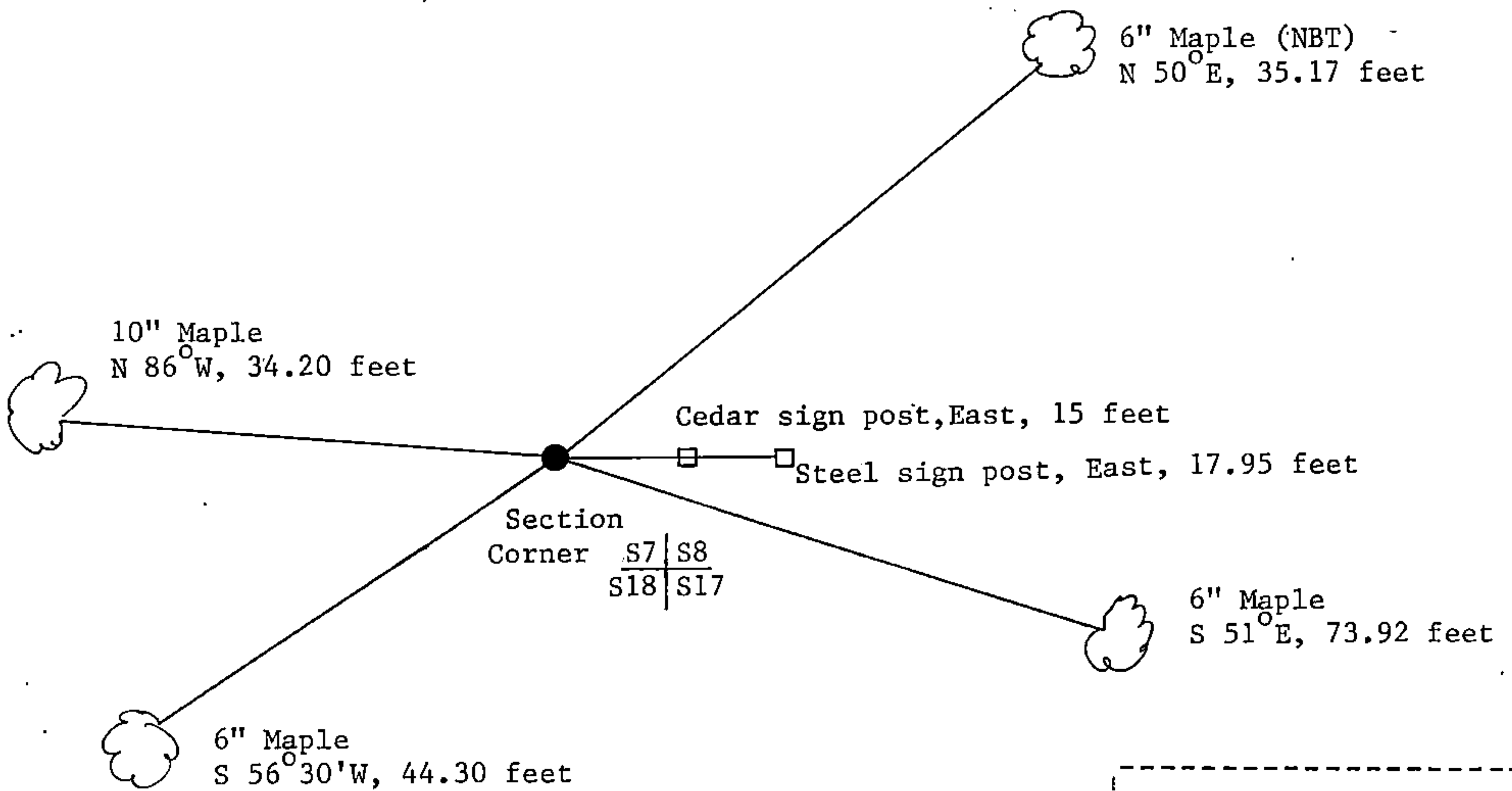

(i) I, Gary L. Pisoni
 (type or print name) certify that the corner location shown on this record was determined by me or under my direction and control and that this U.S. Public Land Survey Monument Record is correct and complete to the best of my knowledge and belief.

Gary L. Pisoni Signature Jan 12 1990 Date

Survey requested by: [Signature] District Ranger 9-18-90 Date