

CERTIFIED LAND CORNER RESTORATION

State of Wisconsin }
County of Forest } ss.

I William B. Cochrane, do hereby certify that on the 27th day of May, 1982, I found evidence of the Northeast Section corner of Section 18 Township 40 North, Range 13 East, Fourth Principal Meridian, as described hereon; and that from this evidence I established a new monument and accessories as described hereon to perpetuate the original location of this corner:

Description of original monument and accessories and subsequent restorations:

Original survey in 1865 by William E. Daugherty
Dependent resurvey in 1975 by Barry G. Krebs
In place of old Cedar post, set an iron post, 2 1/2" diameter, with brass cap marked T40N, R13E, S7, S8, S17, S18, 1975
From which the following bear:
Maple, 8", N48E, 53 lks. Maple, 15", S17 1/2 W, 64 lks.
Hemlock, 19", S24E, 65 lks. Cherry, 12", N9 1/2 W, 46 lks.

Description of corner evidence found:

Monument as described and in place
Maple (dead), 8", N48E, 53 lks.
Spruce, 18", S24E, 65 lks.
Maple, 16", S17 1/2 W, 64 lks.
Cherry, 13", N9 1/2 W, 46 1/2 lks.

Description of monument and accessories I established to perpetuate the location of this corner:

Blazed and scribed the following bearing tree:
Maple, 6", N24E, 18.05 ft.
Steel sign post, East, 2.0 ft.

DOCUMENT NO.
124415

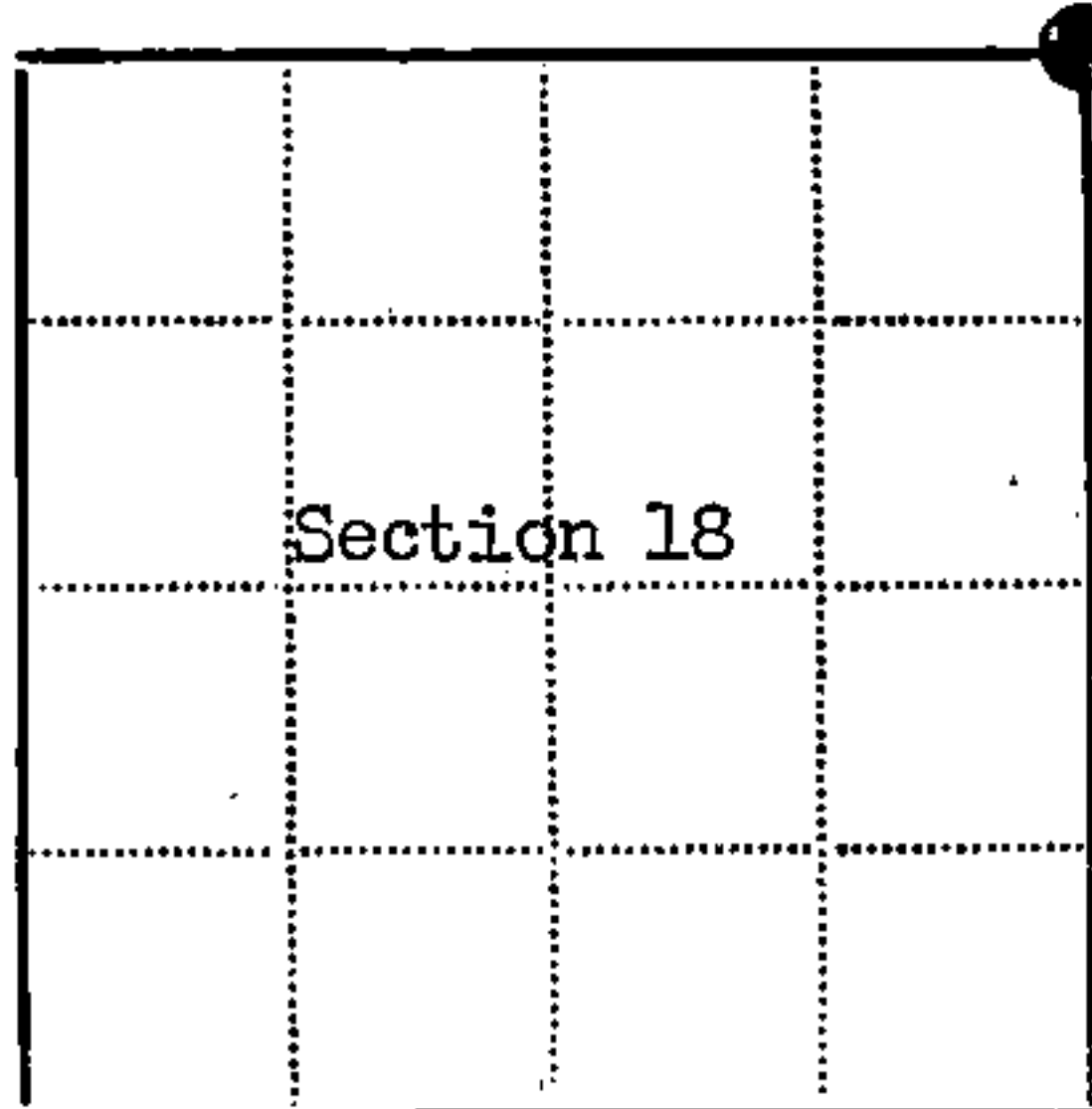
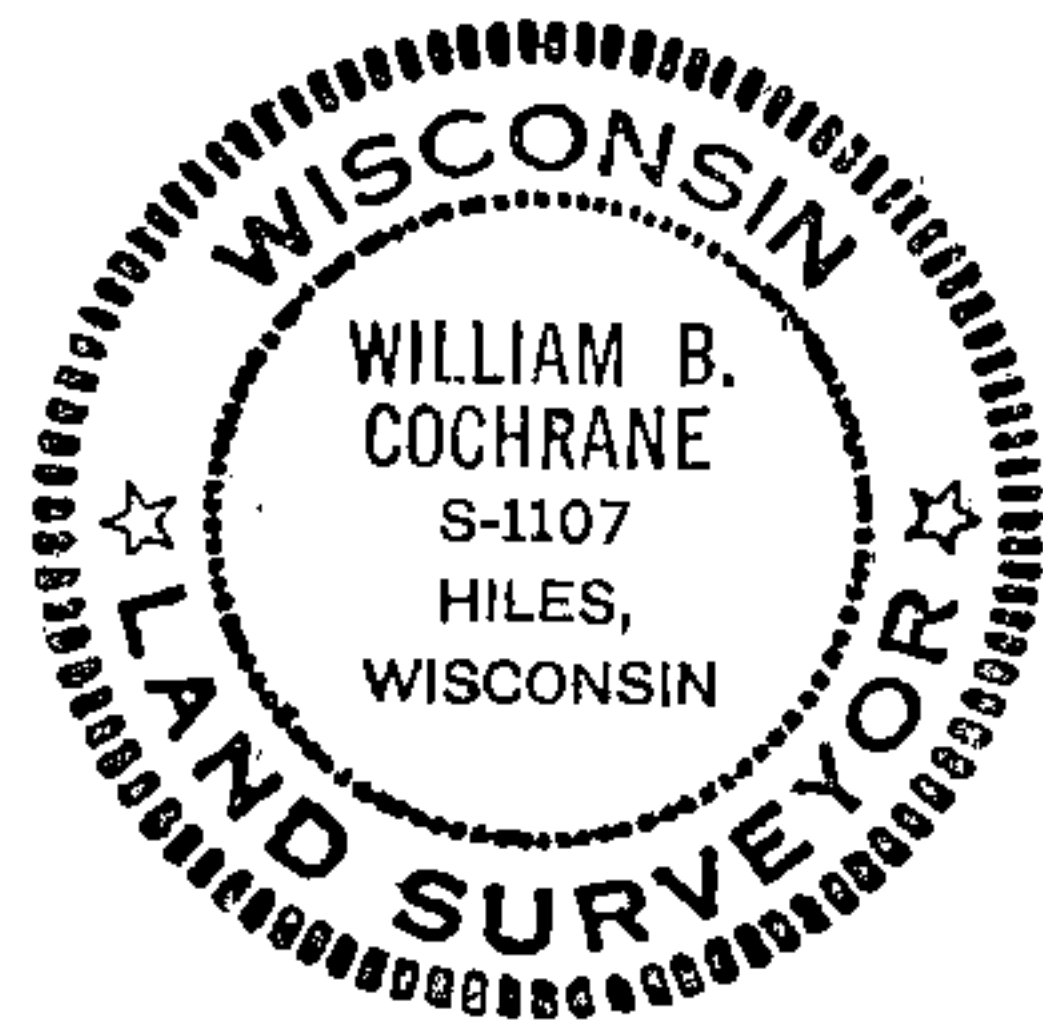

● - Corner monument restored
□ -

Resident witnesses.....

Dated at Hiles Wisconsin, this 21st day of July 1982.

Signature William B. Cochrane Title Land Surveyor
(County Surveyor, Registered Land Surveyor, or other duly authorized official)

Surveyors Registration No. S-1107

Office of Register of Deeds County of Forest

I hereby certify that the within instrument was filed in this office for record on the 10th day of October 1983, and was filed in Book No. Page No. of County Records.

Signature Eugene Stutzman Title Register of Deeds

Township 40 North, Range 13 East, Section 18, Index No. J-5, Page No.