

CERTIFIED LAND CORNER RESTORATION

State of Wisconsin }  
County of Forest } ss.

I William B. Cochrane, do hereby certify that on the 13th day of May, 1982, I found evidence of the Quarter corner of Sections 32 and 33 Township 40 North, Range 12 East, Fourth Principal Meridian, as described hereon; and that from this evidence I established a new monument and accessories as described hereon to perpetuate the original location of this corner:

Description of original monument and accessories and subsequent restorations:

Original survey in 1859 by William E. Daugherty  
Dependent resurvey in 1941 by Guy R. Veal  
At proportionate distance, and in the center of a graded road, set a concrete monument 2' long, 6" in diameter, 6" below the road surface, with an iron post 22" long, 1" in diameter embedded therein, with a brass cap marked 1/4, S32, S33, 1941  
Maple, 8", N36 1/4 E, 57.09 ft.  
Maple, 10", N52 3/4 W, 50.52 ft.

Description of corner evidence found:

Concrete monument, set from resurvey in 1941  
Flush with road surface, brass cap gone  
Maple, 16" N36 1/4 E, 57.09 ft.  
Maple, 21", N52 3/4 W, 50.52 ft.

Description of monument and accessories I established to perpetuate the location of this corner:

Replaced concrete monument with a 2 1/2" aluminum pipe monument, 30" long, 6" below the road surface, with an aluminum cap stamped T40N, R12E, 1/4, S32, S33, 1982, S-1107

DOCUMENT NO. 124422

44012322000

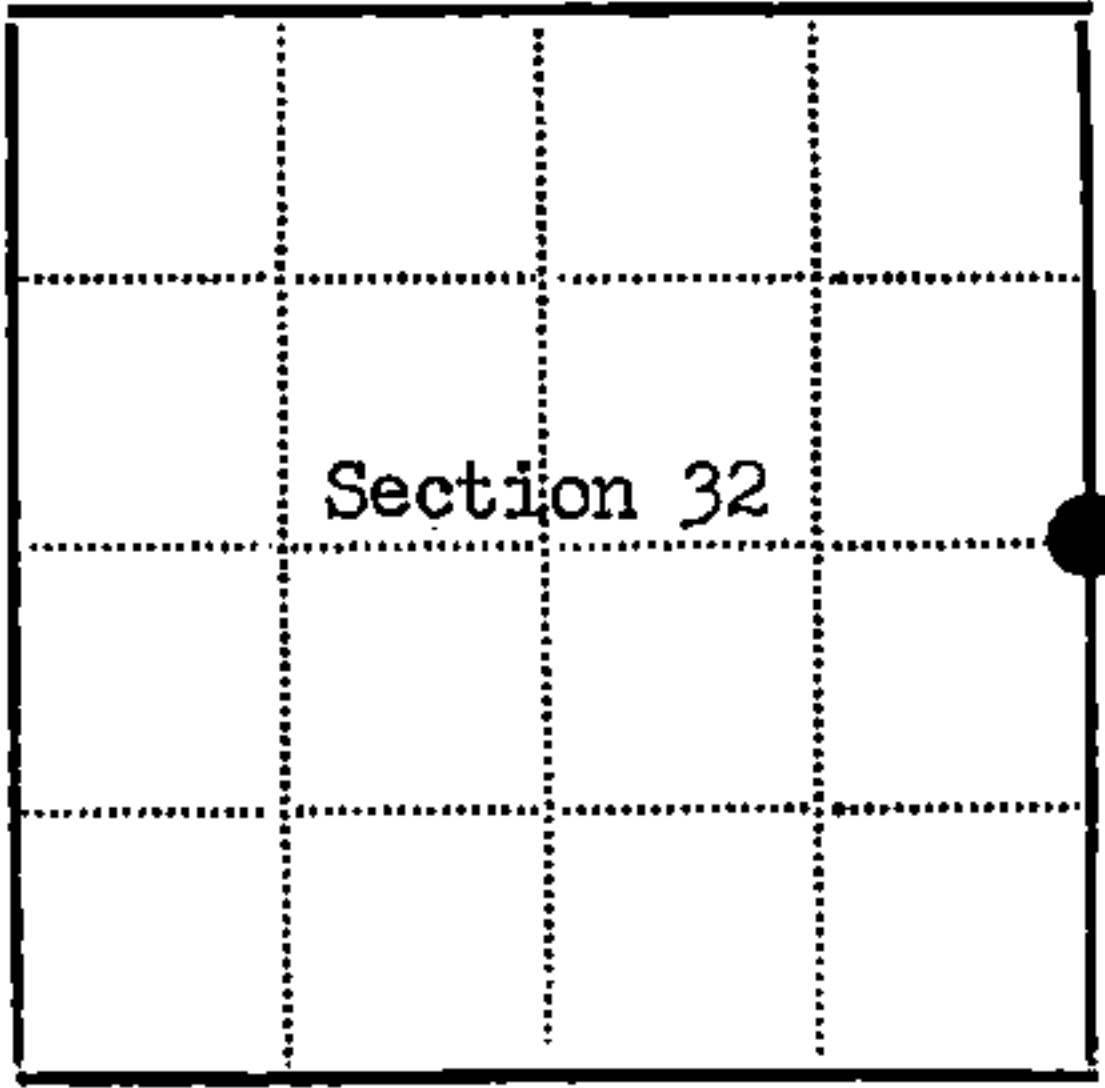
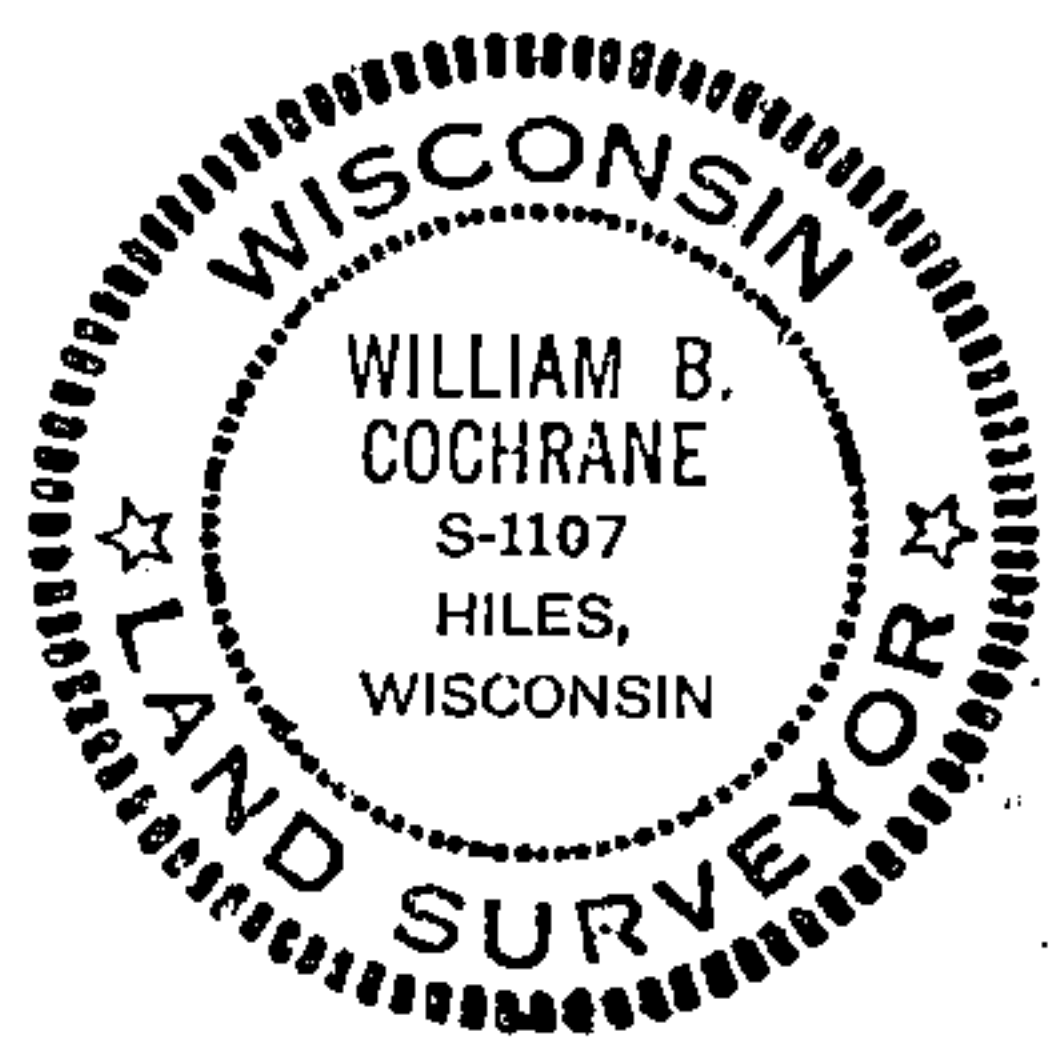

● - Corner monument restored  
□ -

Resident witnesses.....

Dated at Hiles Wisconsin, this 20th day of July 1982.

Signature William B. Cochrane Title Land Surveyor  
(County Surveyor, Registered Land Surveyor, or other duly authorized official)

Surveyors Registration No. S-1107

Office of Register of Deeds County of Forest

I hereby certify that the within instrument was filed in this office for record on the 10th day of October 1983, and was filed in Book No. .... Page No. .... of County Records.

Signature [Signature] Title Register of Deeds

Township 40 North, Range 12 East, Section 32, Index No. X-9, Page No. ....

124422