

U.S. PUBLIC LAND SURVEY MONUMENT RECORD

Index No. 2-5

State of Wisconsin }
 County of Forest } ss.

John H. Fisher, do hereby certify that on the 15 day of May, 1984, I found evidence of the Southeast corner of Section 31 Township 40, North, Range 12 East, Fourth Principal Meridian, as described hereon; and that from this evidence I established a new monument and accessories as described hereon to perpetuate the original location of this corner.

Resident witnesses:

None

History of original corner establishment: Original survey in 1857 by Alfred Millard. Dependent Survey in 1939, by Hal D. Craig, at 79.72 chains set concrete monument, 24 ins. long, 6 ins. diameter, 18 ins. in the ground with brass tablet 3-1/2" diameter, 3 in, stem embedded in top and stamped.

T40N R12E
 S31 | S32
 S6 | S5
 T39N
 1939

From which the following bear:

Original bearing trees:	Sugar Maple	20"	S70°E	45 lks.
	A large upturned pile earth		S48°W	10 lks.
	A splintered Hemlock Stump	20"	N69°W	25 lks.
New Bearing Trees:	Maple	8"	N52-1/2°E	71 lks.
	Maple	10"	S60-3/4°E	41 lks.
	Hemlock	18"	S19-1/2°W	75 lks.
	Maple	8"	S64-1/4°W	73 lks.

Description of corner evidence found:

B.L.M. Monument as described and in place; and the following bearing trees.

Sugar Maple	18"	S60°E	27.37'
Sugar Maple	16"	N50°E	46.83'
Sugar Maple	13"	N60°W	48.35'

Description of monument and accessories I established to perpetuate the original location of this corner.

Corner in good condition.

Blazed and scribed new bearing tree

Set nail in Hemlock	9"	N19°E	52.63 feet
Set Steel Sign Post		S30°E	1.2 feet

Dated at Minocqua, Wis., this 22nd day of January, 1985

Signature John H. Fisher Title Registered Land Surveyor Registration No. S-836
 (County Surveyor, Registered Land Surveyor, or other duly authorized official)

Office of Register of Deeds, County of Forest, I hereby certify that the within instrument was filed in this office for record on the 24th day of April, 1985 at 1:00 o'clock P. M.

Paul Aschenbrenner
 (Register of Deeds)

By.....Deputy

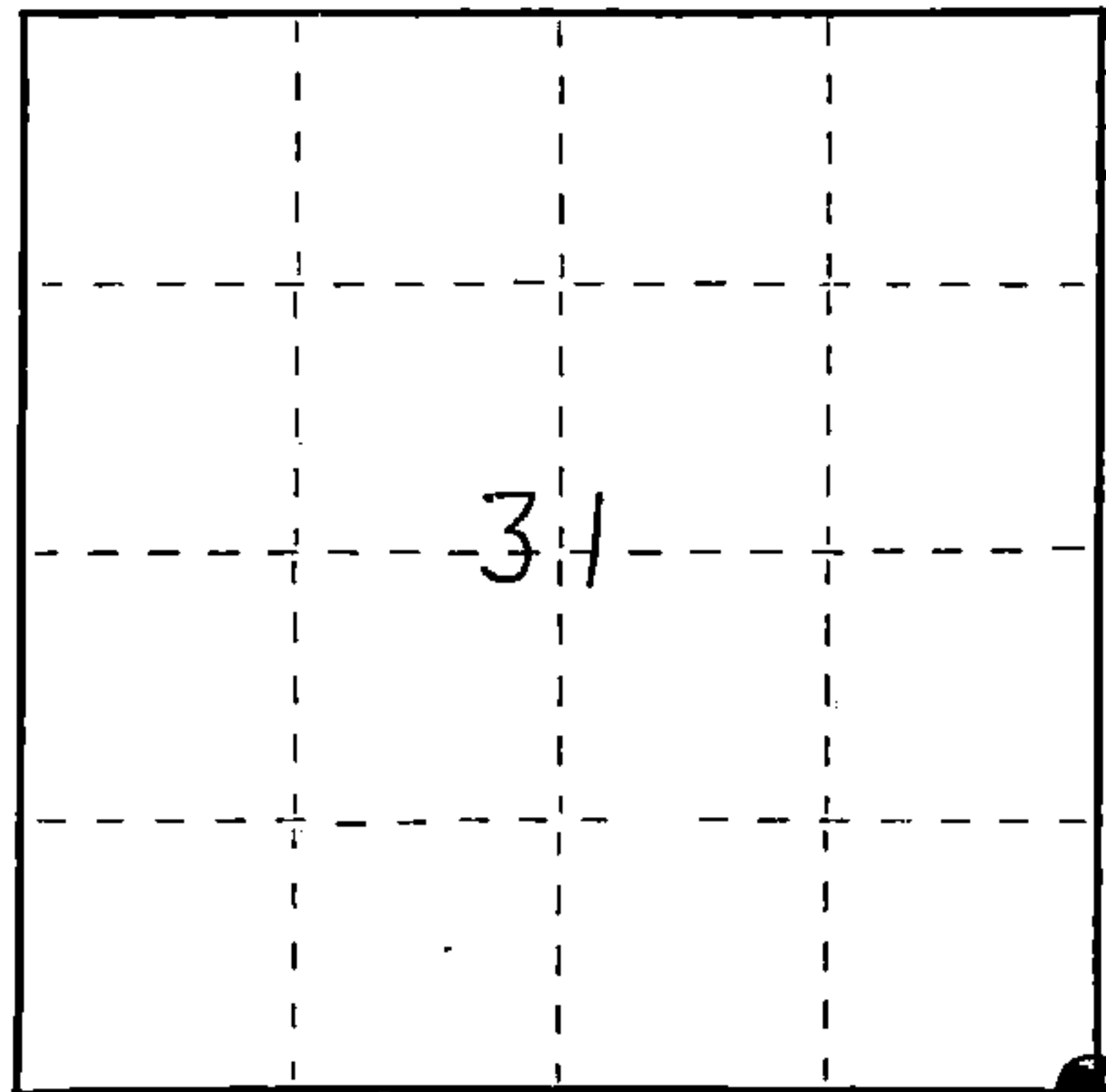

○ = Corner monument restored.

FORM NO. 985-A

H.C. Miller Company

Stock No. 26273

Document Number 127879

44012310000

(e) Describe any material discrepancy between the location of the corner as restored or reestablished and the location of that corner as previously restored or reestablished by distance and direction. Show the discrepancy on the plan view drawing under (d), above. Show the distances between the corner as previously restored or reestablished and (1) the corner as restored or reestablished, and (2) to at least 2 of the witness monuments shown on the drawing in (d), above.

See Drawing Below

(f) Was the corner restored through acceptance of (1) an obliterated evidence location, or, (2) a found perpetuated location?

Found perpetuated location

(g&h) Was the corner reestablished through lost corner proportionate methods? If so, show the method, including the directions and distances to other public land survey corners used as evidence or used for proportioning in determining the corner location?

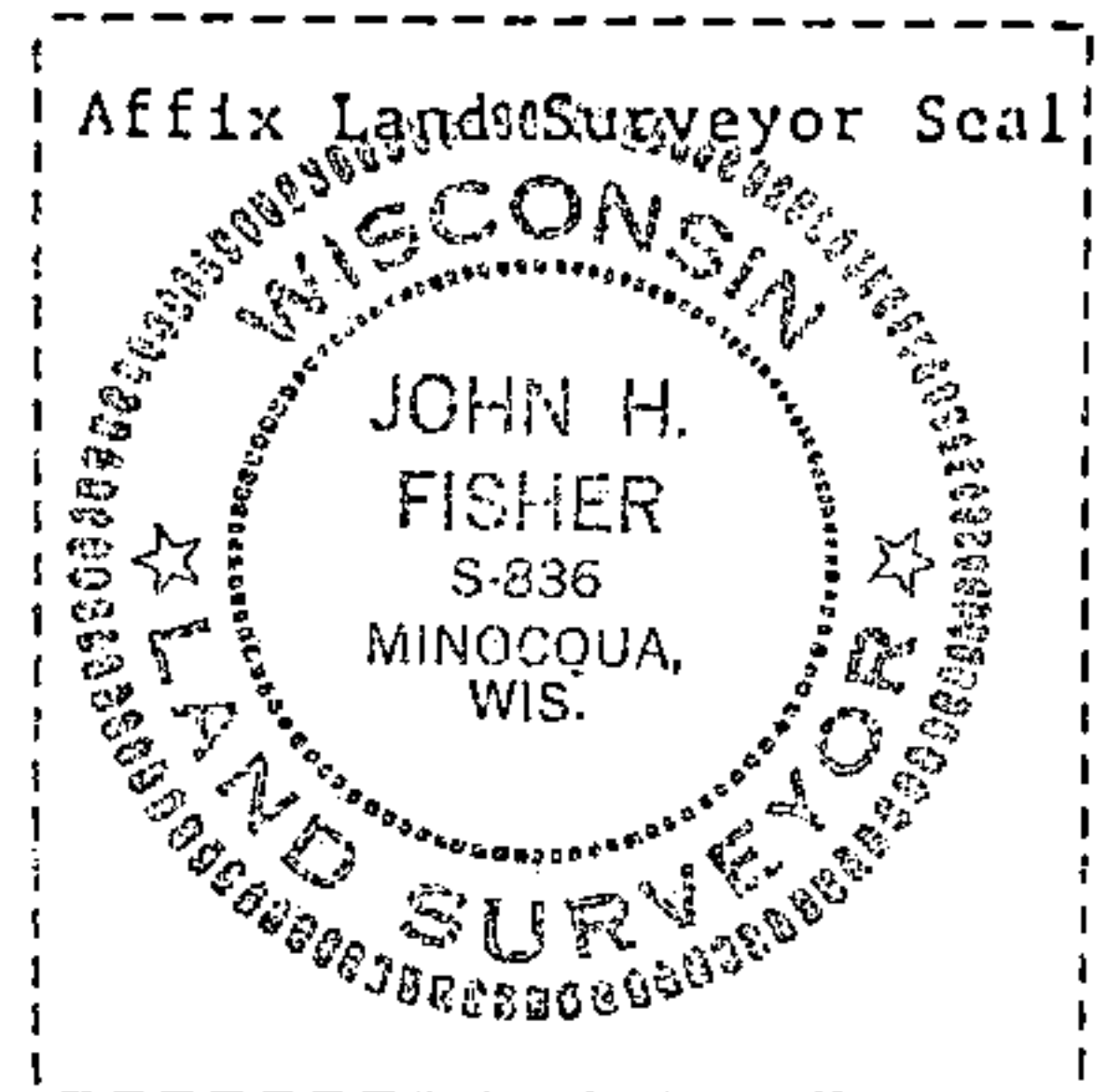
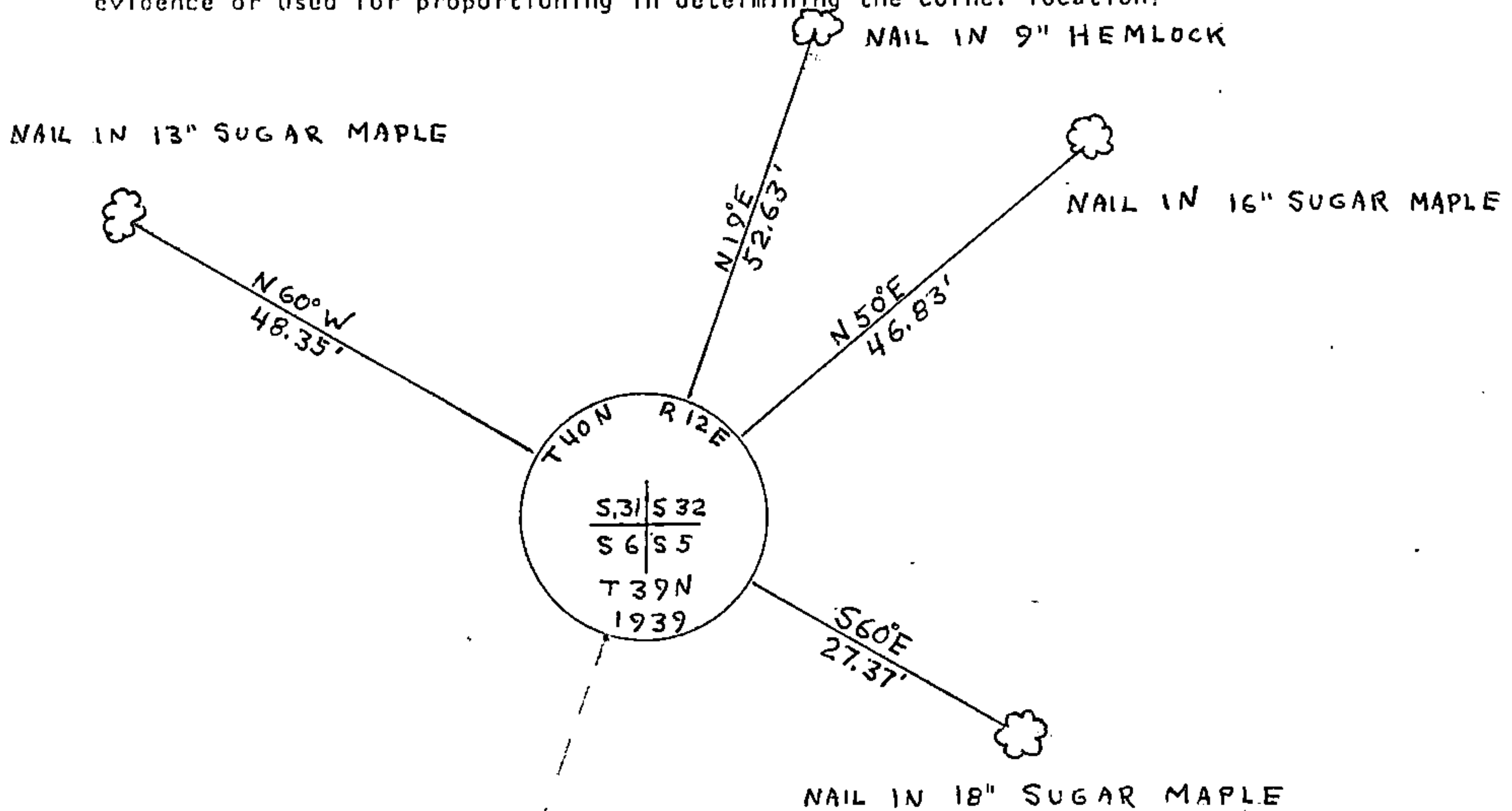

(i) I, John H. Fisher
 (type or print name) certify that the corner location shown on this record was determined by me or under my direction and control and that this U.S. Public Land Survey Monument Record is correct and complete to the best of my knowledge and belief.

John H. Fisher
 Signature

1/22/85
 Date