

U.S. PUBLIC LAND SURVEY MONUMENT RECORD

Index No. A 12-13

State of Wisconsin }
 County of Forest } ss.

History of original corner establishment:
 Dependent resurvey by Guy R. Veal in 1941. Set a 6"x24"
 concrete monument with a G.L.O. brass cap.

I, Robert H. Winat, do hereby
 certify that on the 5th day
 of February, 1985, I found
 evidence of the meander
 corner of 4
 Township 40, North, Range
12 East, Fourth Principal Meridian,
 as described hereon; and that from this evidence
 I established a new monument and accessories
 as described hereon to perpetuate the original
 location of this corner.

BT's: no new BT's marked.

Veal found fallen Hemlock 20" North 27 lks.
 Stump hole N84°E 11 lks.

Resident witnesses:

Description of corner evidence found:
 Found G.L.O. monument.
 Found BT's:

Stump mound North 18 feet (original)
 Stump hole N84°E 8 feet± (original)

Mike Stevens

Mike Lukasko

Description of monument and accessories I established to perpetuate the original location of this corner.
 Blazed and scribed new BT's:

Sugar Maple 5" N30°E 35.18 feet to nail in tree
 Hemlock 6" N68°E 29.22 feet to nail in tree
 Yellow Birch 7" S62°E 30.65 feet to nail in tree
 White Cedar 9" S50°W 25.65 feet to nail in tree
 Steel Sign Post N13°E 1.26 feet

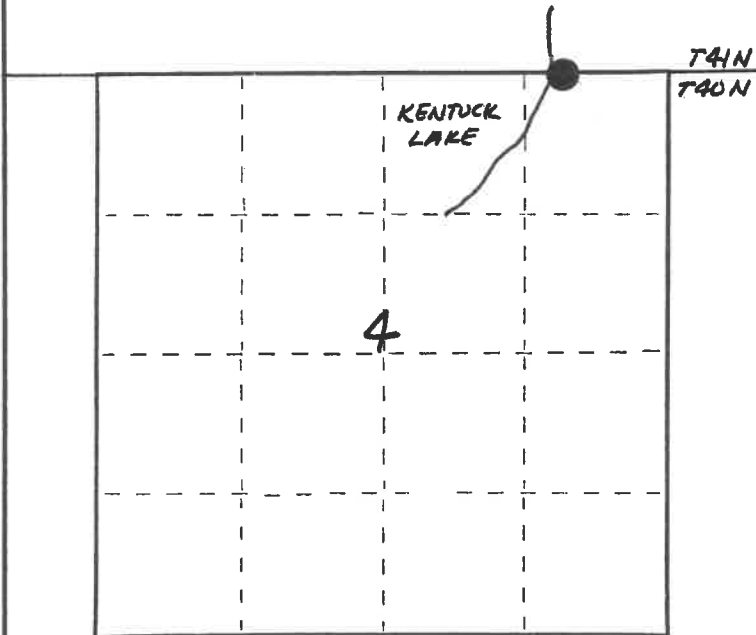

○ = Corner monument restored.

(over)

Dated at Rhineland, Wis., this 24th day of June, 1985.

Signature Robert H. Winat Title R.L.S. Registration No. 1040
 (County Surveyor, Registered Land Surveyor, or other duly authorized official)

Office of Register of Deeds, County of Forest, I hereby certify that the within
 instrument was filed in this office for record on the 24th day of July, 1985
 at 1:10 o'clock P. M.

Paul Aschubrenner
 (Register of Deeds)

By _____ Deputy

FORM NO. 985-A
 H.C. Miller Company
 MILWAUKEE, WISCONSIN

Stock No. 26273

DOCUMENT NUMBER 128463

44012044008

(e) Describe any material discrepancy between the location of the corner as restored or reestablished and the location of that corner as previously restored or reestablished by distance and direction. Show the discrepancy on the plan view drawing under (d), above. Show the distances between the corner as previously restored or reestablished and (1) the corner as restored or reestablished, and (2) to at least 2 of the witness monuments shown on the drawing in (d), above.
 N/A.

(f) Was the corner restored through acceptance of (1) an obliterated evidence location, or, (2) a found perpetuated location?
 Found perpetuated location.

(g&h) Was the corner reestablished through lost corner proportionate methods? If so, show the method, including the directions and distances to other public land survey corners used as evidence or used for proportioning in determining the corner location?
 No.

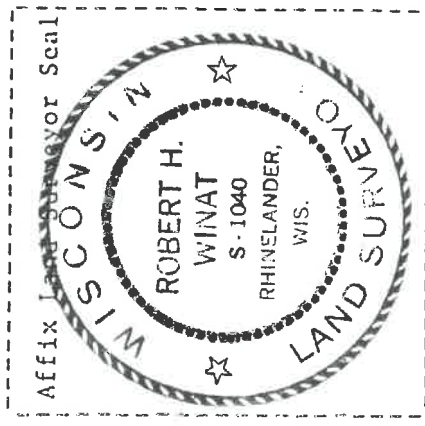
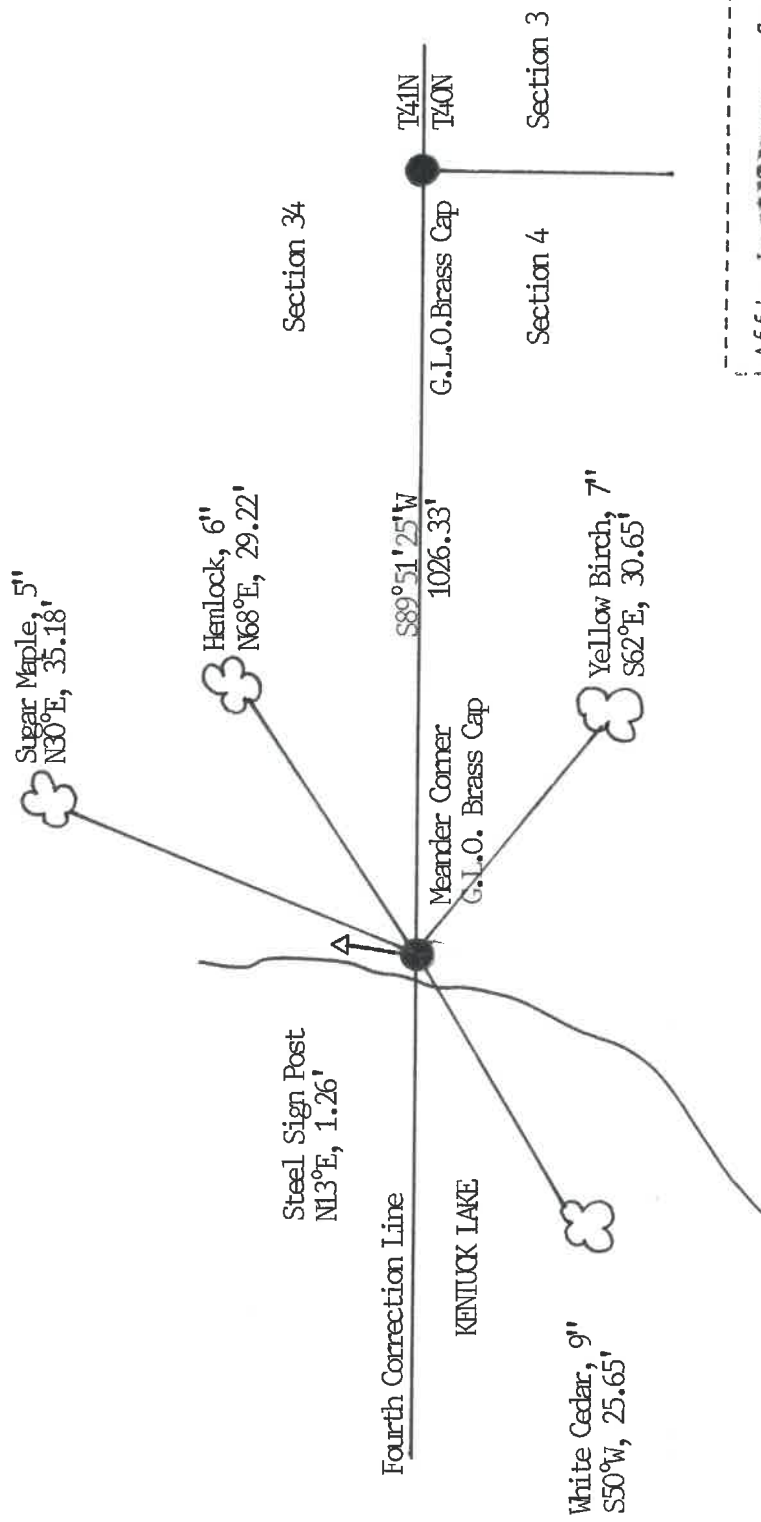

(i) I, Robert H. Winat
 (type or print name) certify that the corner location shown
 on this record was determined by me or under my direction and
 control and that this U.S. Public Land Survey Monument Record is
 correct and complete to the best of my knowledge and belief.

Robert H. Winat 6/24/85
 Signature Date