

CERTIFIED LAND CORNER RESTORATION

State of Wisconsin }
County of Forest } ss.

I, Jean F. Resvick, do hereby certify that on the 16 day of August, 1967, I found evidence of the North quarter corner of Section 9 Township 40 North, Range 12 East, Fourth Principal Meridian, as described hereon; and that from this evidence I established ~~a new monument~~ accessories as described hereon to perpetuate the ~~original~~ location of this corner:

Description of original monument and accessories and subsequent restorations:

Surveyed in 1859 by Wm. E. Daugherty. Dependent resurvey in 1941 by G. R. Veal. Proportionate distance. Set a concrete monument 24 ins. long, 6 ins. dia., 18 ins. in the ground, with brass cap marked:

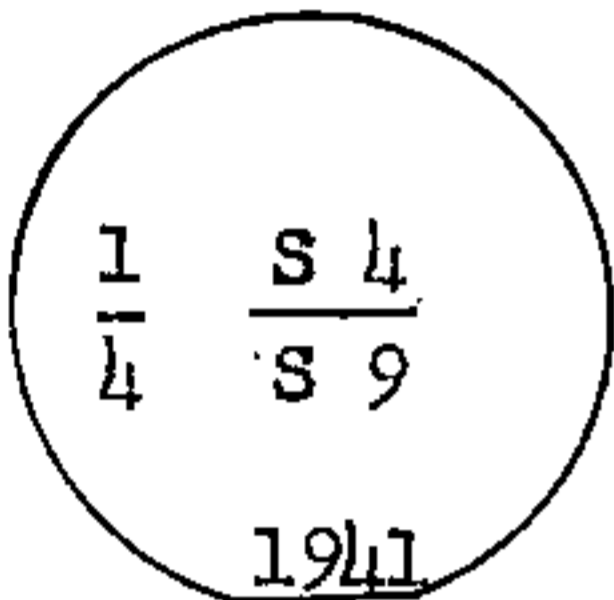

from which the following trees bear: A maple, 7", S70°E, 52 lks.
A birch, 12", N21° 30'E, 59 lks.

Description of corner evidence found:

Monument as described above and in place.
A maple, 12", S70°E, 34.50 ft.
A birch snag, 14", N21° 30'E, 39.00 ft.

Description of ~~monument~~ accessories I established to perpetuate the ~~original~~ location of this corner:

Blazed and scribed the following new bearing tree:
A maple, 4", N23°E, 28.35 ft. or 42.954 lks.
Set 4" x 4" x 7' long cedar post next to the monument.

440120A0020

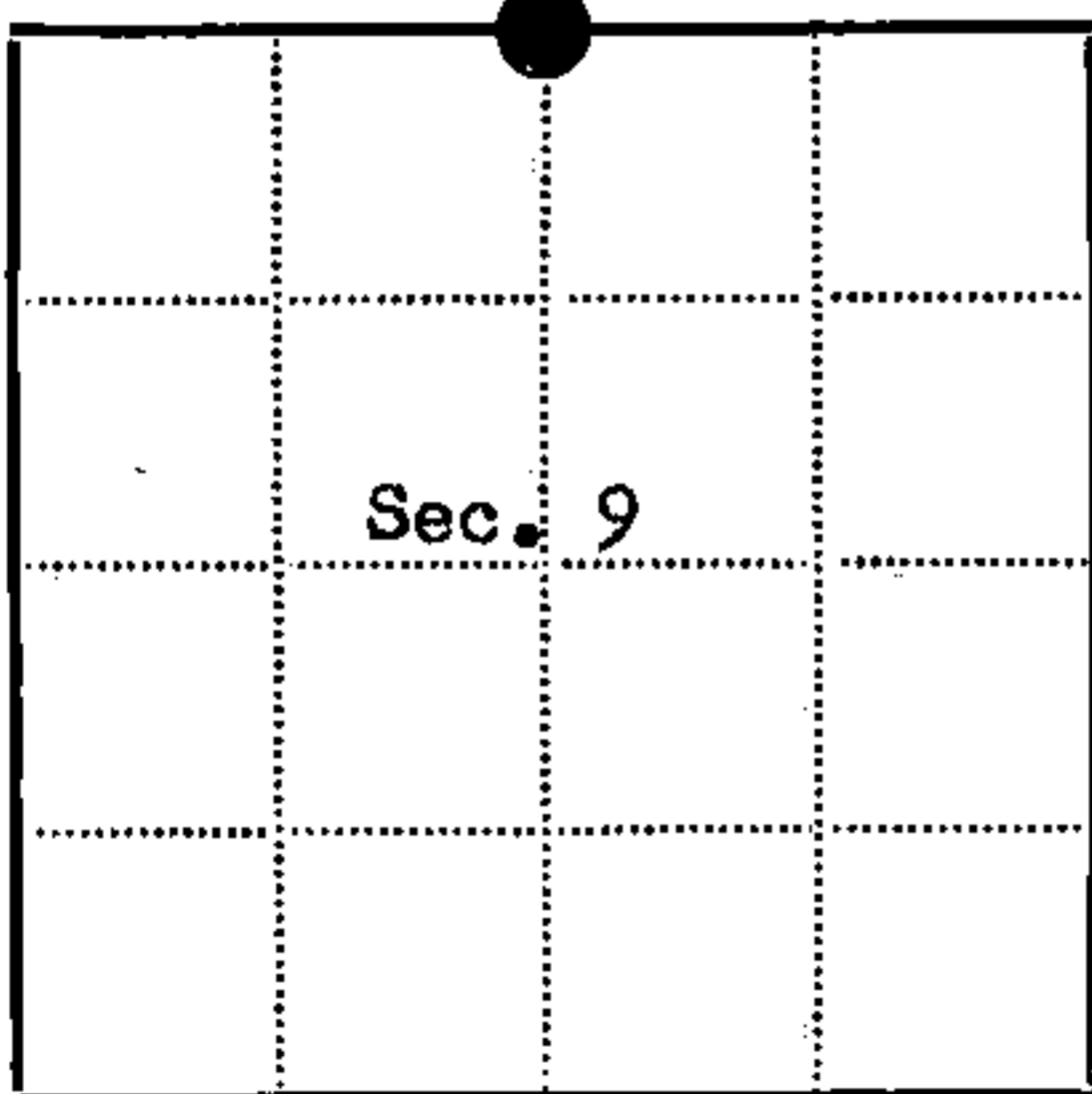

● = Corner monument restored
□ =

Resident witnesses.....

Dated at Rhinelander Wisconsin, this 11th day of April, 1968.

Signature *Jean F. Resvick* Title Cadastral Surveyor
(County Surveyor, Registered Land Surveyor, or other duly authorized official)

Surveyors Registration No. S-802 DOCUMENT # 94557

Office of Register of Deeds County of Forest

I hereby certify that the within instrument was filed in this office for record on the 11th day of May, 1968, and was filed in Book No. I Page No. E-11 of County Records. at 10:00 AM

Signature *Eugene Staszny* Title Register of Deeds

Township 40N, Range 12E, Section 9, Index No. E-11, Page No.

E
11

U.S. PUBLIC LAND SURVEY MONUMENT RECORD

Index No. E-11

State of Wisconsin }
 County of Forest } ss.

I, Robert H. Winat, do hereby certify that on the 10 day of February, 1985, I found evidence of the Quarter corner of Sections 4 & 9 Township 40, North, Range 12 East, Fourth Principal Meridian, as described hereon; and that from this evidence I established a new monument and accessories as described hereon to perpetuate the original location of this corner.

Resident witnesses:

Mike Stevens

Mike Lukasko

History of original corner establishment: Wm. E. Daugherty est. in 1859.
 G.L.O. set a brass capped iron pipe in 1941 with the following Bt's:
 Maple 7" S70°E 52Lks.
 Yellow Birch 12" N21°30'E 59 Lks.
 Jean F. Resvick made an additional Bt in 1968:
 Maple 4" N23°E 28.35'.

Description of corner evidence found: Found the G.L.O. brass capped I.P. and the following

Yellow Birch Swag	N20°E	39.41'
Maple	8" N21°E	28.42'
Maple	14" S70°E	34.50'
Wood sign post	South	0.80'

Description of monument and accessories I established to perpetuate the original location of this corner.

Made new BT's:
 Maple 9" N76°E 10.17'
 Maple 10" S22°E 18.30'

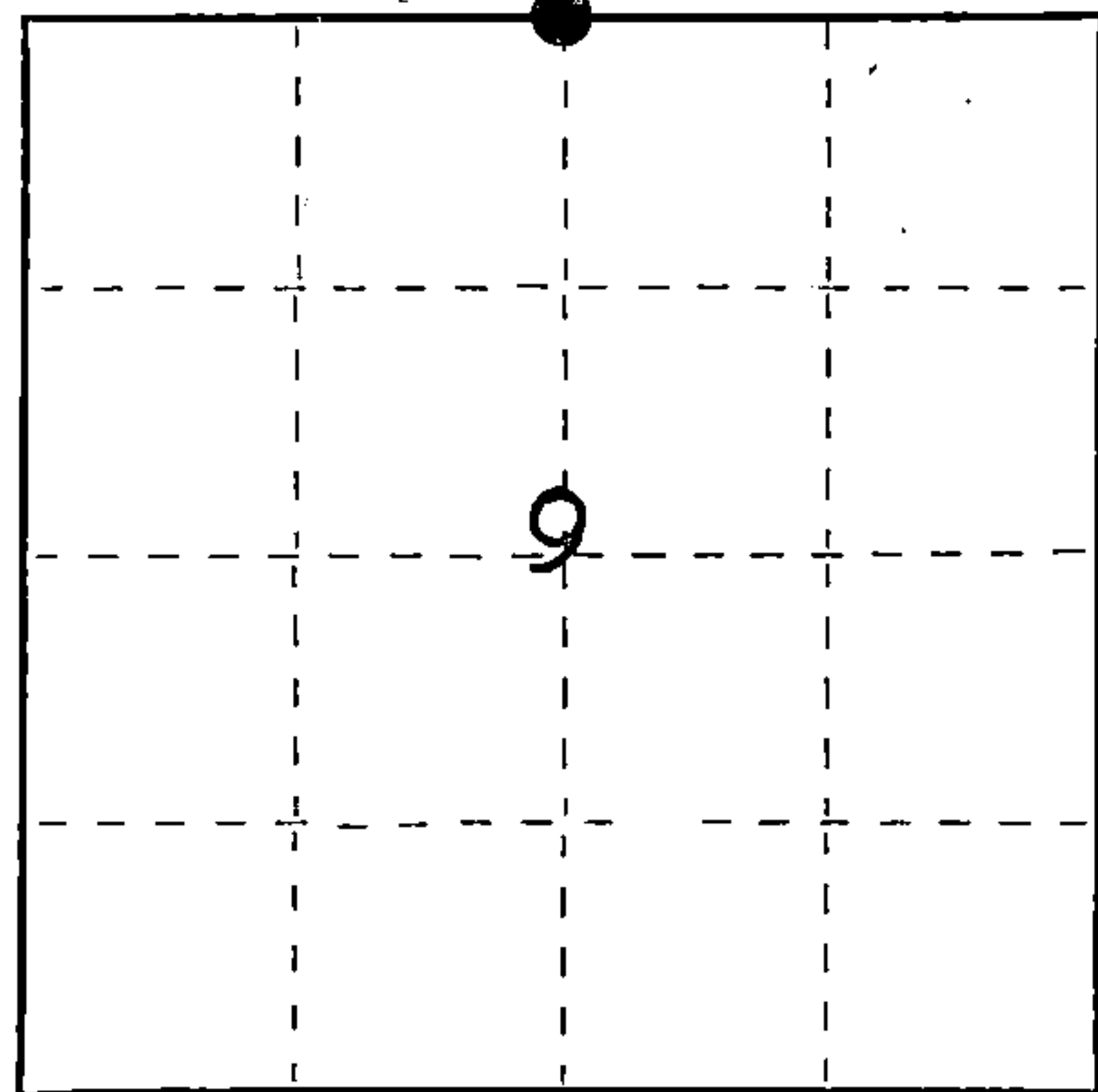

● = Corner monument restored.

(over) Dated at Rhineland, Wis., this 4 day of June, 1985

Signature Robert H. Winat Title Land Surveyor Registration No. 1090
(County Surveyor, Registered Land Surveyor, or other duly authorized official)

Office of Register of Deeds, County of Forest, I hereby certify that the within instrument was filed in this office for record on the 24th day of July, 1985 at 1:10 o'clock P. M.

Paul Aschenbrenner
 (Register of Deeds)

By.....Deputy

FORM NO. 985-A

H.C. Miller Company

Stock No. 26273

DOCUMENT NUMBER 128470

44012040020

(e) Describe any material discrepancy between the location of the corner as restored or reestablished and the location of that corner as previously restored or reestablished by distance and direction. Show the discrepancy on the plan view drawing under (d), above. Show the distances between the corner as previously restored or reestablished and (1) the corner as restored or reestablished, and (2) to at least 2 of the witness monuments shown on the drawing in (d), above.

See drawing below.

(f) Was the corner restored through acceptance of (1) an obliterated evidence location, or, (2) a found perpetuated location?

Found perpetuated location.

(g&h) Was the corner reestablished through lost corner proportionate methods? If so, show the method, including the directions and distances to other public land survey corners used as evidence or used for proportioning in determining the corner location?

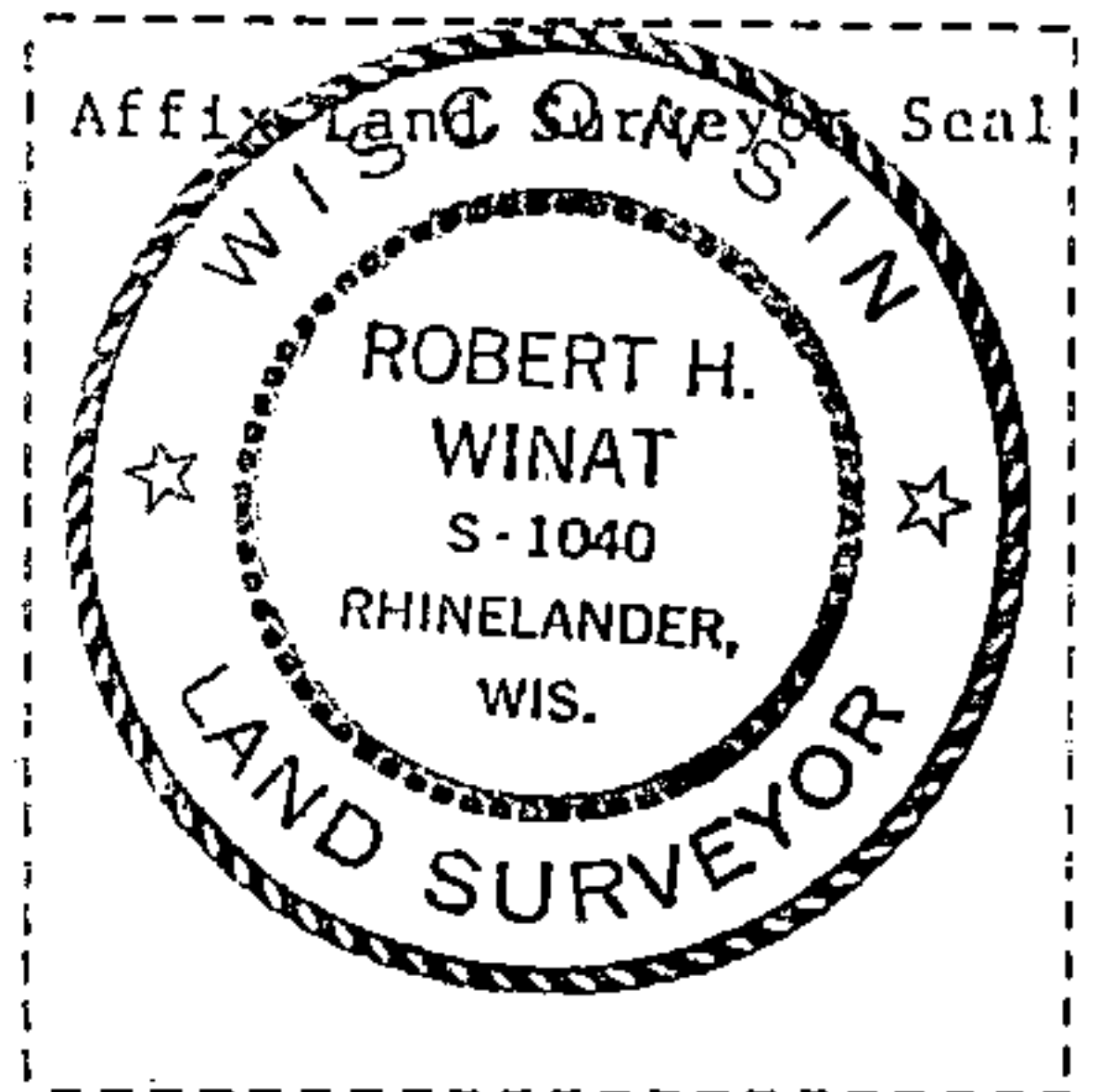
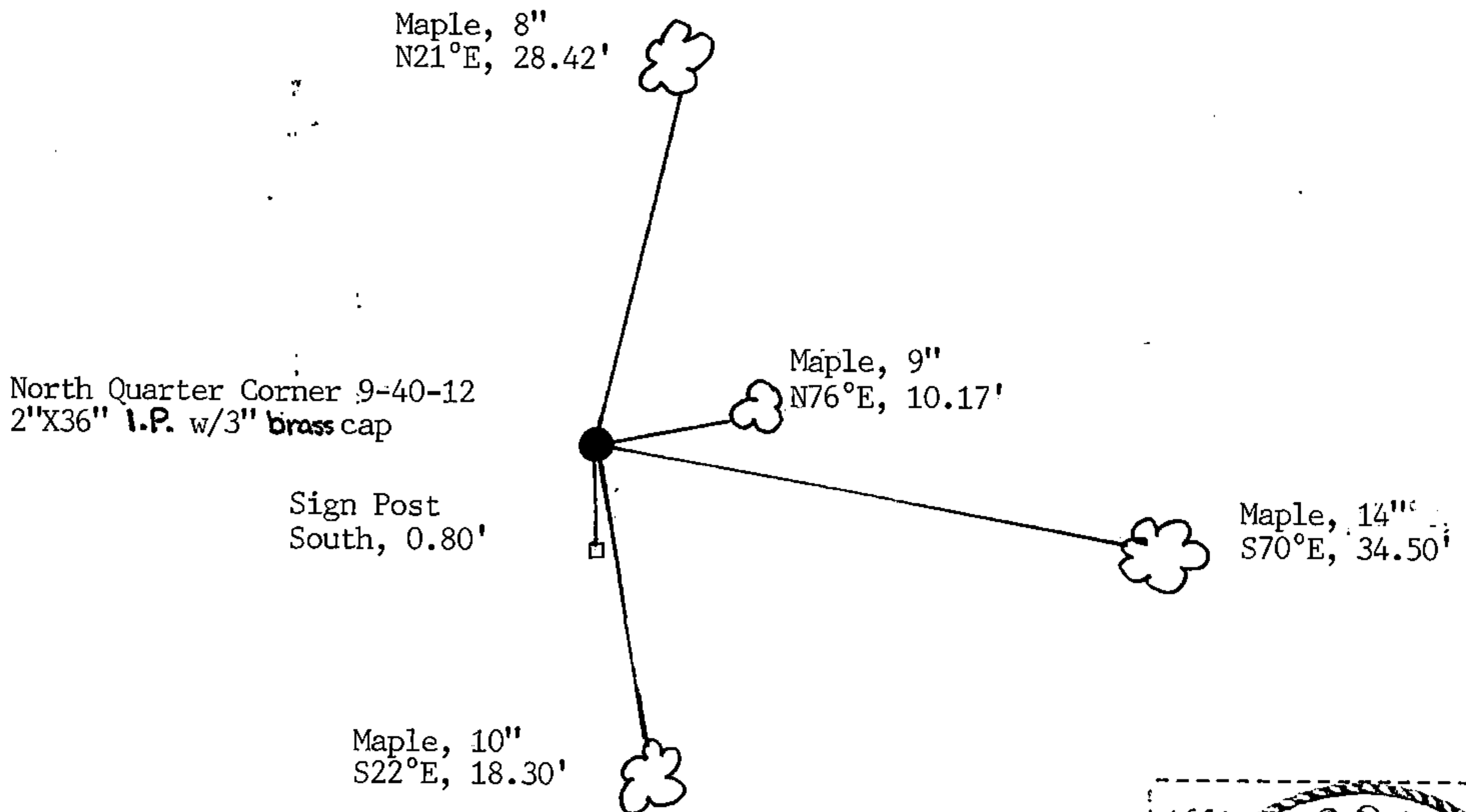

(i) I, Robert H. Winat
 (type or print name) certify that the corner location shown on this record was determined by me or under my direction and control and that this U.S. Public Land Survey Monument Record is correct and complete to the best of my knowledge and belief.

Robert H. Winat 4 Jan '85
 Signature Date