

CERTIFIED LAND CORNER RESTORATION

State of Wisconsin }  
County of Forest } ss.

I, William B. Cochrane, do hereby certify that on the 25th day of May, 1982, I found evidence of the Southeast Section corner of Section 3 Township 40 North, Range 12 East, Fourth Principal Meridian, as described hereon; and that from this evidence I established a new monument and accessories as described hereon to perpetuate the original location of this corner:

Description of original monument and accessories and subsequent restorations:

Original subdivision in 1859 by Wm. E. Daugherty  
Dependent resurvey in 1941 by Guy R. Veal  
From remains of the original bearing tree, set 6" diameter concrete monument with brass cap marked T40N, R12E, S2, S3, S10, S11, 1941  
From which the following bear:  
Hemlock, 7", N34 1/4 E, 96 lks.  
Yellow Birch, 11", S53 1/4 E, 83 lks.  
Yellow Birch, 8", S1W, 121 lks.  
Yellow Birch, 8", N5 1/4 W, 79 lks.  
Description of corner evidence found:

Found monument as described and in place  
Original Hemlock stump, S45W, 7 lks.  
Hemlock snag, 7", N34E, 96 lks.  
Yellow Birch stump, N53E, 83 lks.  
Yellow Birch stump, S1W, 121 lks.  
Yellow Birch stump, N5W, 79 lks.

Description of monument and accessories I established to perpetuate the location of this corner:

Blazed and scribed the following new bearing trees:  
Spruce, 10", S45 1/2 E, 56.50 ft.  
Balsam, 11", S33W, 28.81 ft.  
Balsam, 10", N65W, 37.22 ft.  
Spruce, 11", N3W, 55.16 ft.  
Steel sign post, East, 1.0 ft.

DOCUMENT NO.  
124412

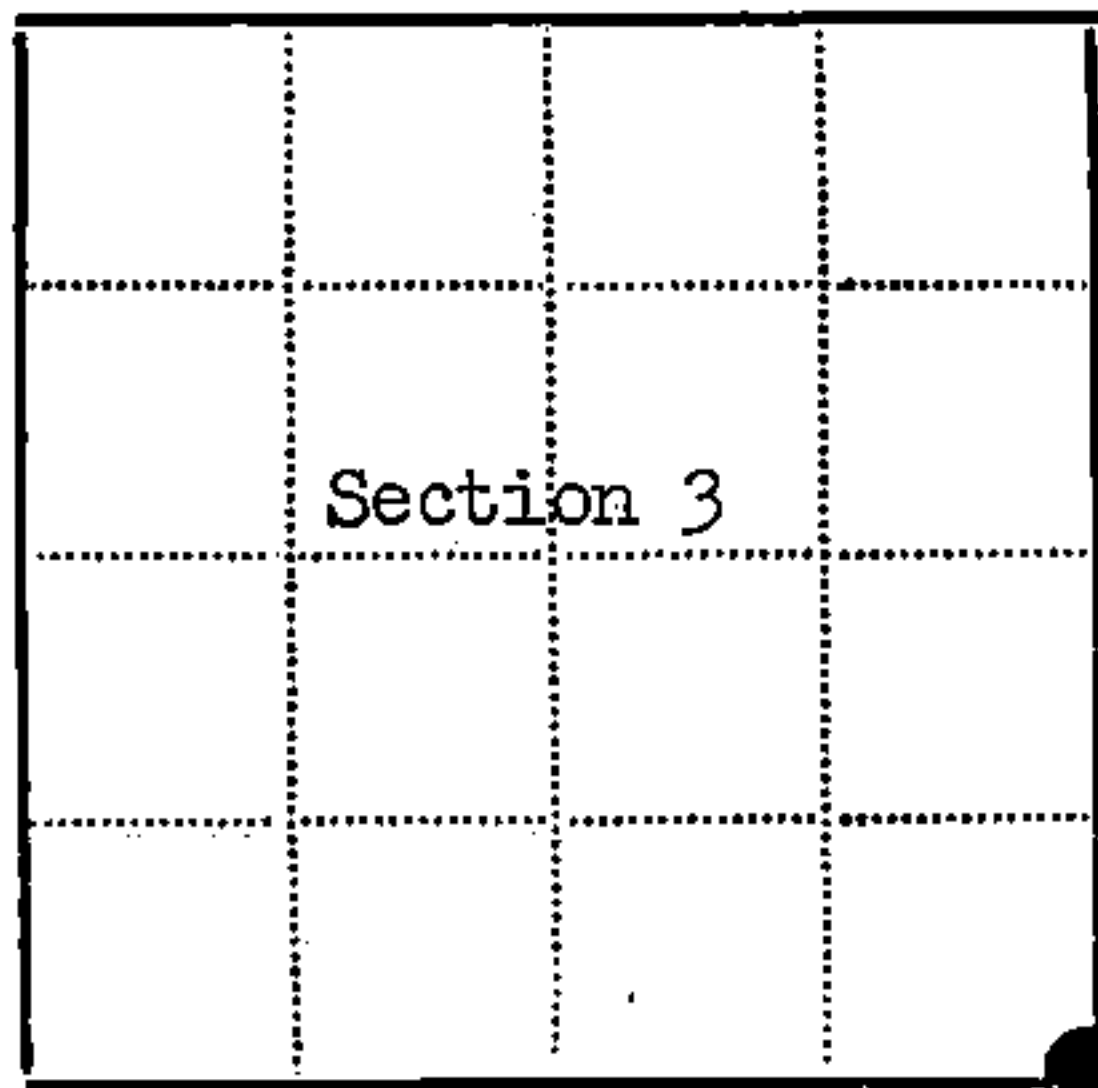
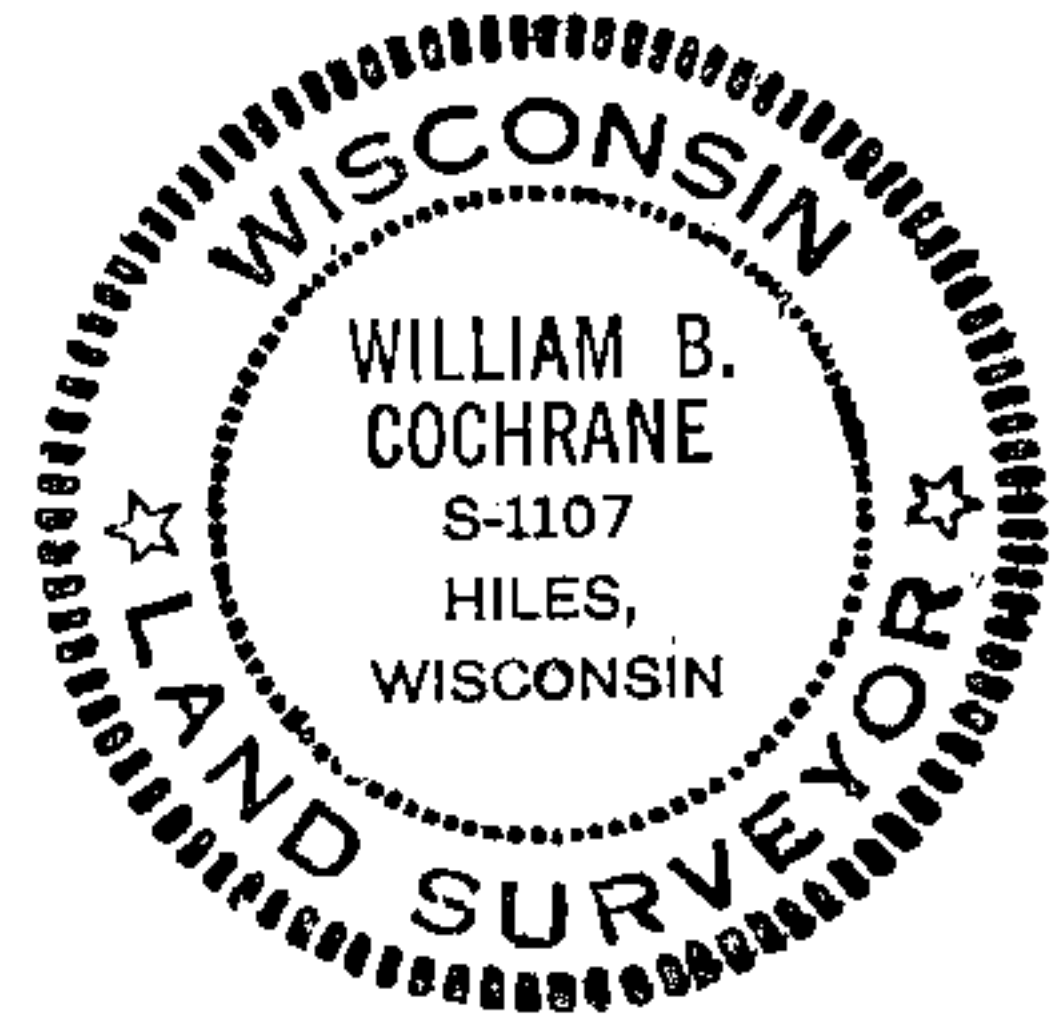

● - Corner monument restored  
□ -

Resident witnesses.....

Dated at Hiles Wisconsin, this 20th day of July 1982.

Signature William B. Cochrane Title Land Surveyor  
(County Surveyor, Registered Land Surveyor, or other duly authorized official)

Surveyors Registration No. S-1107

Office of Register of Deeds County of Forest

I hereby certify that the within instrument was filed in this office for record on the 7th day of October 1983, and was filed in Book No. Page No. of County Records.

Signature Eugene Stetson Title Register of Deeds

Township 40 North, Range 12 East, Section 3, Index No. E-17, Page No.

44012030000

17

U.S. PUBLIC LAND SURVEY MONUMENT RECORD

Index No. E-17

State of Wisconsin }  
County of FOREST } ss.

History of original corner establishment:

I Robert H. Winat, do hereby certify that on the seventh day of November, 1984, I found evidence of the NE section corner of Section 10 Township 40, North, Range 12 East, Fourth Principal Meridian, as described hereon; and that from this evidence I established ~~monument and~~ accessories as described hereon to perpetuate the original location of this corner.

1941 Dependent resurvey by Guy R. Veal of G.L.O. 20" Hemlock S45°W 71k (stump & log) orig  
7" Hemlock N34<sup>1</sup>/<sub>4</sub>°E 96 lks - 11" Y. Birch S53<sup>1</sup>/<sub>4</sub>°E 83 lks - 8" Y. Birch S 1°W 121 lks and  
8" Y. Birch N 5<sup>1</sup>/<sub>4</sub>°W 79 lks new  
Set mon't.

Description of corner evidence found:

G.L.O. mont. & Hemlock rampike N20°E 62.56' (1941)  
Hemlock Stump S 45°W 4.60' (orig.)

Resident witnesses:

Michael G. Stevens

Michael T. Lukasko

Description of ~~monument and~~ accessories I established to perpetuate the original location of this corner.

BT's. 10" Spruce S60°E, 56.52'  
12" Balsam S20°W, 28.80'  
10" " N75<sup>1</sup>/<sub>2</sub>°W, 37.30' to nail in side of tree  
11" Spruce N10°W, 55.18'  
metal sign post bears N 83°E, 1.29' from G.L.O. mont.

440 12030000

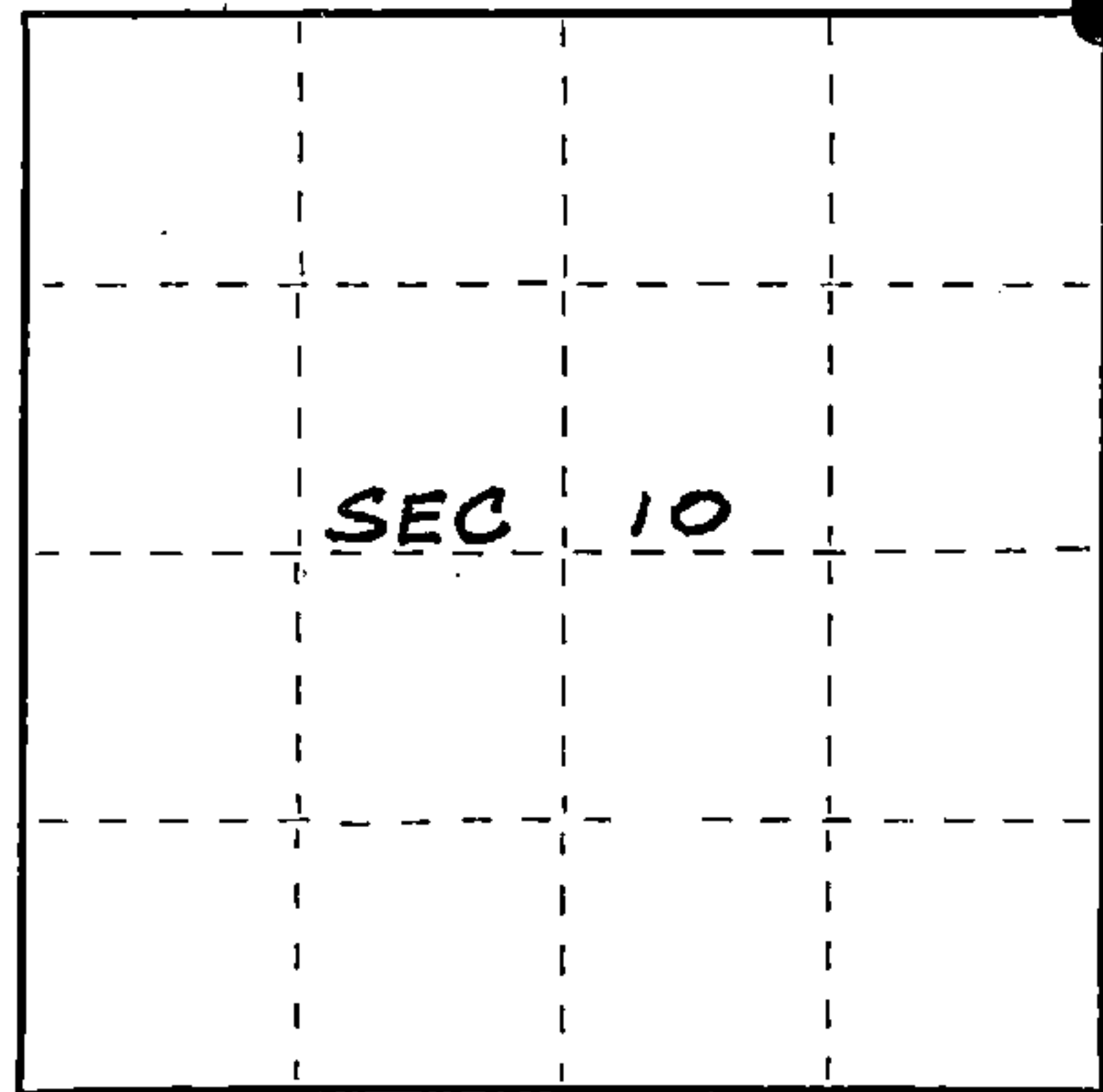

● = Corner monument restored.

(OVER)

Dated at Rhineland, Wis., this 4 day of June, 1985

Signature Robert H. Winat Title Land Surveyor Registration No. 1010  
(County Surveyor, Registered Land Surveyor, or other duly authorized official)

Office of Register of Deeds, County of Forest, I hereby certify that the within instrument was filed in this office for record on the 24th day of July, 1985 at 1:10 o'clock P. M.

Paul Aschenbrenner  
(Register of Deeds)

By..... Deputy

FORM NO. 985-A

H.C. Miller Company  
Lincoln, Wisconsin

Stock No. 26273

DOCUMENT NUMBER 128473

(e) Describe any material discrepancy between the location of the corner as restored or reestablished and the location of that corner as previously restored or reestablished by distance and direction. Show the discrepancy on the plan view drawing under (d), above. Show the distances between the corner as previously restored or reestablished and (1) the corner as restored or reestablished, and (2) to at least 2 of the witness monuments shown on the drawing in (d), above.

N/A

(f) Was the corner restored through acceptance of (1) an obliterated evidence location, or, (2) a found perpetuated location?

2

(g&h) Was the corner reestablished through lost corner proportionate methods? If so, show the method, including the directions and distances to other public land survey corners used as evidence or used for proportioning in determining the corner location?

no

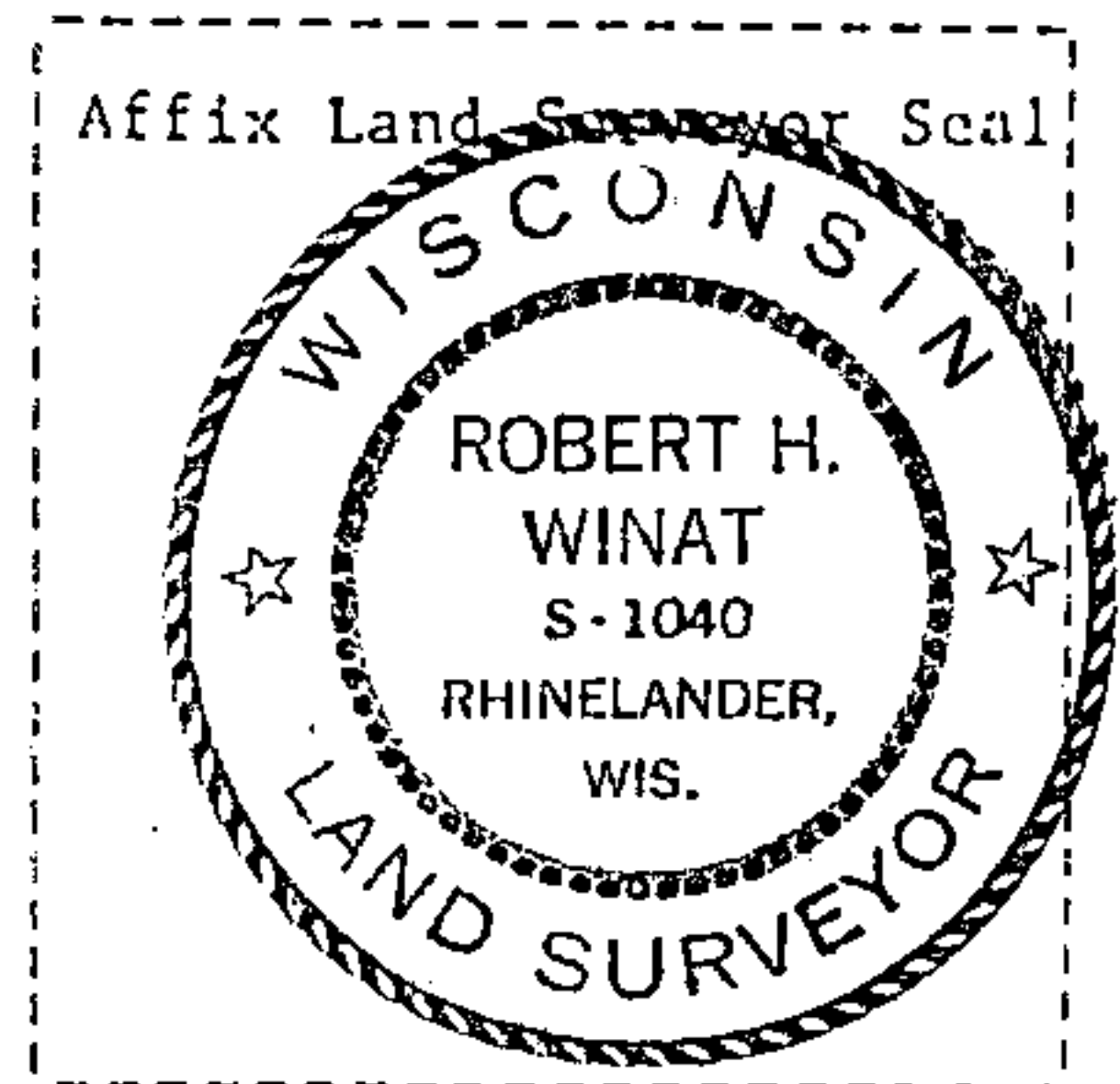
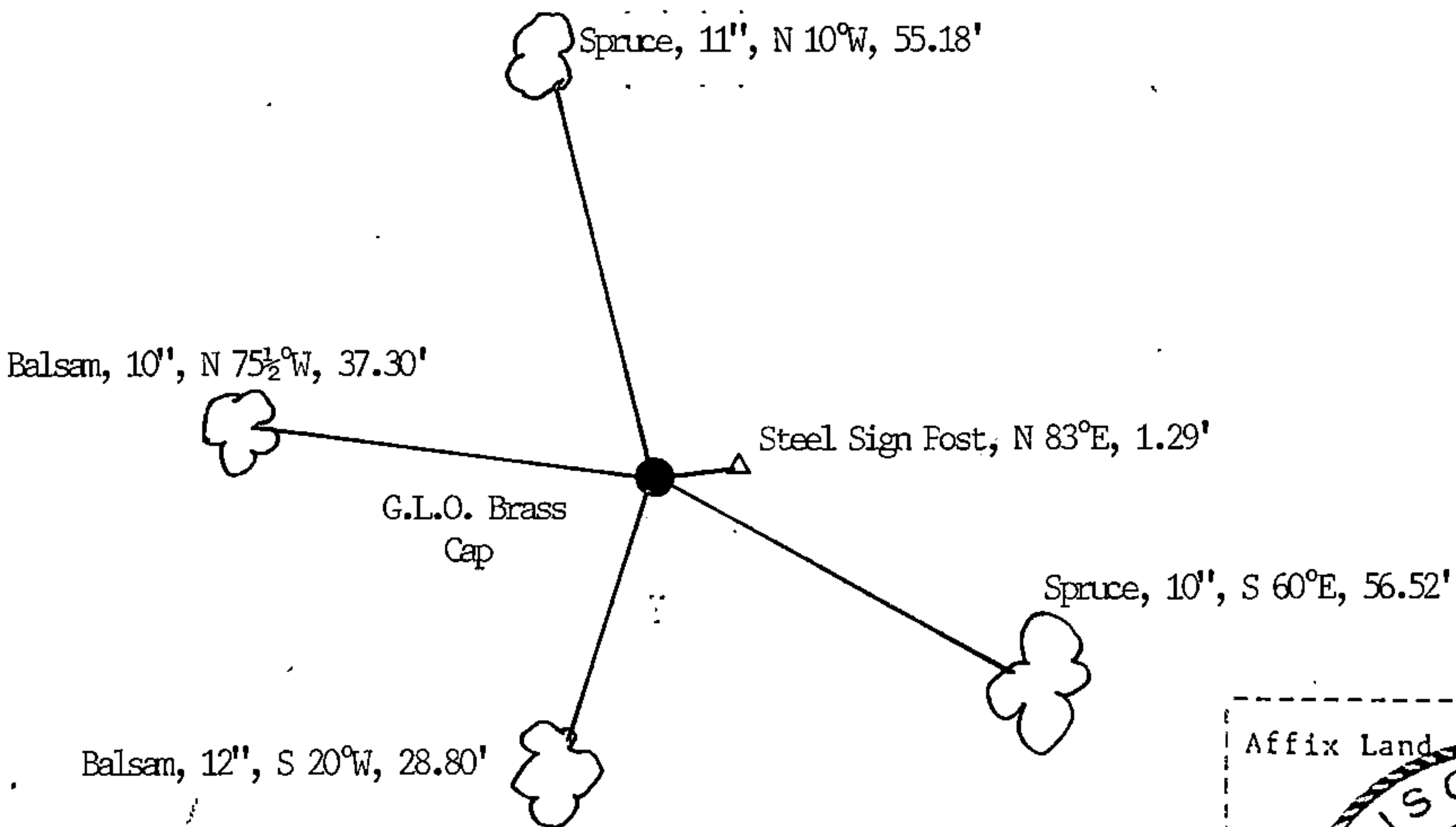

(i) I, Robert H. Winat  
(Type or print name) certify that the corner location shown on this record was determined by me or under my direction and control and that this U.S. Public Land Survey Monument Record is correct and complete to the best of my knowledge and belief.

Robert H. Winat  
Signature

4 June 1985  
Date