

CERTIFIED LAND CORNER RESTORATION

State of Wisconsin }
County of Forest } ss.

I William B. Cochrane, do hereby certify that on the 21st day of May, 1975, I found evidence of the South Quarter corner of Section 5 Township 39 North, Range 14 East, Fourth Principal Meridian, as described hereon; and that from this evidence I established a new monument and accessories as described hereon to perpetuate the original location of this corner:

Description of original monument and accessories and subsequent restorations:

Surveyed in 1865 by Wm. E. Daugherty and Alex McDill.
West corrected between Sections 5 and 8.
40.32 chains set quarter section post.
Birch, 14", S72°E, 49 Lks.
Birch, 8", N4°E, 35 Lks.
East, 4.32 chains enter swamp bears N and S.

Description of corner evidence found:

4x4 scribed wood post in place.
N4°E, 35 Lks., hardwood stump hole
S72°E, 47 Lks., large hardwood stump decayed flush with the ground
Maple, 22", S12°W, 86 Lks. scribed by unknown surveyor.
4.0 chains east, enter lowland edge bears N and S.

Description of monument and accessories I established to perpetuate the location of this corner:

I replaced the post with a 2 inch inside diameter, galvanized pipe, 3 feet long, filled with concrete with a brass cap stamped: T39N, R14E, 1/4, S5, S8, 1976, S-1107

From which the following bear:

Maple, 23", S10°W, 56.42 feet
Maple, 10", N17°W, 41.66 feet
Set a steel sign post NW of the monument, 0.50 ft.

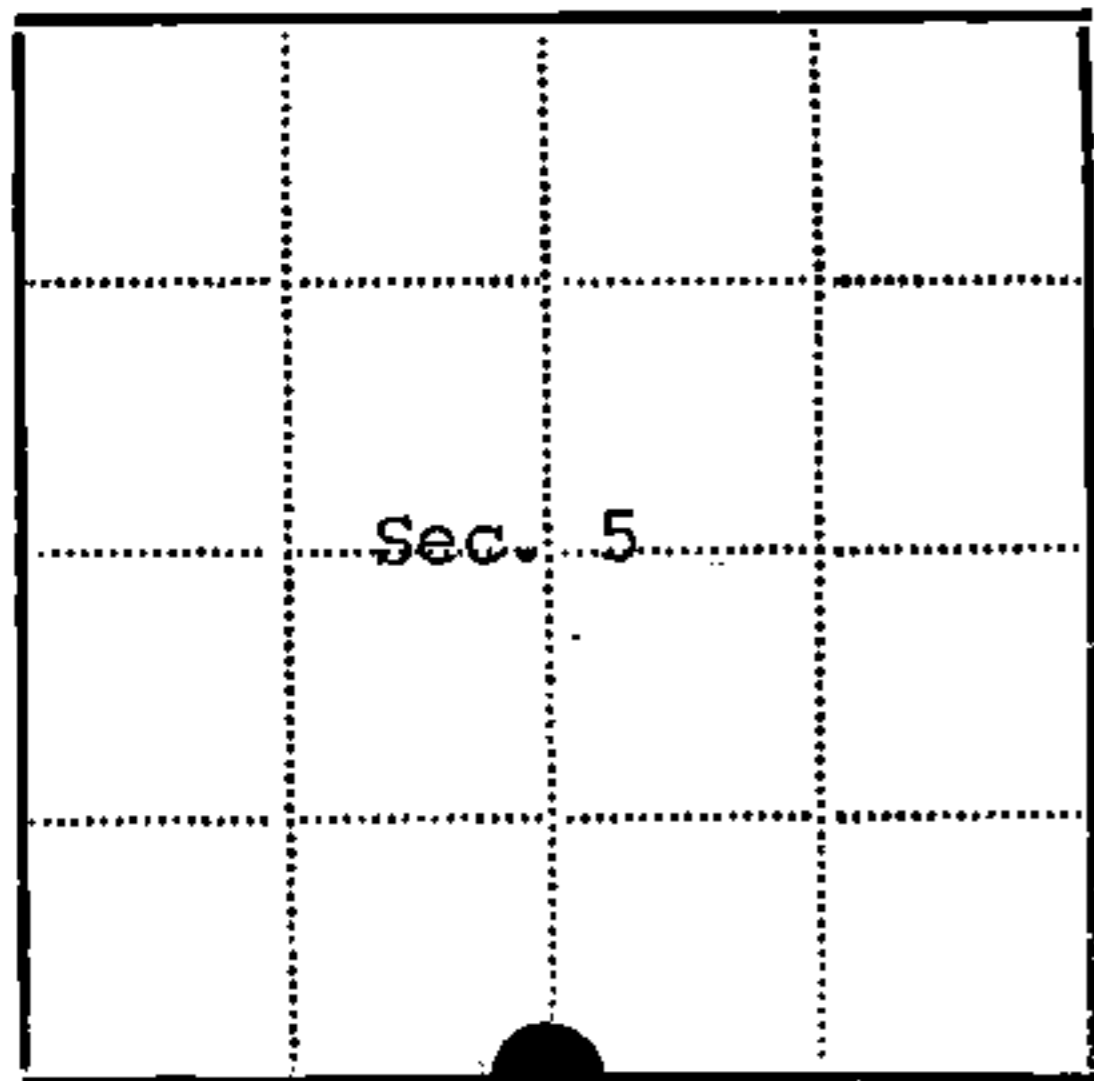
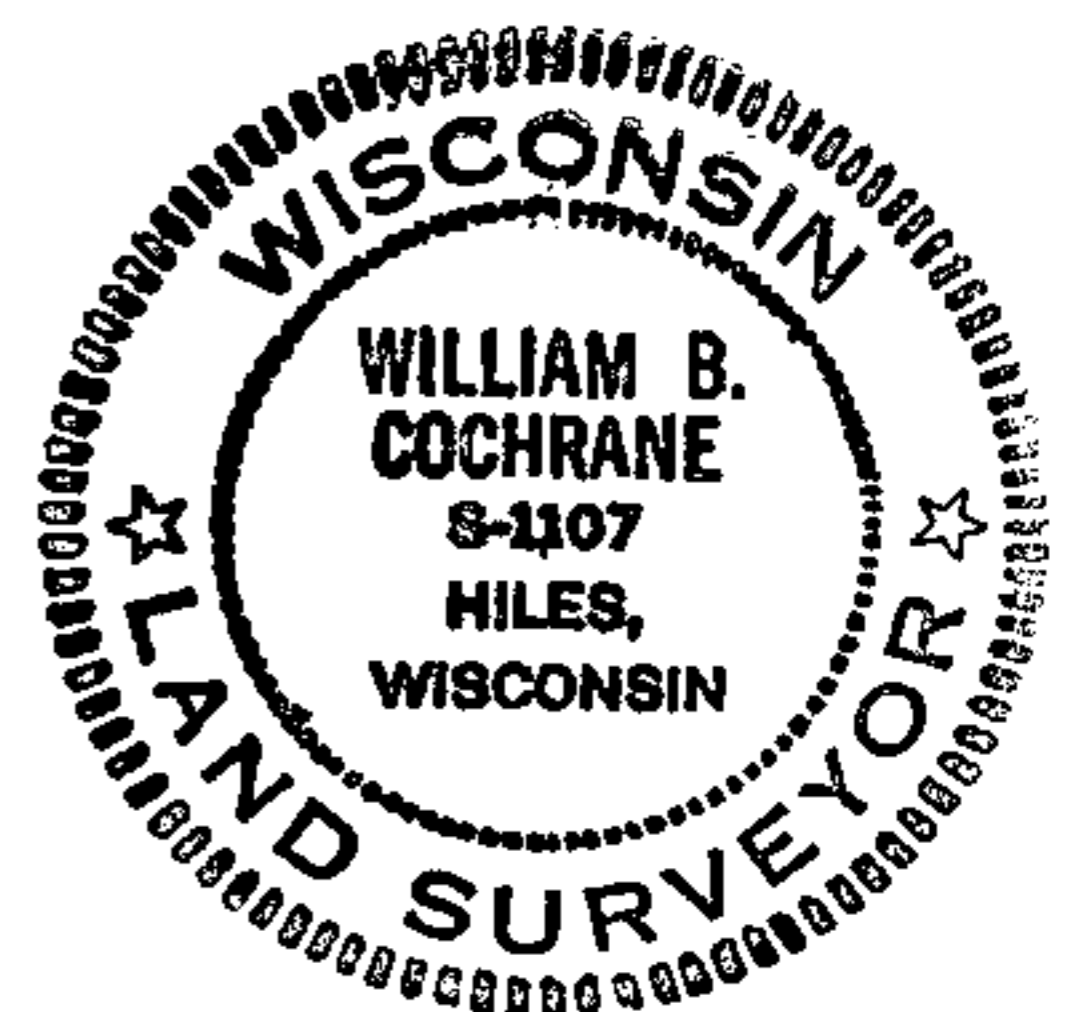

● - Corner monument restored
□ -

Resident witnesses.....

Dated at Laona Wisconsin, this 15 day of June 1976..

Signature William B. Cochrane Title Survey Technician
(County Surveyor, Registered Land Surveyor, or other duly authorized official)

Surveyors Registration No. S-1107

DOCUMENT NUMBER 109595

Office of Register of Deeds County of Forest

I hereby certify that the within instrument was filed in this office for record on the 2nd day of July 1976, and was filed in Book No. Page No. of County Records.

Signature Eugene Stutz Title Register of Deeds

Township 39 North, Range 14 East, Section 5, Index No. E-7, Page No.

439 14050020

U.S. PUBLIC LAND SURVEY MONUMENT RECORD

Index No. E-7

State of Wisconsin }
County of Forest } ss.

I William B. Cochrane, do hereby certify that on the 13th day of August, 1985, I found evidence of the South Quarter corner of Section 5 Township 39 North, Range 14 East, Fourth Principal Meridian, as described hereon; and that from this evidence I established a new monument and accessories as described hereon to perpetuate the original location of this corner.

Resident witnesses:

Tony Tillman
.....
.....
.....

State Plane Co-ordinates
N- 263,266.0620
E-2,313,722.6410

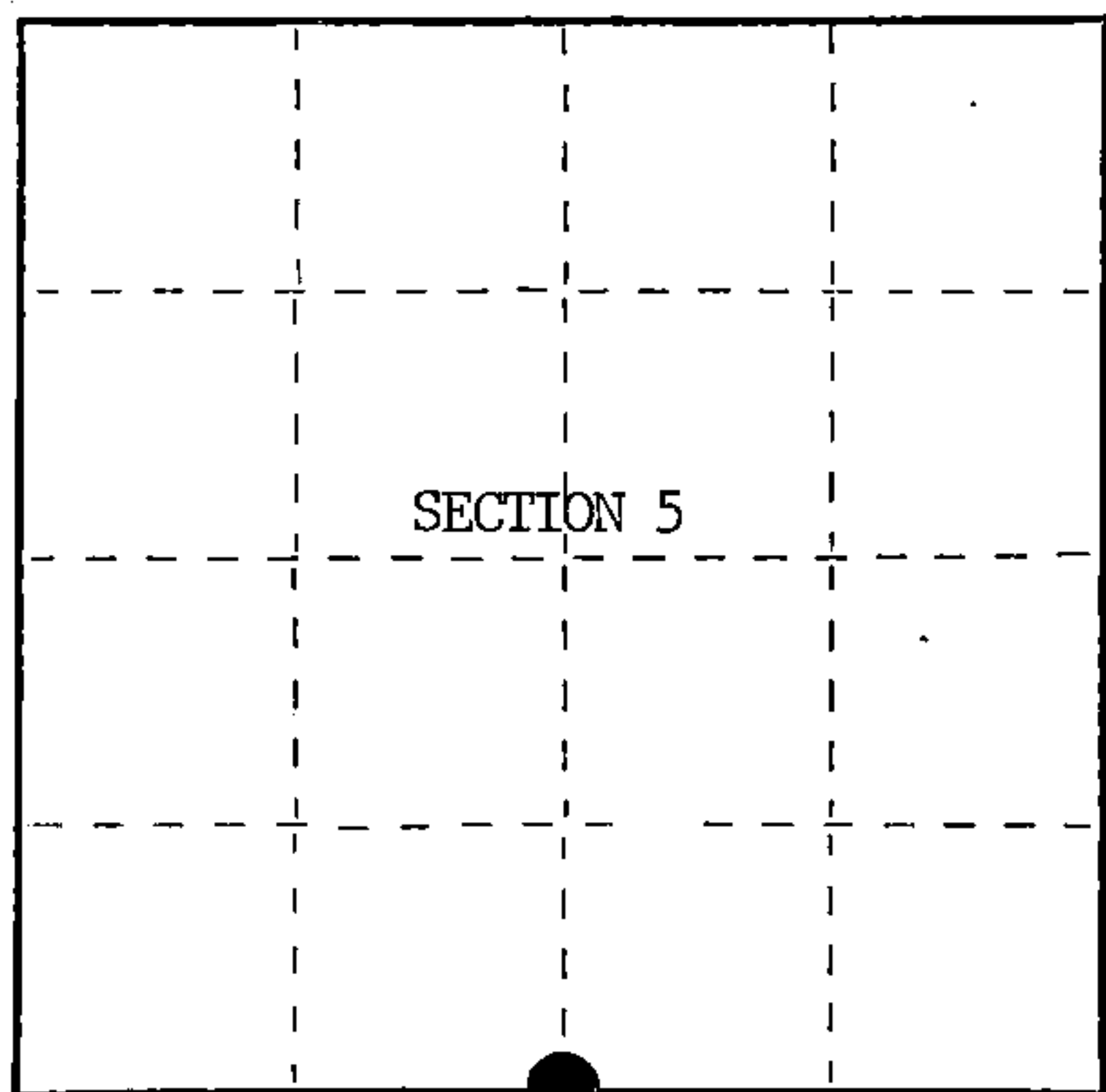

○ = Corner monument restored.

History of original corner establishment:

Original Government Survey in 1865 by William E. Daugherty, and Alex McDill.

Corner restored on May 21st, 1975, by William B. Cochrane, a Registered Land Surveyor with the U.S. Forest Service.

See Certified Land Corner Restoration Certificate #108595, filed in the Registrar of Deeds Office, in the Forest County Courthouse.

Description of corner evidence found:

Found monument as described and in place, from which the following bear;

| | | | |
|---------------|-----|-------|------------|
| Maple(Tipout) | 24" | S10°W | 56.42 feet |
| Maple | 10" | N17°W | 41.66 feet |

Description of monument and accessories I established to perpetuate the original location of this corner.

Blazed and scribed the following new bearing trees;

| | | | |
|-------|----|-------|------------|
| Maple | 9" | S71°W | 63.57 feet |
| Maple | 5" | N26°W | 74.62 feet |

Re-set Steel Sign Post NW 1.00 feet

Dated at Hiles, Wis., this 27th day of February, 1986.

Signature *William B. Cochrane* Title Land Surveyor Registration No. S-1107
(County Surveyor, Registered Land Surveyor, or other duly authorized official)

Office of Register of Deeds, County of Forest, I hereby certify that the within instrument was filed in this office for record on the 11th day of March, 1987 at 3:30 o'clock P. M.

Paul Aschentrener
(Register of Deeds)

By.....Deputy

FORM NO. 985-A

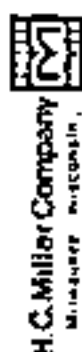

Stock No. 26273

DOCUMENT NUMBER 132326

439 14 05 0020

