

CERTIFIED LAND CORNER RESTORATION

Index No. R-17

State of Wisconsin }  
County of Forest } ss.

History of original corner establishment:  
Original Government Survey by William E. Daugherty in 1865.  
North between sections 26 and 27, at 80 chains set post. from which:  
Sugar 10" N72°E 10 lks  
Birch 10" S45°W 40 lks

I, William B. Cochran, do hereby certify that on the 26 th day of July, 19 94, I found evidence of the Northeast Section corner of Section 27 Township 39 North, Range 13 East, Fourth Principal Meridian, as described hereon; and that from this evidence I established a new monument and accessories as described hereon to perpetuate the original location of this corner.

Description of corner evidence found:

Found scribed 4"X4" wood post, No evidence of original corner.

Resident witnesses:

Description of monument and accessories I established to perpetuate the original location of this corner.

In place of wood post accepted as best remaining evidence of the corner position. Set a 2½"X36" aluminum pipe monument 2½ feet in the ground with an aluminum cap stamped: T39N, R13E, S22, S23, S26, S27, 1994, S-1107. From which:

Maple 9" N56°E 23.51'  
Maple 8" S22°E 25.80'  
Maple 8" S45°W 36.41'  
Maple 8" N39°W 35.35'  
Steel sign post West .75'

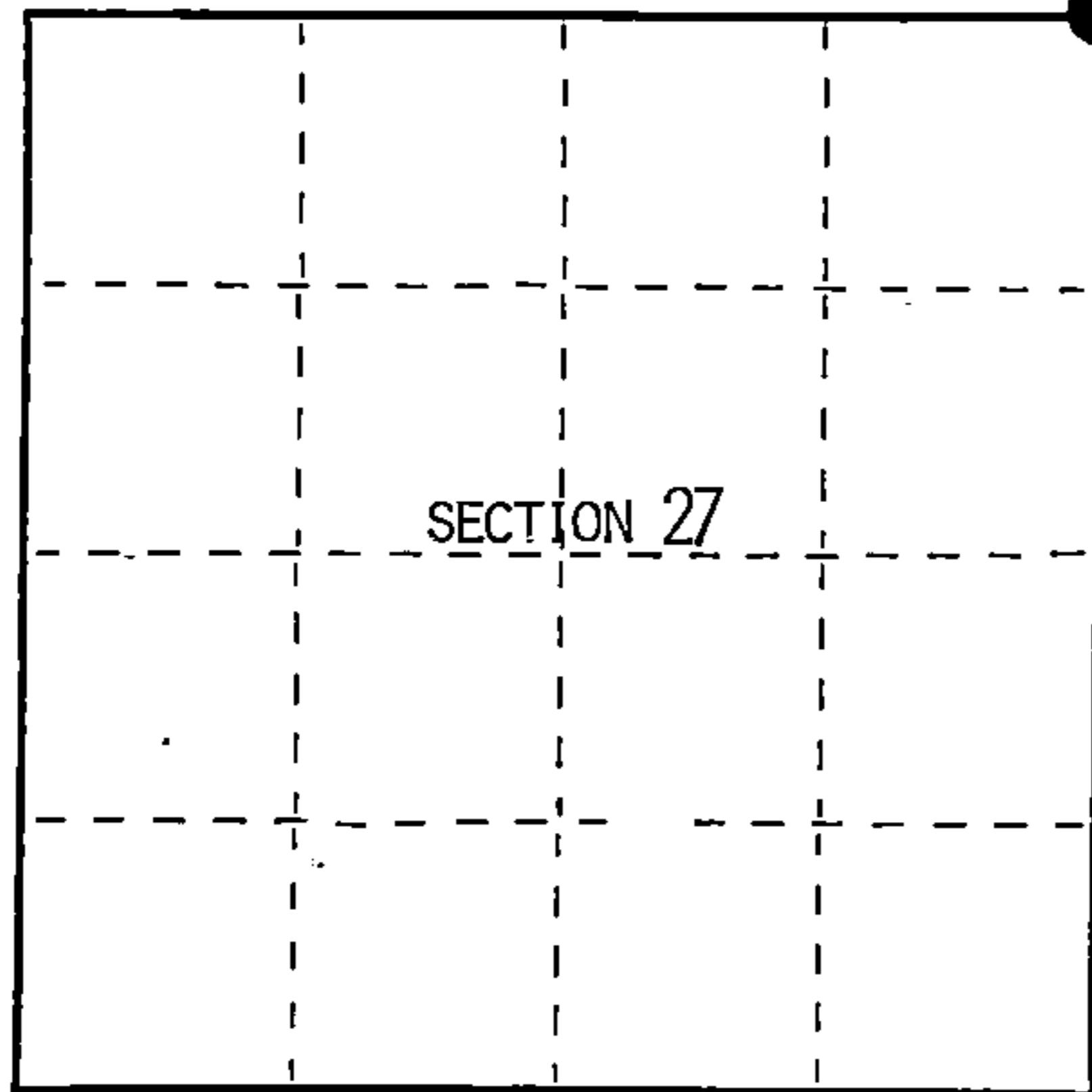

● = Corner monument restored.

Dated at Hiles, Wis., this 13 th day of December, 19 94

Signature: William B. Cochran Title: Land Surveyor Registration No. S-1107  
(County Surveyor, Registered Land Surveyor, or other duly authorized official)

Office of Register of Deeds, County of Forest, I hereby certify that the within instrument was filed in this office for record on the 23rd day of August, 19 96 at 2:30 o'clock P. M.

(Register of Deeds)  
By: [Signature] Deputy

FORM NO. 985-A



Stock No. 26273

156578

43913220000

(e) Describe any material discrepancy between the location of the corner as restored or reestablished and the location of that corner as previously restored or reestablished by distance and direction. Show the discrepancy on the plan view drawing under (d), above. Show the distances between the corner as previously restored or reestablished and (1) the corner as restored or reestablished, and (2) to at least 2 of the witness monuments shown on the drawing in (d), above.

See drawing below.

(f) Was the corner restored through acceptance of (1) an obliterated evidence location, or, (2) a found perpetuated location?

Corner restored from recovered 4"X4" scribed wood post accepted as best remaining evidence of the corner position.

(g&h) Was the corner reestablished through lost corner proportionate methods? If so, show the method, including the directions and distances to other public land survey corners used as evidence or used for proportioning in determining the corner location?

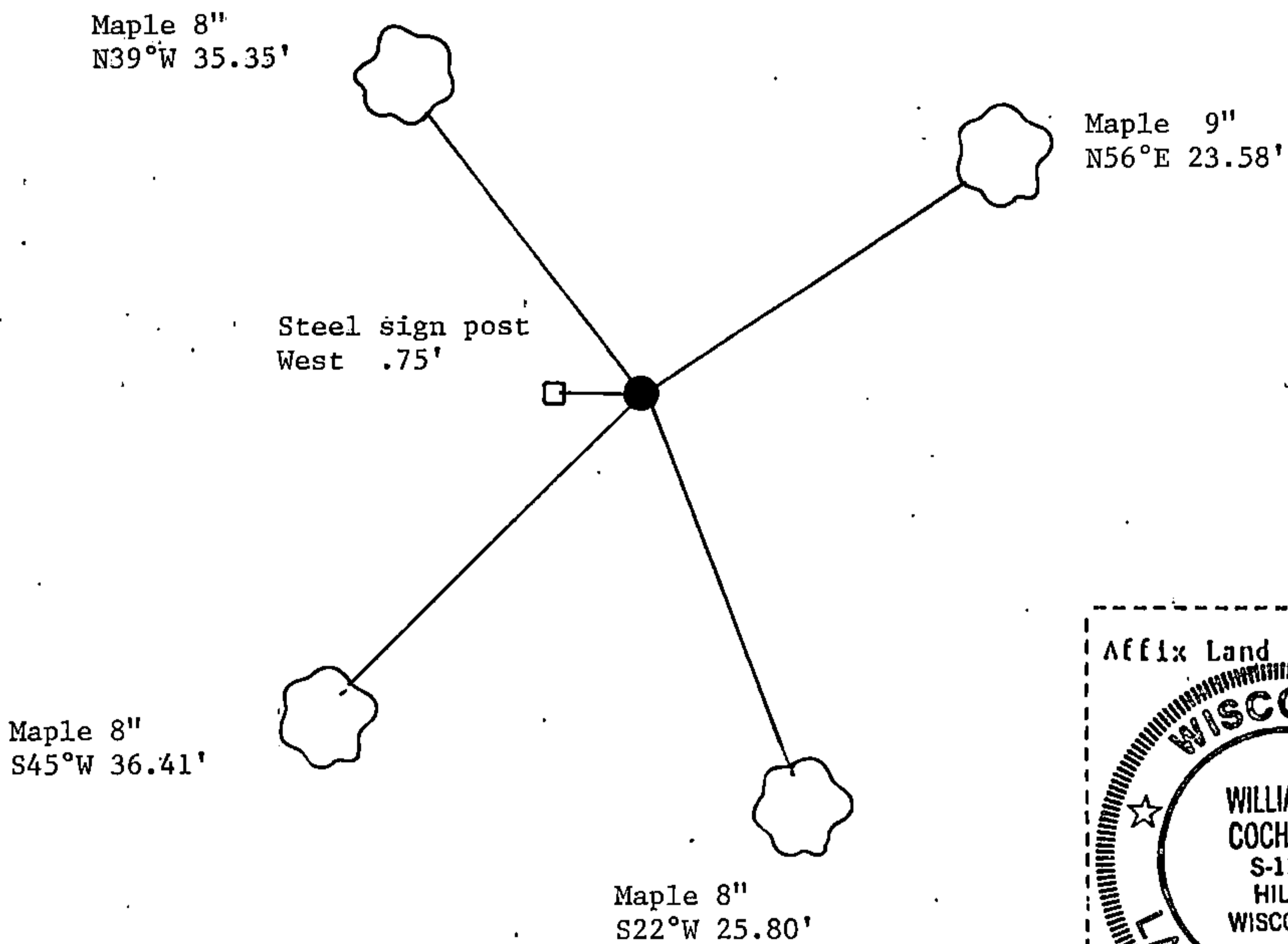

William B. Cochrane

(i) I, William B. Cochrane (type or print name) certify that the corner location shown on this record was determined by me or under my direction and control and that this U.S. Public Land Survey Monument Record is correct and complete to the best of my knowledge and belief.

William B. Cochrane Signature 12/13/24 Date

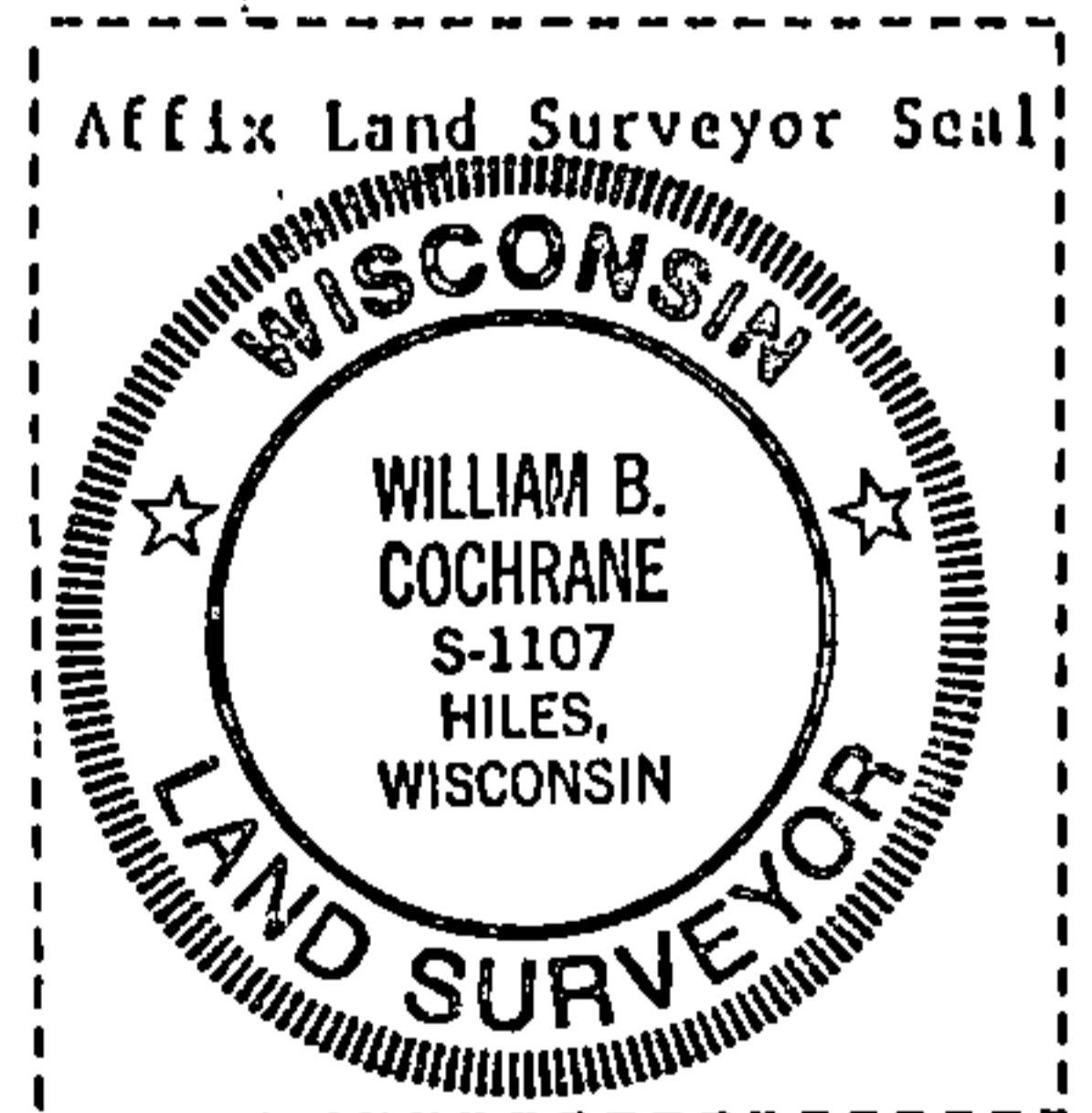

Survey requested by: \_\_\_\_\_  
District Ranger Date