

CERTIFIED LAND CORNER RESTORATION

State of Wisconsin }  
County of Forest } ss.

I William B. Cochrane, do hereby certify that on the 10th day of October, 1974, I found evidence of the West Quarter corner of Section 7 Township 39 North, Range 14 East, Fourth Principal Meridian, as described hereon; and that from this evidence I established a new monument and accessories as described hereon to perpetuate the original location of this corner:

Description of original monument and accessories and subsequent restorations:

Surveyed in 1858 by Alfred Millard  
North between Sections 7 and 12. 40.0 chains set quarter section post between Section 7 and 12.  
Fir, 10", S82°W, 13 lks.  
Spruce, 14", S85°E, 13 lks.  
3.50 chains south, stream, 4 lks., runs SE  
4.0 chains, North leave swamp bears E & W

Description of corner evidence found:

6 x 6 squared cedar post.  
At a point S85°E, 13 lks. from the post, found two picket points in a stump hole.  
At a point S82°W, 13 lks from the post, found a stump believed to be balsam.  
3.5 chains south, stream, 4 lks., runs SE  
4.0 chains north, leave swamp.

Description of monument and accessories I established to perpetuate the location of this corner:

I replaced the post found with a 2 inch inside diameter, galvanized pipe, 5 feet long, filled with concrete, with a brass cap stamped: T39N, R13E, R14E, 1/4, S7, S12, 1975, S-1107. From which the following bear:  
Y. Birch, 15", S22°E, 23.86 feet.  
Hemlock, 11", N2°E, 25.10 feet.  
Set a steel sign post, SW of the monument 0.50 feet.

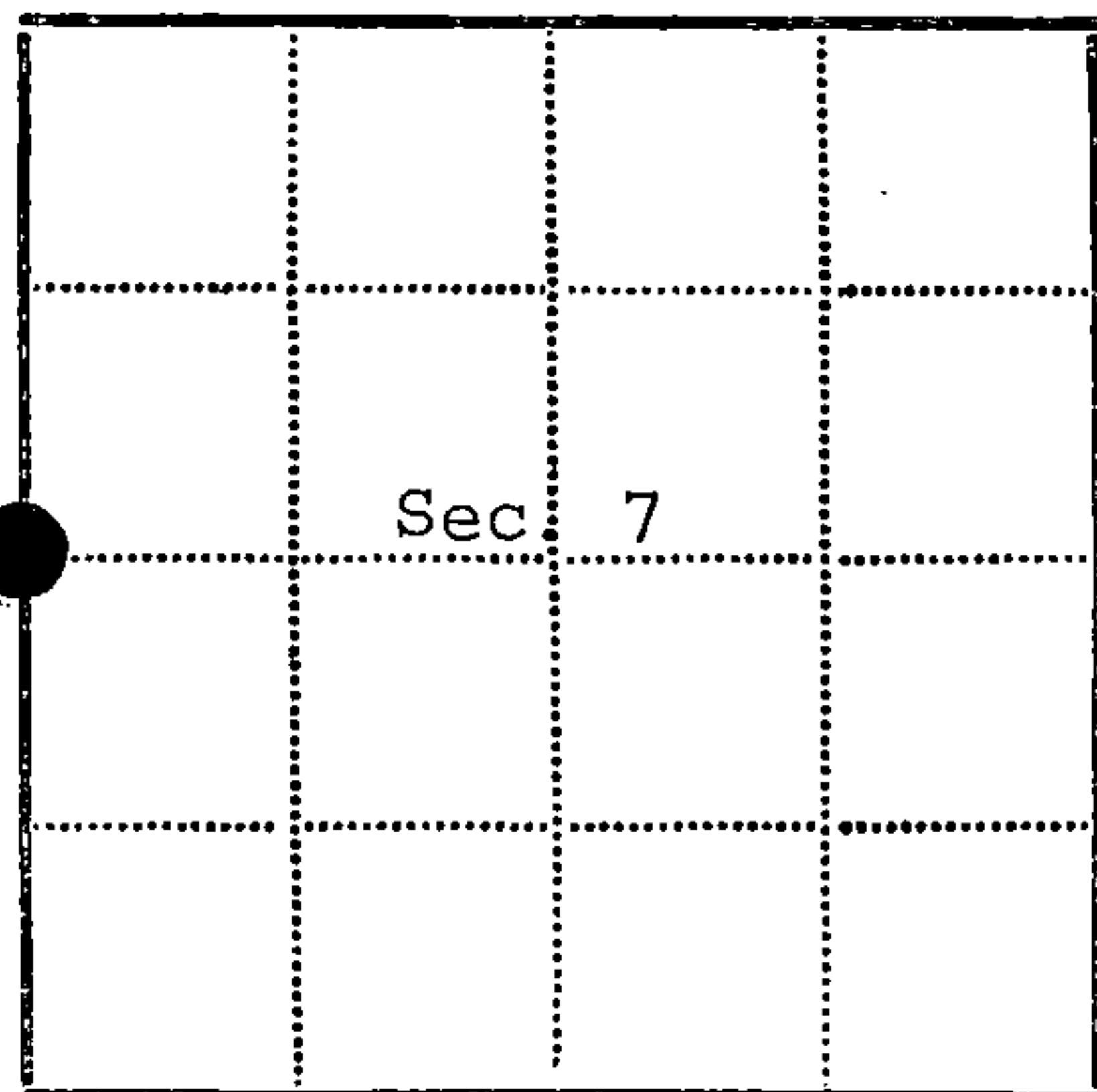
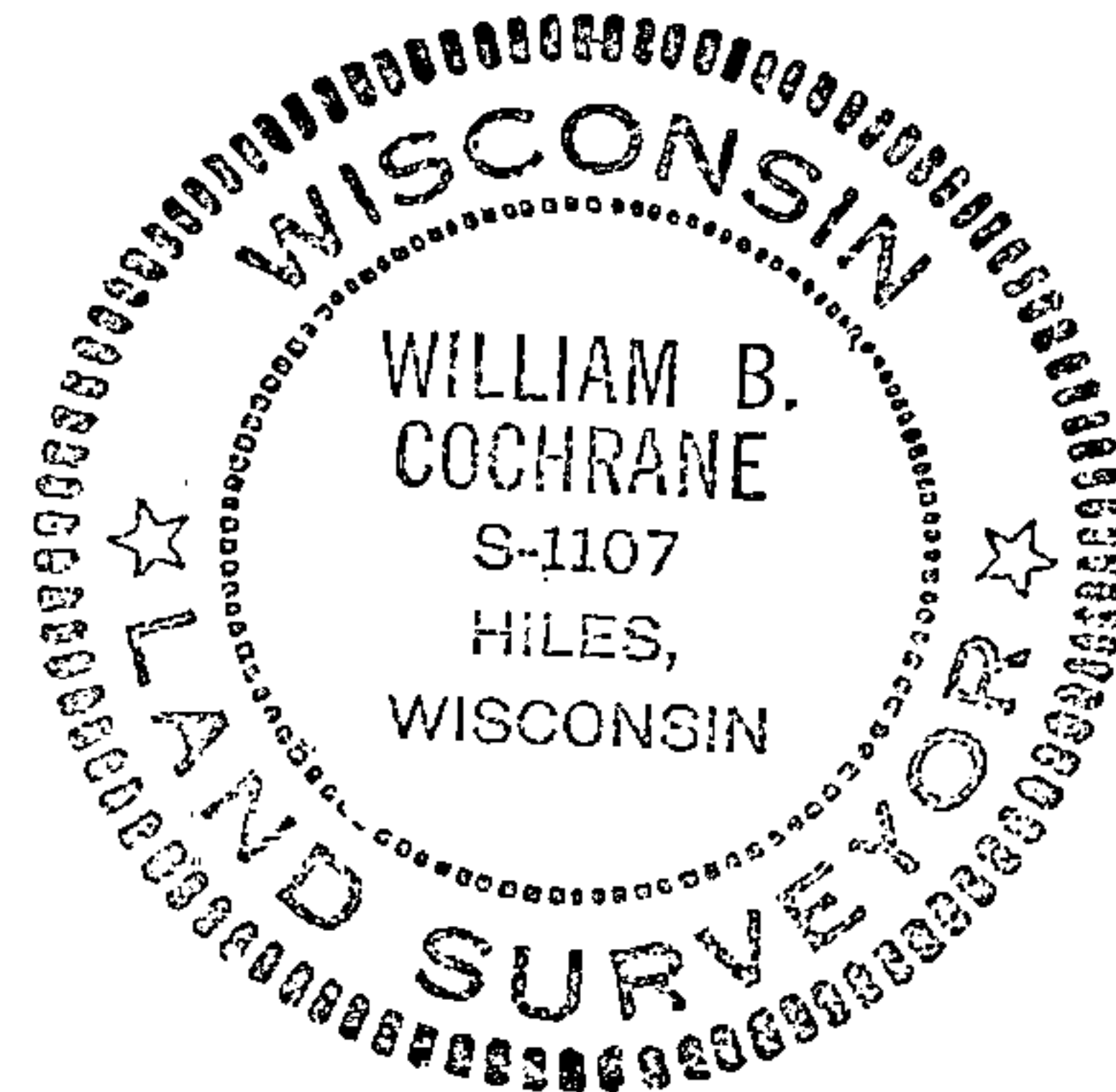

● = Corner monument restored  
□ =

Resident witnesses.....

Dated at Three Lakes Wisconsin, this 10th day of June 1975.

Signature William B. Cochrane Title Survey Technician  
(County Surveyor, Registered Land Surveyor, or other duly authorized official)

Surveyors Registration No. S-1107. NUMBER 107233

Office of Register of Deeds County of Forest

I hereby certify that the within instrument was filed in this office for record on the 16th day of June 1975, and was filed in Book No. Page No. of County Records.

Signature Eugene Stately Title Register of Deeds

Township 39 North, Range 14 East, Section 7, Index No. G-1, Page No.

4 3913 122000

G 1

U.S. PUBLIC LAND SURVEY MONUMENT RECORD

Index No. G-25

State of Wisconsin }  
County of Forest } ss.

I, William B. Cochrane, do hereby certify that on the 29th day of August, 1985, I found evidence of the East Quarter corner of Section 12, Township 39, North, Range 13 East, Fourth Principal Meridian, as described hereon; and that from this evidence I established a new monument and accessories as described hereon to perpetuate the original location of this corner.

Resident witnesses:

Tony Tillman

State Plane Co-ordinates  
N- 260,322.7502  
E-2,305,760.7320

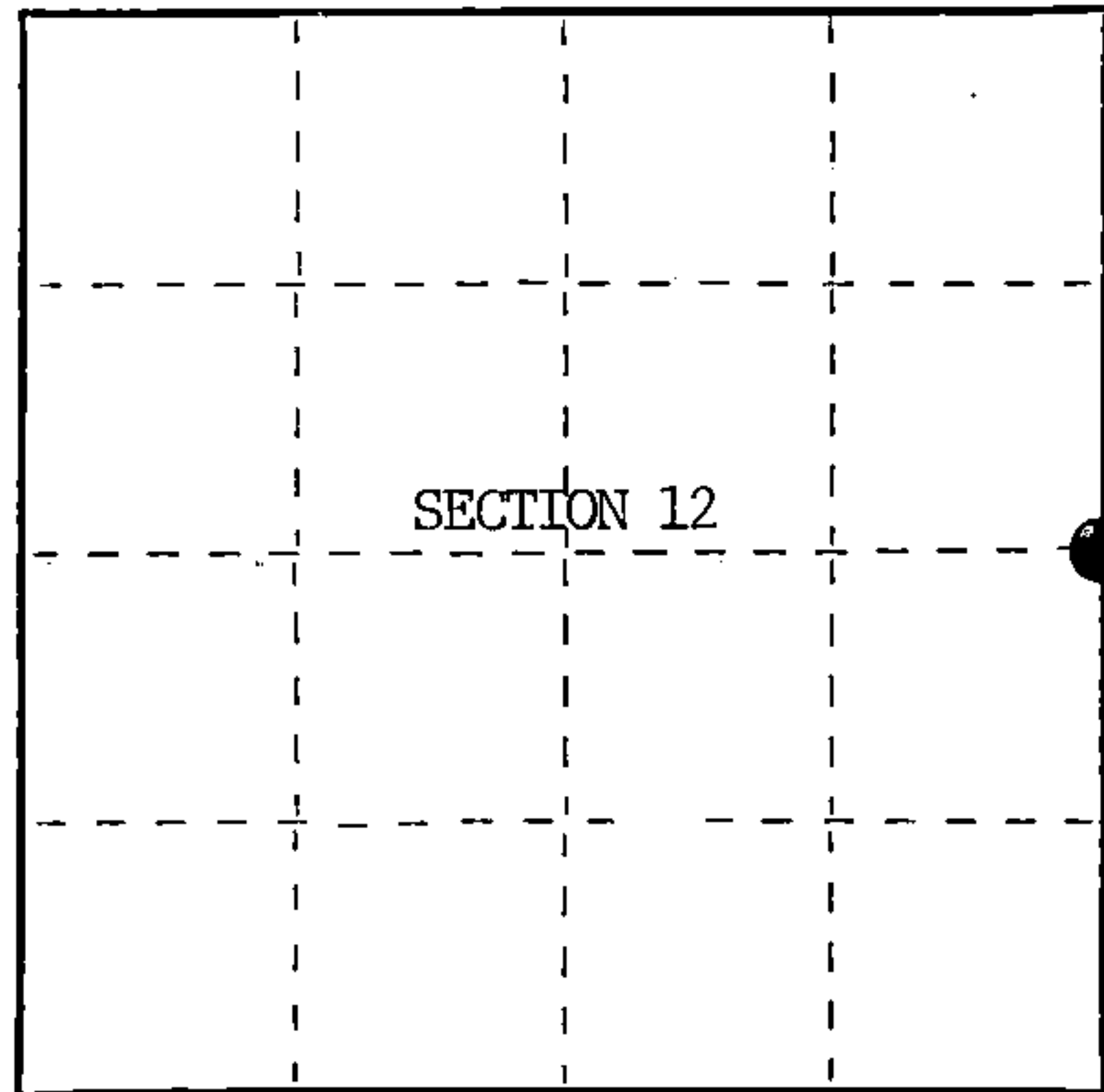

○ = Corner monument restored.

History of original corner establishment:

Original Government Survey in 1858 by Artemas Curtis.

Corner restored in 1971, by William B. Cochrane, a Registered Land Surveyor with the U.S. Forest Service.

See Document #119754, filed in the Registrar of Deeds Office, in the Forest County Courthouse.

Description of corner evidence found:

Found monument as described and in place, from which the following bear;

Maple	9"	S49°W	18.30 feet
Maple	11"	N54°W	16.97 feet
Steel Sign Post		East	0.50 feet

All of the above bearing trees were cut down for the Aerial Photo Project.

Description of monument and accessories I established to perpetuate the original location of this corner.

Blazed and scribed the following new bearing trees;

Maple	8"	N10°E	84.45 feet
Maple	9"	S86°E	62.79 feet

Re-set Steel Sign Post NW 2.00 feet

Dated at Hiles, Wis., this 6th day of February, 1986

Signature *William B. Cochrane* Title Land Surveyor Registration No. S-1107  
(County Surveyor, Registered Land Surveyor, or other duly authorized official)

Office of Register of Deeds, County of Forest, I hereby certify that the within instrument was filed in this office for record on the 11th day of March, 1987 at 3:30 o'clock P. M.

*Faul Aschenbrenner*  
(Register of Deeds)

By \_\_\_\_\_ Deputy

FORM NO. 985-A

H.C. Miller Company

Stock No. 26273

DOCUMENT NUMBER 132301

43913122000

(e) Describe any material discrepancy between the location of the corner as restored or reestablished and the location of that corner as previously restored or reestablished by distance and direction. Show the discrepancy on the plan view drawing under (d), above. Show the distances between the corner as previously restored or reestablished and (1) the corner as restored or reestablished, and (2) to at least 2 of the witness monuments shown on the drawing in (d), above.

See drawing below.

(f) Was the corner restored through acceptance of (1) an obliterated evidence location, or, (2) a found perpetuated location?

Restored through acceptance of a found perpetuated location.

(g&h) Was the corner reestablished through lost corner proportionate methods? If so, show the method, including the directions and distances to other public land survey corners used as evidence or used for proportioning in determining the corner location?

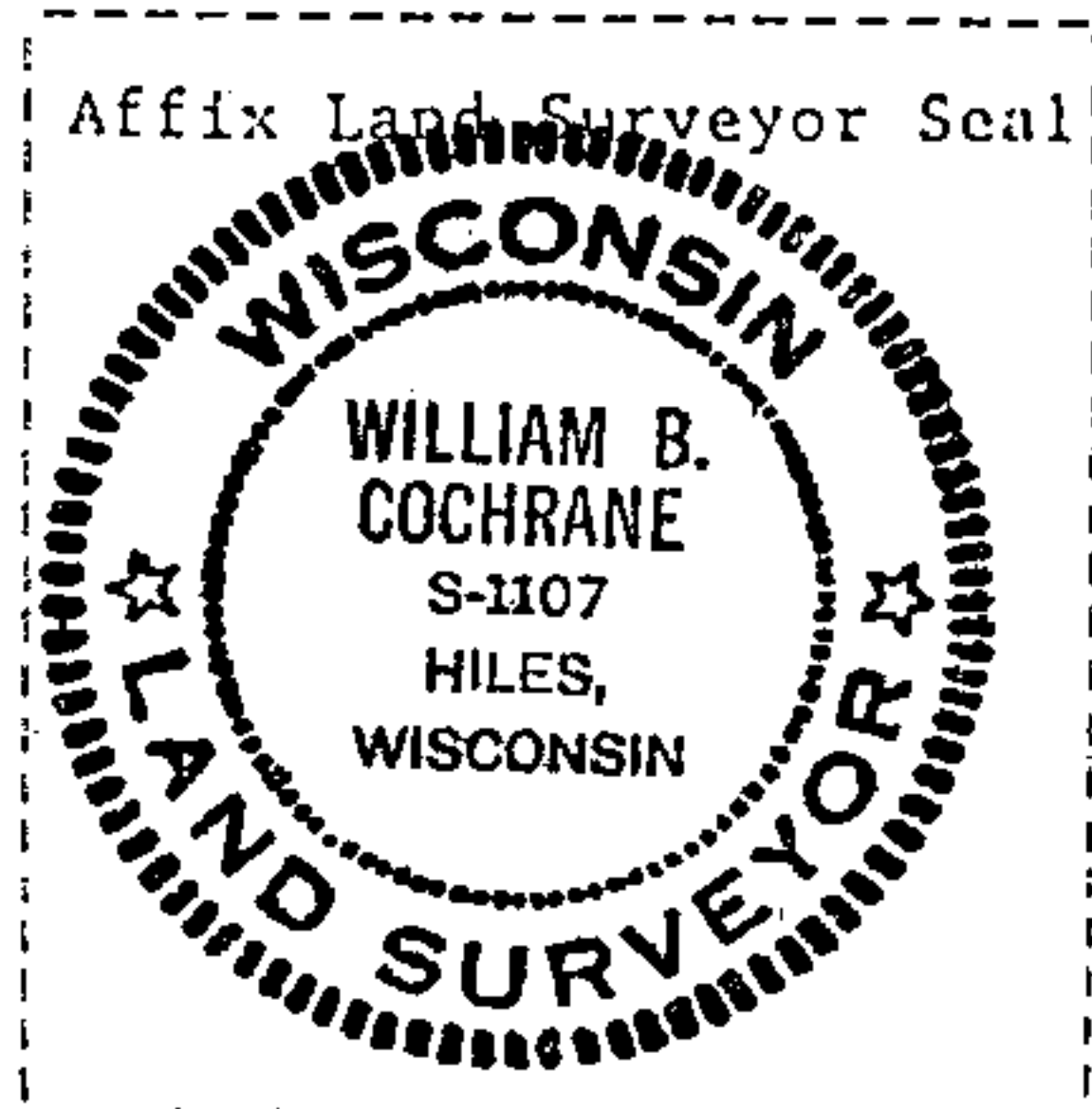
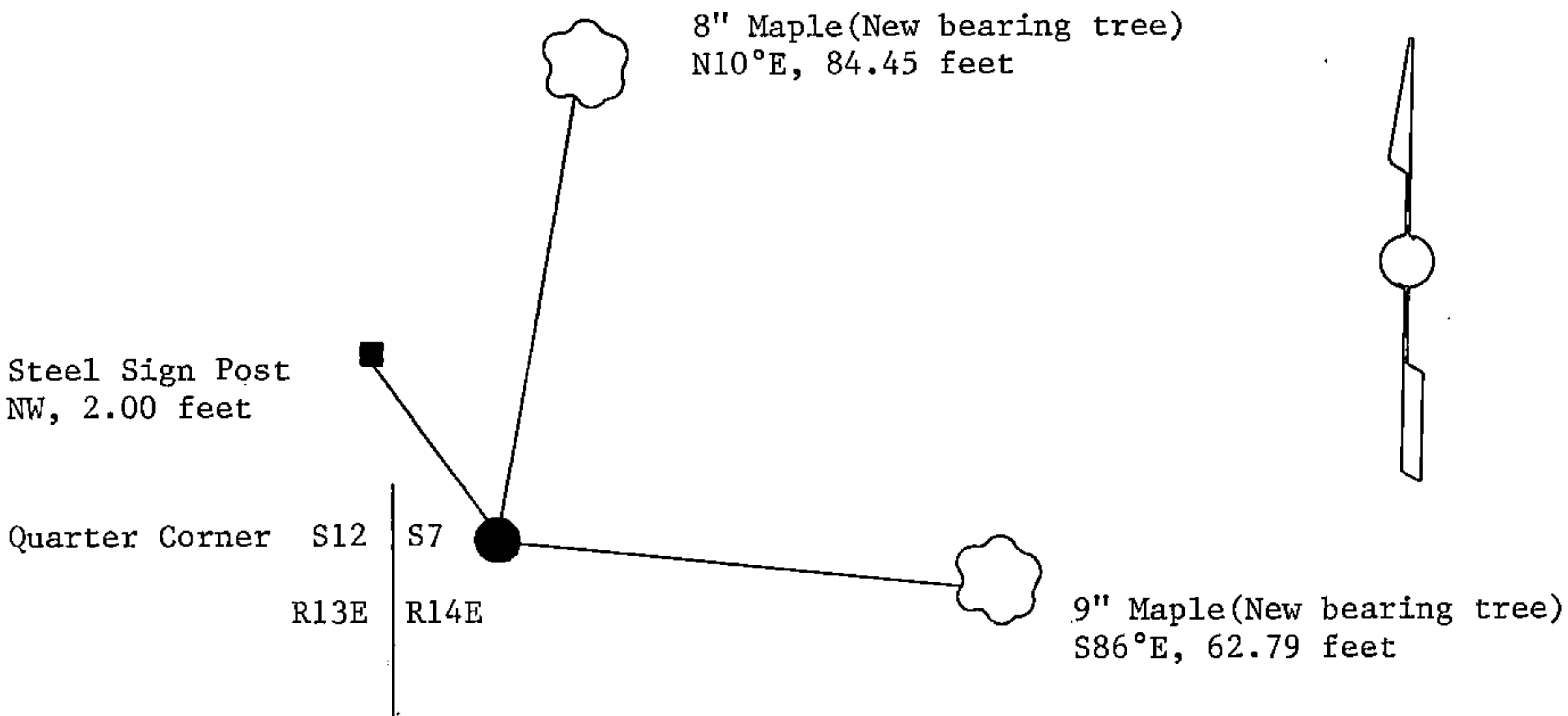

(i) I, William B. Cochrane  
 (type or print name) certify that the corner location shown on this record was determined by me or under my direction and control and that this U.S. Public Land Survey Monument Record is correct and complete to the best of my knowledge and belief.

William B. Cochrane October 7, 1986  
 Signature Date

Survey requested by: [Signature] 3-9-87  
 District Ranger Date



U.S. PUBLIC LAND SURVEY MONUMENT RECORD

Index No. G-1

State of Wisconsin }  
County of Forest } ss.

I, William B. Cochrane, do hereby certify that on the 29th day of August, 1985, I found evidence of the West Quarter corner of Section 7 Township 39 North, Range 14 East, Fourth Principal Meridian, as described hereon; and that from this evidence I established a new monument and accessories as described hereon to perpetuate the original location of this corner.

Resident witnesses:

Tony Tillman

State Plane Co-ordinates  
N- 260,322.7502  
E-2,305,760.7320

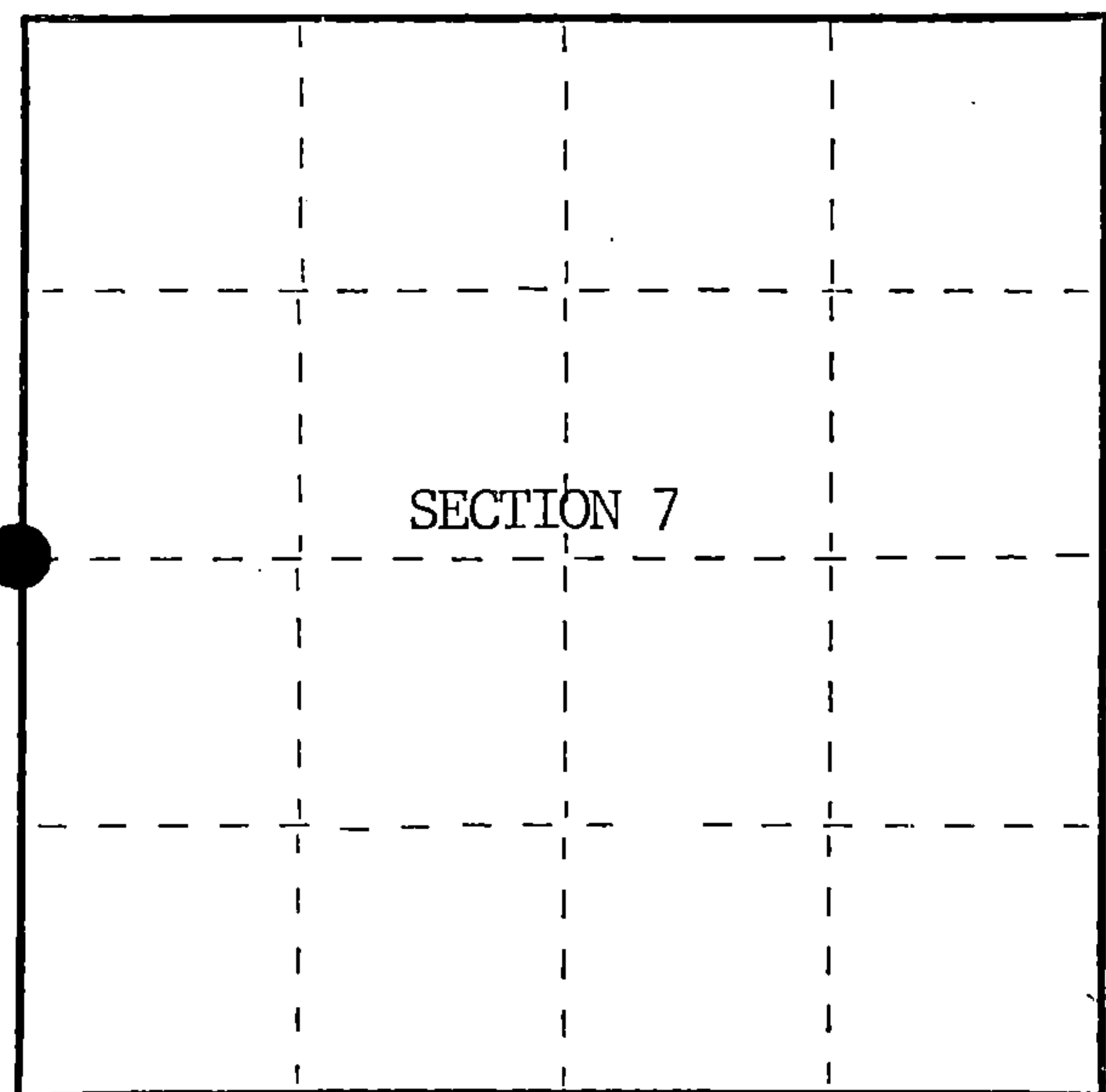

○ = Corner monument restored.

History of original corner establishment:

Original Government Survey in 1858 by Artemas Curtis.

Corner restored in 1971, by William B. Cochrane, a Registered Land Surveyor with the U.S. Forest Service.

See Document #119754, filed in the Registrar of Deeds Office, in the Forest County Courthouse.

Description of corner evidence found:

Found monument as described and in place, from which the following bear;

Maple	9"	S49°W	18.30 feet
Maple	11"	N54°W	16.97 feet
Steel Sign Post		East	0.50 feet

All of the above bearing trees were cut down for the Aerial Photo Project.

Description of monument and accessories I established to perpetuate the original location of this corner.

Blazed and scribed the following new bearing trees;

Maple	8"	N10°E	84.45 feet
Maple	9"	S86°E	62.79 feet

Re-set Steel Sign Post NW 2.00 feet

Dated at Hiles, Wis., this 6th day of February, 1986

Signature *William B. Cochrane* Title Land Surveyor Registration No. S-1107  
(County Surveyor, Registered Land Surveyor, or other duly authorized official)

Office of Register of Deeds, County of Forest, I hereby certify that the within instrument was filed in this office for record on the 11th day of March, 1987 at 3:30 o'clock P.M.

*Paul Achenbrenner*  
(Register of Deeds)

By \_\_\_\_\_ Deputy

FORM NO. 985-A

H.C. Miller Company  
MILWAUKEE, WISCONSIN

Stock No. 26273

DOCUMENT NUMBER 132334

439 13 12 2000

(e) Describe any material discrepancy between the location of the corner as restored or reestablished and the location of that corner as previously restored or reestablished by distance and direction. Show the discrepancy on the plan view drawing under (d), above. Show the distances between the corner as previously restored or reestablished and (1) the corner as restored or reestablished, and (2) to at least 2 of the witness monuments shown on the drawing in (d), above.

See drawing below.

(f) Was the corner restored through acceptance of (1) an obliterated evidence location, or, (2) a found perpetuated location?

Restored through acceptance of a found perpetuated location.

(g&h) Was the corner reestablished through lost corner proportionate methods? If so, show the method, including the directions and distances to other public land survey corners used as evidence or used for proportioning in determining the corner location?

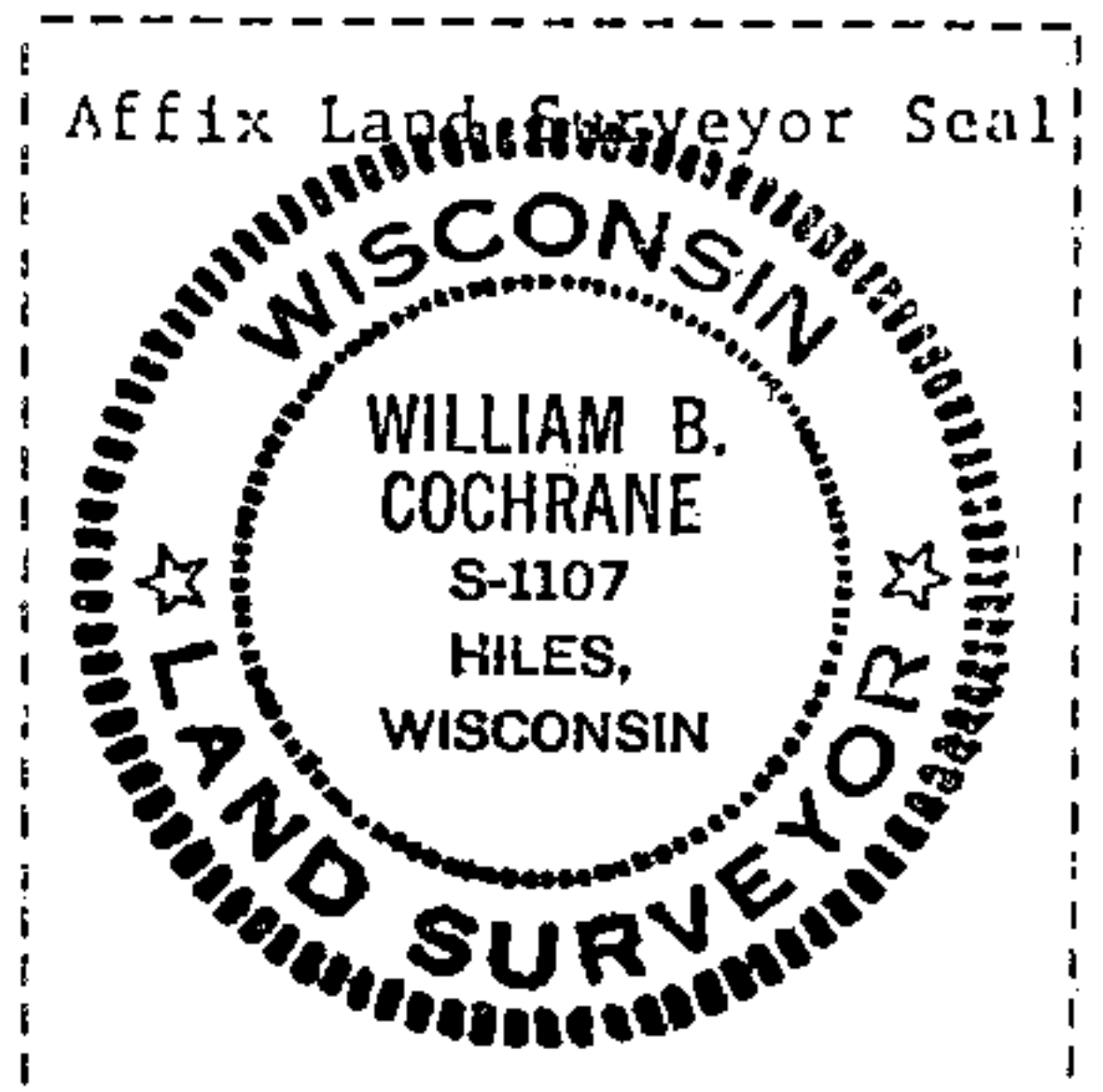
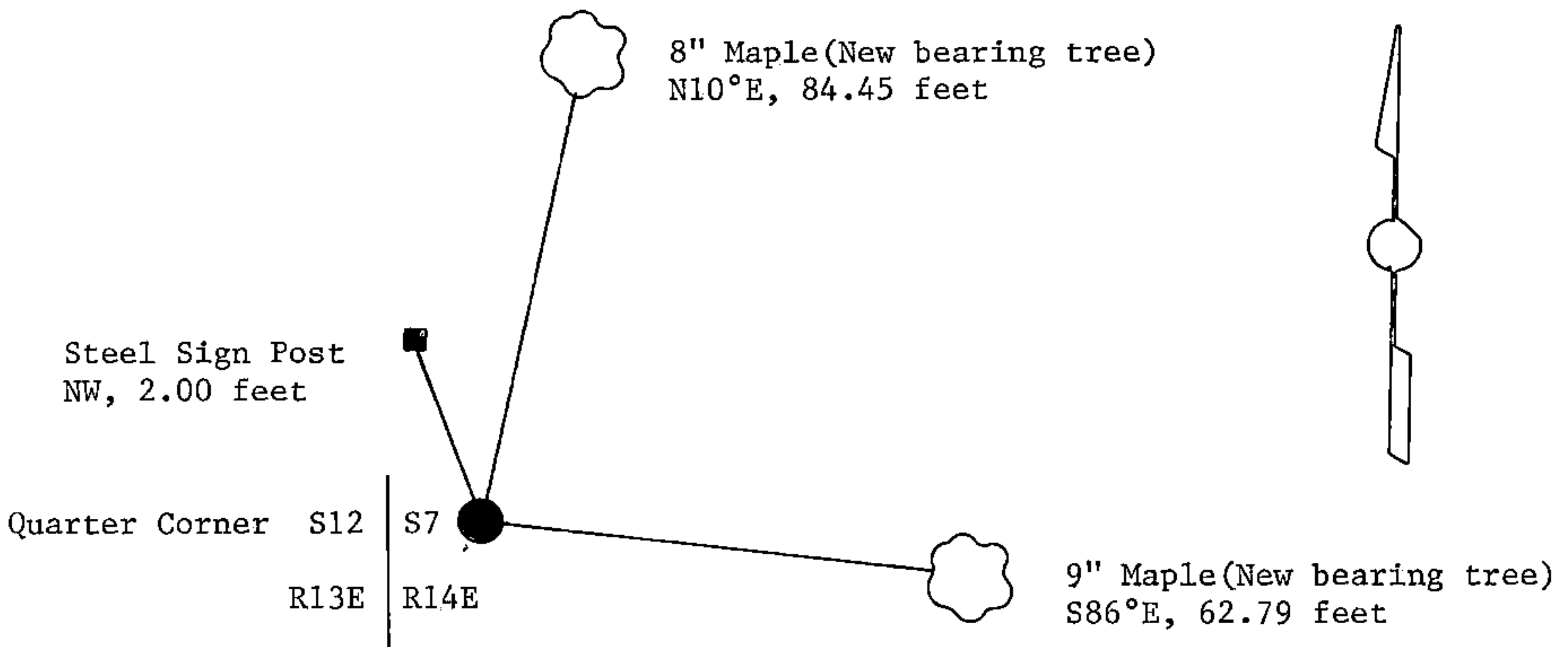

(i) I, William B. Cochrane  
(type or print name) certify that the corner location shown on this record was determined by me or under my direction and control and that this U.S. Public Land Survey Monument Record is correct and complete to the best of my knowledge and belief.

William B. Cochrane October 7, 1986  
Signature Date

Survey requested by: [Signature] 3-9-87  
District Ranger Date