

U.S. PUBLIC LAND SURVEY MONUMENT RECORD

Index No. E-21

State of Wisconsin }
County of Forest } ss.

I Gary L. Pisoni, do hereby certify that on the 8th day of July, 1990, I found evidence of the Southeast Section corner of Section 2 Township 39, North, Range 13 East, Fourth Principal Meridian, as described hereon; and that from this evidence I established a new monument and accessories as described hereon to perpetuate the original location of this corner.

Resident witnesses:

.....
.....
.....

History of original corner establishment:

Original Government Survey in 1865 by William E. Daugherty and Alex McDill.

Dependent Resurvey in 1978 by Gary L. Kratz and Michael J. Avery. Corner position is determined at the intersection of State Hwy 55 and Zepp Road, extending East. Corner is locally accepted and harmoniously related to existing original corners. At the corner point, set a Copperweld, flush with the road surface, with cap mkd; T39N, R13E, S2, S1, S11, S12, 1978. From which the following bear;

White Spruce 10" N46°E 62 lks. Cedar 10" S54°W 101 lks
Cedar 10" S61°E 173 lks. Maple 5" N73°W 55 lks.

Description of corner evidence found:

Found P.K. nail in blacktop above monument.

Found monument buried below road, from which the following bear;

White Spruce 11" N42°E 41.21 feet
Cedar 11" S60°E 114.08 feet
Cedar 10" S47°W 66.21 feet
Red Maple 5" N73°W 36.54 feet

Description of monument and accessories I established to perpetuate the original location of this corner.

None

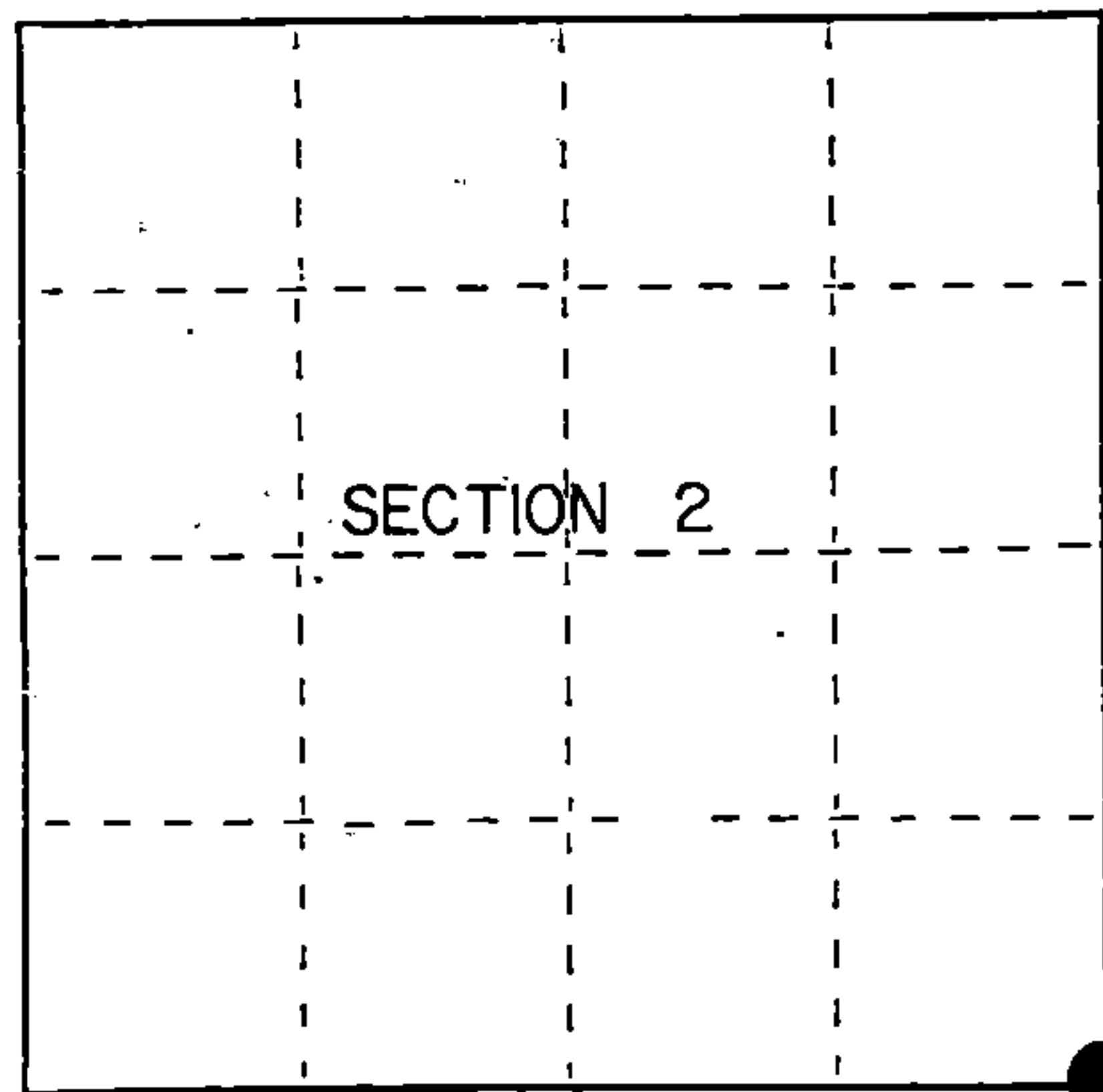

● = Corner monument restored.

Dated at Iron River, MI, ~~xxx~~ this 20th day of August, 1990

Signature Gary L. Pisoni Title Land Surveyor Registration No S-1634
(County Surveyor, Registered Land Surveyor, or other duly authorized official)

Office of Register of Deeds, County of Forest, I hereby certify that the within instrument was filed in this office for record on the 10th day of March, 1993 at 10:45 o'clock A. M.

Paul Aschwendanner
(Register of Deeds)

By..... Deputy

FORM NO. 985-A

H.C. Miller Company

Stock No. 26273

146912

4291302000

(e) Describe any material discrepancy between the location of the corner as restored or reestablished and the location of that corner as previously restored or reestablished by distance and direction. Show the discrepancy on the plan view drawing under (d), above. Show the distances between the corner as previously restored or reestablished and (1) the corner as restored or reestablished, and (2) to at least 2 of the witness monuments shown on the drawing in (d), above.

See drawing below.

(f) Was the corner restored through acceptance of (1) an obliterated evidence location, or, (2) a found perpetuated location?

Restored through acceptance of a found perpetuated location.

(g&h) Was the corner reestablished through lost corner proportionate methods? If so, show the method, including the directions and distances to other public land survey corners used as evidence or used for proportioning in determining the corner location?

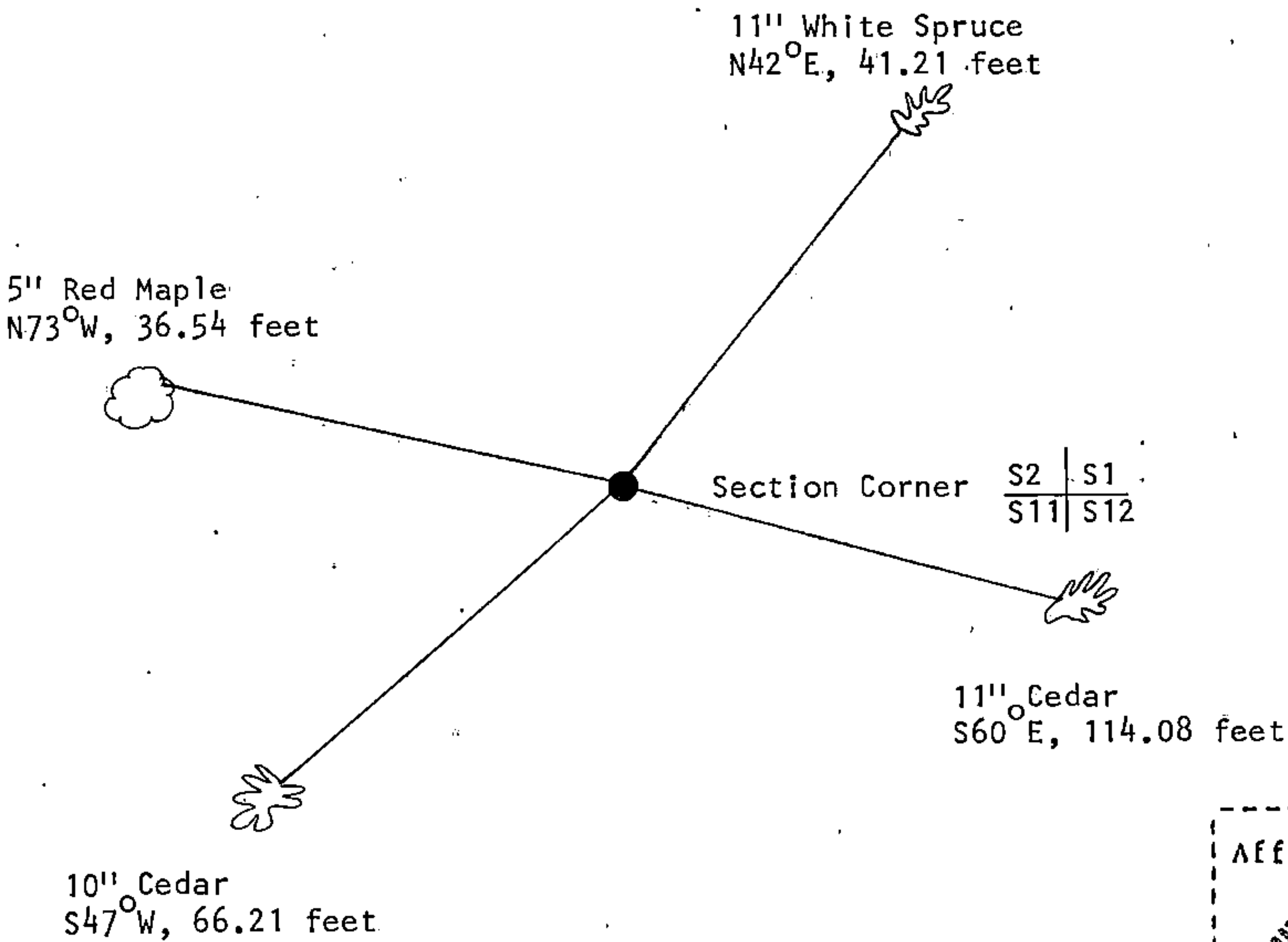

(i) I, Gary L. Pisoni
 (type or print name) certify that the corner location shown on this record was determined by me or under my direction and control and that this U.S. Public Land Survey Monument Record is correct and complete to the best of my knowledge and belief.

Gary L. Pisoni 11/21/91
 Signature Date

Survey requested by; Cam Gardner 12/15/92
 District Ranger Date

[Handwritten initials]