

CERTIFIED LAND CORNER RESTORATION

83256

Index No. 21E 23

State of Wisconsin }
County of Forest } ss.

I Robert E. Bandow, do hereby certify that on the 11th day of November, 1959, I found evidence of the North Quarter corner of Section 12 Township 39 North, Range 13 East, Fourth Principal Meridian, as described hereon; and that from this evidence I established a new monument and accessories as described hereon to perpetuate the original location of this corner.

Resident witnesses:

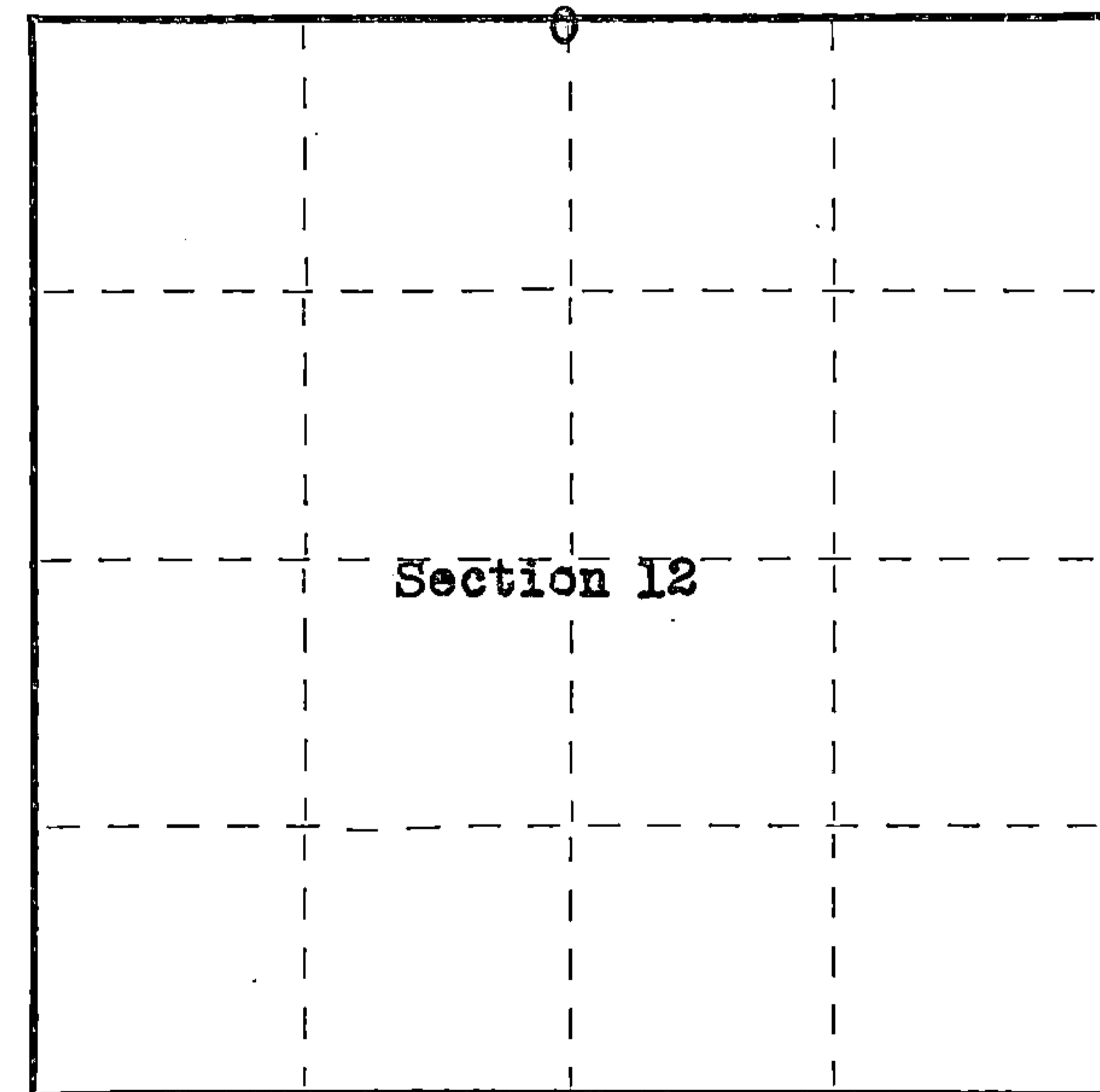

○ = Corner monument restored.

History of original corner establishment:

Original corner established in 1858 by Alfred Willard and Wm. S. Daugherty, Government Deputy Surveyors.
Original bearing trees: Yellow Birch 14" N 17°W 20 lks.
Hemlock 12" S16°E 32 lks.

Description of corner evidence found:

4"x4" scribed wood post.

Wood post appears to have been placed approximately 25 years ago, and was cut from native hemlock. Scribing accomplished with a standard surveyors timber scribe. The corner lies approximately 12 feet north of the centerline of the unsurfaced road. Corner is accepted locally as being in it's proper position.

Description of monument and accessories I established to perpetuate the original location of this corner.

Set 2"x5' galvanized iron pipe filled with concrete capped with brass cap and stamped as follows:

T39N R13E
1/4 S 1
S-12
1959

RLS No. S-104

Blazed and scribed the following bearing trees: Maple 21" N66°00' E 20.75 feet.
Maple 17" S26°00' E 60.6 feet.
Yellow Birch 13" N80°00'W 13.6 feet.

Genisot Engineering Co.

Dated at Rhineland, Wis., this 3rd day of December, 1959.

Signature Robert E. Bandow Title Registered Land Surveyor Registration No. S-104
(County Surveyor, Registered Land Surveyor, or other duly authorized official)

Office of Register of Deeds, County of Forest, I hereby certify that the within instrument was filed in this office for record on the 21st day of March, 1960 at 9:00 o'clock A.M.

Anna Peterson
(Register of Deeds)

By _____ Deputy

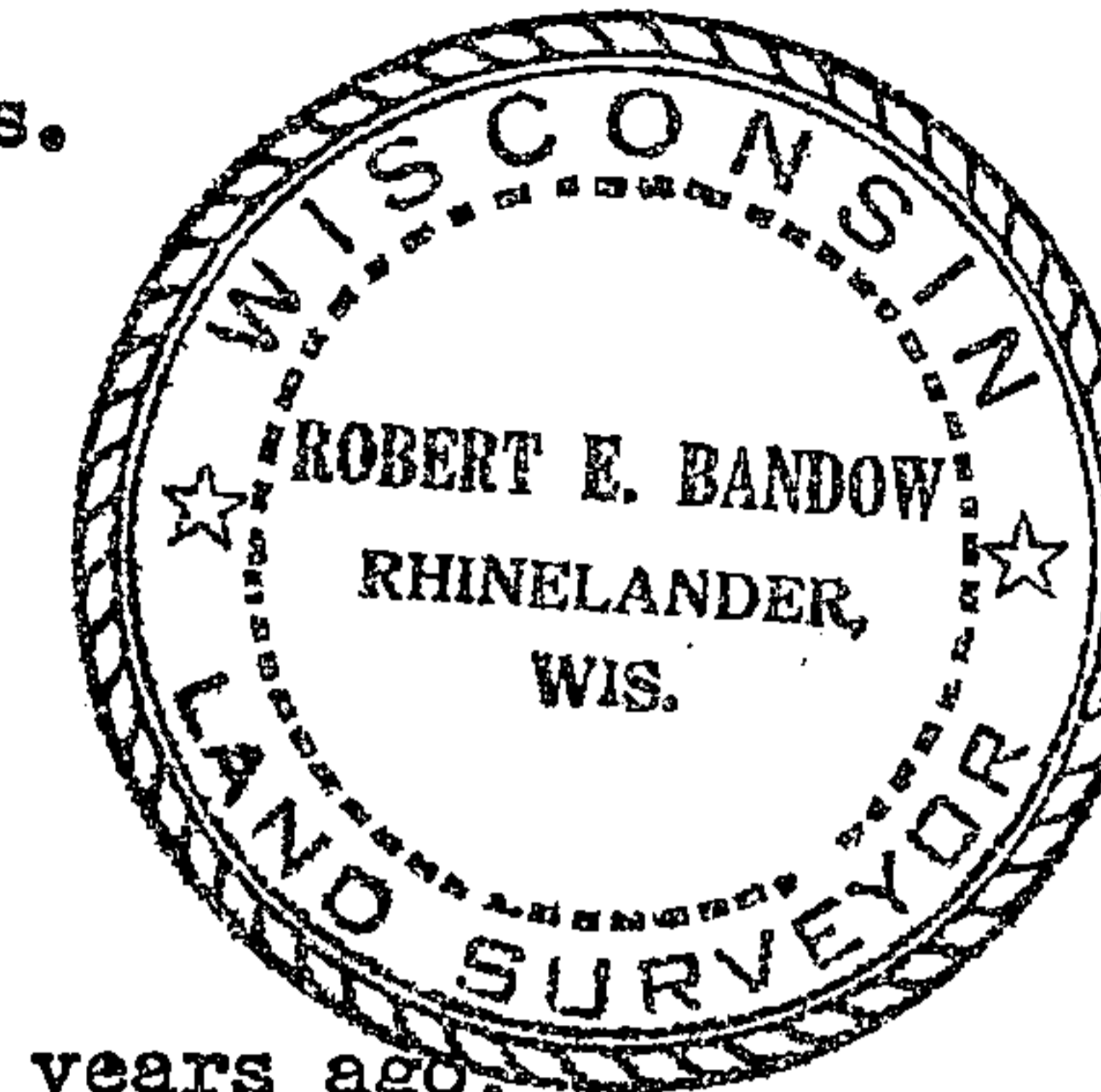

Subscribed and sworn to before me this 29th day of December 1959. Joseph C. Birkley Notary Public, Oneida County, Wisconsin.

My Commission Expires May 1, 1960

43913010020

U.S. PUBLIC LAND SURVEY MONUMENT RECORD

Index No. E-23

State of Wisconsin }
 County of Forest } ss.

I, Gary L. Pisoni, do hereby certify that on the 23rd day of August, 1990, I found evidence of the North quarter corner of Section 12 Township 39, North, Range 13 East, Fourth Principal Meridian, as described hereon; and that from this evidence I established a new monument and accessories as described hereon to perpetuate the original location of this corner.

Resident witnesses:

.....

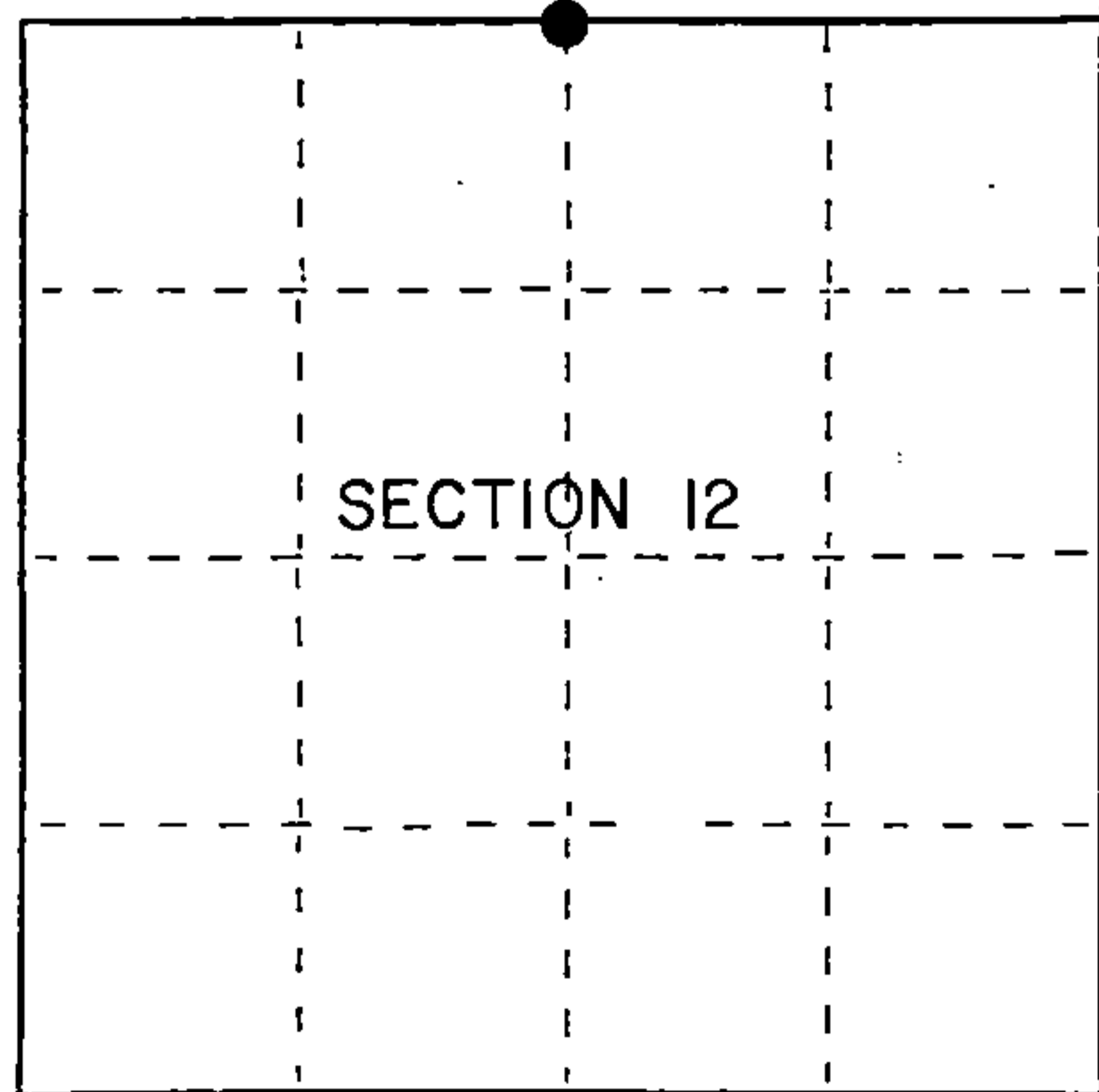

● = Corner monument restored.

History of original corner establishment:

Original Government survey in 1865 by William E. Daugherty and Alex. McDill. In 1959, Robert Badow RLS restored the corner position by acceptance of a wood post. Set a 2 inch diameter brass capped iron pipe and stamped as follows: T39N, R13E, 1/4, S-1, S-12, 1959, S-104 from which the following new blazed and scribed bearing trees bear:

Maple	21"	N 66°00'E	20.75 feet
Maple	17"	S 26°00'E	60.6 feet
Yellow Birch	13"	N 80°00'W	13.6 feet

Description of corner evidence found:

Found monument as described above from which the following bear:

Maple	26"	N 66°E	20.75 feet
Maple	22"	S 26°E	60.60 feet
Yellow Birch	22"	N 80°W	13.17 feet
Steel sign post		N 33°E	0.4 feet

Description of monument and accessories I established to perpetuate the original location of this corner.

Blazed and scribed the following new bearing tree: (Measurement taken to nail in side of tree)

Sugar Maple	8"	N 08°W	19.95 feet
-------------	----	--------	------------

Dated at Iron River, MI, ~~Wis~~, this 17th day of June, 1992

Signature Gary L. Pisoni Title Land Surveyor Registration No. S-1634
 (County Surveyor, Registered Land Surveyor, or other duly authorized official)

Office of Register of Deeds, County of Forest, I hereby certify that the within instrument was filed in this office for record on the 10th day of March, 1993 at 10:45 o'clock A M.

Paul Aschambrenner
 (Register of Deeds)

By..... Deputy

FORM NO. 985-A

H.C. Miller Company

Stock No. 26273

146913

070010210020

e) Describe any material discrepancy between the location of the corner as restored or reestablished and the location of that corner as previously restored or reestablished by distance and direction. Show the discrepancy on the plan view drawing under (d), above. Show the distances between the corner as previously restored or reestablished and (1) the corner as restored or reestablished, and (2) to at least 2 of the witness monuments shown on the drawing in (d), above.

See drawing below.

(f) Was the corner restored through acceptance of (1) an obliterated evidence location, or, (2) a found perpetuated location?

Restored through acceptance of a found perpetuated location.

(g&h) Was the corner reestablished through lost corner proportionate methods? If so, show the method, including the directions and distances to other public land survey corners used as evidence or used for proportioning in determining the corner location?

8" Sugar Maple (NBT)
N 08° W, 19.95 feet

26" Maple
N 66° E, 20.75 feet

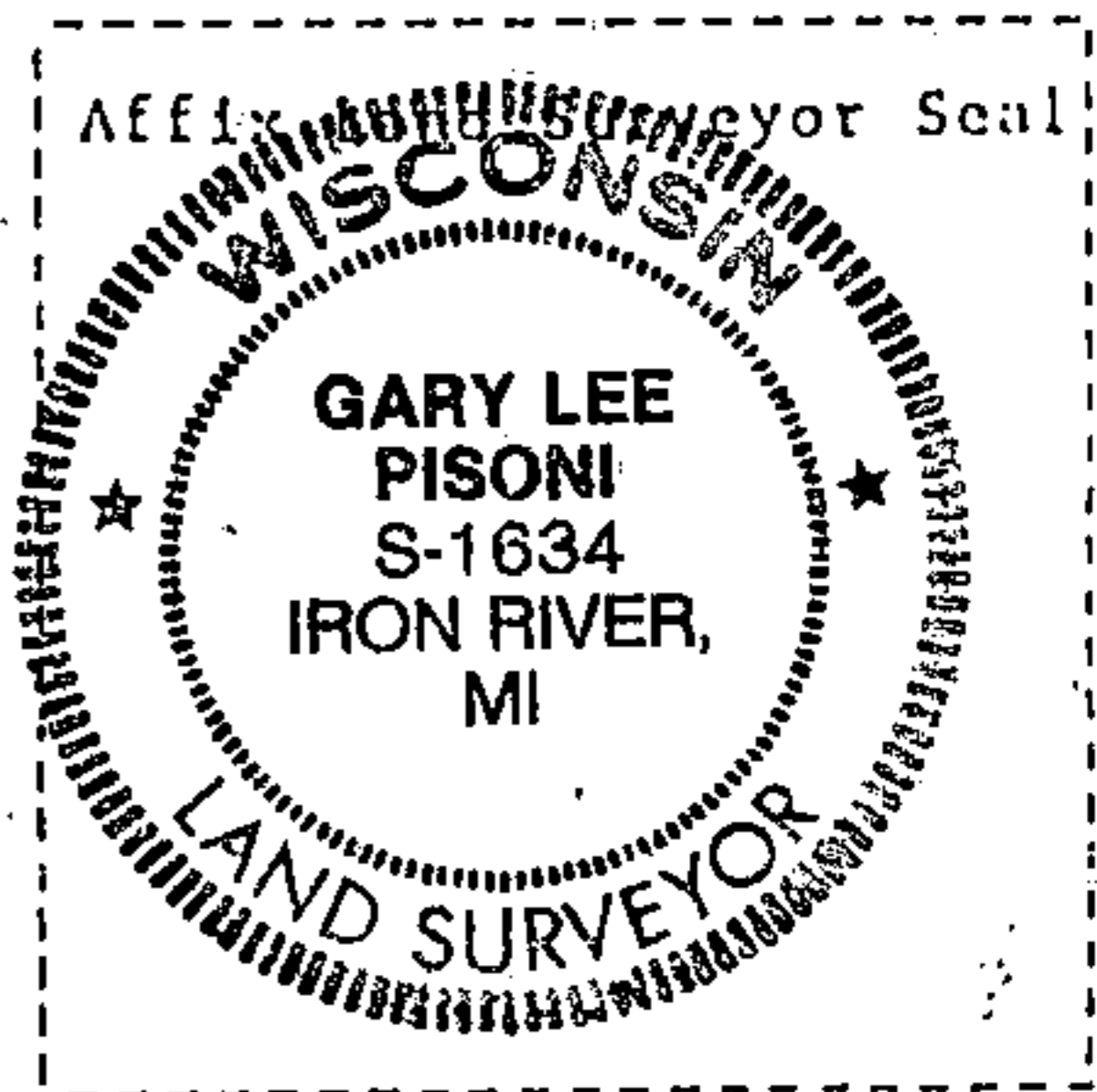
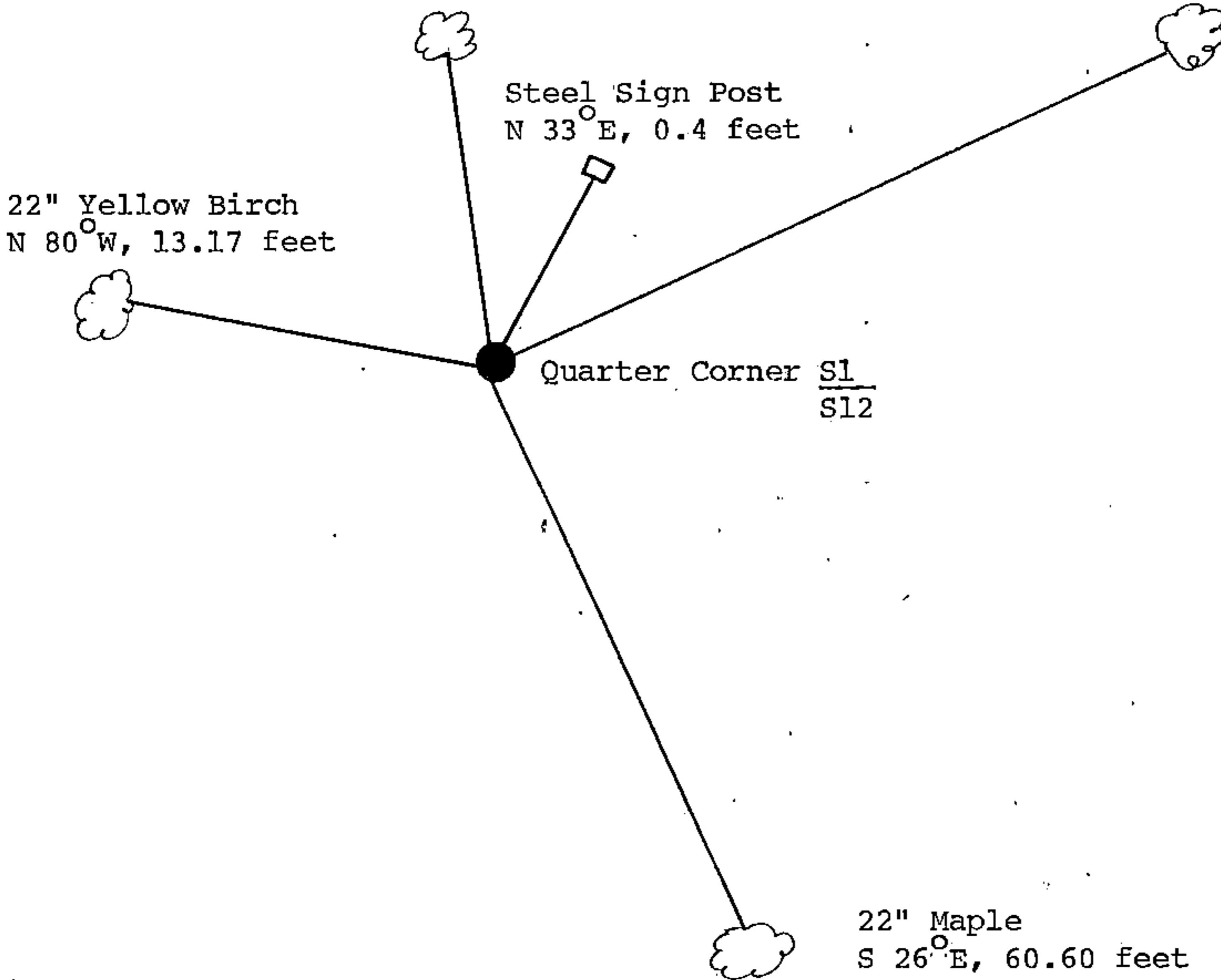

(i) I, Gary L. Pisoni (type or print name) certify that the corner location shown on this record was determined by me or under my direction and control and that this U.S. Public Land Survey Monument Record is correct and complete to the best of my knowledge and belief.

Gary L. Pisoni 6/17/92
Signature Date

Survey requested by: W Carr 10/2/92
District Ranger Date