

CERTIFIED LAND CORNER RESTORATION
U.S. Public Land Corner

History of original corner establishment: Township 38 North, Range 14 East subdivided by:
James L. Nowlin, Deputy Surveyor
Commenced Aug. 30, 1865, completed Sept. 9, 1865

Original bearing trees
Cedar 14 N 46 E 15 lks.
Cedar 8 S 71 W 21 lks



State of Wisconsin }
County of Forest } ss.

I, Norman A. Harrison, do hereby certify that on the 24th day of March, 1983, I found ~~set~~ evidence of the west quarter corner of Section 35, Township 38 North, Range 14 East, Fourth Principal Meridian, as described hereon; and that from this evidence I established a new monument and accessories as described hereon to perpetuate the original location of this corner.

Description of corner evidence found:
No evidence of original corner found
Forest County aluminum monument at Southwest corner of section
Federal Forest brass cap monument at Northwest corner of section

Resident witnesses:
.....
.....
.....

Description of monument and accessories I established to perpetuate the original location of this corner.

Corner set by proportionate measure, falls in swamp area
Set Forest County aluminum monument at corner

Bearing trees, magnetic bearings
Cedar 9" N 47° 32' E 78.3'
W. Birch 10" S 52° 30' E 24.5'
Cedar 8" S 44° 07' W 35.7'
Cedar 10" N 87° 15' W 47.6'

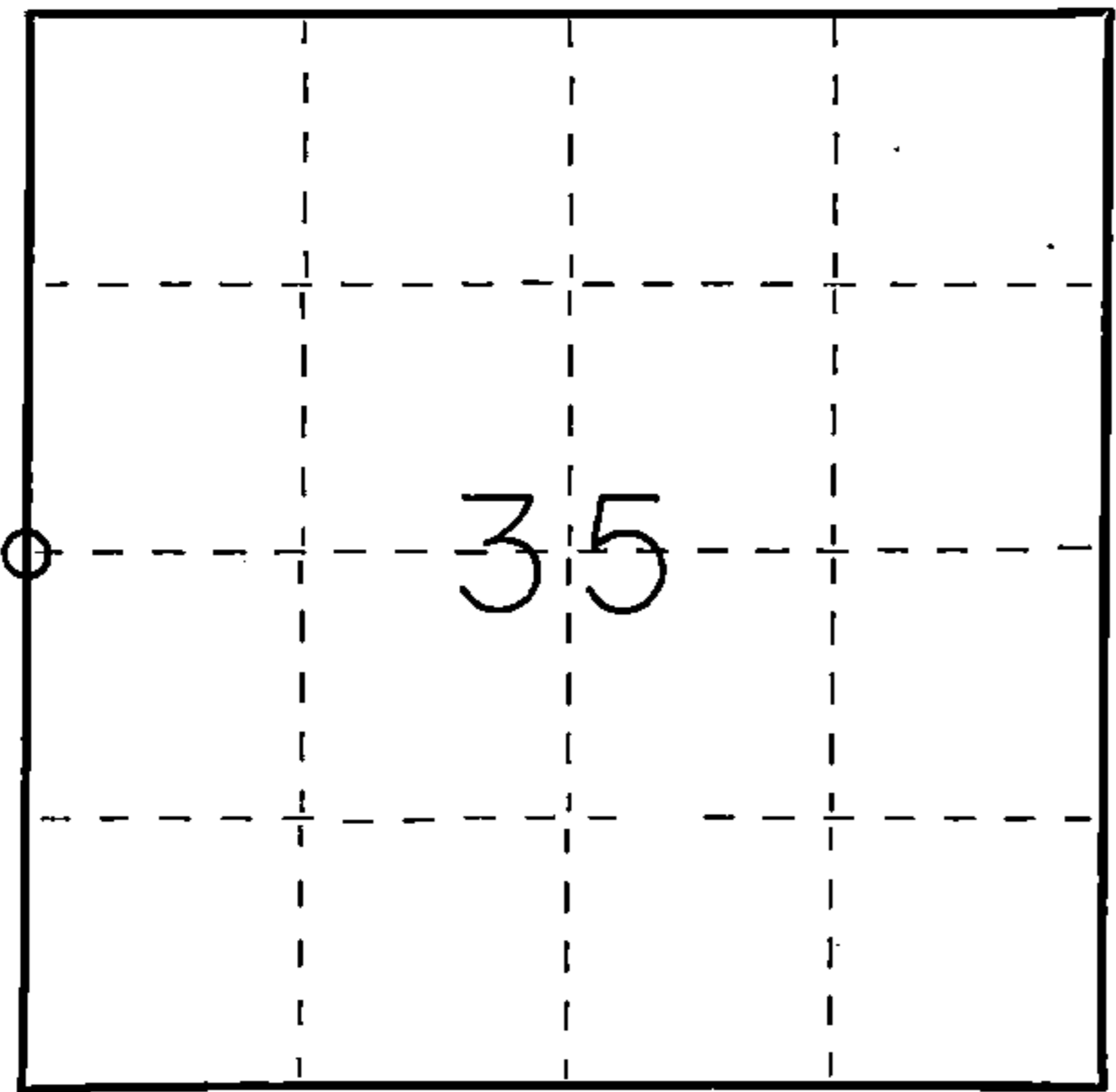

○ = Corner monument restored.

Dated at Fence, Wis., this 5th day of May, 1983.

Signature Norman A. Harrison Title Surveyor Registration No. 1394
(County Surveyor, Registered Land Surveyor, or other duly authorized official)

Office of Register of Deeds, County of Forest, I hereby certify that the within instrument was filed in this office for record on the 5th day of May, 1983 at 4:30 o'clock P. M.

Eugene Staszny (Register of Deeds)

DOCUMENT NO. 123318

By Deputy

Stock No. 26272
FORM 985
H.C. Miller Company

42814342000

U.S. PUBLIC LAND SURVEY MONUMENT RECORD

Index No. X-17

State of Wisconsin }
County of Forest } ss.

I, Gary L. Pisoni, do hereby certify that on the 4th day of March, 1994, I found evidence of the East Quarter corner of Section 34 Township 38 North, Range 14 East, Fourth Principal Meridian, as described hereon; and that from this evidence I established a new monument and accessories as described hereon to perpetuate the original location of this corner.

Resident witnesses:

History of original corner establishment:

Original Government survey in 1865 by James L. Nowlin, Deputy Surveyor. North between Sections 34 & 35, at 40.00 chains, set Quarter Section Post, from which the following bear: Cedar, 14", N 46° E, 15 Lks., Cedar, 8", S 71° W, 21 Lks.,

In 1983, Norman A. Harrison, R.L.S., found no evidence of the original corner or bearing trees. He set a Forest County aluminum pipe monument with an aluminum cap on line and at proportionate distance from the Northeast corner and the Southeast corner of Section 34 from which the following bear:

	Cedar	9"	N 47° 32' E	78.3 feet
	White Birch	10"	S 52° 30' E	24.5 feet
Description of corner evidence found:	Cedar	8"	S 44° 07' W	35.7 feet
	Cedar	10"	N 87° 15' W	47.6 feet

Found monument as described above and the following bearing trees:

	Cedar	12"	N 50° E	78.65 feet
	White Birch	12"	S 50° E	24.09 feet
	Cedar	10"	N 85° W	47.90 feet

Description of monument and accessories I established to perpetuate the original location of this corner.

Blazed and scribed a new bearing tree. (Measurement is taken to a nail in side of tree)

	Cedar	8"	S 22° W	47.07 feet
	Steel Sign Post		N 31° W	1.20 feet

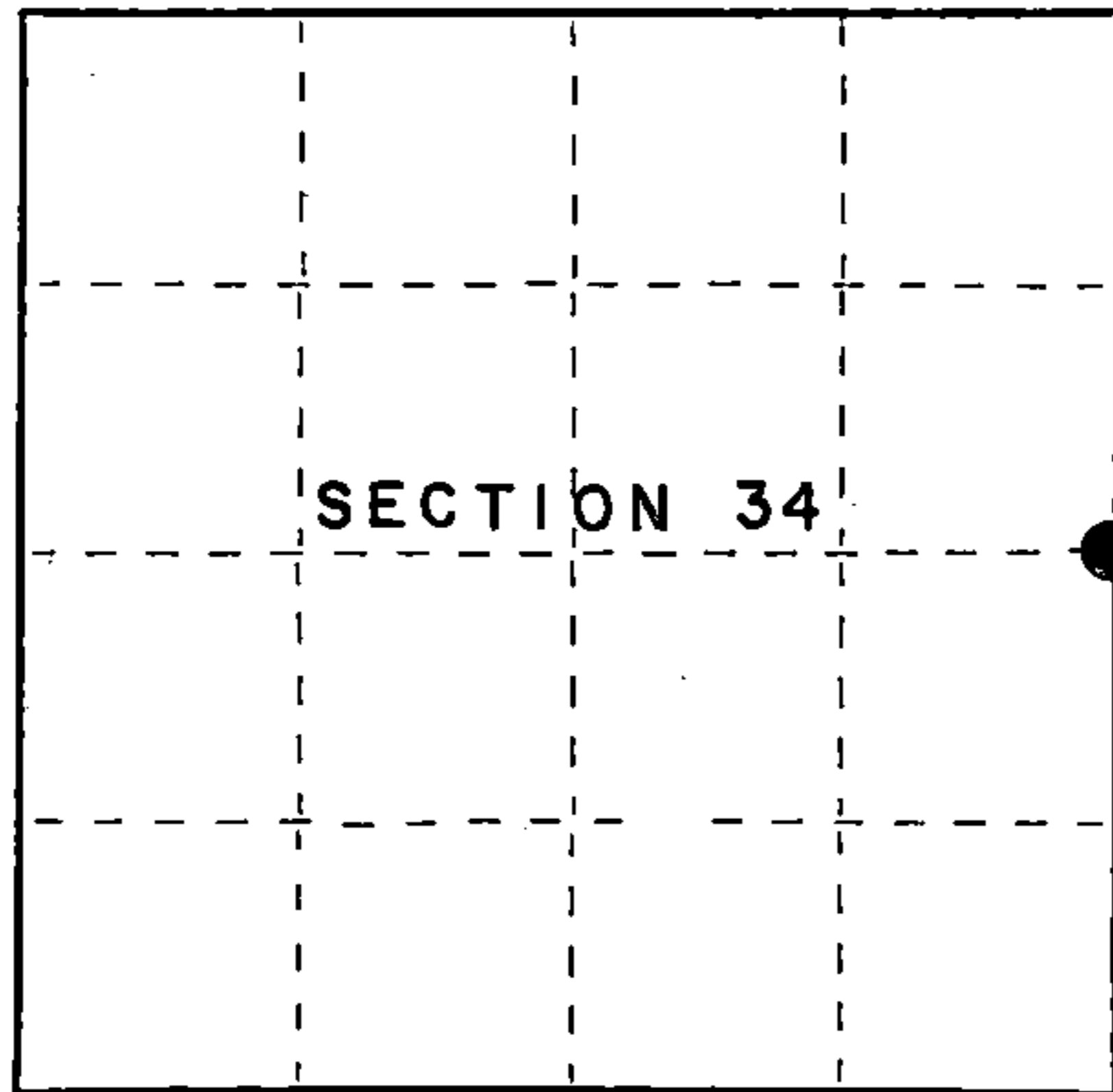

● = Corner monument restored.

Dated at Iron River, WI, this 5th day of May, 1994.

Signature: Gary L. Pisoni Title: Land Surveyor Registration No. S-1634
(County Surveyor, Registered Land Surveyor, or other duly authorized official)

Office of Register of Deeds, County of Forest, I hereby certify that the within instrument was filed in this office for record on the 20th day of March, 1997 at 1:30 o'clock P.M.

(Register of Deeds)

By: [Signature] Deputy

FORM NO. 985-A



Stock No. 26273

158152

42814 342000

(e) Describe any material discrepancy between the location of the corner as restored or reestablished and the location of that corner as previously restored or reestablished by distance and direction. Show the discrepancy on the plan view drawing under (d), above. Show the distances between the corner as previously restored or reestablished and (1) the corner as restored or reestablished, and (2) to at least 2 of the witness monuments shown on the drawing in (d), above.

None

(f) Was the corner restored through acceptance of (1) an obliterated evidence location, or, (2) a found perpetuated location?

Restored through acceptance of a found perpetuated location.

(g&h) Was the corner reestablished through lost corner proportionate methods? If so, show the method, including the directions and distances to other public land survey corners used as evidence or used for proportioning in determining the corner location?

No

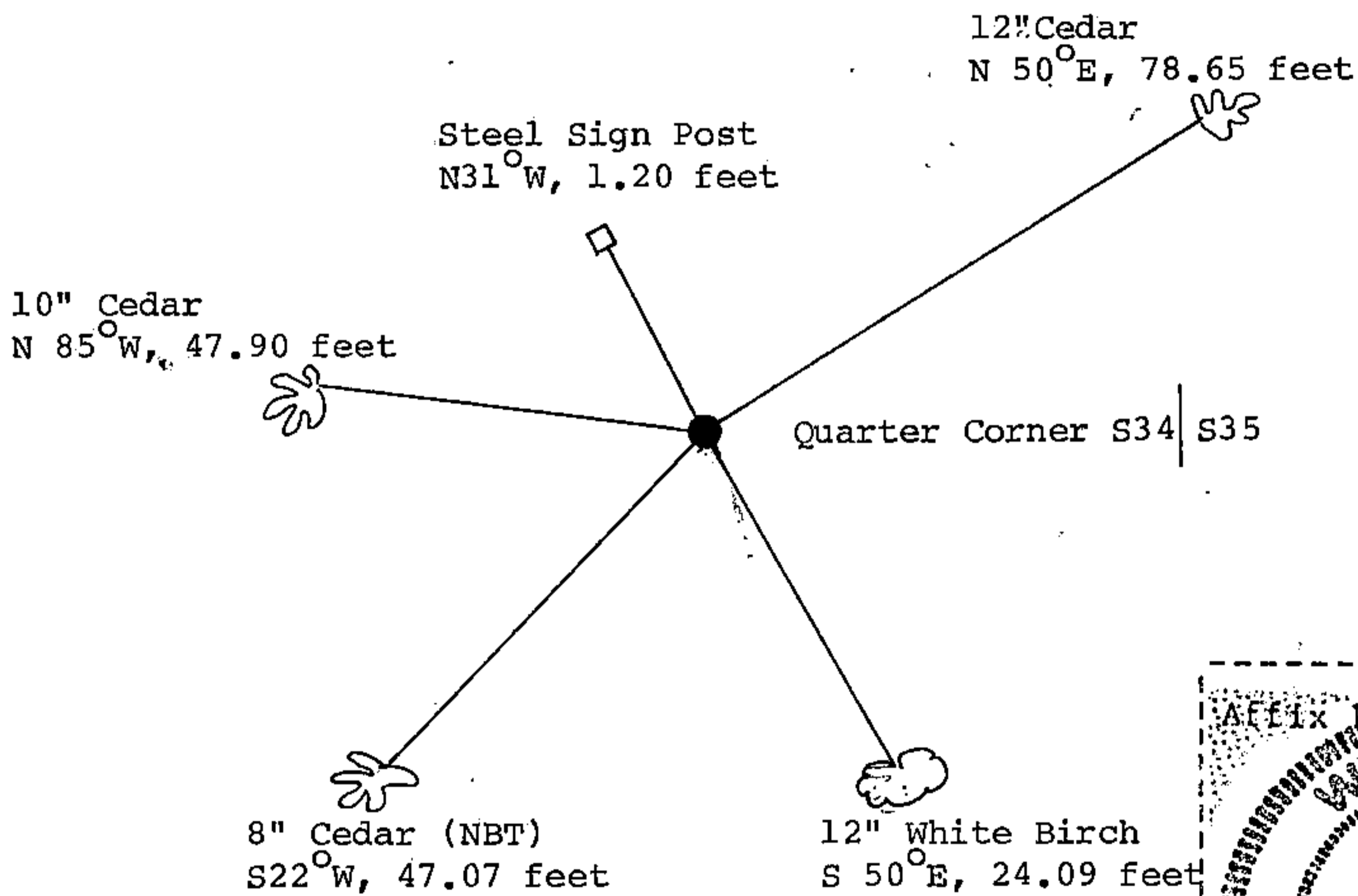

(i) I, Gary L. Pisoni
 (type or print name) certify that the corner location shown on this record was determined by me or under my direction and control and that this U.S. Public Land Survey Monument Record is correct and complete to the best of my knowledge and belief.

Signature

Gary L. Pisoni

Date

4-11-95