

U.S. PUBLIC LAND SURVEY MONUMENT RECORD

Index No. N-19

State of Wisconsin }  
County of Forest } ss.

I, Milo E. Stefan, do hereby certify that on the 13th day of April, 1990, I found evidence of the North Quarter corner of Section 23 Township 38 North, Range 13 East, Fourth Principal Meridian, as described hereon; and that from this evidence I established a new monument and accessories as described hereon to perpetuate the original location of this corner.

Resident witnesses:

Jeffrey Kennedy

Myron Smith

History of original corner establishment:

Original government survey of 1865 by H. & L. Nowlin set a wood post for Quarter to Sections 14 and 23 with two BTs:  
24" Hemlock, N8°W, 20 Links      16" Birch, S16°W, 4 Links

Description of corner evidence found:

Forest Service monument as set by myself in 1983 and recorded by Certificate # 124236 on 9/15/83.

Found a 2" x 36" Berntsen aluminum monument with tablet stamped as follows:

T38N, R13E, S14, ¼, S23, 1983, RLS-1558

From which the following bear:

Sugar, 7", N50°E, 14.12'

Sugar, 12", S19°W, 18.49'

Sugar, 13", N74°W, 61.66'

Steel Sign Post, SE, 1.45'

Description of monument and accessories I established to perpetuate the original location of this corner.

As I removed the SW BT in our traverse, we made two new BTs to bring corner up to contract and State specifications.

\*6" Sugar, N13°E, 37.94'

6" Sugar, N50°E, 14.22'

\*12" Sugar, S38°W, 42.71'

13" Sugar, N74°W, 61.73'

8' Steel Sign Post, SE, 1.4'

\*New BTs

Dated at Rhinelander, Wis., this 9th day of July, 1990

Signature *Milo E. Stefan* Title Land Surveyor Registration No. 1558  
(County Surveyor, Registered Land Surveyor, or other duly authorized official)

Office of Register of Deeds, County of Forest, I hereby certify that the within instrument was filed in this office for record on the 10th day of December, 1991 at 10:15 o'clock A.M.

(Register of Deeds)

By *Paul Chitko* Deputy

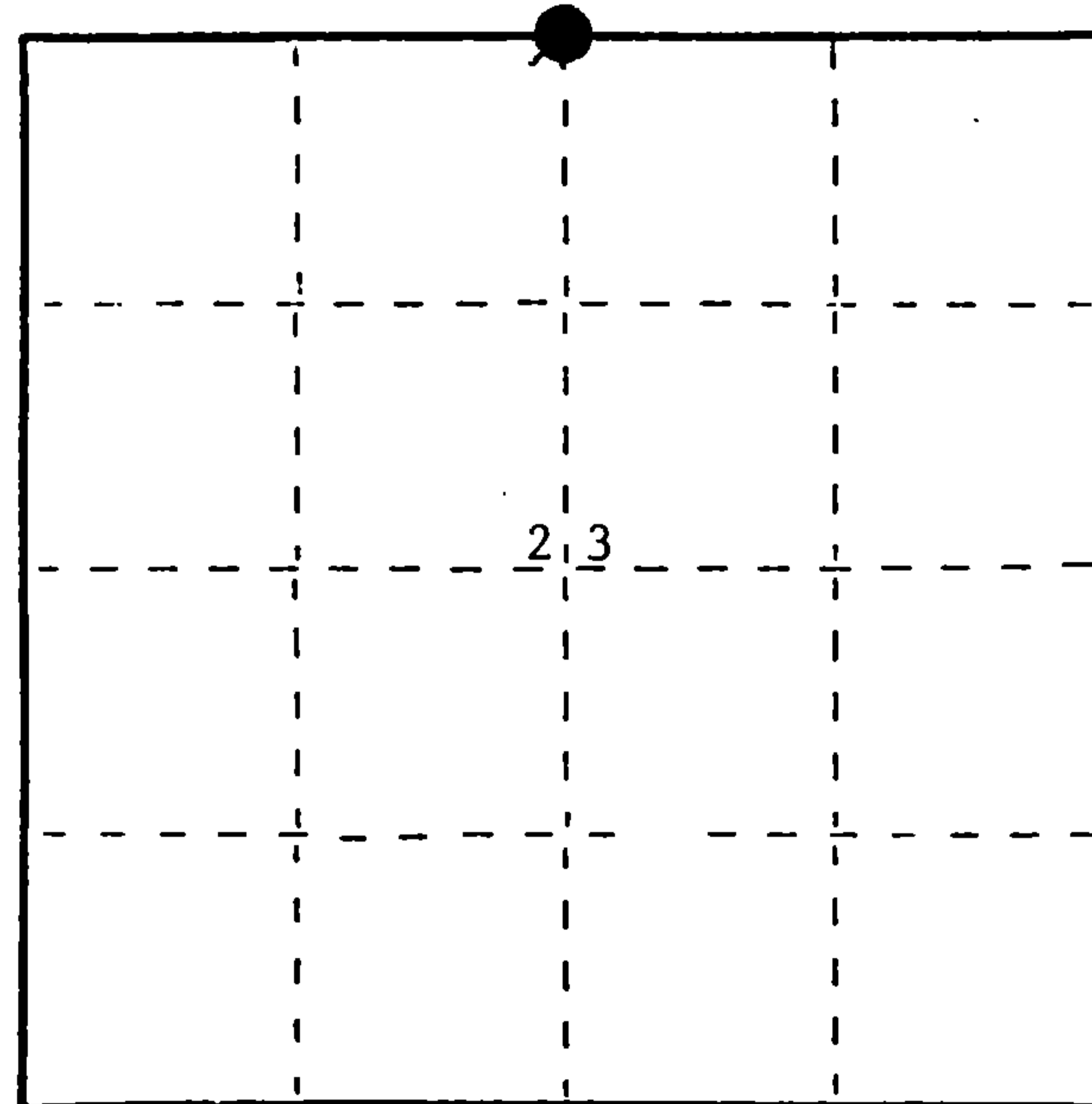

● = Corner monument restored.

FORM NO. 985-A

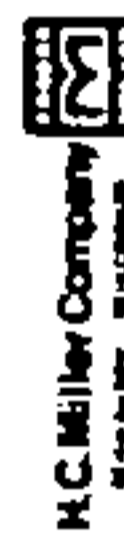

Stock No. 26273  
DOCUMENT NUMBER  
143391

43813140020

e) Describe any material discrepancy between the location of the corner as restored or reestablished and the location of that corner as previously restored or reestablished by distance and direction. Show the discrepancy on the plan view drawing under (d), above. Show the distances between the corner as previously restored or reestablished and (1) the corner as restored or reestablished, and (2) to at least 2 of the witness monuments shown on the drawing in (d), above.

None

(f) Was the corner restored through acceptance of (1) an obliterated evidence location, or, (2) a found perpetuated location?

A found perpetuated location.

(g&h) Was the corner reestablished through lost corner proportionate methods? If so, show the method, including the directions and distances to other public land survey corners used as evidence or used for proportioning in determining the corner location?

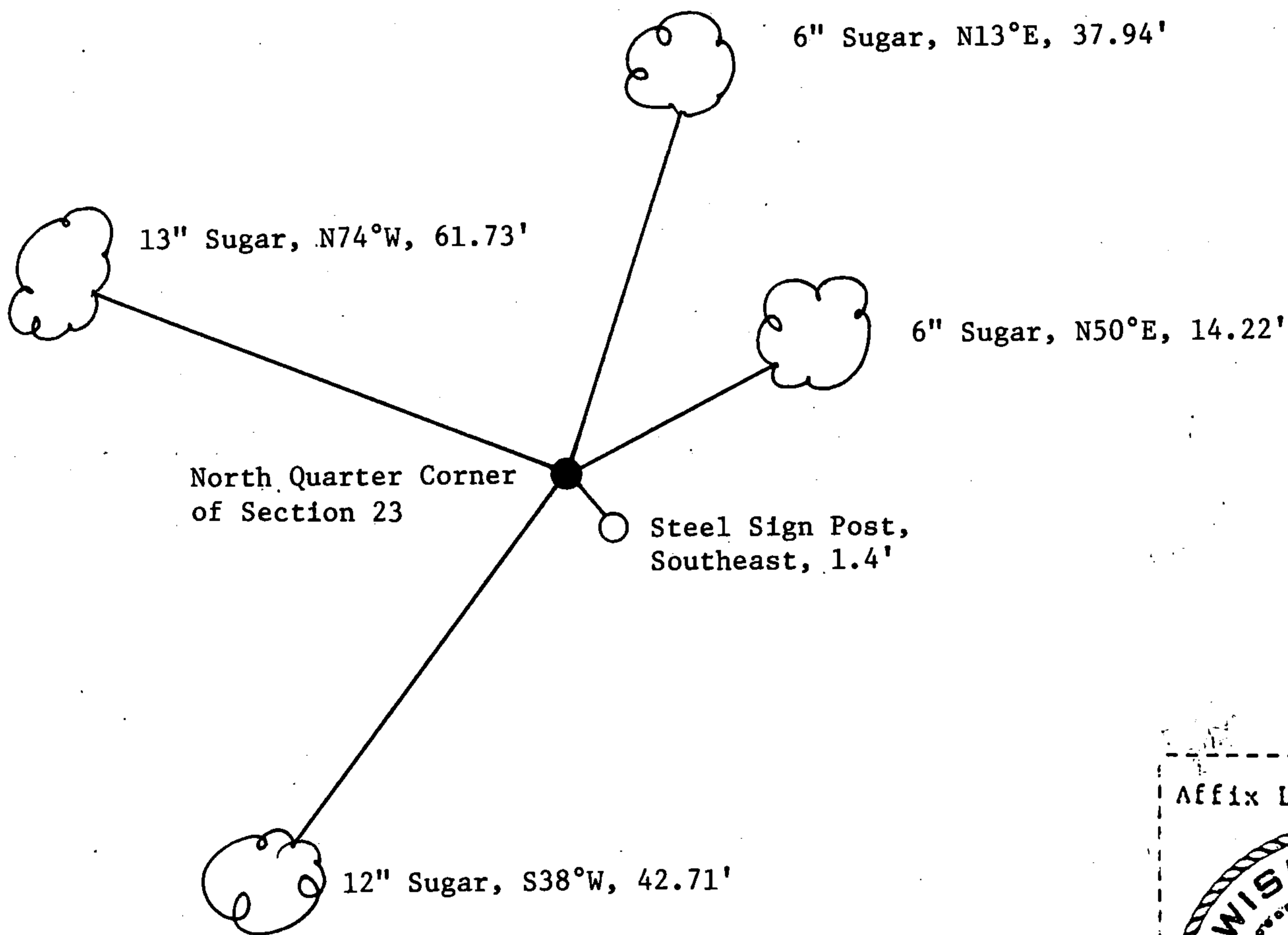

Affix Land Surveyor Seal



(i) 1. Milo E. Stefan  
(type or print name) certify that the corner location shown on this record was determined by me or under my direction and control and that this U.S. Public Land Survey Monument Record is correct and complete to the best of my knowledge and belief.

Milo E. Stefan  
Signature

7/9/1990  
Date

Survey requested by: Darius Staeger  
District Ranger

6/4/91  
Date

CERTIFIED LAND CORNER RESTORATION

State of Wisconsin }  
County of Forest } ss.

I Milo E. Stefan, do hereby certify that on the 25th day of May, 1983, I found evidence of the North Quarter corner of Section 23 Township 38 North Range 13 East, Fourth Principal Meridian, as described hereon; and that from this evidence I established a new monument and accessories as described hereon to perpetuate the original location of this corner:

Description of original monument and accessories and subsequent restorations:

Surveyed in 1865 by H. Nowlin and J. L. Nowlin  
40.00 chains, set wood post  
Hemlock, 24", N8°W, 20 lks.  
Birch, 16", S16°W, 4 lks.

Description of corner evidence found:

Hemlock stump remains, N8°W, 21 lks.  
Yellow Birch stump, 18", S16°W, 5 lks.  
Local Evidence: 60 year old blazed line from east

Description of monument and accessories I established to perpetuate the location of this corner:

Placed a 2" x 36" Berntsen aluminum monument with tablet stamped as follows:  
T38N, R13E, S14, 1/4, S23, 1983, RLS-1558  
From which the following bear:  
Sugar, 7", N50°E, 14.12 feet  
Sugar, 12", S19°W, 18.49 feet  
Sugar, 13", N74°W, 61.66 feet  
Steel Sign Post, SE, 1.45 feet

DOCUMENT NO.  
**124236**

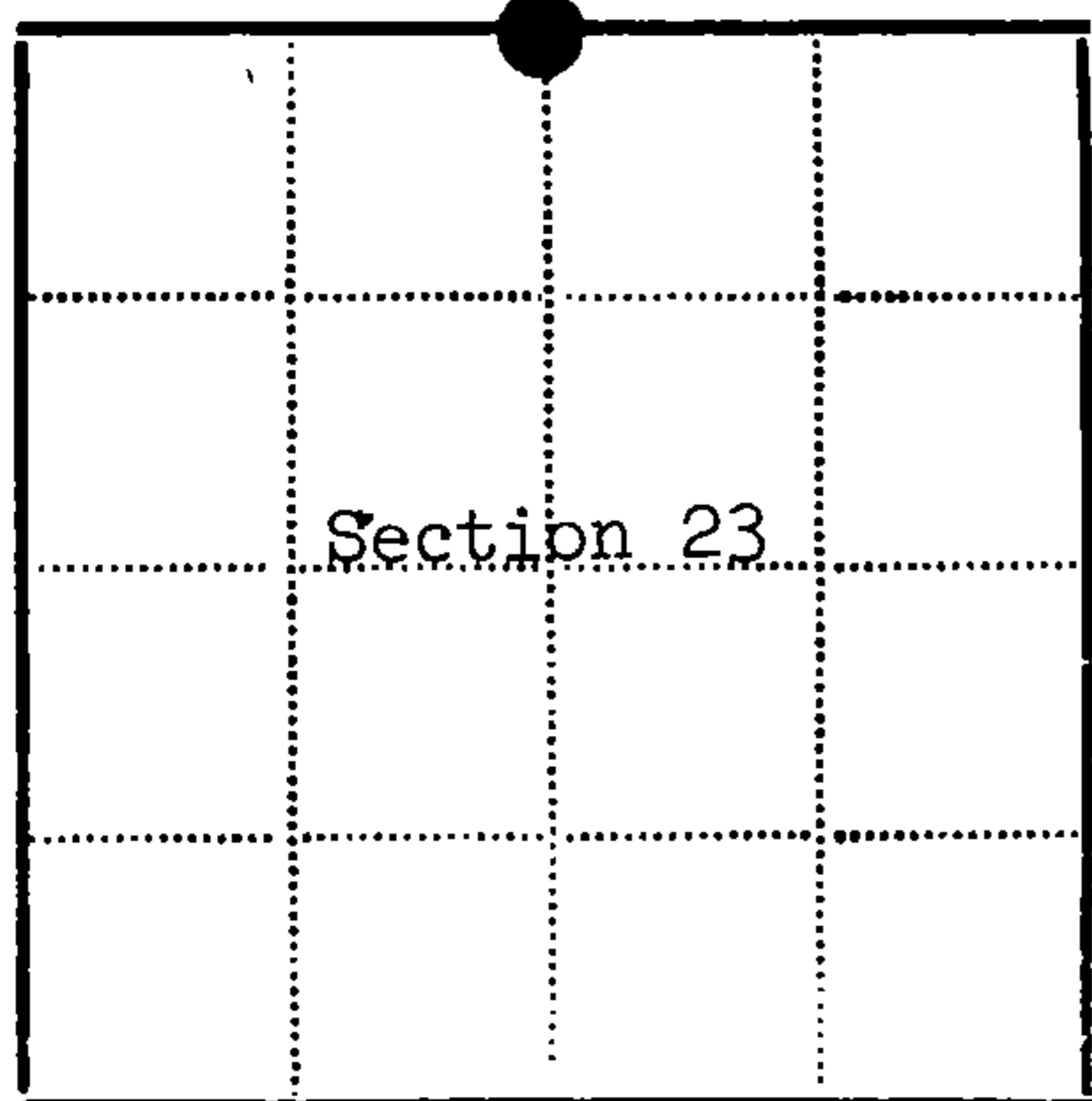

● - Corner monument restored  
□ -

Resident witnesses.....

Dated at Rhinelander Wisconsin, this day of 1983.

Signature Milo E. Stefan Title Land Surveyor  
(County Surveyor, Registered Land Surveyor, or other duly authorized official)

Surveyors Registration No. RLS-1558

Office of Register of Deeds County of Forest

I hereby certify that the within instrument was filed in this office for record on the 15th day of September 1983, and was filed in Book No. Page No. of County Records.

Signature Eugene Statynoff Title Register of Deeds

Township 38 North Range 13 East Section 23 Index No. N-19 Page No. 33