

CERTIFIED LAND CORNER RESTORATION

Index No. 721

State of Wisconsin }
County of FOREST } ss.

History of original corner establishment: Township line surveyed by Artemus Curtis under contract dated March 23, 1857.

- Ironwood 8 N 37 W 29 Lks.
- Yellow Birch 15 N 57 E 42 Lks.
- Hemlock 8 S 67 E 23 Lks.
- Ironwood 8 S 64 W 13 Lks.

I NORMAN A. HARRISON, do hereby certify that on the Twenty eighth day of June, 1980, I found evidence of the South West corner of Section 36 Township 37, North, Range 16 East, Fourth Principal Meridian, as described hereon; and that from this evidence I established a new monument and accessories as described hereon to perpetuate the original location of this corner.

Description of corner evidence found: No evidence of original corner monument or bearing trees found.

Accepted intersection of North-South and East-West roads as oldest & best evidence of corner perpetuation. Intersection shown on 1939 quadrangle as intersection of North-South road with road from the west.

Resident witnesses:

The distance South to a East-West fence from the West is 1282'. The distance South from this fence to a 2nd East-West fence from the West is 1282'. The distance South from the, 2nd fence to a 2" iron pipe with a brass cap at the 1/4 corner to Sec.'s 11 & 12, T 36 N, R 16 E, is 5287'

Description of monument and accessories I established to perpetuate the original location of this corner.

- Power pole no. 3715 - 3617, N 30° 32' E, 39.6'
- 9" Maple tree, S 45° E, 26.4'
- 1" iron pipe set, S 45° E, 45.0'
- 1" iron pipe set in fence line, S 25° 11' W, 51.5'
- 10" maple tree, N 62° 46' W, 52.4'
- Existing 1" iron pipe, N 40° 28' W, 32.55'

Above ties are to a Forest County aluminum monument set 1' below the surface of the existing bituminous pavement and 0.7' off the edge of the bituminous pavement.

FORM 985 H. G. MILLER CO., MILWAUKEE

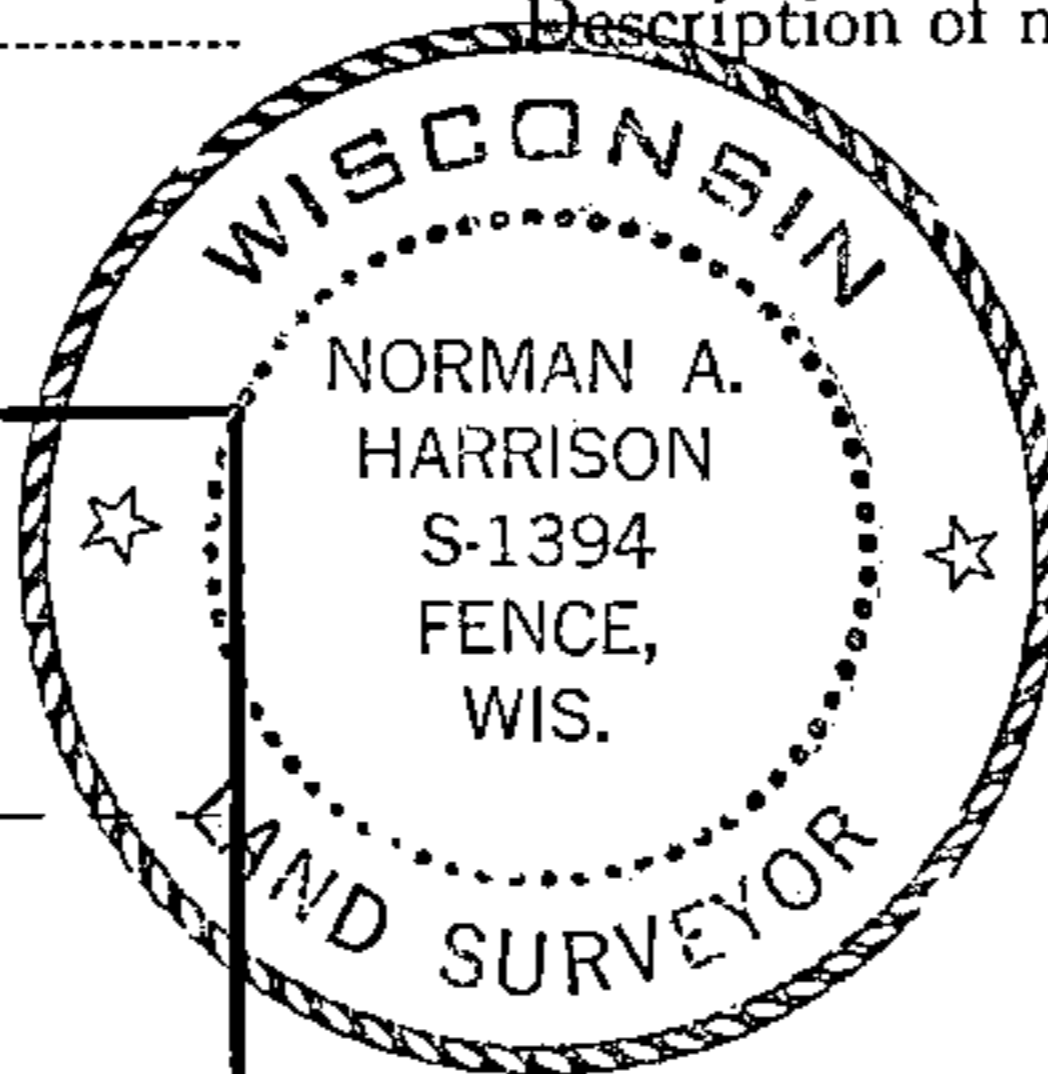
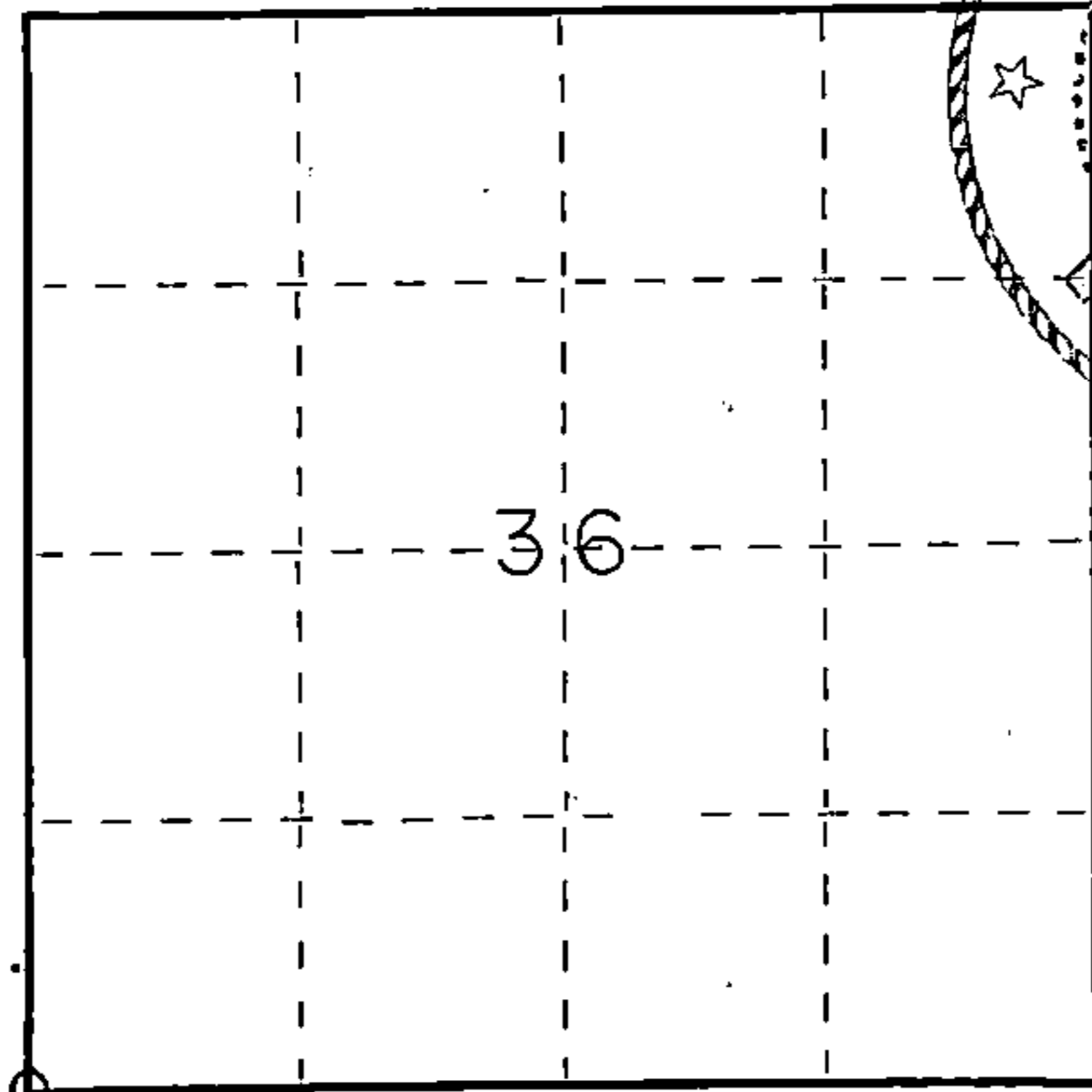

Dated at Fence, Wis., this 25 day of Nov., 1980.

Signature Norman A. Harrison Title Surveyor Registration No. 1394
(County Surveyor, Registered Land Surveyor, or other duly authorized official)

Office of Register of Deeds, County of Forest, I hereby certify that the within instrument was filed in this office for record on the 25th day of November, 1980 at 3:30 o'clock P. M.

EUGENE STATEZNY
(Register of Deeds) DOCUMENT NO. 119057

By Sharon Mueller Deputy

○ = Corner monument restored.

43716350000