

DOCUMENT NUMBER
143941

FORM 985 H. C. MILLER CO., MILWAUKEE

State of Wisconsin }
County of Forest } ss.

A I, Norman A. Harrison, do hereby certify that on the 15 day of October, 1991, I found evidence of the east quarter corner of Sec. 34 Township 37 North, Range 16 East, Fourth Principal Meridian, as described hereon; and that from this evidence I established a new monument and accessories as described hereon to perpetuate the original location of this corner.

Resident witnesses:

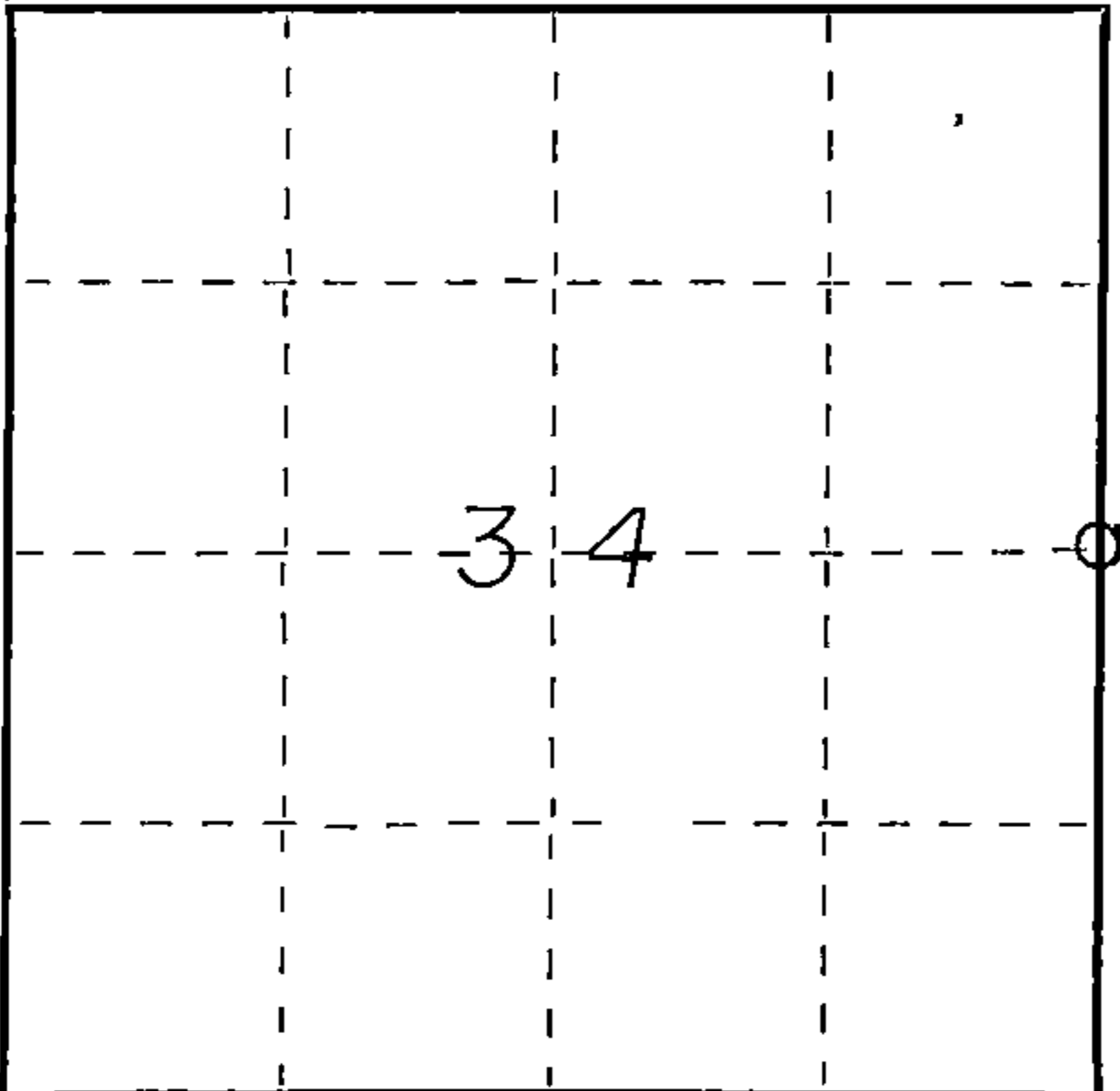

○ = Corner monument restored.

43716342000

CERTIFIED LAND CORNER RESTORATION

U.S. PUBLIC LAND SURVEY MONUMENT RECORD

History of original corner establishment:

Original survey by: James McBride
Commenced July 11, 1859
Finished July 16, 1859
original bearing trees
tamrack 8 S 16 E 30 (19.8')
Spruce 5 N 81 W 20 (13.2')

B Description of corner evidence found:
Found 1 1/4" iron pipe, 20' ± from creek

F accepted iron pipe as best evidence of perpetuation of original corner location

Description of monument and accessories I established to perpetuate the original location of this corner.
Replaced iron pipe with Forest County aluminum monument bearing objects, set 1 1/4" x 24" iron pipe on edge of cultivated field

iron pipe	1 1/4" x 24"	S 80° 48' 37" W	236.21 feet
"	"	S 71° 44' 00" W	234.87 "
"	"	S 59° 40' 44" W	238.24 "

G,H corner was not set by proportionate methodes

Dated at Fence, Wis., this 10 day of Feb., 1992

Signature Norman A. Harrison Title Surveyor Registration No. 1394
(County Surveyor, Registered Land Surveyor, or other duly authorized official)

Office of Register of Deeds, County of Forest, I hereby certify that the within instrument was filed in this office for record on the 5th day of March, 1992 at 3:30 o'clock P.M.

Paul Schreiner (Register of Deeds)

By Deputy

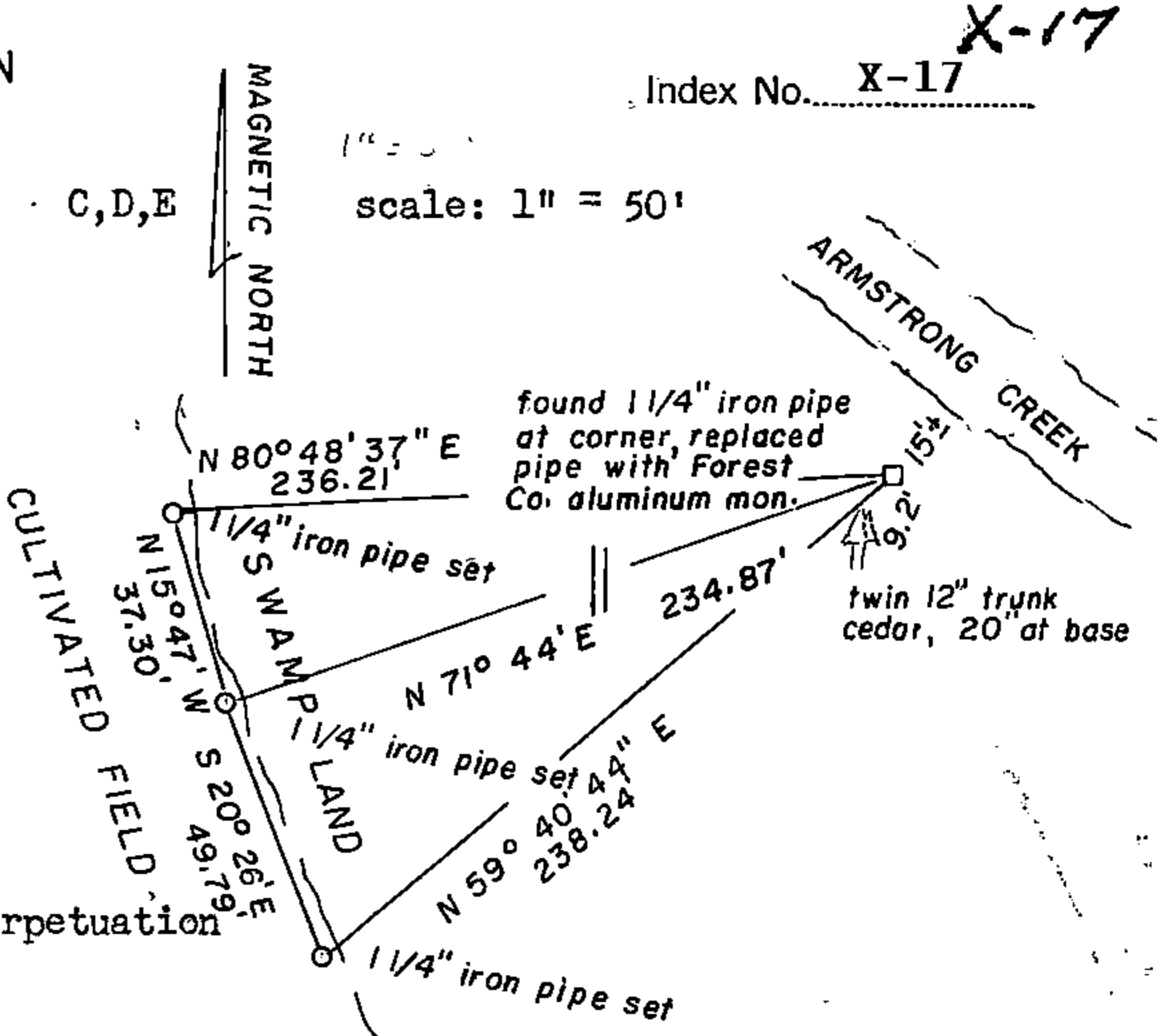

Index No. X-17

scale: 1" = 50'

