

CERTIFIED LAND CORNER RESTORATION

Index No. 121

State of Wisconsin }
County of Forest } ss.

I Thomas R. Arnett, do hereby certify that on the 21 day of Oct., 1976, I found evidence of the 1/4 corner of sec. 25 & 26 Township 37, North, Range 16 E, Fourth Principal Meridian, as described hereon; and that from this evidence I established a new monument and accessories as described hereon to perpetuate the original location of this corner.

Resident witnesses:

.....
.....
.....

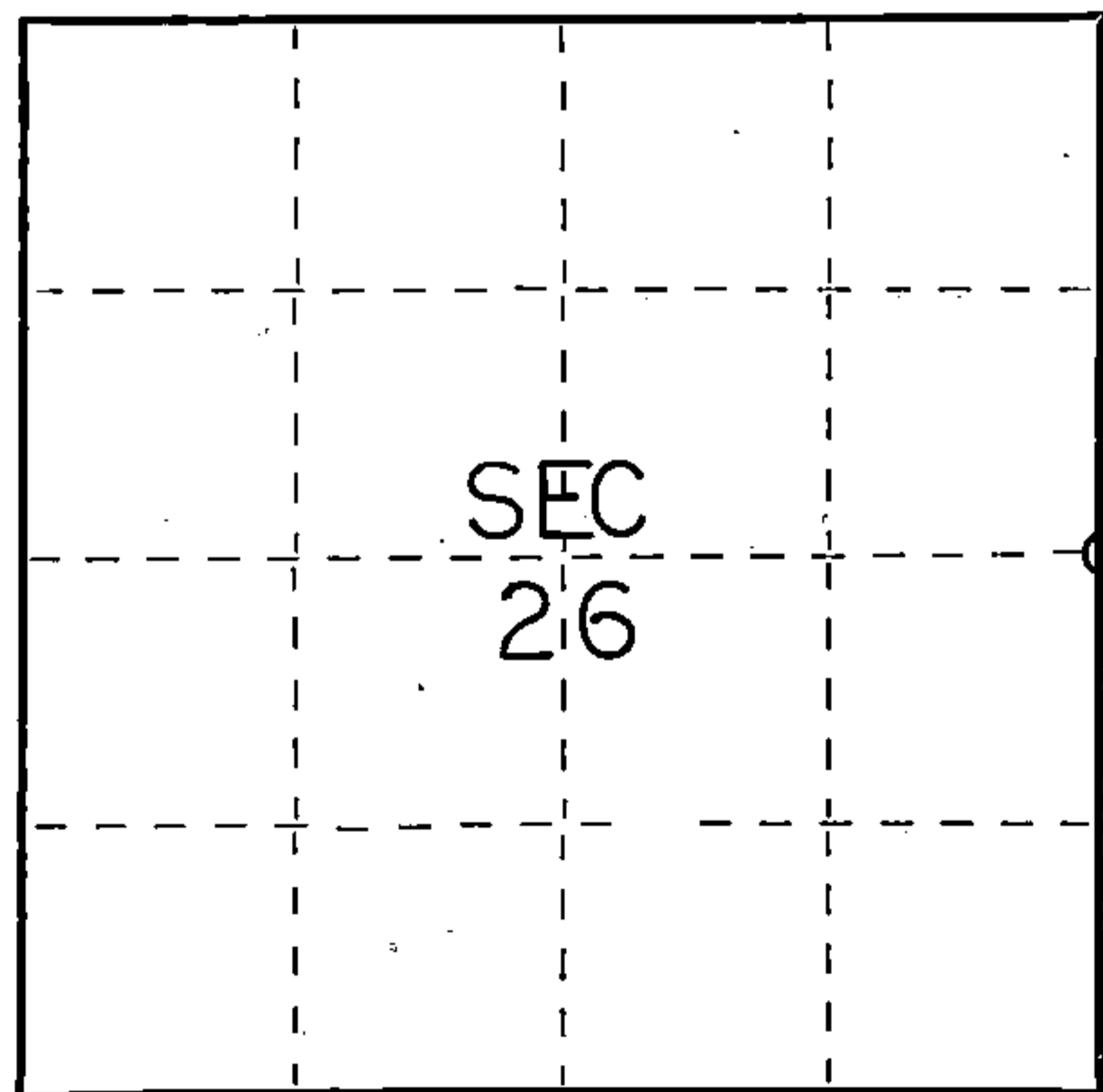

○ = Corner monument restored.

History of original corner establishment:

Original survey by James McBride July 11 - July 16, 1859.

Hemlock 10 N53E 36 Lks.
Hemlock 16 N26W 38 Lks.

Description of corner evidence found:

None: Reset corner from highway notes.

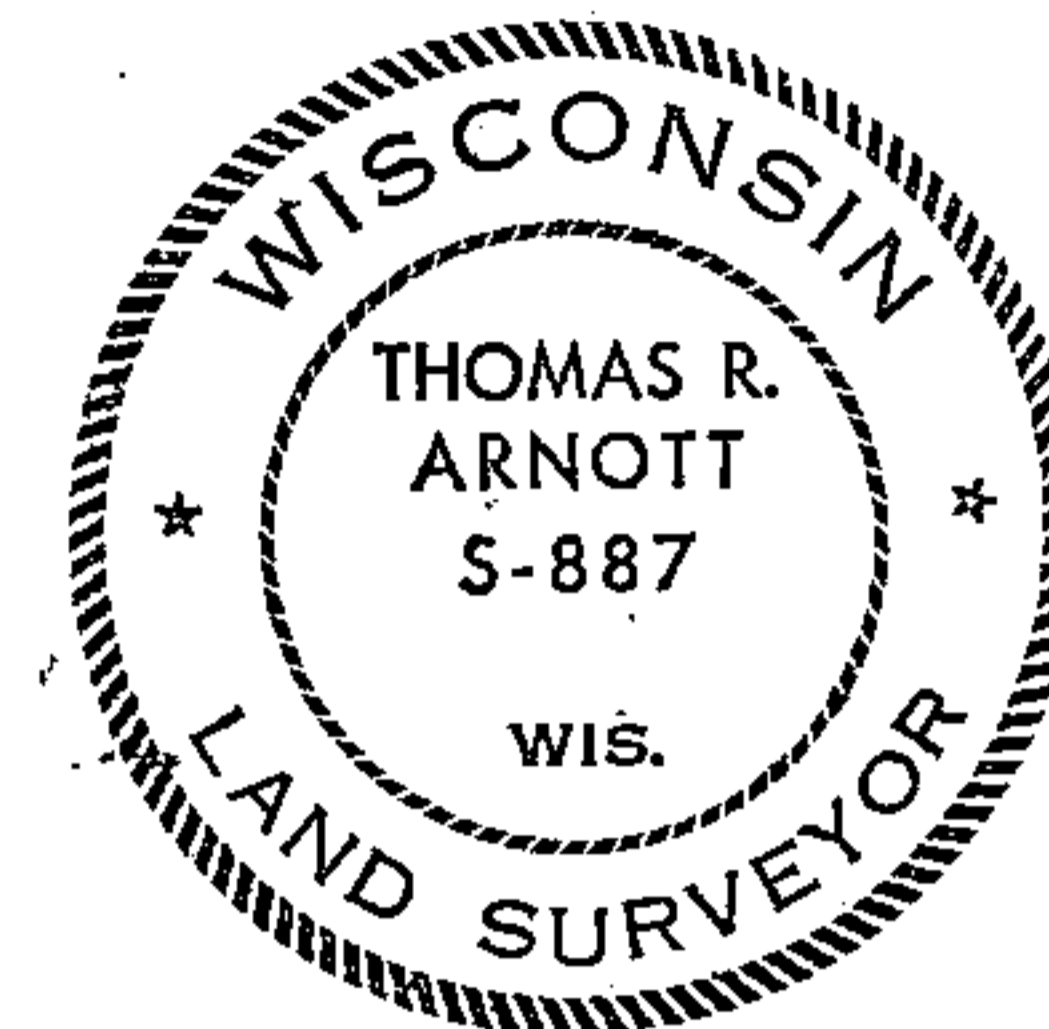

43716262000

Description of monument and accessories I established to perpetuate the original location of this corner.

Set R.R. Spike for 1/4 corner.

Ties:

NW cor Janczy Tavern N23E 95.14 feet
NE cor concrete porch of store S24W 89.02 feet
NE cor Kopka's Tavern N36W 111.46 feet

Dated at Crandon, Wis., this 26 day of Nov., 1976.

Signature Thomas R. Arnett Title Surveyor Registration No S-887
(County Surveyor, Registered Land Surveyor, or other duly authorized official)

Office of Register of Deeds, County of Forest, I hereby certify that the within instrument was filed in this office for record on the 26 day of Nov., 1976 at 3:30 o'clock P. M.

EUGENE STATEZNY

(Register of Deeds)

Document Number **110624**

By Eileen Schmidt Deputy