

CERTIFIED LAND CORNER RESTORATION

Index No. L 9

State of Wisconsin }
County of Forest } ss.

I Philip T. Hansen, do hereby certify that on the 13th day of September, 1976, I found evidence of the M.C. - Section 16 & 17 corner of North Shore - Ross Lake Township 37, North, Range 15 East, Fourth Principal Meridian, as described hereon; and that from this evidence I established a new monument and accessories as described hereon to perpetuate the original location of this corner.

Resident witnesses:

Glen Barker
Jim Claflin
Herb Wagoner

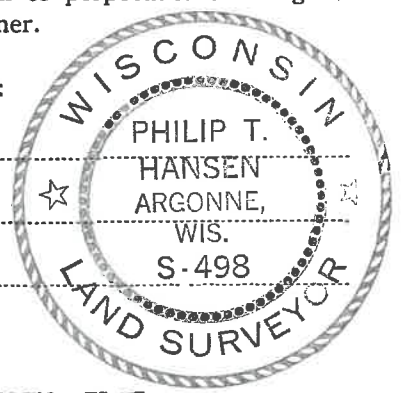

Wisconsin Printing & Binding Co. Milwaukee, Wisconsin
FORM 985

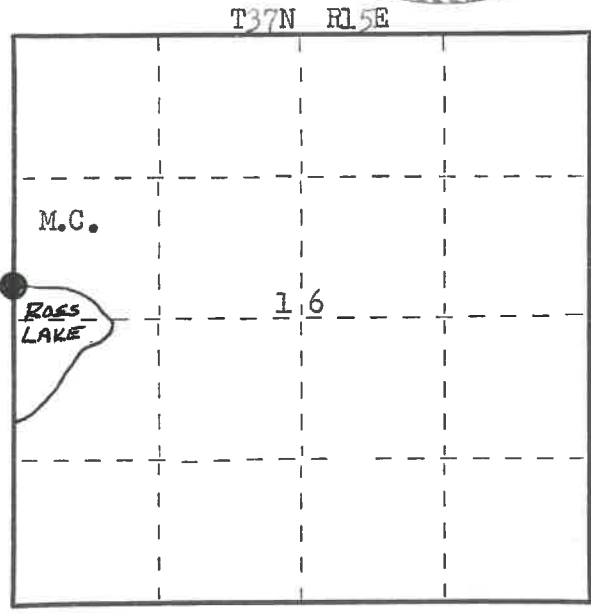

○ = Corner monument restored.

History of original corner establishment:

Original Corner established by J.L. Nowlin in 1858. This corner recovered by Ray Leigh and Phil Hansen in 1945. A rock cairn built around wood post, just north of shore line of Ross Lake.
Corner has been accepted by local land owners dating into 1930's.

Description of corner evidence found:

Recovered large rock cairn, with remains of old piece of cedar post in center.
Corner sets 8 links north of the north edge of Ross Lake.

Description of monument and accessories I established to perpetuate the original location of this corner.

Set 2 1/2" Berntsen A-1 Federal Monument in center of rock cairn. Cap stamped.
Marked NBT's - Sugar 6" N 78° W 41.3 links - scribed M.C. BT.
Sugar 6" N 50° W 48.6 links - scribed M.C. BT.
Sugar 8" N 52° E 81.6 links - scribed M.C. BT.

Monument projects 6" above rock cairn.
Monument and BT's painted blue.

T37N R15E
17 | 16 M.C.
S498-1976

Dated at Rhineland, Wis., this 16th day of September, 1976.

Signature Philip T. Hansen Title Registered Land Surveyor Registration No. S-498
(County Surveyor, Registered Land Surveyor, or other duly authorized official)

Office of Register of Deeds, County of Forest, I hereby certify that the within instrument was filed in this office for record on the 9th day of November, 1976 at 3:45 o'clock P. M.

Eugene Stutzman
(Register of Deeds)
By _____ Deputy

DOCUMENT NUMBER **110503**

H3715172100