

CERTIFIED LAND CORNER RESTORATION

Index No. V 7
1-7

State of Wisconsin }
County of Forest } ss.

I Philip T. Hansen, do hereby certify that on the 11th day of December, 1975, I found evidence of the Quarter corner of Sec. 29 and 32 Township 37, North, Range 14 East, Fourth Principal Meridian, as described hereon; and that from this evidence I established a new monument and accessories as described hereon to perpetuate the original location of this corner.

Resident witnesses:

Glen Barker

Jim Claflin

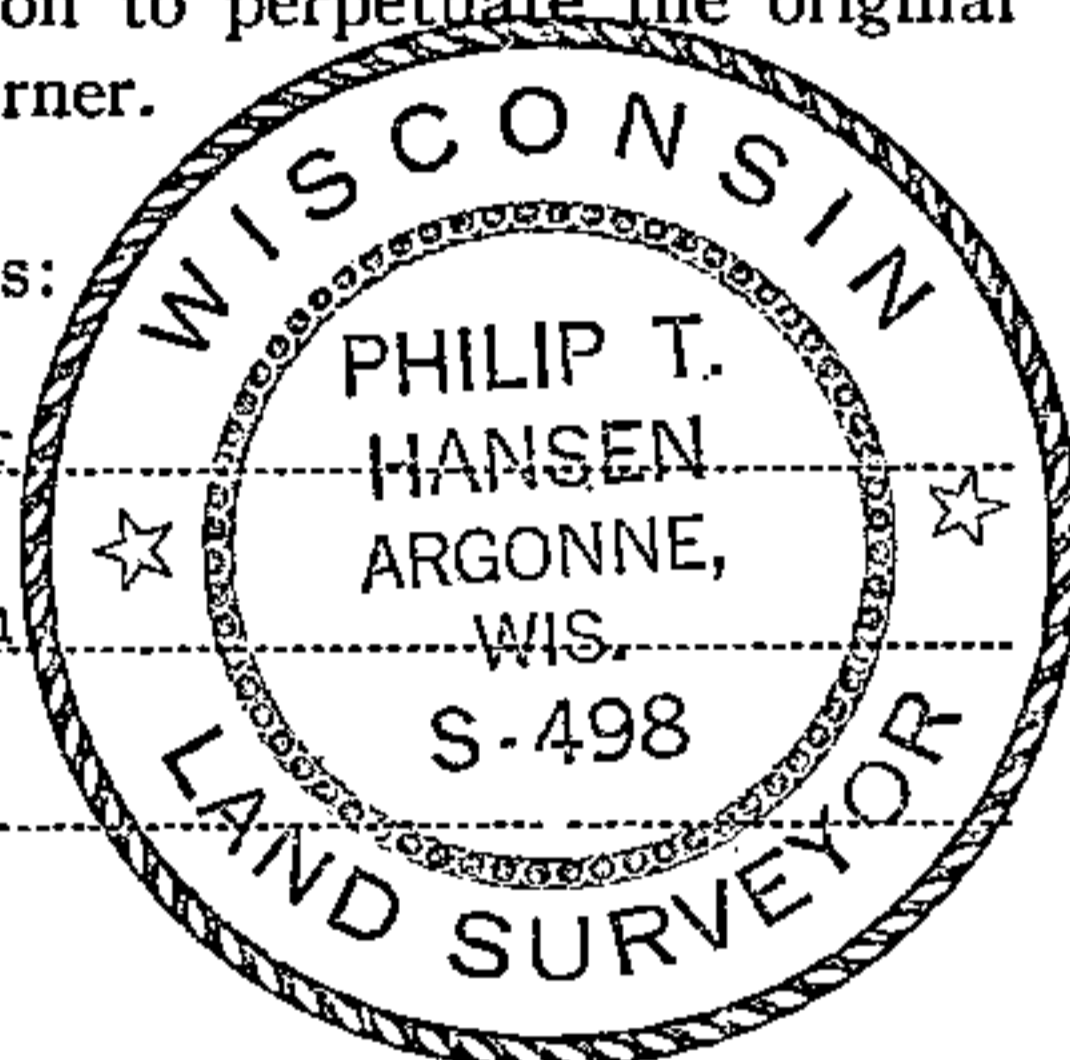

T37N R14E

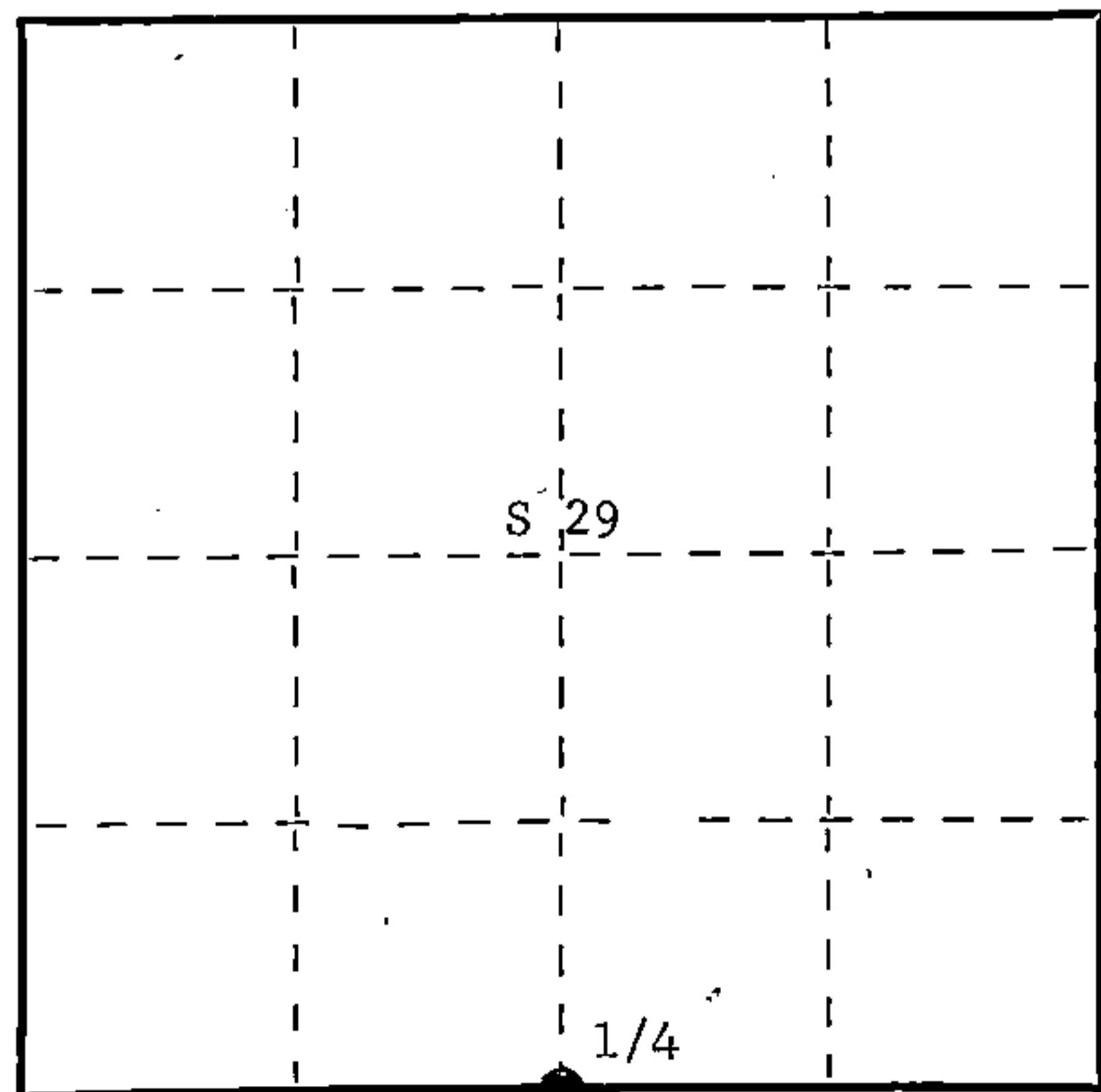

○ = Corner monument restored.

History of original corner establishment: Original corner established by J.L. Nowlin, Deputy Surveyor, in 1858, from which birch 20" bears S38°W 28 lks. and hemlock 7" bears N29°W 12 lks. This corner was reestablished by single proportion by Wisconsin State Highway Department. The true corner fell in centerline of old highway G. They set a white wooden post, with location tag and a 1-1/2" iron pipe, projecting 8" above ground, one chain north as a witness corner for true corner.

Description of corner evidence found: Recovered 1-1/2" iron pipe and white post with location tag one chain north of true corner.

No BT's were visible.

Description of monument and accessories I established to perpetuate the original location of this corner. As the true corner was in the center of the highway G, a temporary point was established one chain south from the iron pipe and post with location tag. A 2-1/2" Berntsen A-1 Federal Monument was set north on line with the witness pipe 75 lks. This pipe projects 18" above ground. Cap stamped -

NBT's - Twin maple 6" and 8" : N49°W 173.8 lks. scribed 1/4 BT.
Maple 6" : S12°W 125.9 lks. scribed 1/4 BT.

T37N R14E
1/4

S	29
S	32

 W.C.
S 75 lks.
S498 1975

Bearings and measurements made from true corner.

W.C. and BT's painted blue.

Dated at Argonne, Wis., this 15th day of December, 1975.

Signature Philip T. Hansen Title Reg. Land Surveyor Registration No. S-498
(County Surveyor, Registered Land Surveyor, or other duly authorized official)

Office of Register of Deeds, County of Forest, I hereby certify that the within instrument was filed in this office for record on the 23rd day of December, 1975 at 2:30 o'clock P. M.

Eugene Staszny
(Register of Deeds)
By _____ Deputy

DOCUMENT NUMBER **108437**

FORM 985 H. C. MILLER CO., MILWAUKEE

43711429 0020