

CERTIFIED LAND CORNER RESTORATION

Index No. **V-22**

State of Wisconsin }
County of Forest } ss.

I Daniel K. Pleoger, do hereby certify that on the 27 day of September, 19 81, I found ~~no~~ evidence of the W 1/16 corner of Sections 25 & 36 Township 37 North, Range 14 East, Fourth Principal Meridian, as described hereon; and that from this evidence I established a new monument and accessories as described hereon to perpetuate the original location of this corner.

Resident witness

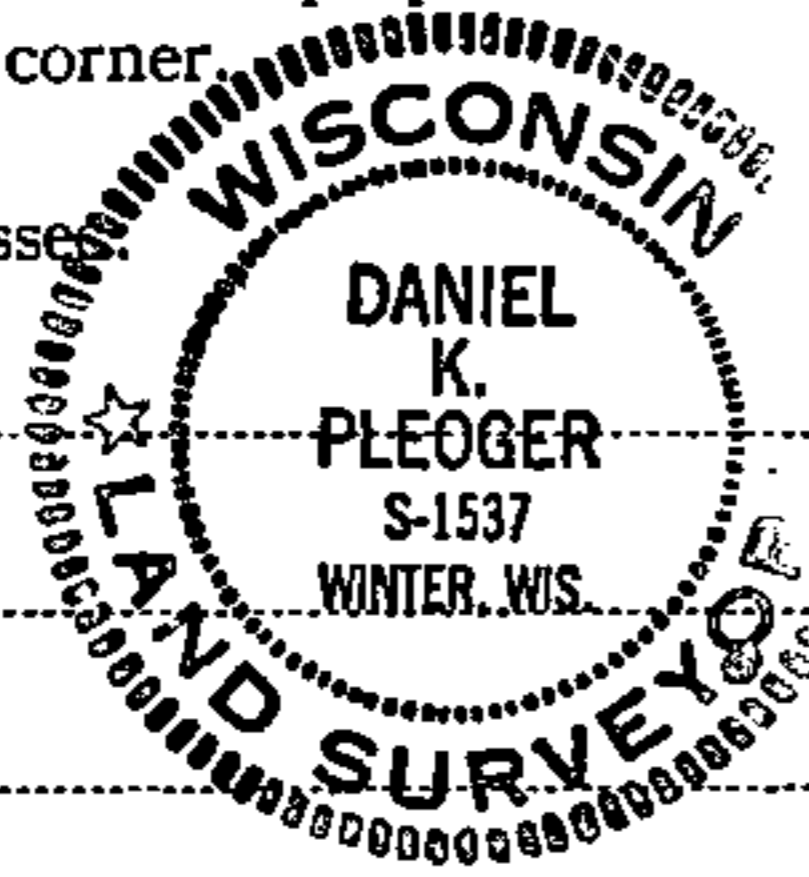

FORM 985 R. C. MILLER CO., MILWAUKEE

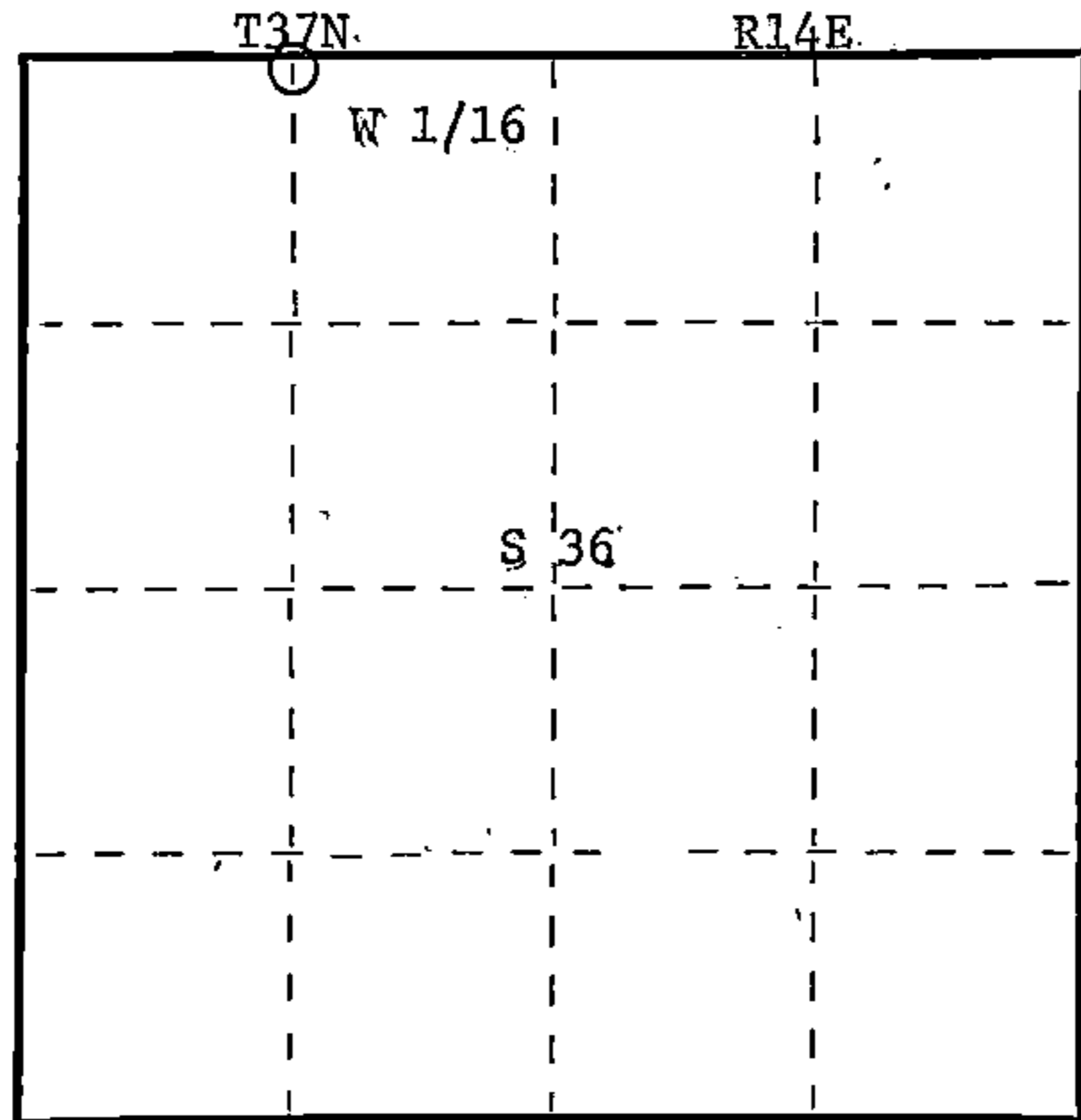

○ = Corner monument restored.

History of original corner establishment:

No evidence of any previous corner

Description of corner evidence found:

Total distance from section corner 25,26,35,36 to 1/4 corner between sections 25 & 26 is 2695.034 ft. at bearing S84-56-32E.
Set W 1/16 1347.517 ft. intermediate.

Description of monument and accessories I established to perpetuate the original location of this corner.

Set a 1 1/2" iron pipe with 2" diameter brass cap stamped:

Monument projects 18" above ground

Marked NBTs:

- Sugar 5" S36W 32.10 ft.
- Sugar 6" due north 31.58 ft.
- Scribed 1/16 - B.T.

S1537
T37N R14E

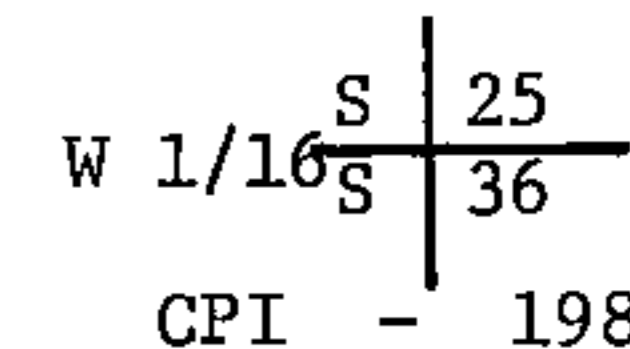

Dated at Rhinelander, Wis., this 4th day of November, 19 81

Signature *Daniel K. Pleoger* Title Registered Land Surveyor Registration No. 1537
(County Surveyor, Registered Land Surveyor, or other duly authorized official)

Office of Register of Deeds, County of Forest, I hereby certify that the within instrument was filed in this office for record on the 19th day of January, 19 82 at 3:00 o'clock P. M.

Eugene Stagny
(Register of Deeds)

DOCUMENT NO.

121091

By _____ Deputy

43714250030