

CERTIFIED LAND CORNER RESTORATION

Index No. N 3

State of Wisconsin }
County of Forest } ss.

I Philip T. Hansen, do hereby certify that on the 30th day of September, 1975, I found evidence of the Quarter corner of Sec. 18 and 19 Township 37, North, Range 14 East, Fourth Principal Meridian, as described hereon; and that from this evidence I established a new monument and accessories as described hereon to perpetuate the original location of this corner.

History of original corner establishment: Original corner established by James L. Nowlin, Gov. Deputy Surveyor, in 1865, from which Spruce 10" bears S8°E 8 links, and Spruce 6" bears N5°W 12 links. Corner recovered by E.B. Hurst, Consolidated Forester, in 1932, during mapping. Corner perpetuated by Ray Leigh and P.T. Hansen, Consolidated Forester and Surveyor.

Description of corner evidence found:

Recovered 5" cedar post, squared and scribed 1/4 S S18, 1/4 S S19, in fair condition. No OBT's were recovered.

Resident witnesses:

Glen Barker

Jim Claflin

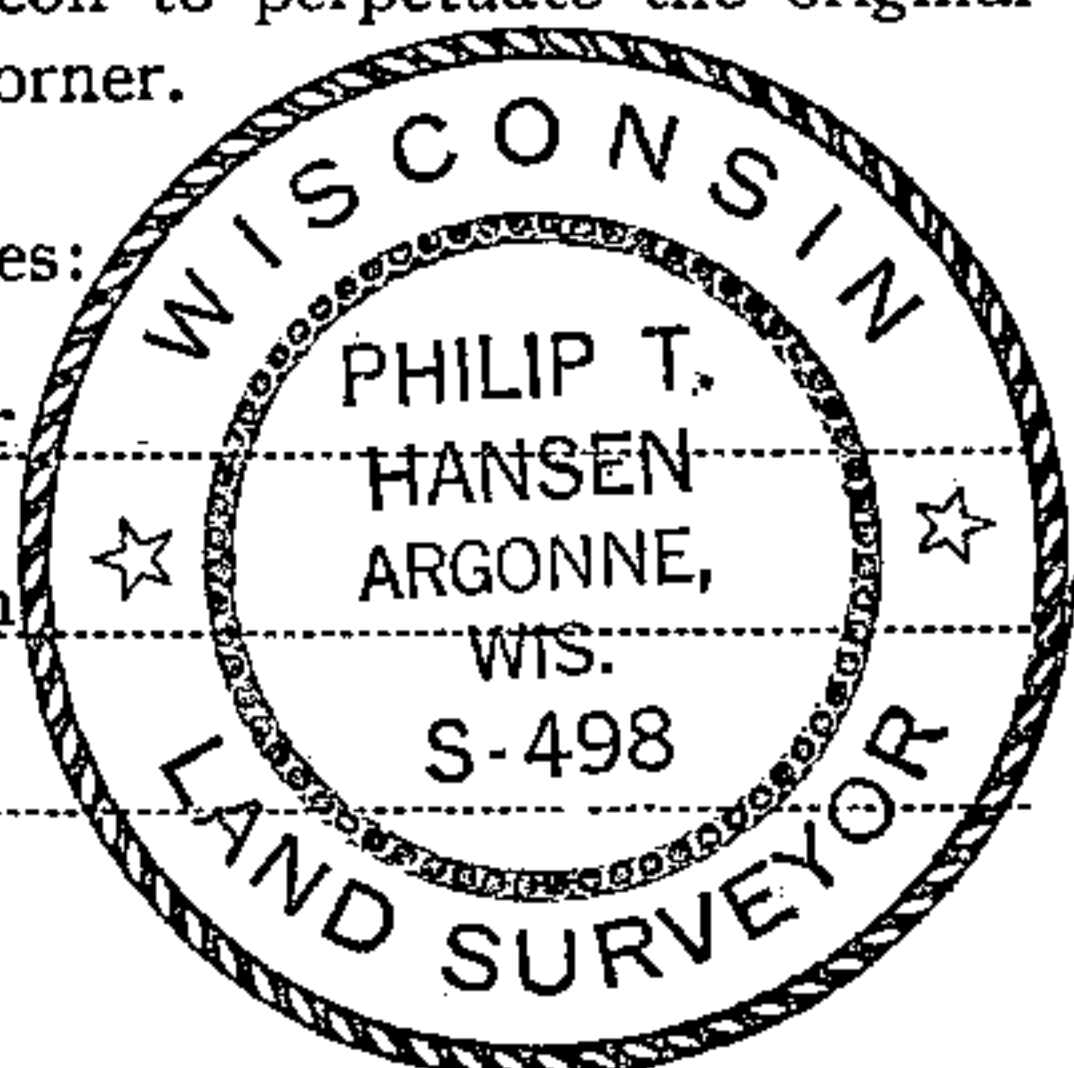

T37N R14E

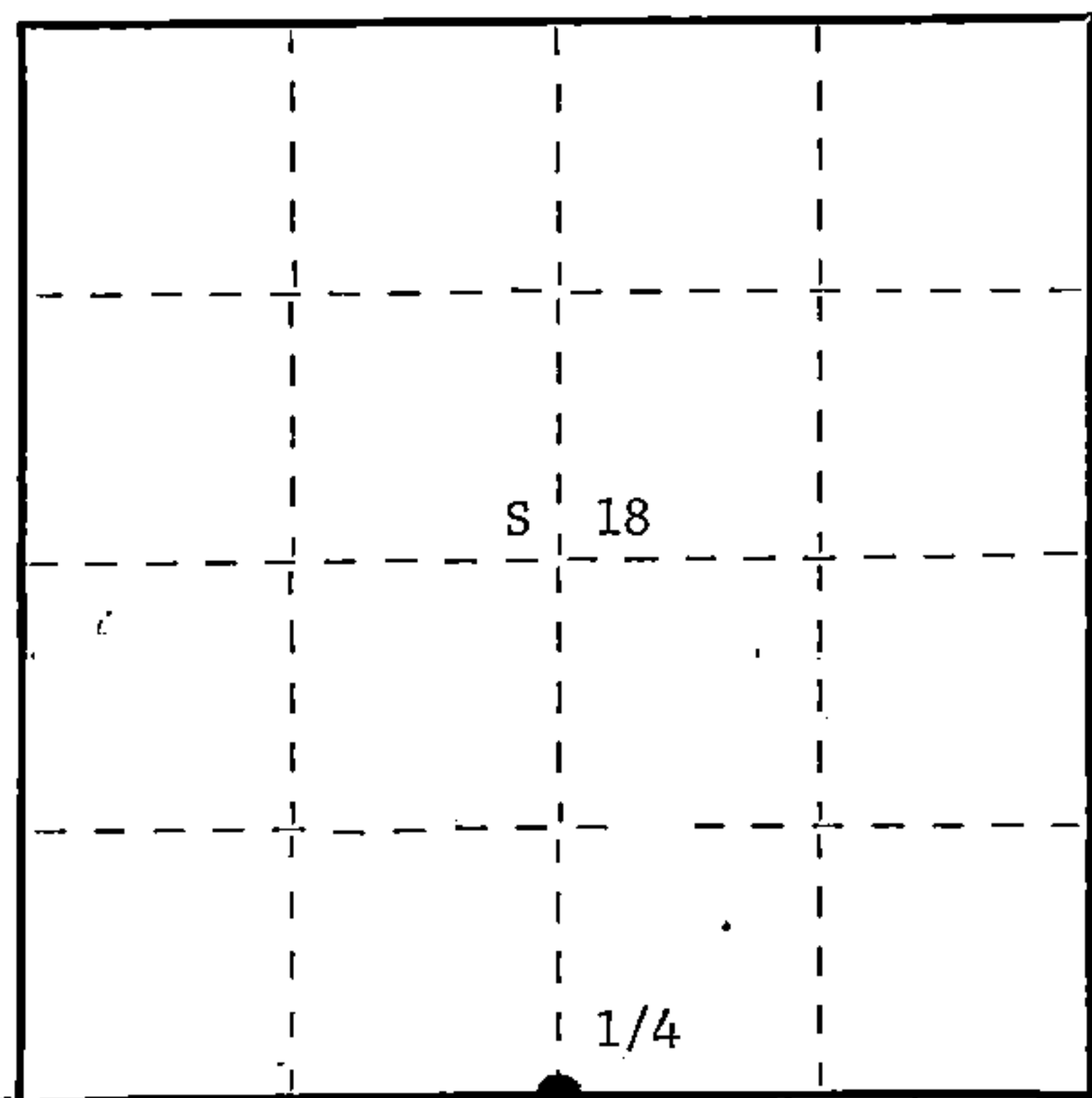

○ = Corner monument restored.

Description of monument and accessories I established to perpetuate the original location of this corner.

Replaced wooden post with 2 1/2" x 30" Berntsen, A-1 Federal Monument, aluminum pipe with magnets installed in cap and base. Cap stamped -

NBT's - Black spruce 6" S11°W 21.7 links, scribed 1/4 BT.
Black spruce 6" N35°E 32.5 links, scribed 1/4 BT.

S498
T37N R14E
1/4 S | 18
S | 19
1975

Dated at Argonne, Wis., this 2nd day of October, 1975.

Signature Philip T. Hansen Title Registered Land Surveyor Registration No. S-498
(County Surveyor, Registered Land Surveyor, or other duly authorized official)

Office of Register of Deeds, County of Forest, I hereby certify that the within instrument was filed in this office for record on the 13th day of October, 1975 at 4:00 o'clock P. M.

Eugene Stetson
(Register of Deeds)
By _____ Deputy

DOCUMENT NUMBER -- **107969**

FORM 985 H. C. MILLER CO., MILWAUKEE

4371418 0020