

U.S. PUBLIC LAND SURVEY MONUMENT RECORD

Index No. E-11

State of Wisconsin }
County of FOREST } ss.

I, John C. Schulke, do hereby certify that on the 2nd day of July, 1986, I found evidence of the South Quarter corner of Section 4 Township 37 North, Range 12 East, Fourth Principal Meridian, as described hereon; and that from this evidence I established a new monument and accessories as described hereon to perpetuate the original location of this corner.

Resident witnesses:

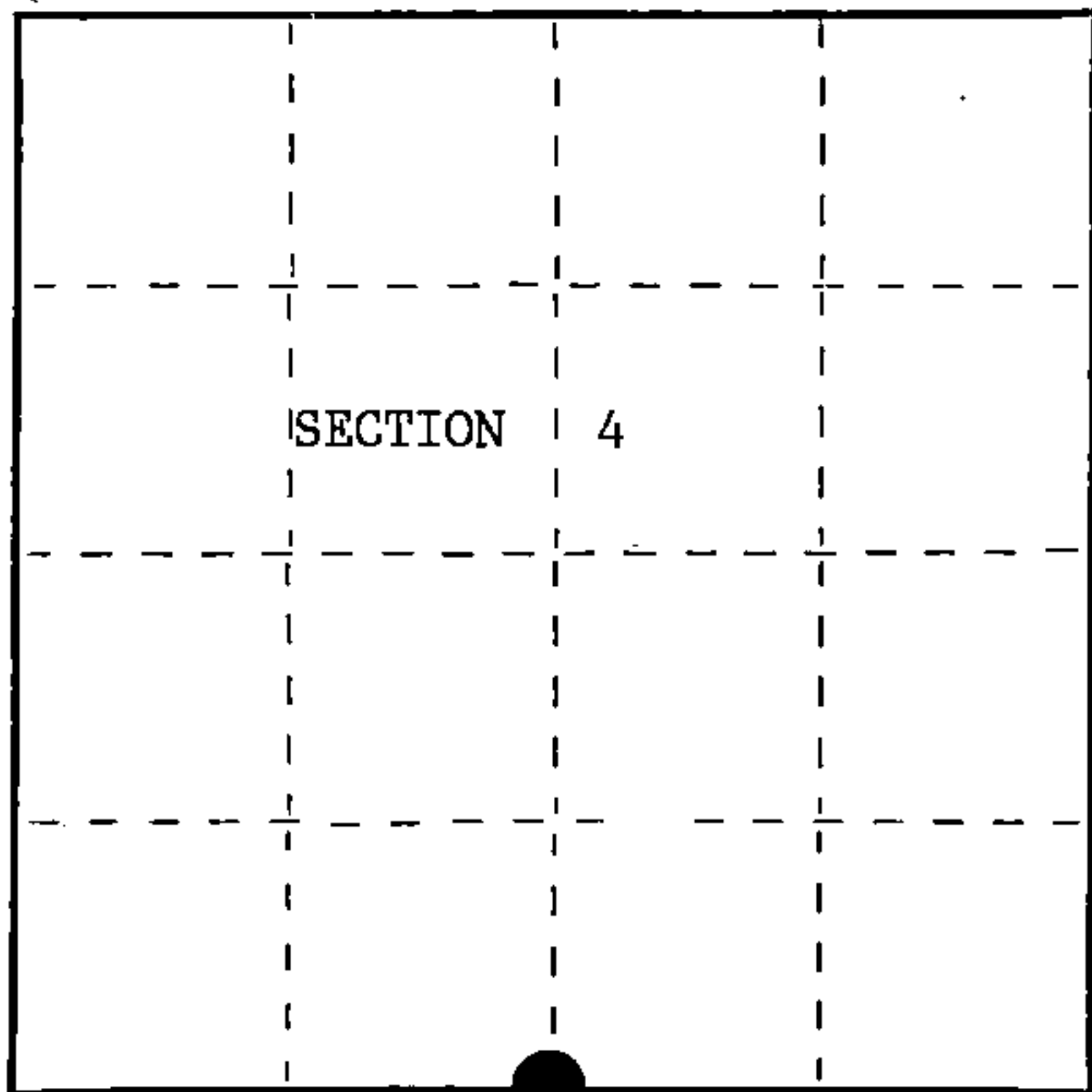

○ = Corner monument restored.

History of original corner establishment:

1. Original Government Survey in 1859 by William Daugherty, U.S. Deputy Surveyor. Set wooden post with the following bearing trees:
Hemlock 10" N32°W 35 links Birch 12" S20°E 18 links
2. Railroad maps indicate a recovered corner about 1917. The maps also indicate the Section line the West bears about N80°W.

Description of corner evidence found:

Found fence corner that has been long accepted as the corner by all concerned parties. Fence run in the three cardinal directions with the fourth fence to the West bearing N80°W following the Section line. Accepted this fence corner to be the best evidence for the location of the original corner. There were no remains of the GLO bearing trees. The entire has been heavily pastured, with all evidence being destroyed.

Description of monument and accessories I established to perpetuate the original location of this corner.

Set a 2 1/2" diameter aluminum pipe monument, 3 feet long, 2 feet in the ground, with an aluminum cap stamped; T37N, R12E, 1/4, S4 and S9, 1986, S-1665. Established the following new bearing trees which are blazed, scribed, painted and tagged. Monument next to fence corner running North-South and East. Old fence bears N80°W along section line to the West.

Triple R. Maple	6"	N21°E	48.68 feet
Tamarack	4"	S28°E	67.22 feet
Red Maple	8"	N52°W	55.93 feet
Tamarack	5"	S11°W	93.95 feet
Steel sign post		Northeast	0.8 feet

Dated at Ludington, Michigan, ~~Wis~~, this fifth day of January, 1987.

Signature John C. Schulke Title Land Surveyor Registration No. S-1665
(County Surveyor, Registered Land Surveyor, or other duly authorized official)

Office of Register of Deeds, County of Forest, I hereby certify that the within instrument was filed in this office for record on the 24th day of February, 1987 at 2:00 o'clock P. M.

Paul Aschenbrenner
(Register of Deeds)

By _____ Deputy

REGISTRAR'S OFFICE
Forest County, Wis.
Received for record this 24th day
of February, A.D., 1987, at
2:00 o'clock P.M. and recorded
in Vol. CORNER RESTORATIONS
page E-11
Paul Aschenbrenner
Register of Deeds

FORM NO. 985-A

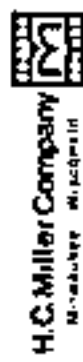

Stock No. 26273

DOCUMENT NUMBER

132173

43712040020

(e) Describe any material discrepancy between the location of the corner as restored or reestablished and the location of that corner as previously restored or reestablished by distance and direction. Show the discrepancy on the plan view drawing under (d), above. Show the distances between the corner as previously restored or reestablished and (1) the corner as restored or reestablished, and (2) to at least 2 of the witness monuments shown on the drawing in (d), above.

None. Location fits railroad maps.

(f) Was the corner restored through acceptance of (1) an obliterated evidence location, or, (2) a found perpetuated location?

(1) an obliterated evidence location

(g&h) Was the corner reestablished through lost corner proportionate methods? If so, show the method, including the directions and distances to other public land survey corners used as evidence or used for proportioning in determining the corner location?

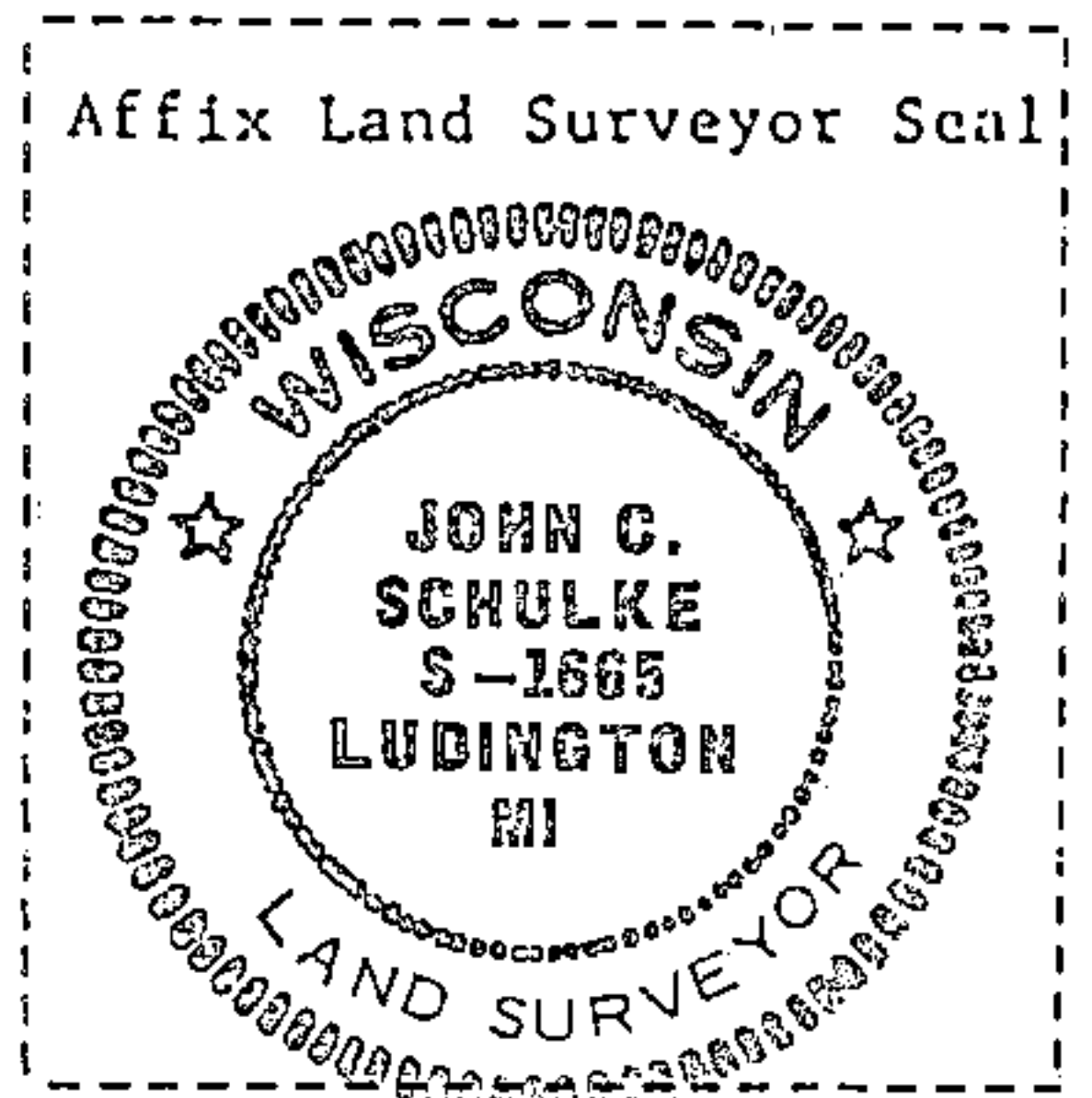
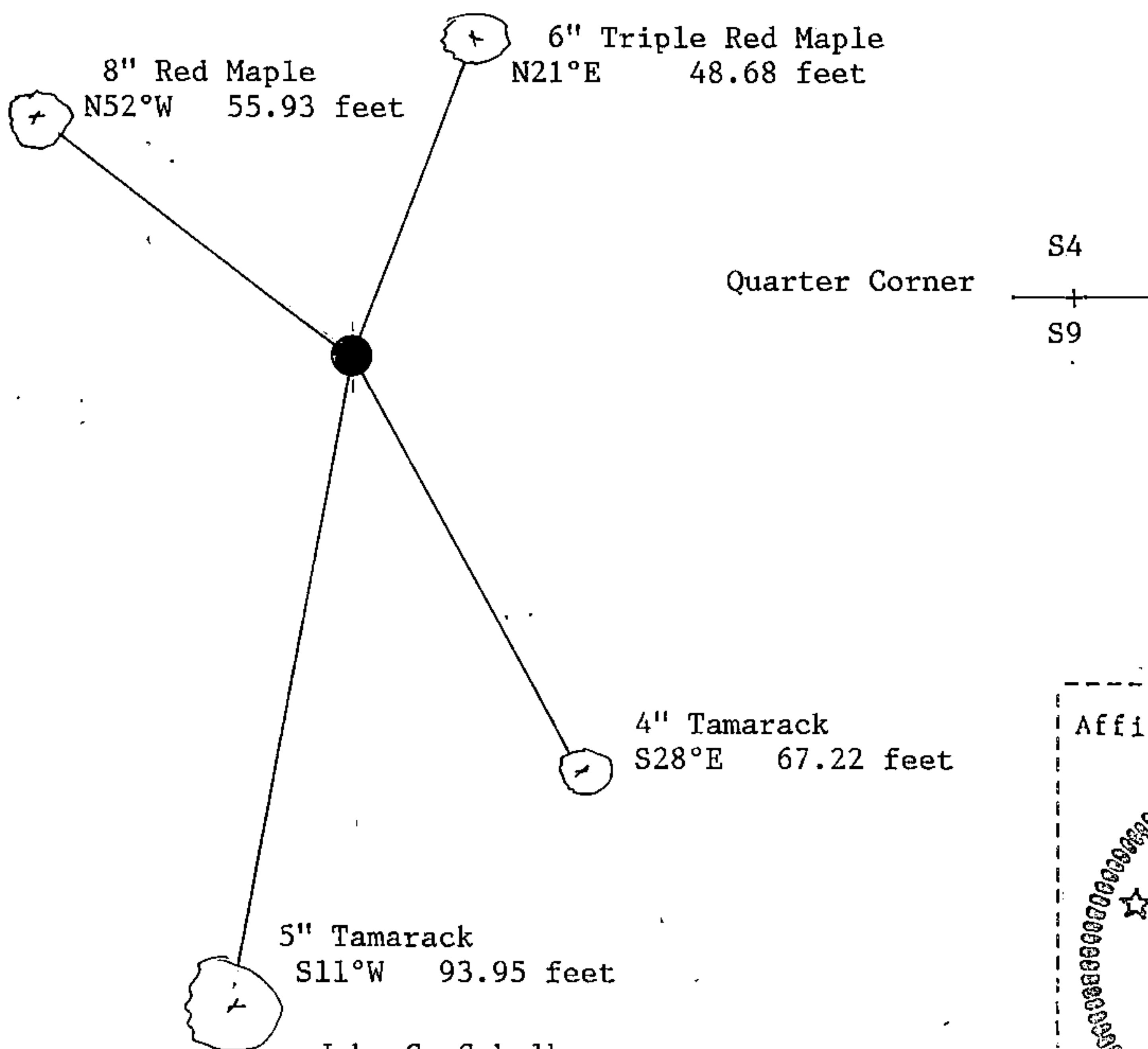

(i) I, John C. Schulke
 (type or print name) certify that the corner location shown on this record was determined by me or under my direction and control and that this U.S. Public Land Survey Monument Record is correct and complete to the best of my knowledge and belief.

John C. Schulke Signature Jan 5, 1987 Date

Certificate Ready for Filing: Dale B. Staege District Ranger 2/24/87 Date