

CERTIFIED LAND CORNER RESTORATION

Index No. K-1

State of Wisconsin }  
County of Forest } ss.

I Philip T. Hansen, do hereby certify that on the 2nd day of August, 1976, I found evidence of the N 1/16 corner of Section 13 & 18 Township 37, North, Range 11 & 12, Fourth Principal Meridian, as described hereon; and that from this evidence I established a new monument and accessories as described hereon to perpetuate the original location of this corner.

Resident witnesses:

Glen Barker

Jim Claflin

Herb Wagoner

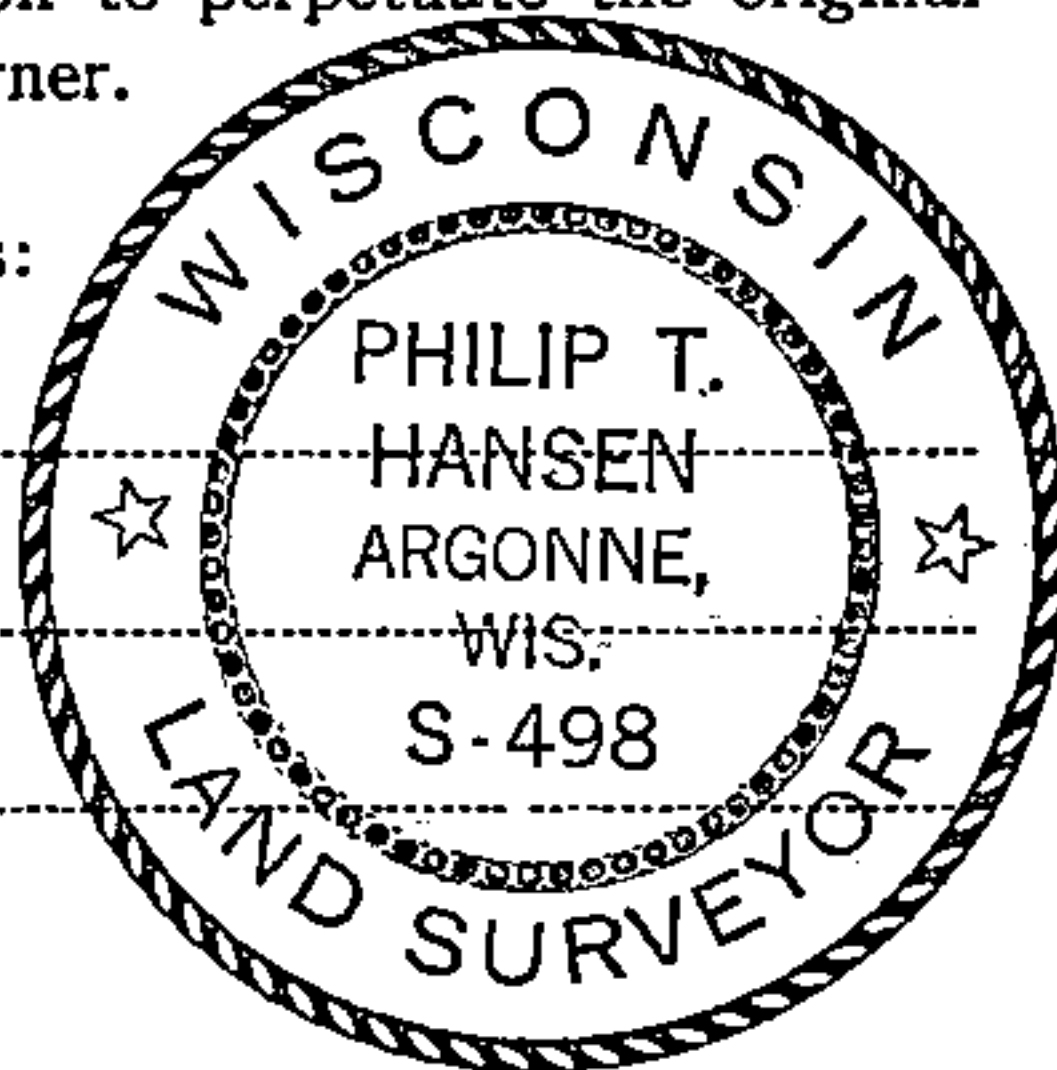

FORM 985 H. G. MILLER CO., MILWAUKEE

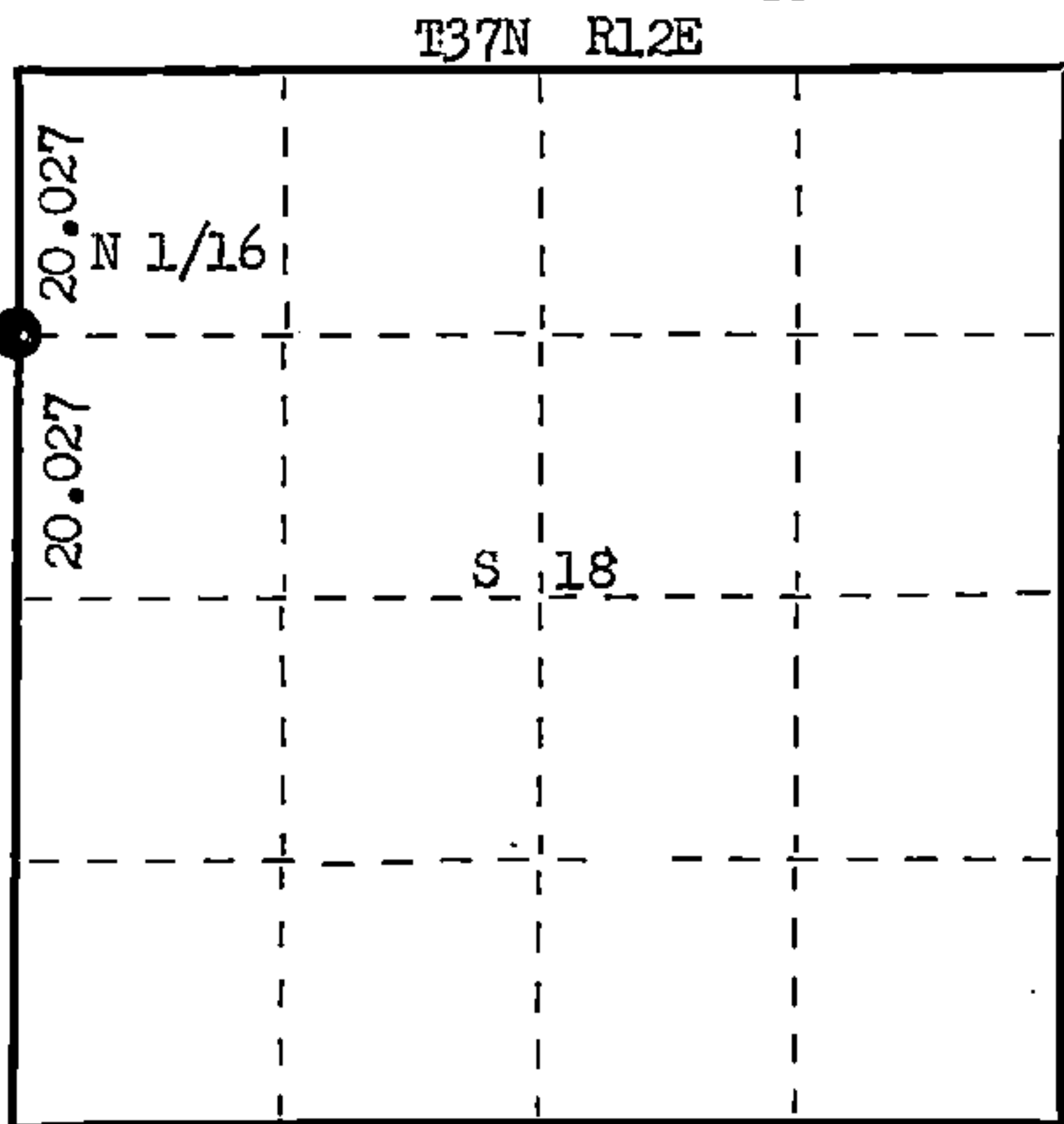

○ = Corner monument restored.

History of original corner establishment: Oneida  
Corner established by V.M. Maine County Surveyor, in 1935. Ran random line North from East 1/4 Corner 40.05 1/2 chains var. 2° 15' E, fell 29 1/2 links west of Section Corner. Set N 1/16 at 20.027 chains 14-3/4 links east. Corrected bearing 1° 50' E. Marked BT's - Hemlock 14" N 78° E 24 1/2 links, Cedar 4" N 70° W 20 1/2 links.

Corner recovered by H.C. Lawrence, Registered Land Surveyor. Set new post.

Description of corner evidence found:

Recovered 6" cedar post, squared and scribed S13, N 1/16, S18 N 1/16 in poor condition.

Recovered OBT's - Hemlock 20" N 71° E 25.8 lks. Top scribed N 1/16 S18. Bottom grown over.

Description of monument and accessories I established to perpetuate the original location of this corner.

Replaced 6" cedar post with 1 1/2" OD iron pipe with 2" brass cap stamped.

Monument projects 24" above ground.

NBT - Sugar 8" N 15° E 35.1 links, scribed 1/16 BT.

Monument and BT's painted blue.

S498  
T37N.  
R 11 13 18 R  
N 1/16 11 13 18 12  
E CPI-1976 E

Dated at Rhineland, Wis., this 31st day of August, 1976

Signature Philip T. Hansen Title Registered Land Surveyor Registration No. S-498  
(County Surveyor, Registered Land Surveyor, or other duly authorized official)

Office of Register of Deeds, County of Forest, I hereby certify that the within instrument was filed in this office for record on the 8th day of September, 1976 at 10 o'clock A. M.

Eugene Stetson  
(Register of Deeds)

By \_\_\_\_\_ Deputy

DOCUMENT NUMBER  
**110109**

43711133006