

CERTIFIED LAND CORNER RESTORATION

Index No. **X 5**

State of Wisconsin }  
County of Forest } ss.

I Thomas R. Arnott, do hereby certify that on the 13th day of June, 1976, I found evidence of the 1/4 corner of sections 31 & 32 Township 36, North, Range 15 E, Fourth Principal Meridian, as described hereon; and that from this evidence I established a new monument and accessories as described hereon to perpetuate the original location of this corner.

Resident witnesses:

.....  
.....  
.....

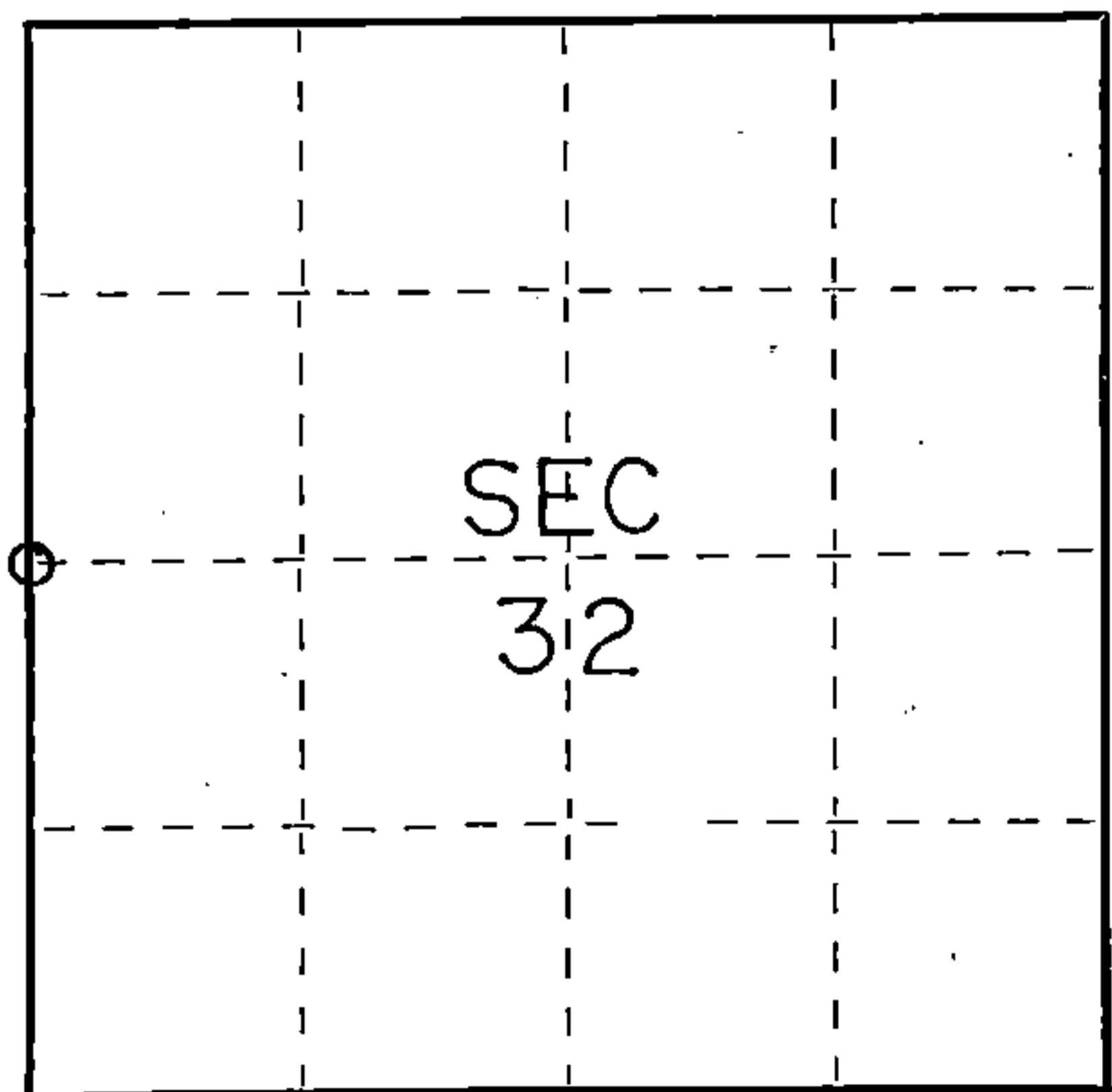

○ = Corner monument restored.

History of original corner establishment:

Original subdivision by James McBrid 17 Jul - 28 Jul, 1859

Sugar 10 West 8 Lks.  
Sugar 8 S54E 9 Lks.

Description of corner evidence found:

Found 1 1/4" iron pipe also found 1 3/4" iron pipe .32 feet east

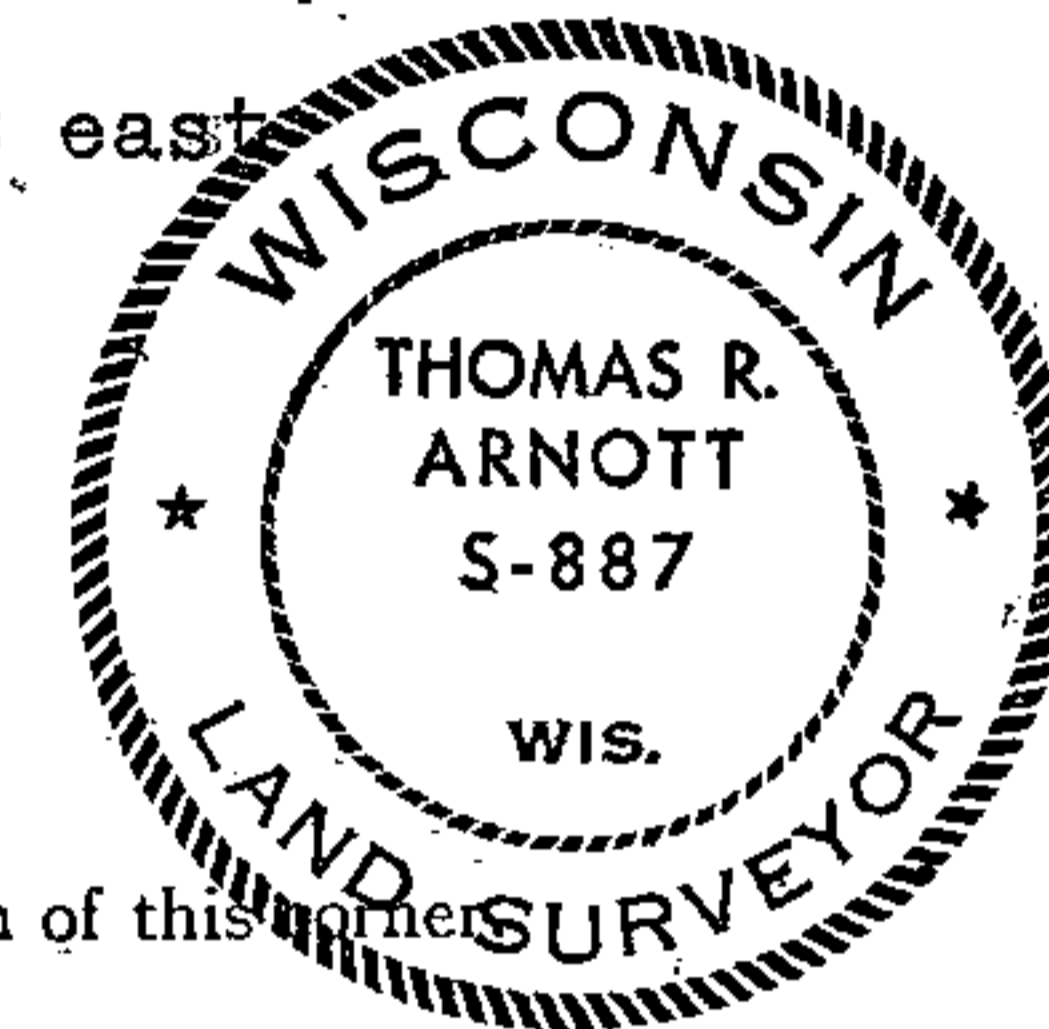

4215312000

Description of monument and accessories I established to perpetuate the original location of this corner:

Replaced 1 1/4" iron pipe with new Forest County Aluminum Monument  
Left 1 3/4" iron pipe .32 feet east

Ties to Aluminum monument:

Power pole (3615-31E1) N57W 38.80 feet  
Telephone Pole S37E 37.00 feet

Dated at Grandon, Wis., this 11th day of June, 1976

Signature Thomas Arnott Title Surveyor Registration No. S-887  
(County Surveyor, Registered Land Surveyor, or other duly authorized official)

Office of Register of Deeds, County of Forest, I hereby certify that the within instrument was filed in this office for record on the 11th day of June, 1976 at 3 o'clock P. M.

EUGENE STATEZNY

(Register of Deeds)

Document Number **109437**

By Eileen Schmidt Deputy

FORM 985 H. C. MILLER CO., MILWAUKEE