

CERTIFIED LAND CORNER RESTORATION

State of Wisconsin }
County of Forest } ss.

I, Milo E. Stefan, do hereby certify that on the 13 day of December, 1979, I found evidence of the West Quarter corner of Section 13 Township 36 North, Range 15 East, Fourth Principal Meridian, as described hereon; and that from this evidence I established a new monument and accessories as described hereon to perpetuate the original location of this corner:

Description of original monument and accessories and subsequent restorations:

Surveyed in 1859 by James McBride.
40.00 chains north between sections 13 and 14.
Set 1/4 section post.
Elm 10", S4°E, 6 links
Elm 10", S47°W, 31 links.

Description of corner evidence found:

Wood post point in mound of stone from which an elm snag with scribing in face, S47°W, 31 links; Rotten Elm stump, S4°E, 6 links.

Description of monument and accessories I established to perpetuate the location of this corner:

Replaced post point with a 2 inch inside diameter galvanized iron pipe 36" long, concrete filled, with a 3 inch brass tablet stamped: T36N, R15E, 1/4, S13, S14, 1979, S-1558.

Blazed and scribed the following new bearing trees:

Hemlock 10", N58°E, 25.36 feet
White Pine 22", S44°E, 65.72 feet
Hemlock 11", S9°E, 29.37 feet
Steel sign post, southeast, .5feet

DOCUMENT NO.
119854

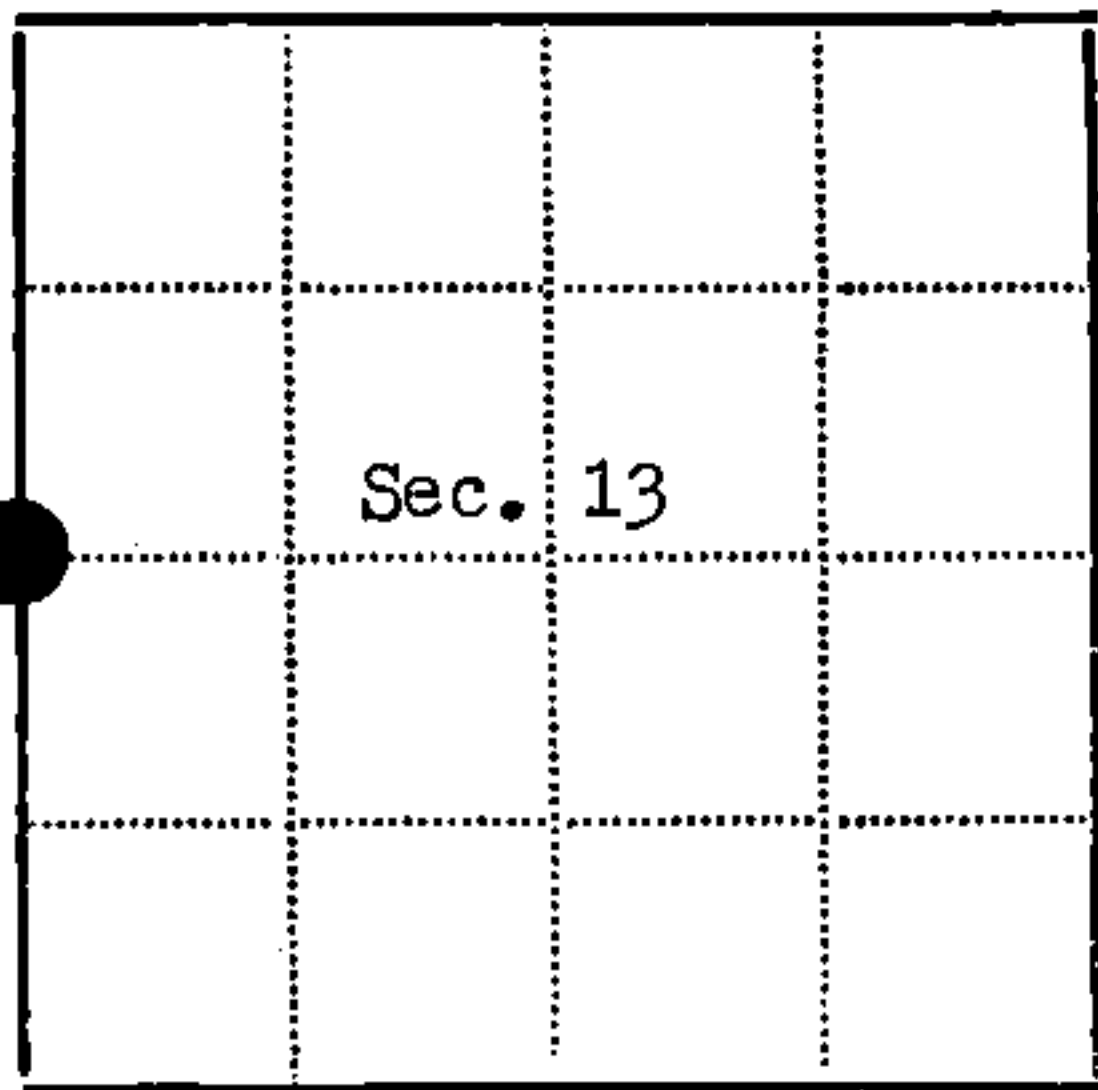

● - Corner monument restored
□ -

Resident witnesses.....

Dated at Laona Wisconsin, this 18 day of December 1979.

Signature Milo E. Stefan Title Land Surveyor
(County Surveyor, Registered Land Surveyor, or other duly authorized official)

Surveyors Registration No. S-1558.

Office of Register of Deeds County of Forest

I hereby certify that the within instrument was filed in this office for record on the 2nd day of June 1981, and was filed in Book No. Page No. of County Records.

Signature Eugene Staszny Title Register of Deeds

Township 36N, Range 15E, Section 13, Index No. L-21, Page No.

U. S. PUBLIC LAND SURVEY MONUMENT RECORD

INDEX NO. L-21

Quarter _____ Corner to Section 13 14 T 36 N, R 15 E
(Section/Quarter)

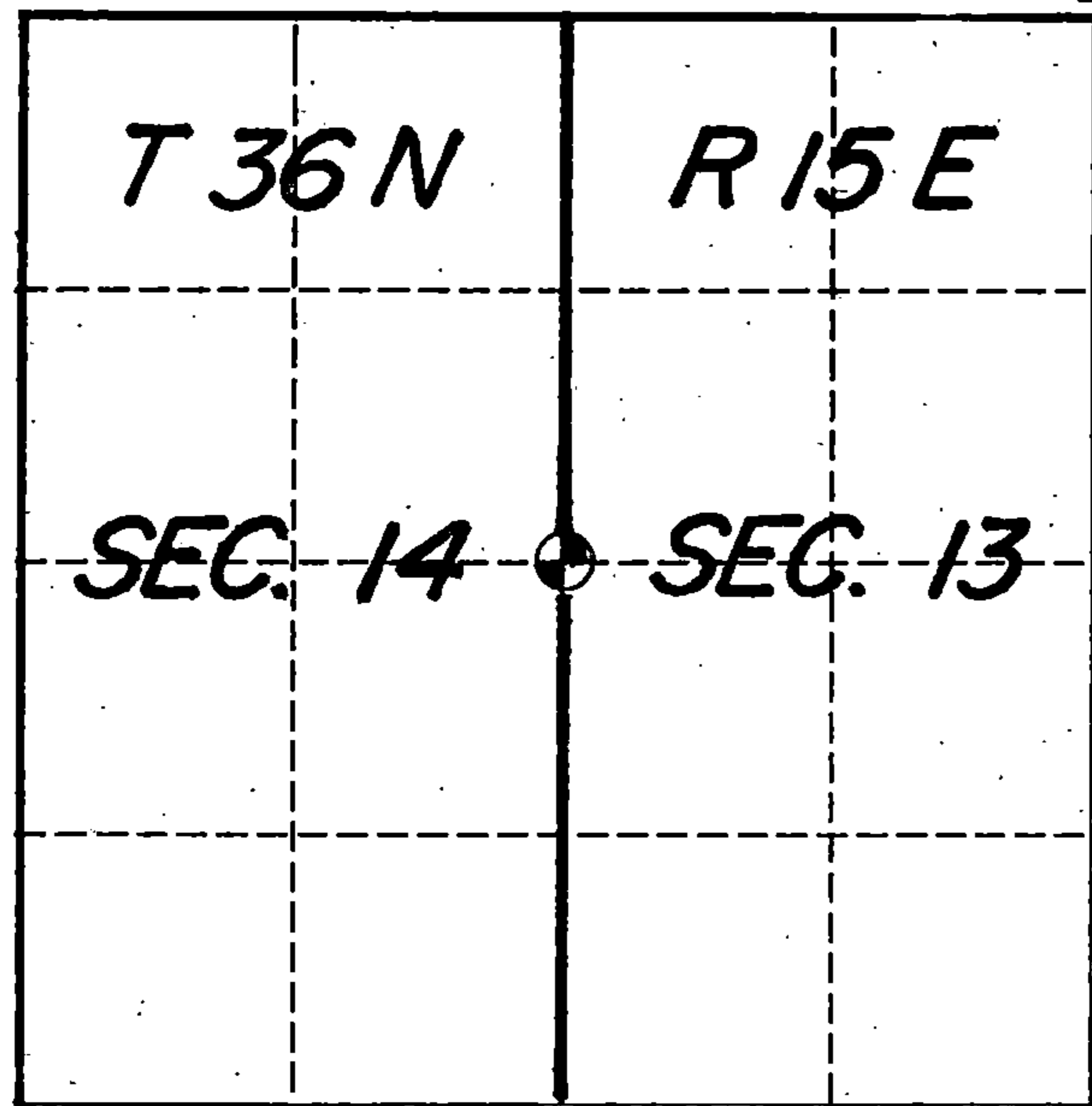

Show distances and bearings if set by proportional measurement.

History of original corner establishment, record evidence, monument evidence, occupational evidence, testimonial evidence or any other material evidence, and what you found and how the monument was set.

In 1859 James McBride set a wood post at this corner location and scribed the following bearing trees:

- Elm 10" S 04°E 6 links
- Elm 10" S 47°W 31 links

In 1979 Milo Stefan found a wood post point in a mound of stone and two dead Elm stumps at the BT locations. He set a 2" iron pipe with brass cap stamped for corner in place of the old post and marked a 10" Hemlock, 22" White Pine, 11" Hemlock and set a steel sign post SE 0.5 ft.

I found Milo's iron pipe in good condition with the steel post knocked down. The 10" Hemlock was now 14", the White Pine was 24" and the other Hemlock was 14". I reset the sign post and marked another BT as shown below.

In the plan view drawing below, provide reference ties to at least 4 witness monuments, or, if the location is within a municipality, to at least 2 witness monuments. (Witness monuments shall be made of concrete, natural stone, iron or other equally durable material, except wood other than bearing trees.) Also, show any material discrepancies between the corner restored or re-established and the location of any other previous corner location or occupation.

○ = Corner monument restored.

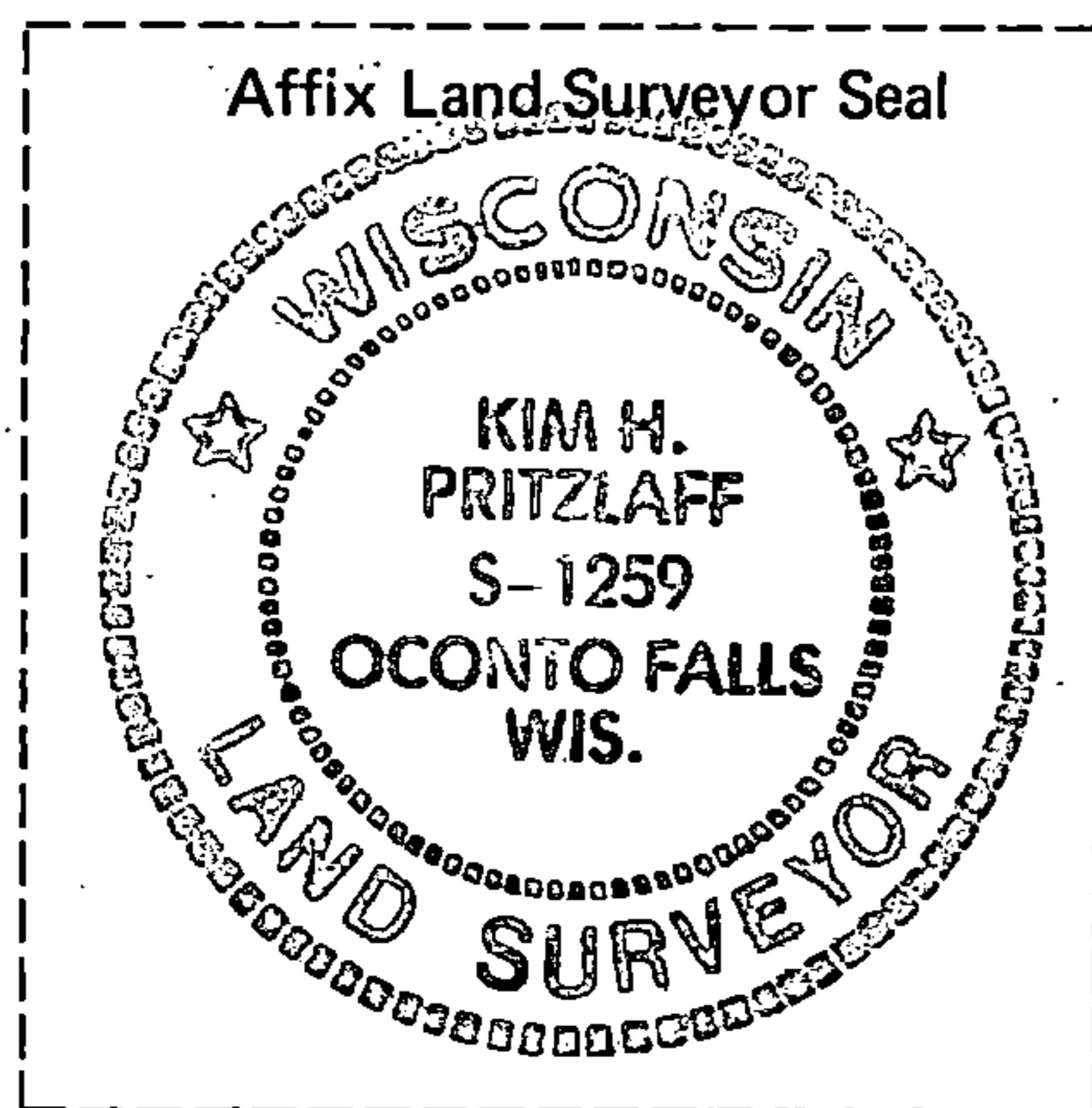

The corner consists of a 2" iron pipe with brass cap stamped for corner. The trees are scribed "BT" and blazed with nails driven into the trees centers for measurement to the monument. Bearings are magnetic.

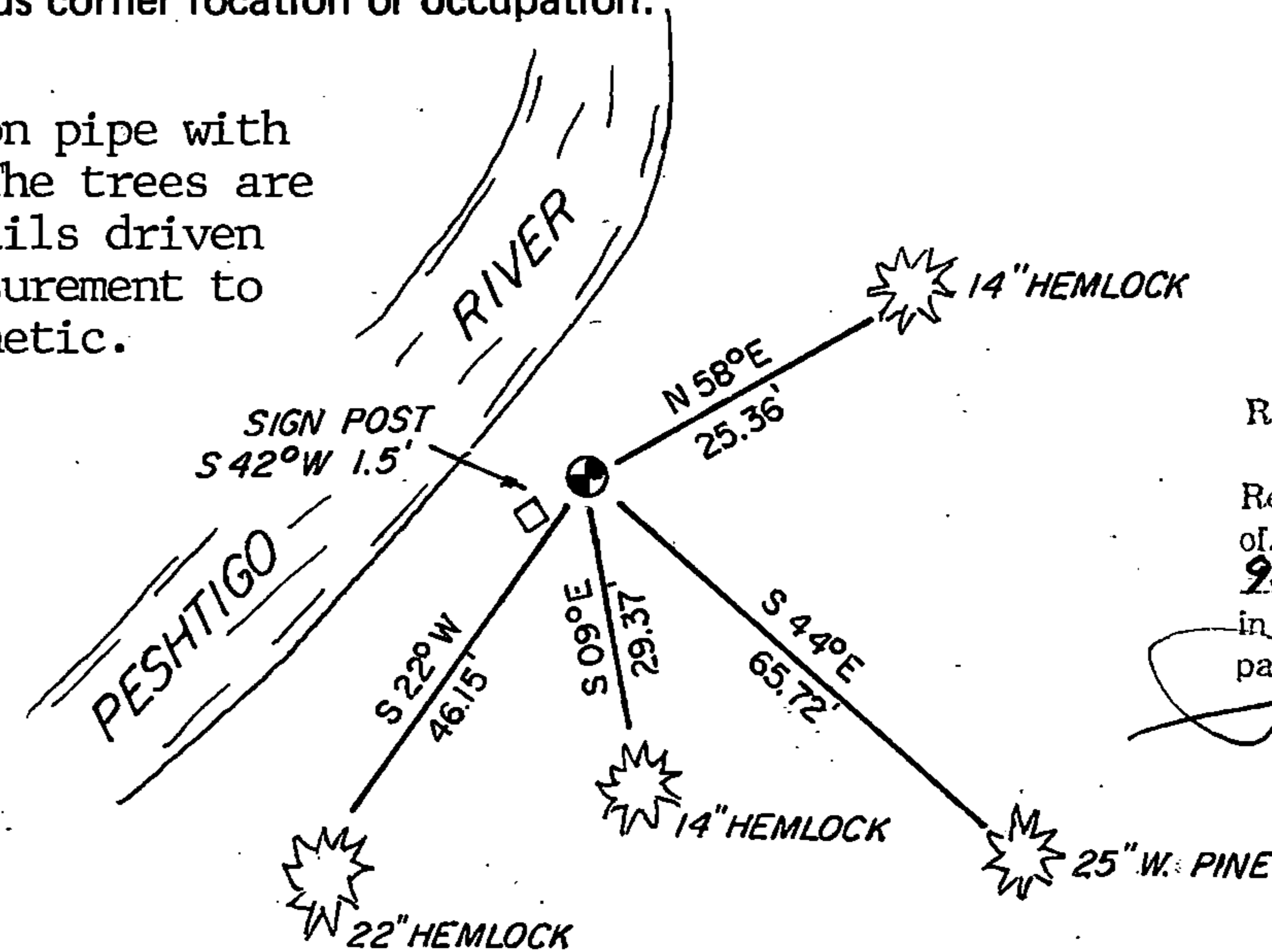

REGISTER'S OFFICE
 Forest County, Wis.
 Received for record this 3rd day
 of JANUARY A.D. 1992 at
9:30 o'clock A.M. and recorded
 in Vol. CORNER RESTORATIONS
 page L-21

Paul Schenck
 Register of Deeds

DOCUMENT NUMBER
143544

I, Kim H Pritzlaff, USFS Contractor
 (Type or print name) certify that the corner location shown on this record
 was determined by me or under my direction and control and that this
 U.S. Public Land Survey Monument Record is correct and complete to the
 best of my knowledge and belief.

Kim H. Pritzlaff
 Signature

11/30/91
 Date

43015142000