

CERTIFIED LAND CORNER RESTORATION

Index No. E-12

E 12

State of Wisconsin }
County of Forest } ss.

I Glen Barker, do hereby certify that on the 17th day of November, 1982, I ~~found~~ ^{established} ~~location of the~~ ^{E 1/16} corner of Sections 4 & 9 Township 36, North, Range 14 East, Fourth Principal Meridian, as described hereon; and that from this evidence I established a new monument and accessories as described hereon to perpetuate the original location of this corner.

Resident witnesses:

J. Claflin, R. 3A Land Surveyor

H. Wagoner

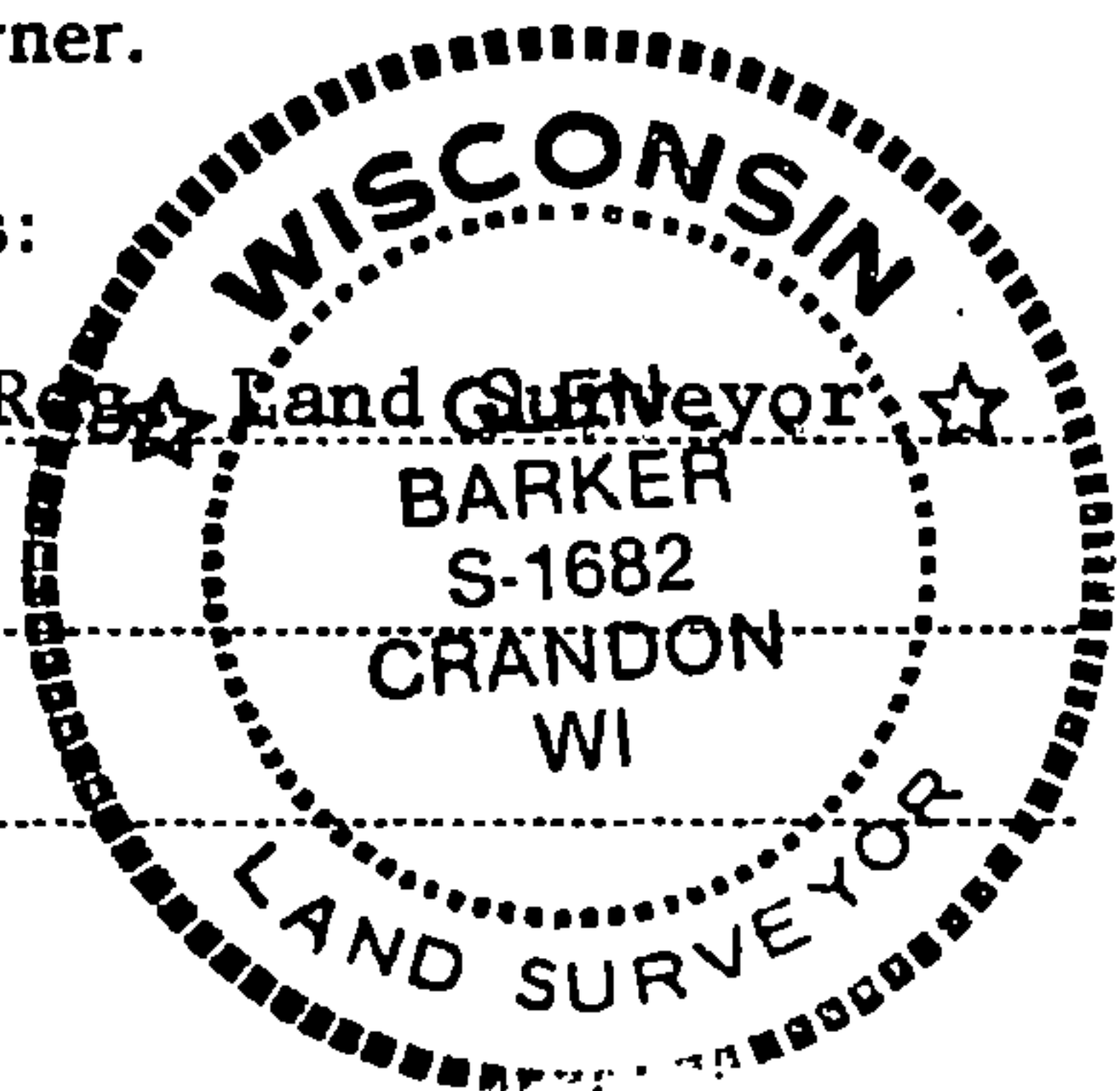

T36N R14E

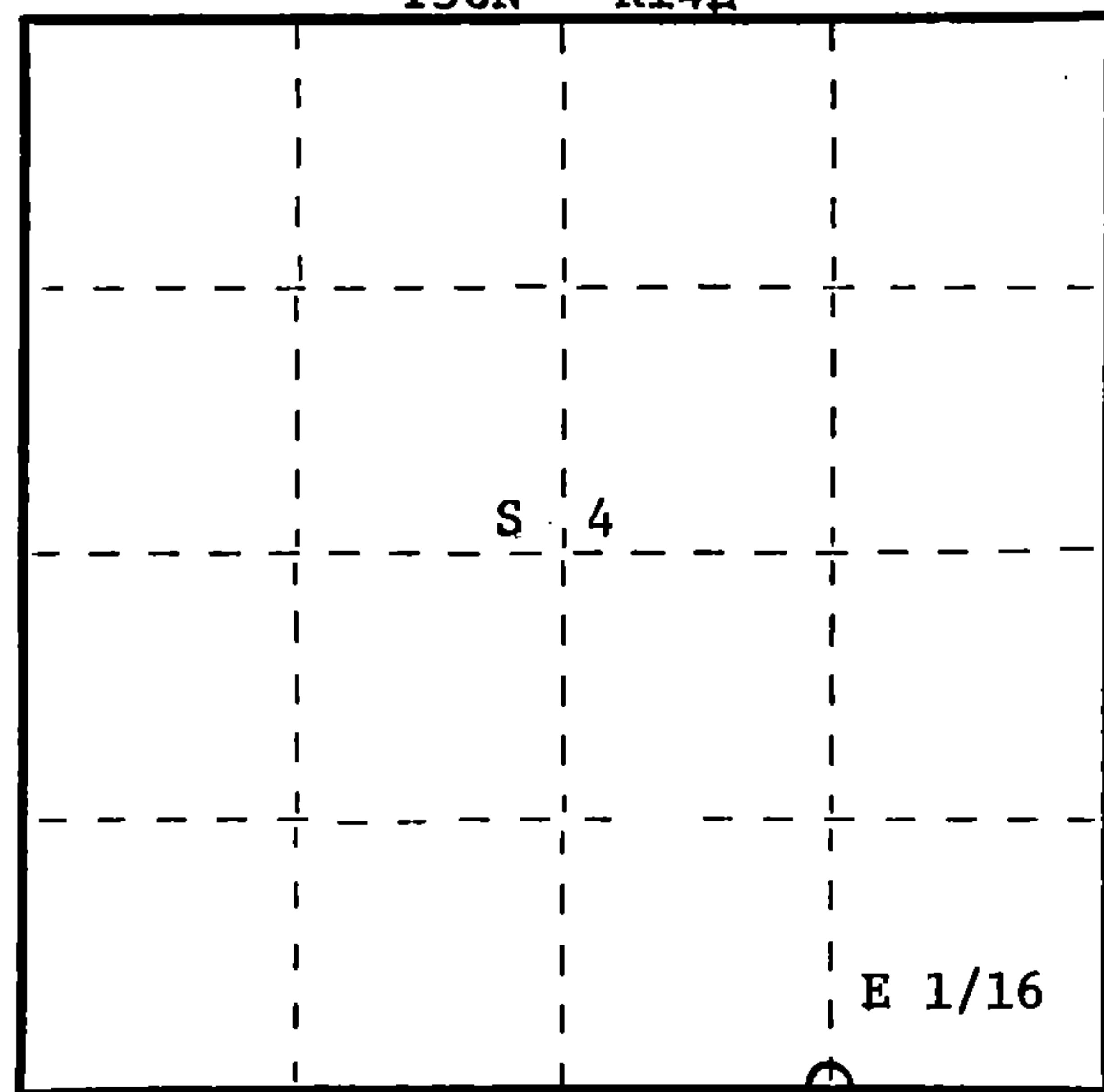

○ = Corner monument restored.

History of original corner establishment:

No evidence of any previous corner.

Description of corner evidence found:

Total distance from section corner 3-4-9-10 to 1/4 corner between sections 4 and 9 is 2579.60 feet at bearing S 85-12-14 W.
Set E 1/16 1289.80 feet intermediate.

Description of monument and accessories I established to perpetuate the original location of this corner.

Set a 1" iron pipe with 2" diameter alloy cap - stamped:
Monument projects 18" above ground.

Marked NBT's:

Sugar 8" S31W 7.50 feet
Sugar 8" N35W 5.35 feet
scribed 1/16 - B.T.

S1682
T36N R14E

E 1/16 $\frac{S+4}{S+9}$
CPI-1982

Dated at Rhinelander, Wis., this 21st day of March, 1983

Signature Glen Barker Title Registered Land Surveyor Registration No. S-1682
(County Surveyor, Registered Land Surveyor, or other duly authorized official)

Office of Register of Deeds, County of Forest, I hereby certify that the within instrument was filed in this office for record on the 7th day of April, 1983 at 9:30 o'clock A. M.

Eugene Stearns
(Register of Deeds)
By.....Deputy

DOCUMENT NO. **123146**

Stock No. 26272



FORM 983

43614040010