

CERTIFIED LAND CORNER RESTORATION

Index No. A-11

State of Wisconsin }
County of Forest } ss.

I Philip T. Hansen, do hereby certify that on the 28th day of February, 1977, I ~~found~~ **established** ~~the~~ Quarter corner of Section 4 & 33 Township 35 & 36, North, Range 12 East, Fourth Principal Meridian, as described hereon; and that from this evidence I established a new monument and accessories as described hereon to perpetuate the original location of this corner.

Resident witnesses:

Glen Barker

Jim Claflin

Herb Wagoner

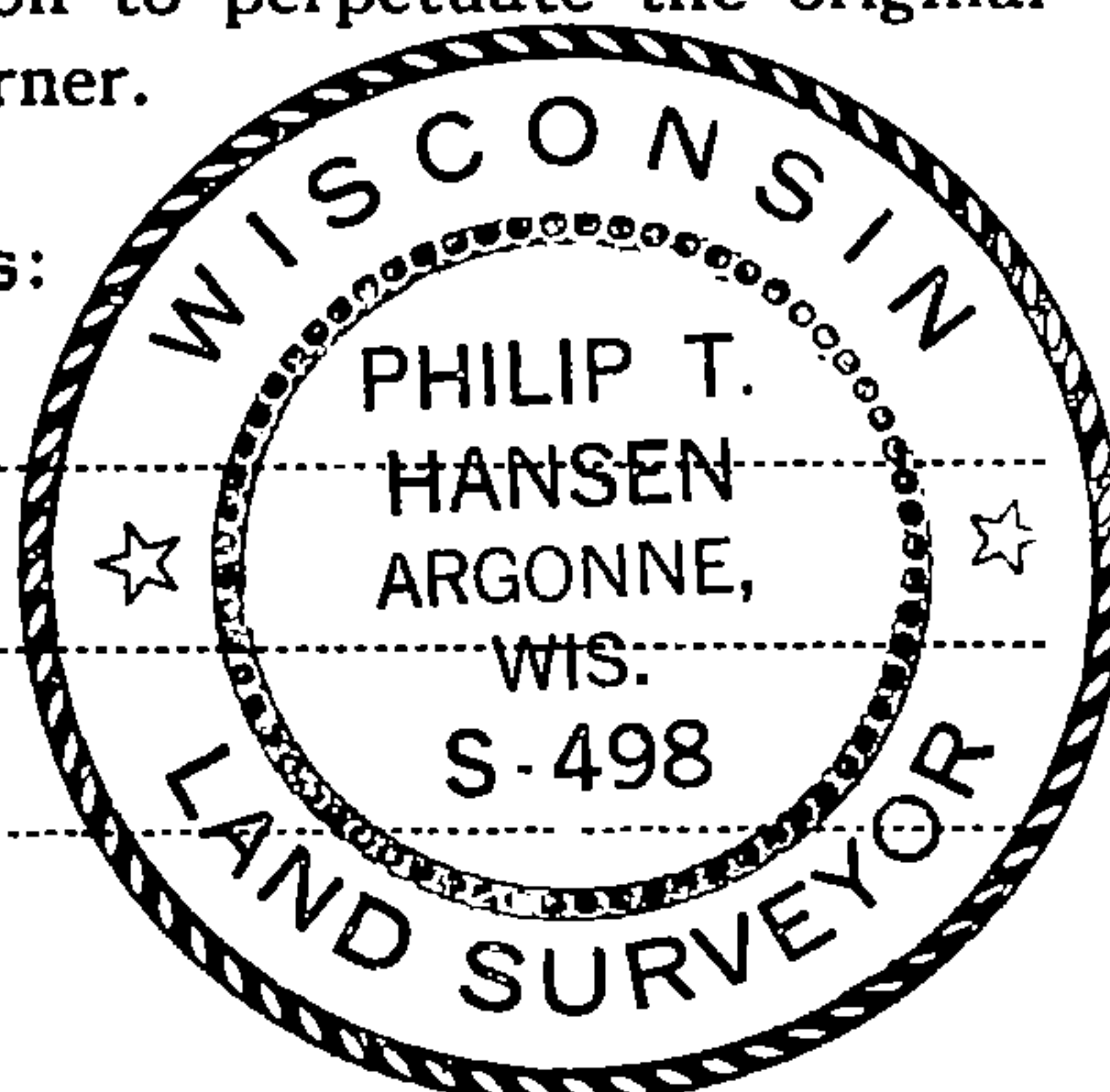

FORM 985 H. C. MILLER CO., MILWAUKEE

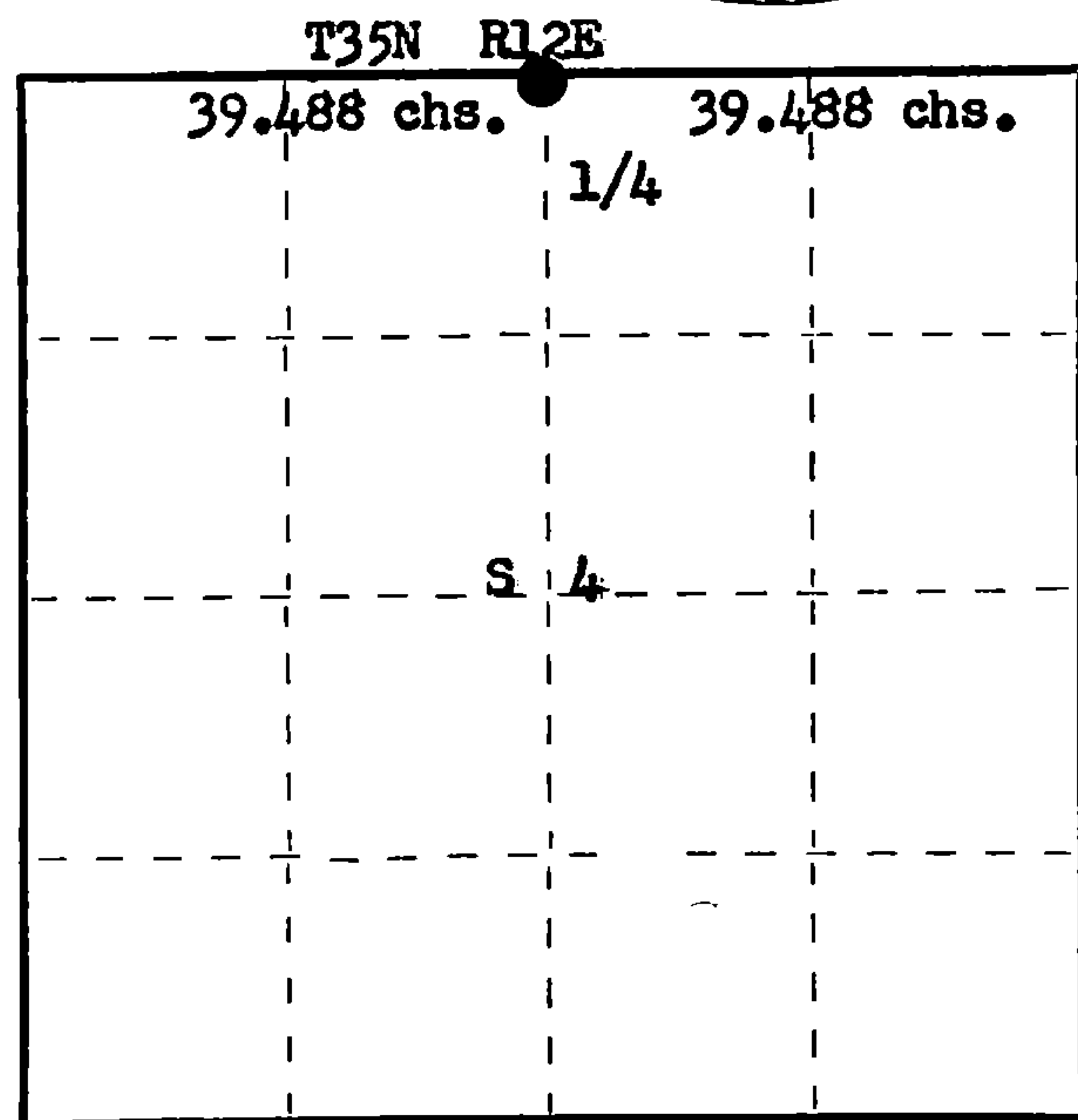

○ = Corner monument restored.

History of original corner establishment:

Original Corner established by Alfred Millard, Deputy Surveyor, in 1858, from which Sugar 10" bears N 20° E, 10 links and Yellow Birch 20" bears S 50° W, 45 links.

No record of any subsequent survey.

Description of corner evidence found:

Corner established by proportional measurement. Ran traverse from Section 33, 34, 3 & 4 to Section Corner 32, 33, 5 & 4. Computed distance 78.976 chains at bearing S 88° 57' 41" W. Set 1/4 corner at 39.488 chains intermediate.

Description of monument and accessories I established to perpetuate the original location of this corner.

Set a 2 1/2" Berntsen A-1 Federal Monument, aluminum with magnet installed in cap and base. Monument projects 12" above ground. Cap stamped:
NBTs - Sugar 7" S22°E, 20.7 links
Sugar 6" S75°E, 97.7 links
Sugar 6" N34°W, 96.8 links, scribed 1/4 BT.

T36N R12E
1/4 S 33
S 4
T35N R12E
S498-1977

43612330020

Dated at Rhinolander, Wis., this 5th day of April, 1977.

Signature Philip T. Hansen Title Registered Land Surveyor Registration No. S-498
(County Surveyor, Registered Land Surveyor, or other duly authorized official)

Office of Register of Deeds, County of Forest, I hereby certify that the within instrument was filed in this office for record on the 5th day of May, 1977 at 4:00 o'clock P. M.

Eugene Stutzman
(Register of Deeds)

By _____ Deputy

DOCUMENT NUMBER
111357