

CERTIFIED LAND CORNER RESTORATION

Index No. U-11

State of Wisconsin }
County of Forest } ss.

I Philip T. Hansen, do hereby certify that on the 18th day of October, 1980, I ~~found~~ ^{established} the SC 1/16 corner of Section 28 Township 36, North, Range 12 East, Fourth Principal Meridian, as described hereon; and that from this evidence I established a new monument and accessories as described hereon to perpetuate the original location of this corner.

Resident witnesses:

Glen Barker

Jim Claflin

Herb Wagoner



FORM 985 K. C. MILLER CO., MILWAUKEE

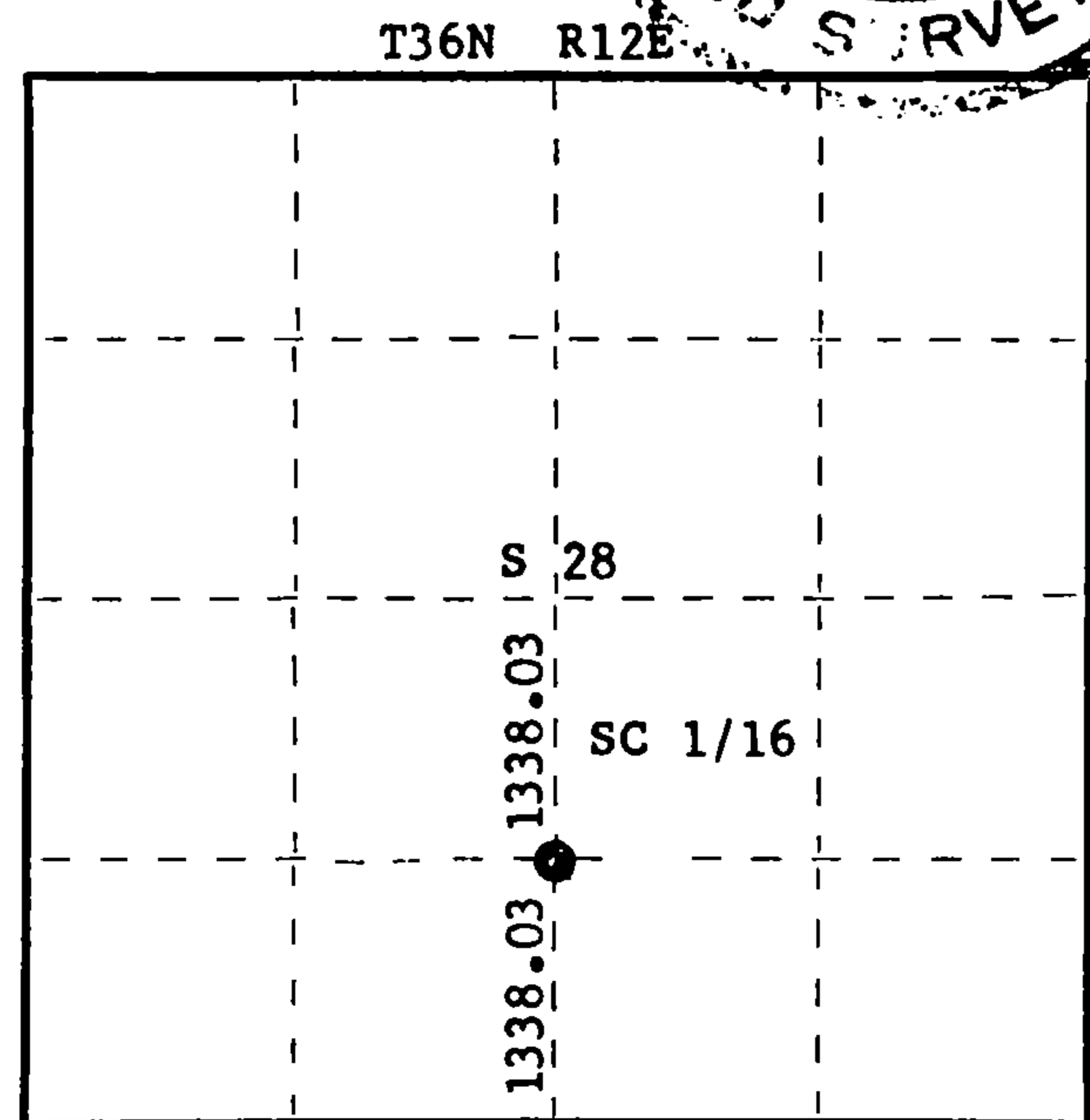

○ = Corner monument restored.

History of original corner establishment:

No record of any previous survey.

Description of corner evidence found:

No evidence of any corner recovered.

Corner established by traverse and computation.

Computed distance from previously established C 1/4 to the S 1/4 Section 28 is 2676.05' at bearing N 2° 12' 15" W.

Set SC 1/16 at 1338.03' intermediate.

Description of monument and accessories I established to perpetuate the original location of this corner.

Set 1-1/2" iron pipe with 2" brass cap projecting 18" - stamped:

Marked NBT's -

Sugar 7" S50°W 18.83 feet, scribed 1/16 BT.

Sugar 7" S79°E 24.12 feet, scribed 1/16 BT.

S498
T36N R12E
SC 1/16 S+28
CPI-1979

Dated at Rhineland, Wis., this 16th day of May, 1980

Signature Philip T. Hansen Title Registered Land Surveyor Registration No. S-498
(County Surveyor, Registered Land Surveyor, or other duly authorized official)

Office of Register of Deeds, County of Forest, I hereby certify that the within instrument was filed in this office for record on the 2nd day of June, 1980 at 8:30 o'clock A. M.

Eugene Stegany
(Register of Deeds)
By _____ Deputy

DOCUMENT NO. **118002**

43612281020