

CERTIFIED LAND CORNER RESTORATION

Index No. U-13

State of Wisconsin }  
County of Forest } ss.

I Philip T. Hansen, do hereby certify that on the 7th day of June, 1979, I ~~found~~ established ~~the~~ S 1/16 corner of Section 27 and 28 Township 36, North, Range 12 East, Fourth Principal Meridian, as described hereon; and that from this evidence I established a new monument and accessories as described hereon to perpetuate the original location of this corner.

Resident witnesses:

Glen Barker

Jim Claflin

Herb Wagoner

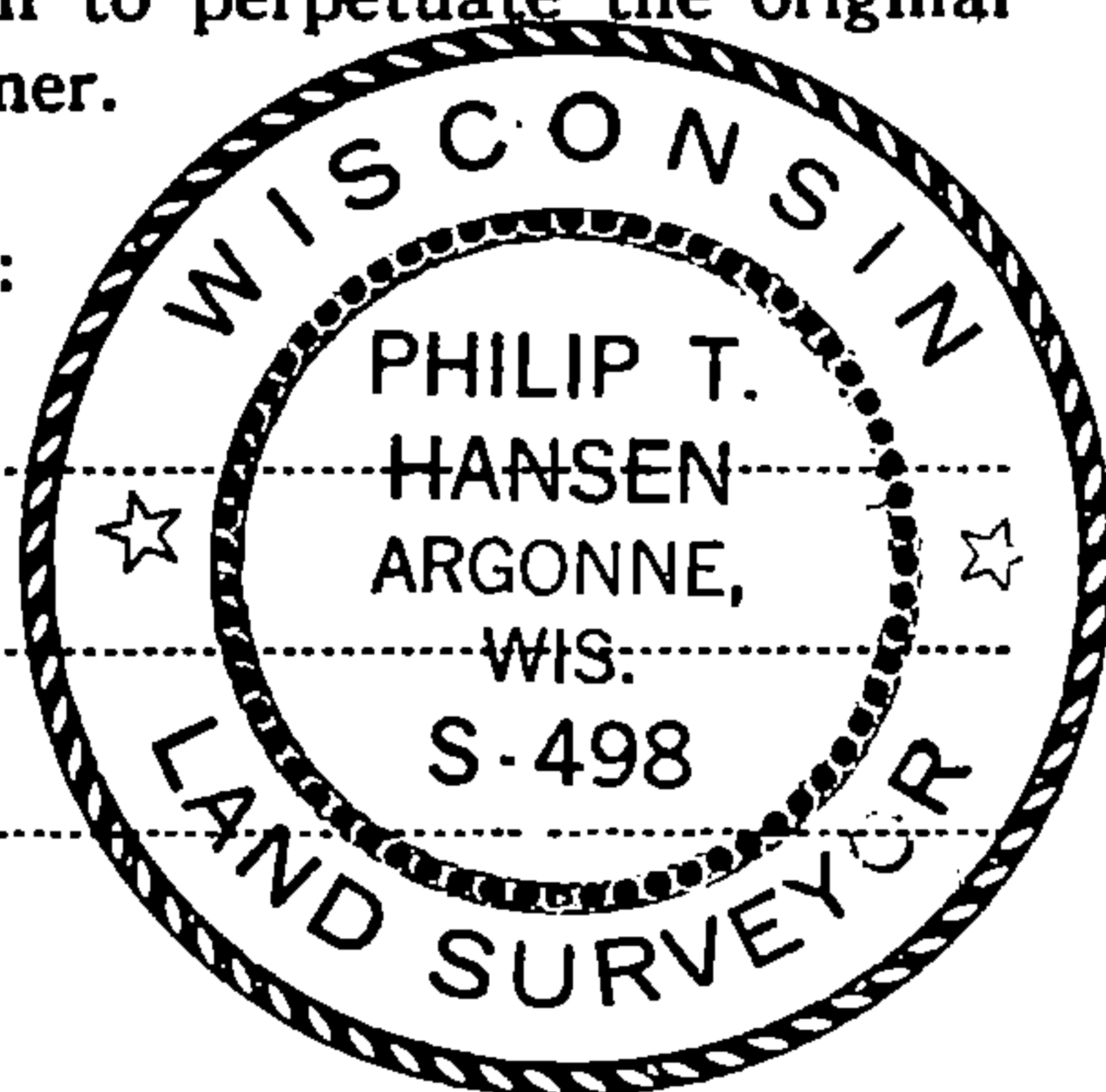

FORM 985 Wisconsin Planning & Surveying Co. Inc. Madison, Wisconsin

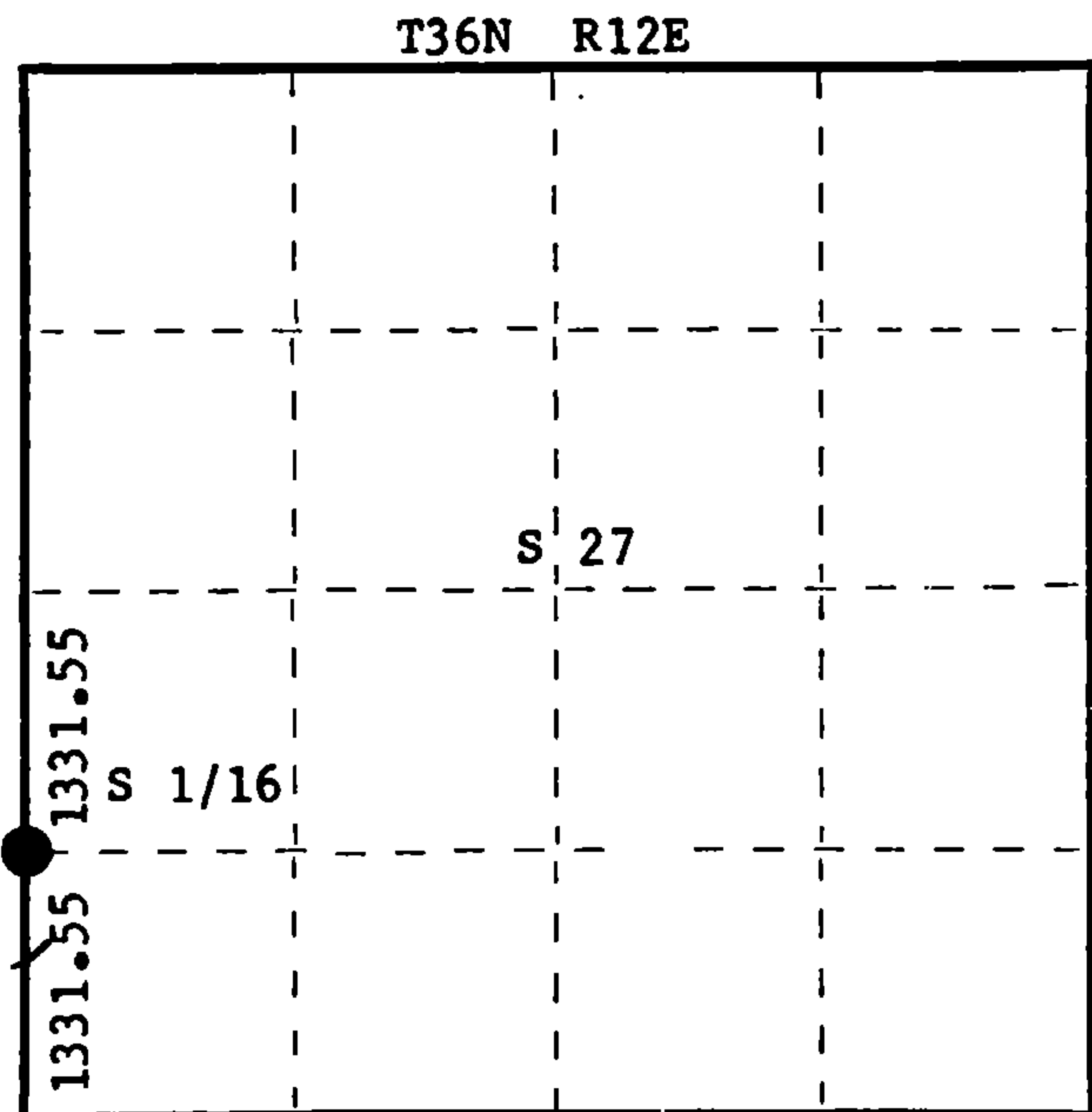

○ = Corner monument restored.

History of original corner establishment:  
No records of any previous survey.

Description of corner evidence found:

No evidence of any corner recovered.

Corner established by traverse and computation. Ran traverse from quarter corner between section 27 and 28 to section corner 27, 28, 33 and 34. Computed distance at 2663.112 feet at bearing N 2° 32' 41" W. Set S 1/16 corner at 1331.55 feet intermediate.

Description of monument and accessories I established to perpetuate the original location of this corner.

Set a 1-1/2" iron pipe with 2" brass cap, projecting 24" above ground - cap stamped:

Marked NBT's -

Maple 8" N43°W 19.34', scribed 1/16 BT.

Sugar 9" N47°E 20.85', scribed 1/16 BT.

S498  
T36N R12E  
S 1/16 28 + 27  
CPI-1979

Dated at Rhineland, Wis., this 12th day of June, 19 79

Signature Philip T. Hansen Title Registered Land Surveyor Registration No. S-498  
(County Surveyor, Registered Land Surveyor, or other duly authorized official)

Office of Register of Deeds, County of Forest, I hereby certify that the within instrument was filed in this office for record on the 13th day of November, 19 79 at 8:30 o'clock A. M.

Eugene Stutzman  
(Register of Deeds)

By \_\_\_\_\_ Deputy

DOCUMENT NO. **117079**

431012281000