

REGISTER'S OFFICE  
Forest County, WI

Received for record this 31<sup>ST</sup> day  
of December AD, 2008  
at 10:10 o'clock A M and  
recorded in Vol. Corner Restoration  
of records  
on page N-21.

Kay Swanson  
Deputy REGISTER

Document Number  
**199361**

U.S. PUBLIC LAND SURVEY MONUMENT RECORD

(As Required by WI Adm. Code)

History of original corner establishment and subsequent restorations and descriptions of any record, monument, occupational, testimonial or other evidence considered:

1859 - William E. Daugherty, set section post between Sections 13, 14, 23 and 24 and made the following B.T.'s:  
Hemlock, 10", N 62° W, 33 lks., 21.78 feet.  
Birch, 10", S 60° E, 7 lks., 4.62 feet.

1919 - I.R. Ritter set an iron pipe at section corner position and made the following B.T.'s:  
Birch, 16", S 45° E, 7 lks., 4.62 feet.  
Hemlock, 10", N 14° E, 70 lks., 46.20 feet.

2008 - I found a 1 1/4" iron pipe from 1919 Ritter Survey in excellent condition.  
I found Yellow Birch B.T. in good condition.  
I made the following new B.T.'s to iron pipe:

Cedar, 10", N 54° E, 31.74 feet.  
Yellow Birch, 24", S 49° E, 4.47 feet.  
Cedar, 7", S 73° W, 25.06 feet.  
Cedar, 8", N 38° W, 17.16 feet.

Corner was: (Check All That Apply)

- Restored through acceptance of an obliterated evidence location.
- Restored through acceptance of a found perpetuated location.
- Considered a lost corner and reestablished through lost corner proportionate methods (include a plan view drawing showing distances and directions to other Public Land Survey Corners used for proportioning and determining the corner location).
- Restored or reestablished in a location that differs from a previous restoration or reestablishment (include a plan view drawing and indicate what was set and/or found).

Describe the monument and accessories used to perpetuate the location of this corner (include a plan view drawing and indicate what was set and/or found).

Sketch Not To Scale

LEGEND:

● 1 1/4" Iron Pipe Found

Note: All distances are taken to nail in side of tree.

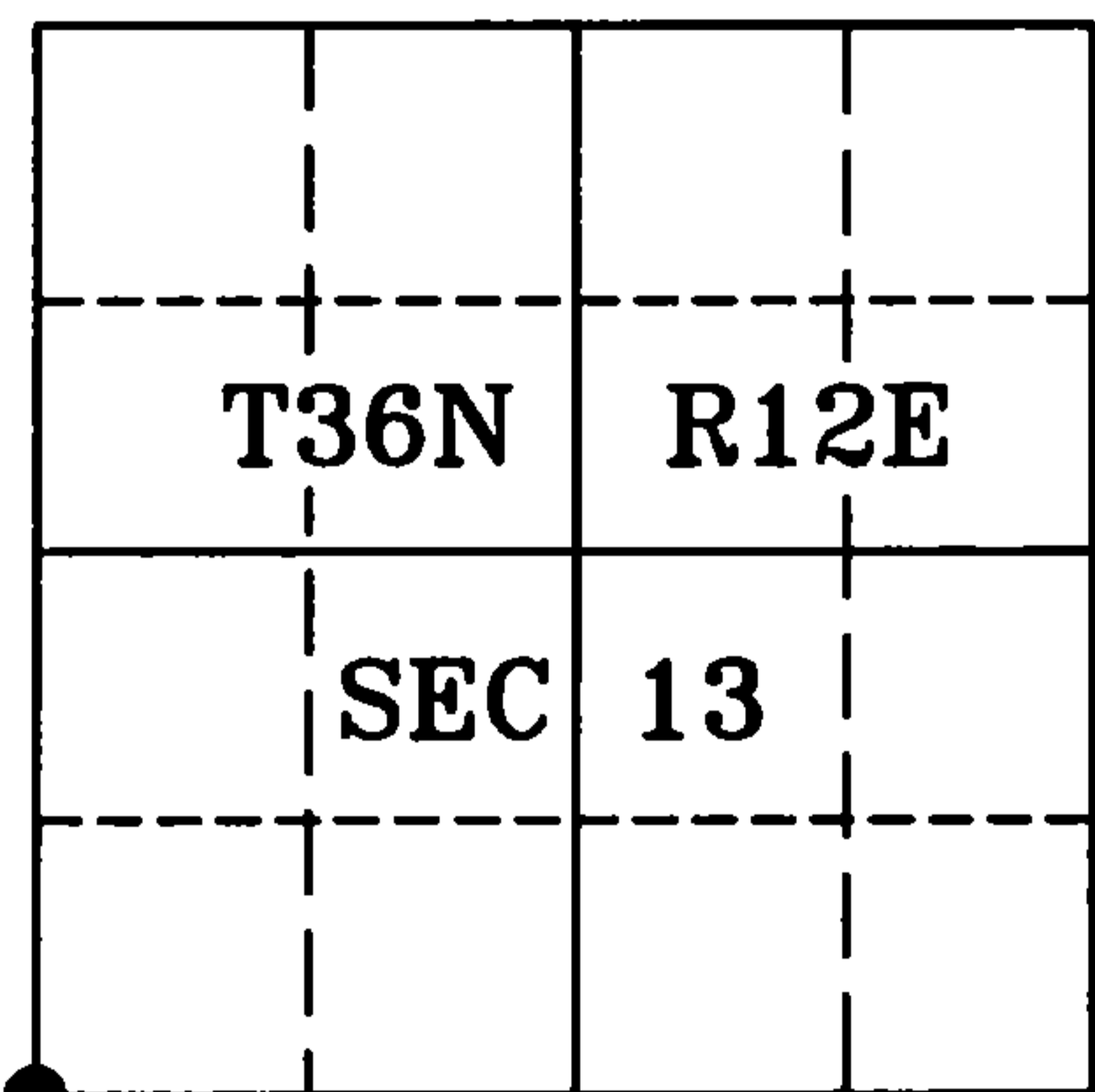
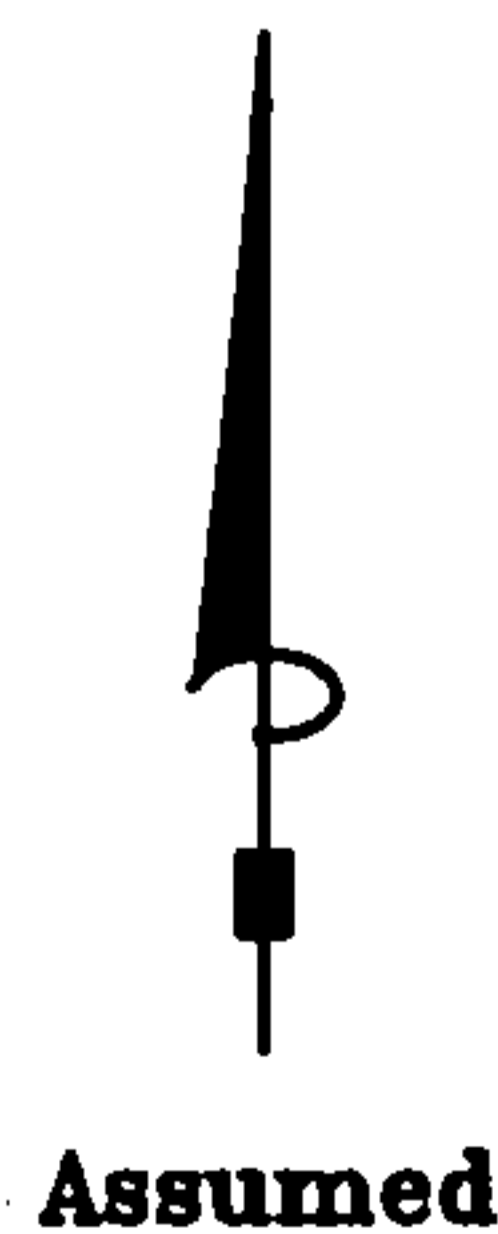
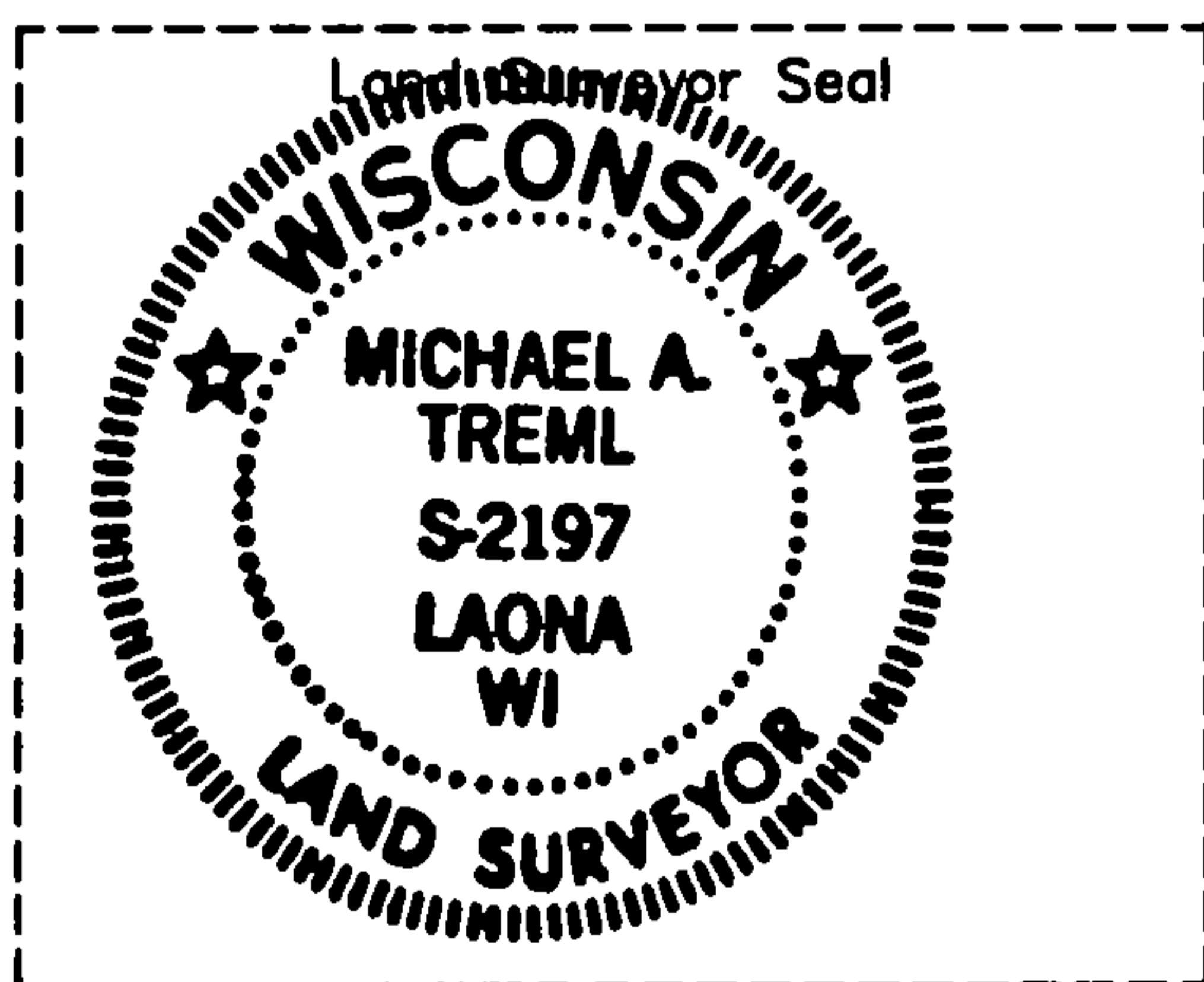
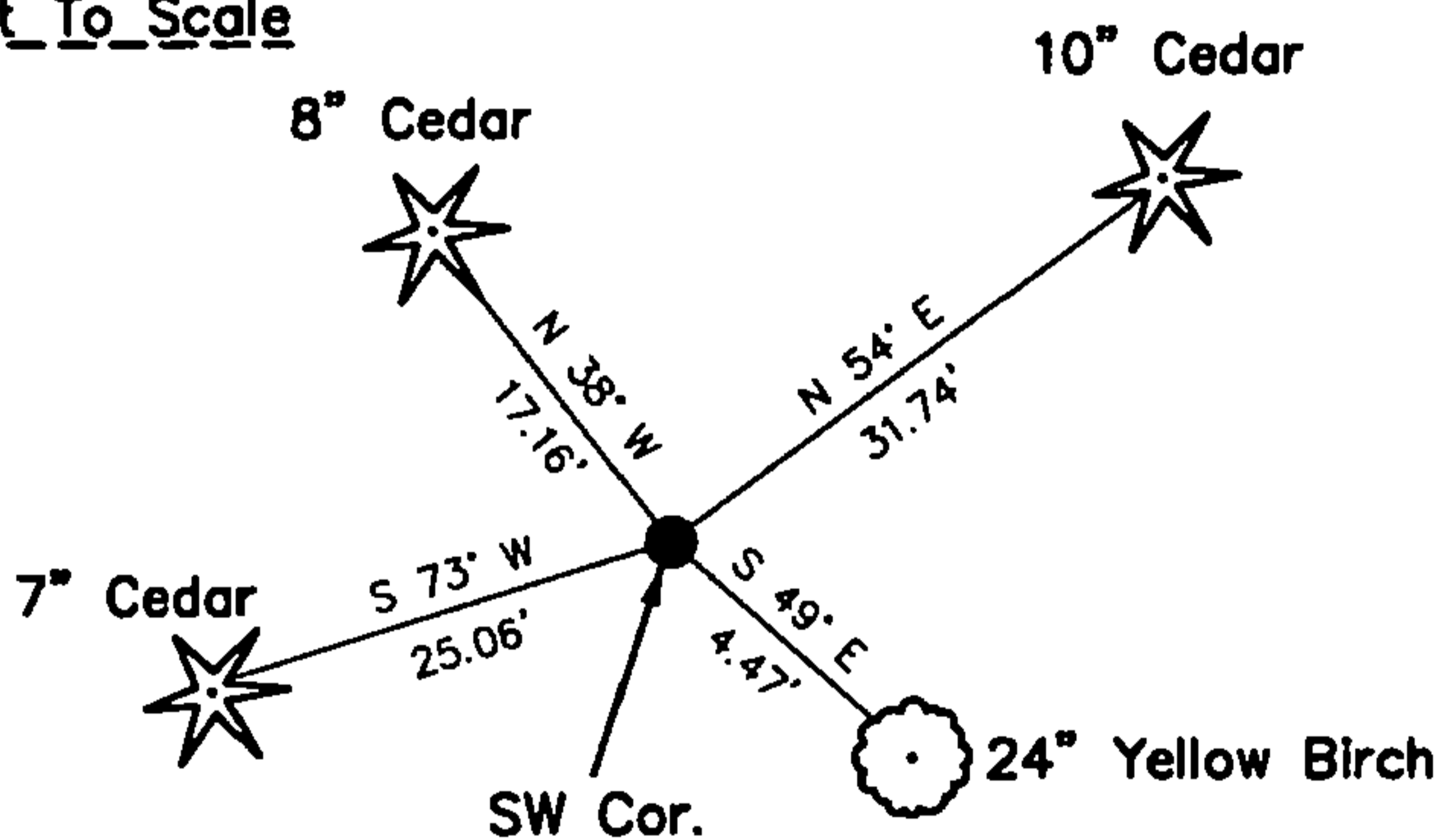

I, Michael A. Trembl, RLS  
(type or print name) certify that the corner location shown on this record was determined by me or under my direction and control and that this U.S. Public Land Survey Monument Record is correct and complete to the best of my knowledge and belief.

Michael A. Trembl 11/11/08  
Signature Date

The Southwest corner of  
Section 13 T. 36 N., R. 12 E.  
Forest County, WI

Index No. N-21