

U. S. PUBLIC LAND SURVEY MONUMENT RECORD

INDEX NO. V.W-5

V, W-5

MEANDER Corner to Section 31 30 T35 N, R 15 E
(Section/Quarter)

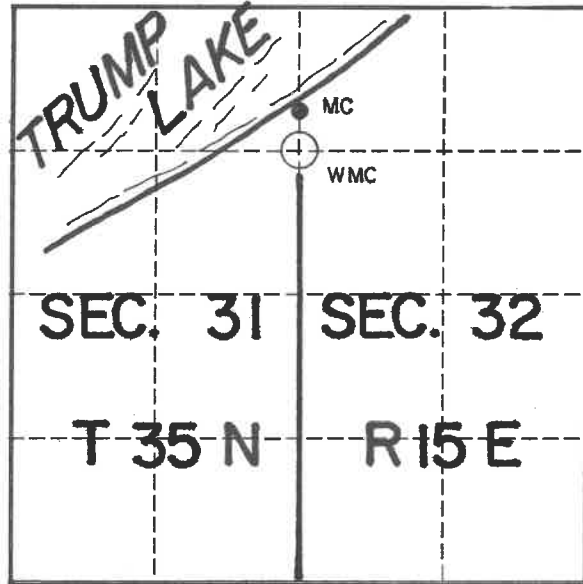

Show distances and bearings if set by proportional measurement.

○ = Corner monument restored.

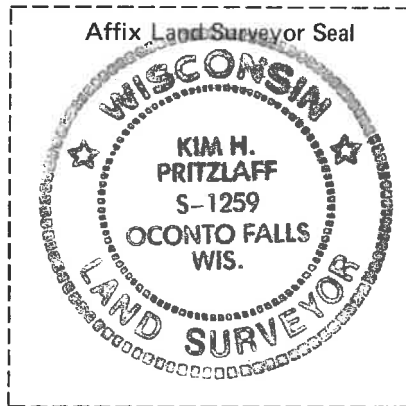

THE MEANDER CORNER CONSISTS OF A 1½" IRON PIPE WITH A 2" DIAMETER BY 36" LONG ALUMINUM MONUMENT SET FIVE FEET SOUTH ON THE SECTION LINE AS A WITNESS MEANDER CORNER. BEARINGS ARE MAGNETIC.

DOCUMENT NUMBER
143534

History of original corner establishment, record evidence, monument evidence, occupational evidence, testimonial evidence or any other material evidence, and what you found and how the monument was set.

SURVEYED IN 1857 BY ARTEMAS CURTIS WHO SET A WOOD POST AT 57.62 CHAINS WITH THE FOLLOWING BEARING TREES:
WHITE PINE , 18" , S86E, 83 LINKS
BIRCH , 10" , S34W, 41 LINKS

SURVEYED IN 1911 AND 1905 BY NATHAN SMITH WHO RESTORED THIS CORNER WITH A NEW STAKE AND PLATTED OUT THE PLAT OF LONG BEACH SUMMER RESORT.

IN 1991 KIM PRITZLAFF FOUND A 1½" IRON PIPE AT THIS CORNER LOCATION WHICH IRON PIPE MONUMENTS ON SMITH'S LONG BEACH SUMMER RESORT PLAT FIT MARKING THE INDIVIDUAL LOTS. PLATS TO THE SOUTH OF SMITH'S ALSO FIT THIS PIPE LOCATION. BEARING TREE EVIDENCE WAS DESTROYED BY LAKE LOT IMPROVEMENTS. I ACCEPTED THE IRON PIPE AS SMITH'S CORNER PERPETUATION AND MONUMENTED A WITNESS TO THIS MEANDER CORNER FIVE FEET SOUTH.

In the plan view drawing below, provide reference ties to at least 4 witness monuments, or, if the location is within a municipality, to at least 2 witness monuments. (Witness monuments shall be made of concrete, natural stone, iron or other equally durable material, except wood other than bearing trees.) Also, show any material discrepancies between the corner restored or re-established and the location of any other previous corner location or occupation.

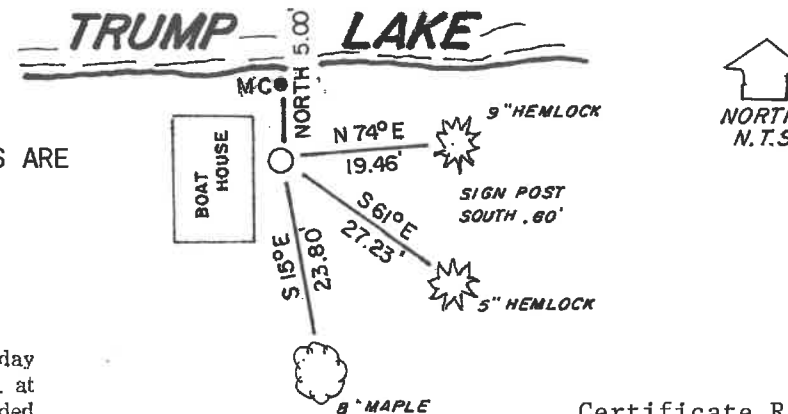

REGISTER'S OFFICE
Forest County, Wis.

Received for record this 3RD day of JANUARY A.D. 1992 at 9:30 o'clock A.M. and recorded in Vol. CORNER RESTORATIONS page V, W-5.

Janet A. Schrammer
Register of Deeds

I, KIM H PRITZLAFF, RLS 1991
(Type or print name) certify that the corner location shown on this record was determined by me or under my direction and control and that this U.S. Public Land Survey Monument Record is correct and complete to the best of my knowledge and belief.

Kim H Pritzlaff

Signature

Date

Certificate Ready for Filing:

Darrell E. Richards
Acting District Ranger

4351572900

INDEX NO. _____

MAINTENANCE RECORD

Condition of Monument _____

Condition of Ties _____

New Ties, if any:

_____ Date _____ Signature _____

Condition of Monument _____

Condition of Ties _____

New Ties, if any:

_____ Date _____ Signature _____

Condition of Monument _____

Condition of Ties _____

New Ties, if any:

_____ Date _____ Signature _____