

U. S. PUBLIC LAND SURVEY MONUMENT RECORD

INDEX NO. T-9

Quarter _____ Corner to Section 28 29 T 35 N, R 14 E
(Section/Quarter)

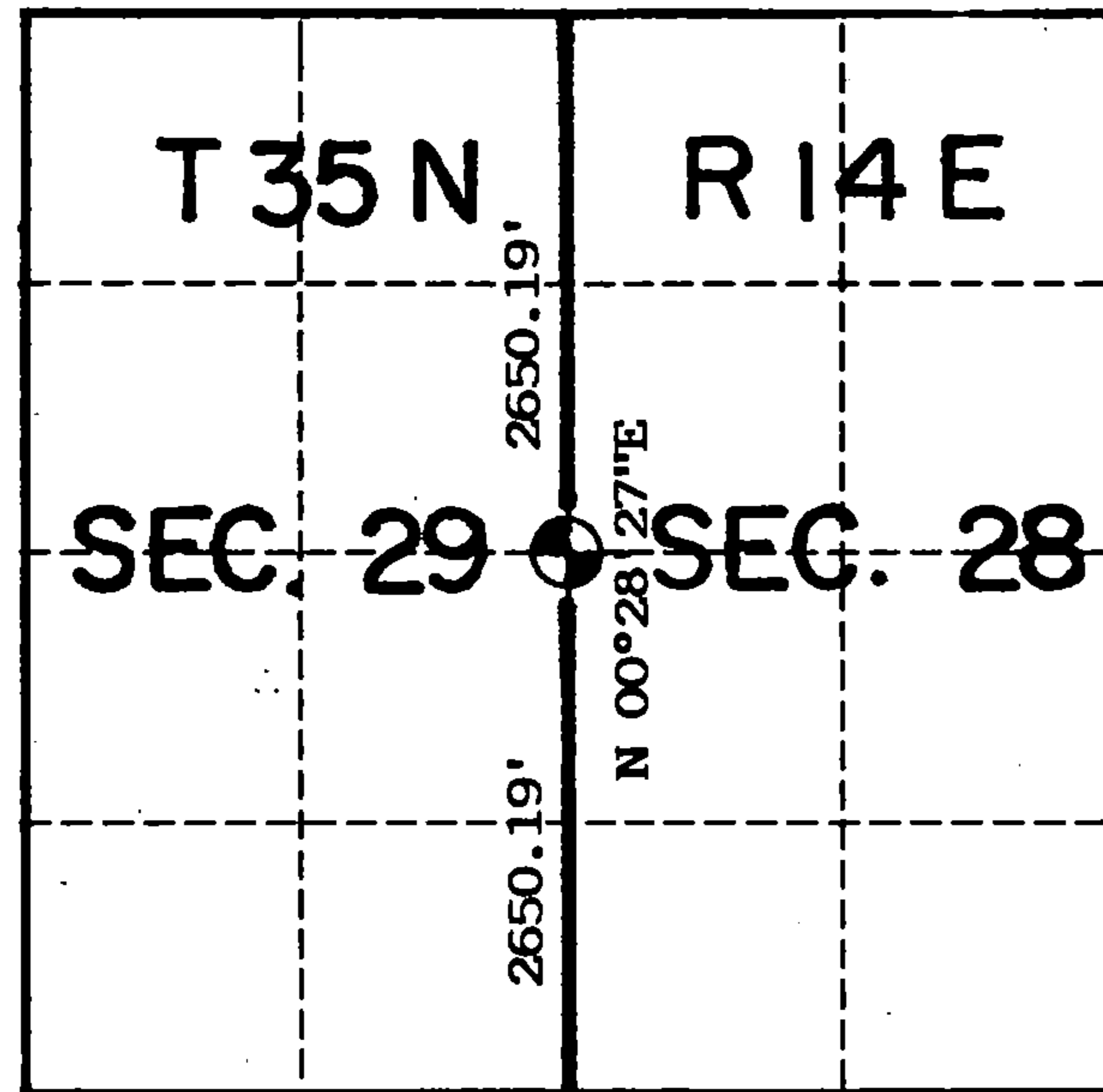

Show distances and bearings if set by proportional measurement.

○ = Corner monument restored.

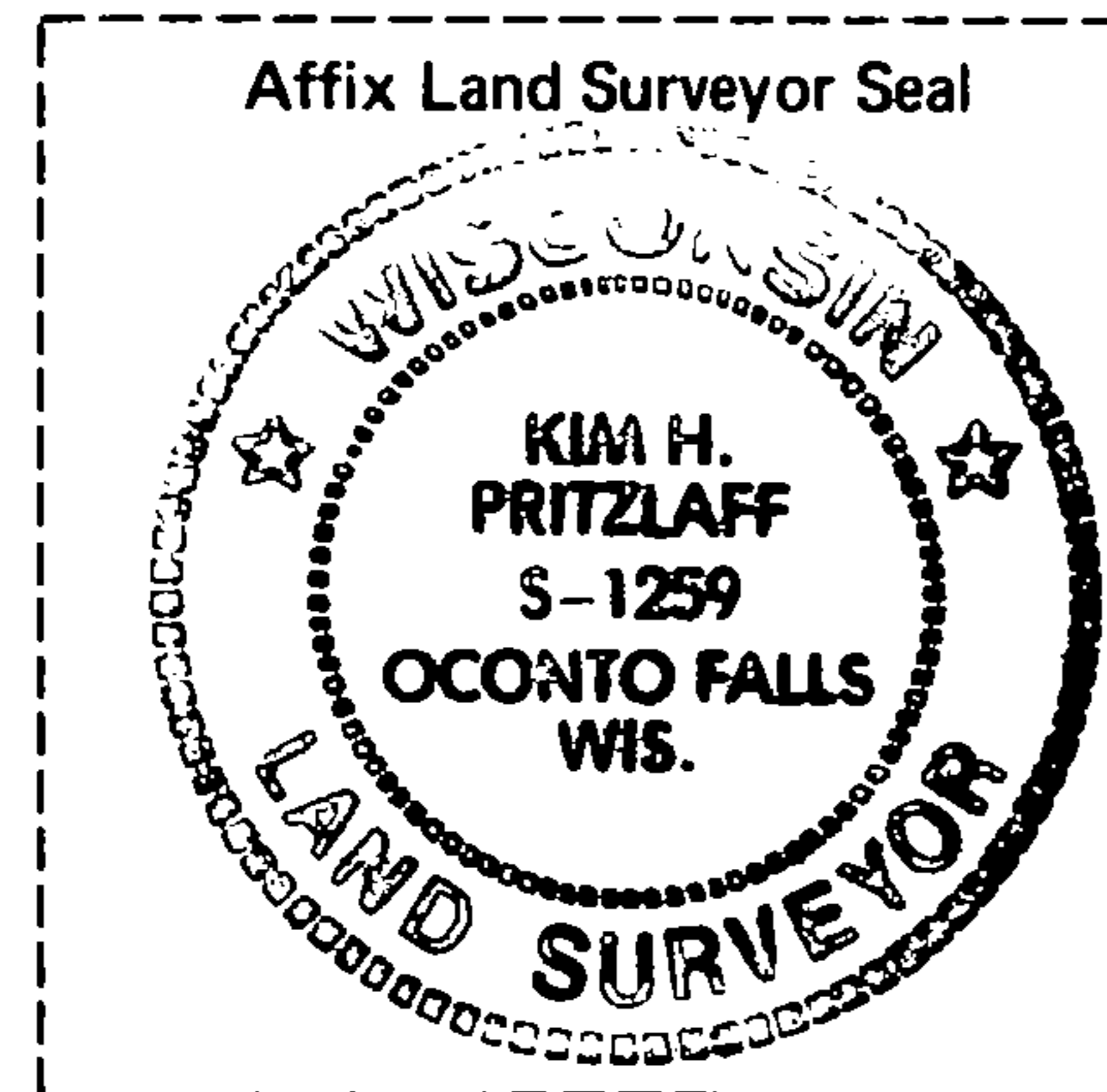

Set a 2"x 36" aluminum post with cap stamped for corner. Ties are to aluminum nails driven into the tree centers which trees were blazed and scribed. Bearings are magnetic.

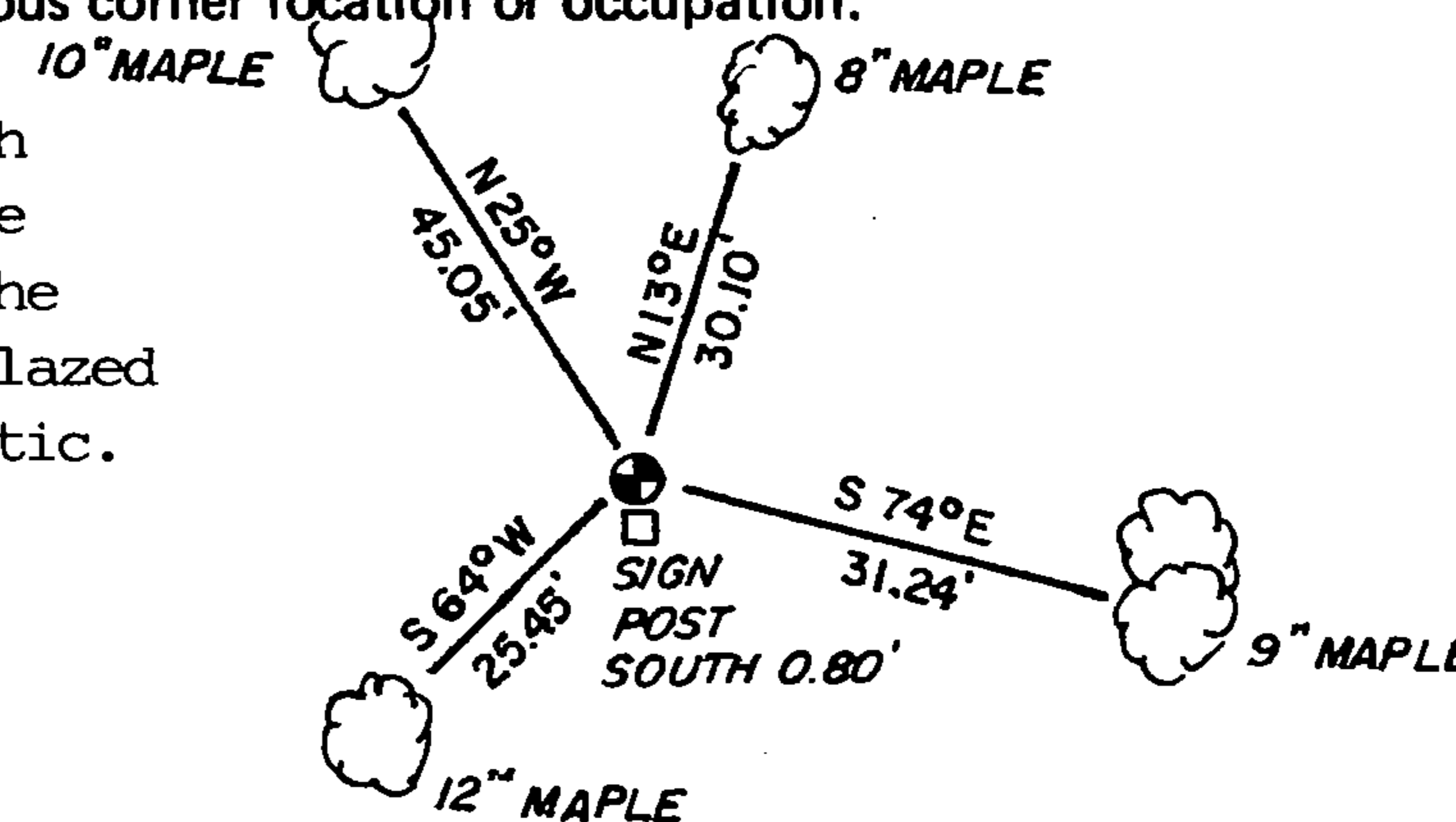

History of original corner establishment, record evidence, monument evidence, occupational evidence, testimonial evidence or any other material evidence, and what you found and how the monument was set.

In 1859 James McBride, contract surveyor, set this corner at 40 chains and marked the following bearing trees:

Sugar	10"	N84W	22 links
Hemlock	10"	N85E	18 "

I set up a search area at the single proportionate position which fell on a side hill and in a heavily logged area in Popple slashing. The single proportionate position also fit the marsh call north of 54.50 chains within a chain. After location of some Hemlock stumps and finding no post evidence, I determined the corner to be lost and set it at single proportionate measure.

In the plan view drawing below, provide reference ties to at least 4 witness monuments, or, if the location is within a municipality, to at least 2 witness monuments. (Witness monuments shall be made of concrete, natural stone, iron or other equally durable material, except wood other than bearing trees.) Also, show any material discrepancies between the corner restored or re-established and the location of any other previous corner location or occupation.

Certificate Ready For Filing:

I, Kim H Pritzlaff, RLS No. 1259
(Type or print name) certify that the corner location shown on this record was determined by me or under my direction and control and that this U.S. Public Land Survey Monument Record is correct and complete to the best of my knowledge and belief.

Kim Pritzlaff
Signature

1993
Date

Ralph Della
Acting District Ranger

149068

43514292000

INDEX NO. _____

MAINTENANCE RECORD

Condition of Monument _____

Condition of Ties _____

New Ties, if any:

Date

Signature

Condition of Monument _____

Condition of Ties _____

New Ties, if any:

Date

Signature

Condition of Monument _____

Condition of Ties _____

New Ties, if any:

Date

Signature

REGISTER'S OFFICE
FOREST COUNTY, WIS.

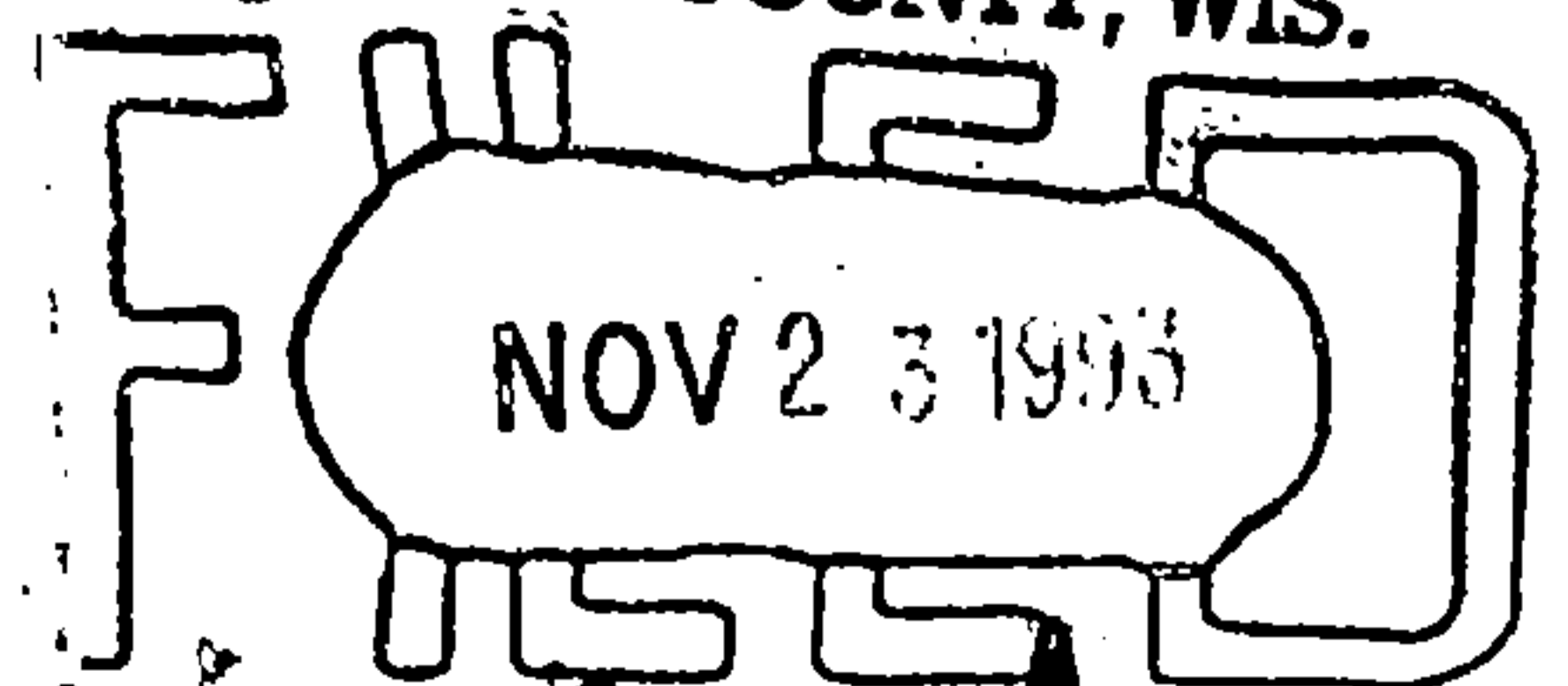

Paul A. Schramm
At _____ O'clock **A** M.
Register of Deeds