

CERTIFIED LAND CORNER RESTORATION

Index No. Q-17

017

State of Wisconsin } ss.
County of Forest

I Glen Barker, do hereby certify that on the 18th day of October, 1982, ~~XXXX~~ Est. ~~XXXXXX~~ of the S1/16 corner of Sections 22-23 Township 35 North, Range 13 East, Fourth Principal Meridian, as described hereon; and that from this evidence I established a new monument and accessories as described hereon to perpetuate the original location of this corner.

Resident witnesses:
Jim Claflin - RLS
H. Wagoner

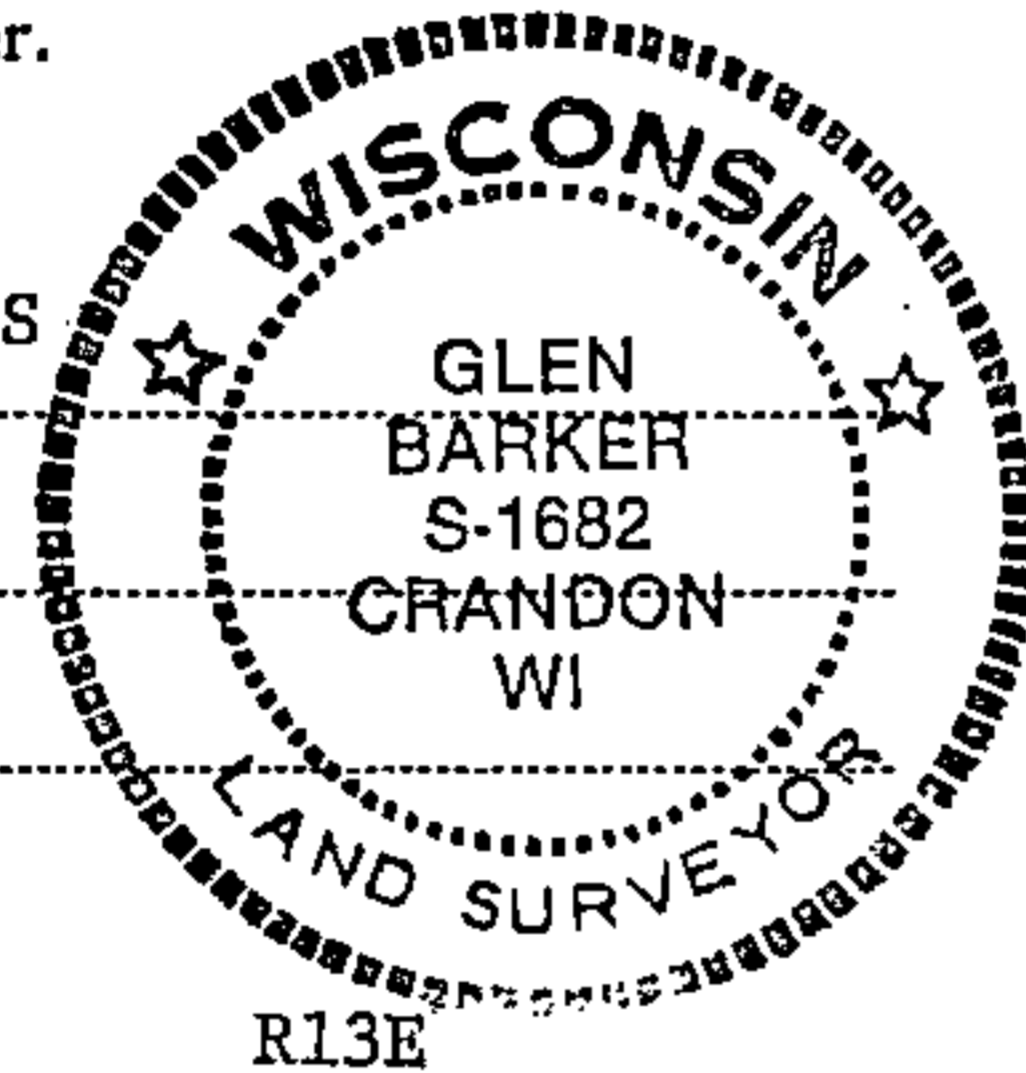

T35N R13E

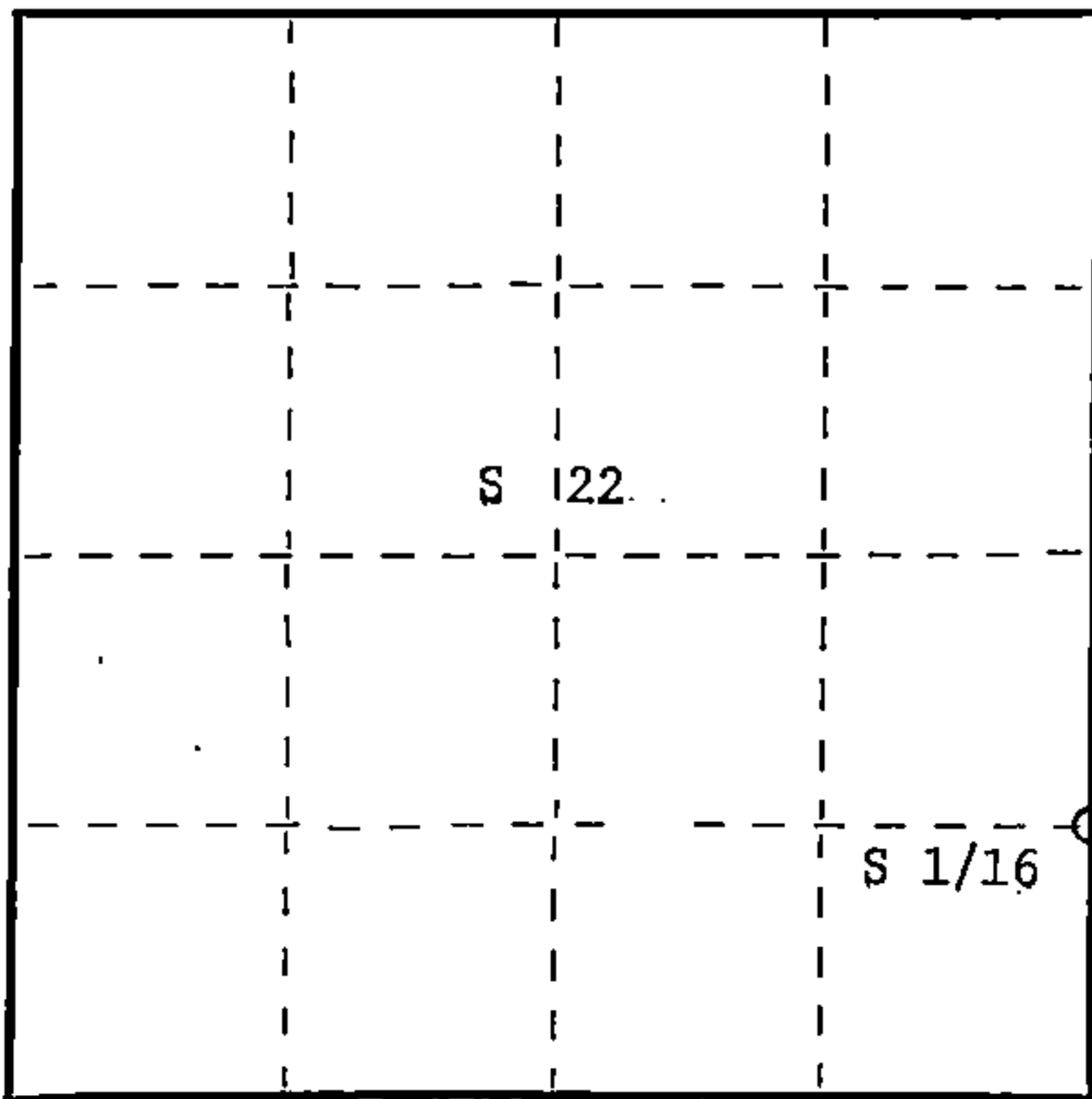

○ = Corner monument restored.

History of original corner establishment:

No evidence of any previous corner.

Description of corner evidence found:

Total distance from section corner 22-23-26-27 to 1/4 corner 22-23 is 2654.75 ft. at bearing N2-49-16E. Set S1/16 1327.375 ft. intermediate.

Description of monument and accessories I established to perpetuate the original location of this corner.

Set a 1" iron pipe with 2" diameter alloy cap stamped: S1682 T35N R13E
Monument projects 18" above ground S1/16 22 23
Marked NBTs: CPI - 1982
Maple 6" S69E 38.65 ft.
White birch 5" N78E 48.45 ft.
Scribed 1/16 - B.T.

Dated at Rhineland, Wis., this 30th day of December, 1982

Signature Glen Barker Title Registered Land Surveyor Registration No. S1682
(County Surveyor, Registered Land Surveyor, or other duly authorized official)

Office of Register of Deeds, County of Forest, I hereby certify that the within instrument was filed in this office for record on the 16th day of February, 1983 at 10:30'clock A.M.

Eugene Stately
(Register of Deeds)
By _____ Deputy

DOCUMENT NO. 122917

FORM 985 H. C. MILLER CO., MILWAUKEE

43513221000