

CERTIFIED LAND CORNER RESTORATION

Index No. U-22

State of Wisconsin }
County of Forest } ss.

I Glen Barker, do hereby certify that on the 13th day of September, 1984, I found ~~evidence of the~~ established corner of Sections 12 & 13 Township 35, North, Range 13 East, Fourth Principal Meridian, as described hereon; and that from this evidence I established a new monument and accessories as described hereon to perpetuate the original location of this corner.

Resident witnesses:

N. Spiess
H. Wagoner

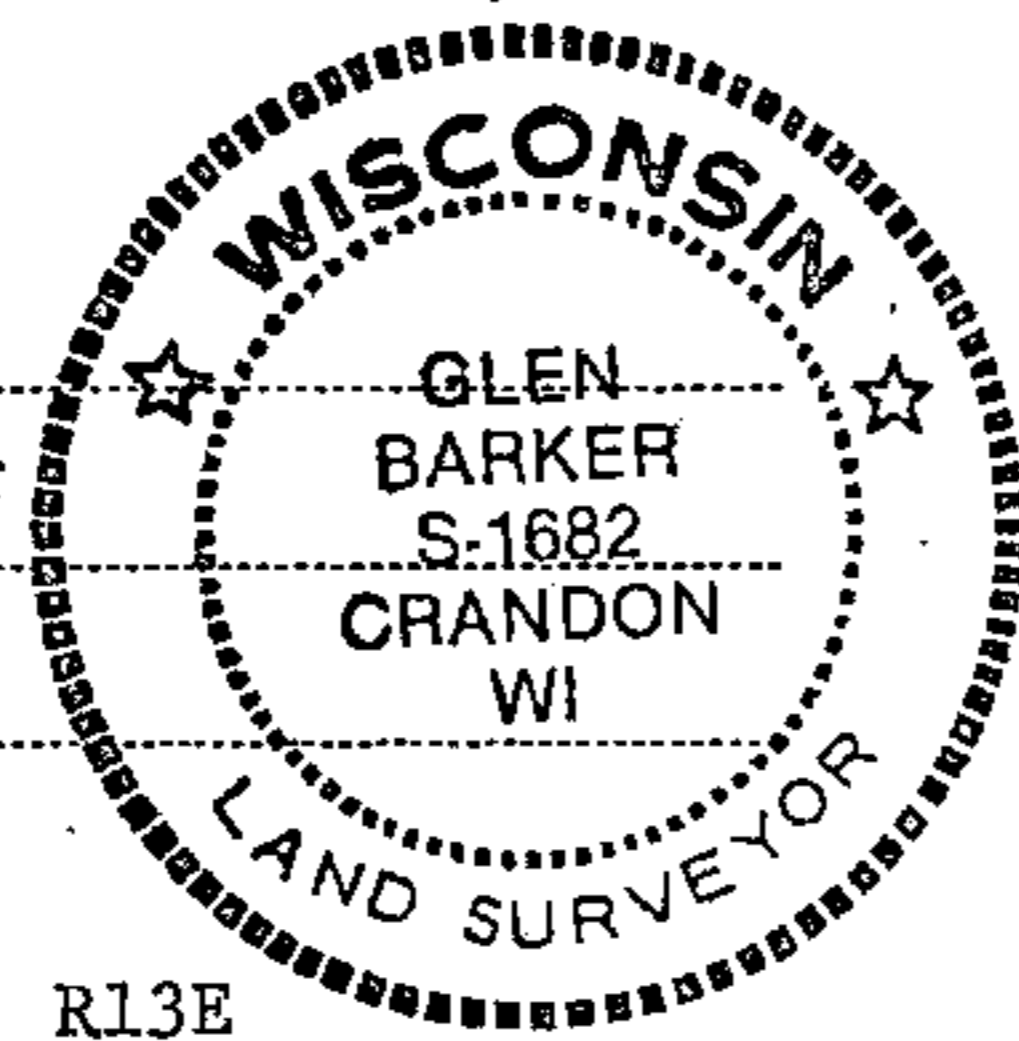

T35N R13E

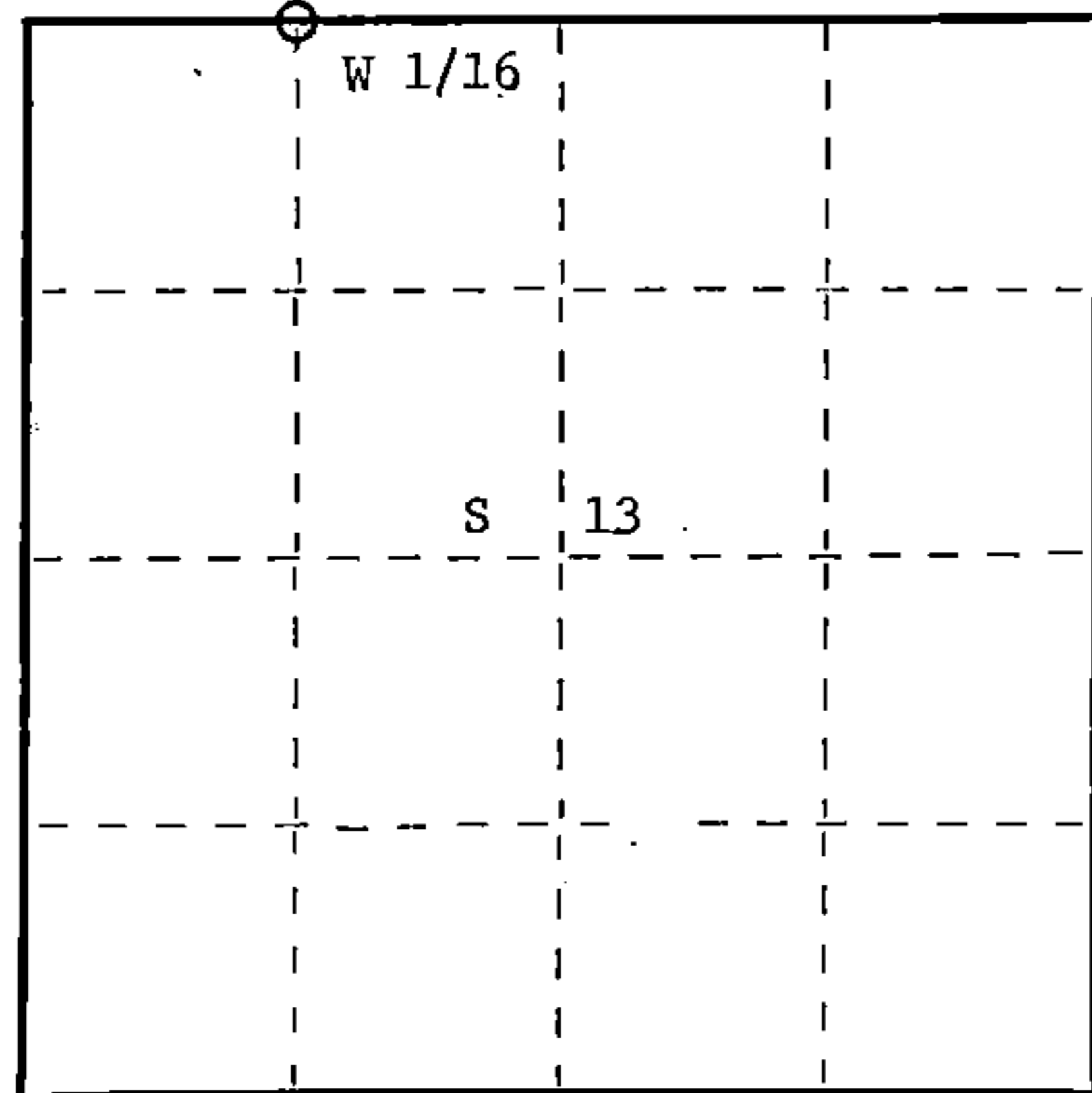

○ = Corner monument restored.

History of original corner establishment:

Corner originally set by C. Walker. Remonumented by T. Arnott.

Description of corner evidence found:

Total distance from 1/4 corner between Sections 12 & 13 to section corner 11-12=13-14 is 2584.38'.

Set W 1/16 1292.10' intermediate.

T. Arnott's monument bears N80-47-49W 7.63'

Description of monument and accessories I established to perpetuate the original location of this corner.

Set a 1" iron pipe with 2" diameter alloy cap stamped: S1682

Monument projects 18" above ground. T35N

Marked NBTs:

W. birch 12" S53W 22.35' W 1/16 S 12

W. birch 6" S58E 18.45' S 13

R13E

CPI - 1984

Dated at Rhineland, Wis., this 12th day of October, 1984.

Signature Glen Barker Title Registered Land Surveyor Registration No. 1682
(County Surveyor, Registered Land Surveyor, or other duly authorized official)

Office of Register of Deeds, County of Forest, I hereby certify that the within instrument was filed in this office for record on the 20th day of December, 1984 at 1:15 o'clock P. M.

Eugene Staszny
(Register of Deeds)

Document Number **126949**

By _____ Deputy

FORM 985 R. C. MILLER CO., MILWAUKEE

43513120030